

**FOR
LEASE**

REDUCED RATE! - \$2.10 IG

**MULTI-TENANT LIGHT INDUSTRIAL
BUILDING FOR LEASE**



3270
keller street

CONTACT US

TYLER HUYGHUE

Associate

Lic. 02244055

+1 408 790 5419

tyler.huyghue@cbre.com

NICK WHITSTONE

Senior Vice President

Lic. 01196787

+1 408 453 7438

nick.whitstone@cbre.com

SANTA CLARA, CA

CBRE

PROPERTY HIGHLIGHTS



±1,200
RSF UNIT



3 PHASE
POWER



REAR GRADE
LEVEL DOOR



2:1000
PARKING



CURRENT AVAILABILITY
AND SITE PLAN
ON REVERSE



FLOOR PLAN

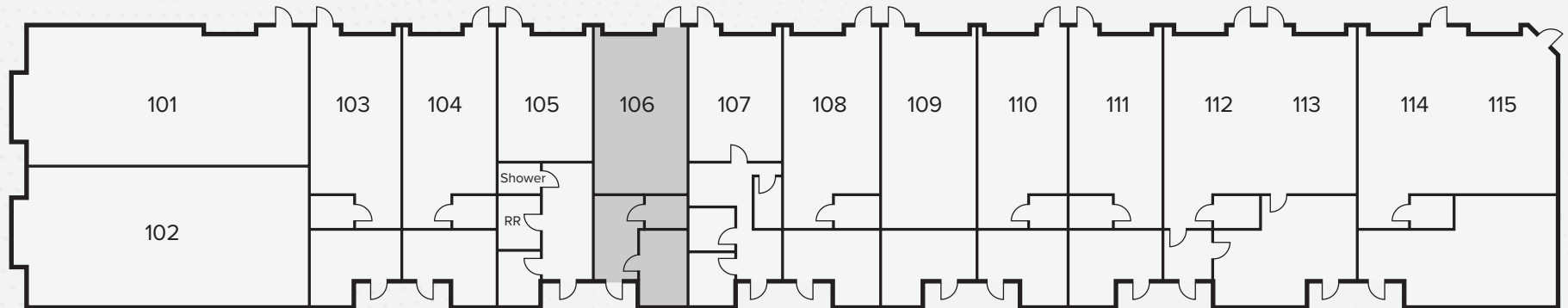

Unit 106

±1,200 RSF

40% OFFICE

RESTROOM

GRADE LEVEL DOOR

\$2.10 IG

AVAILABLE NOW

AMENITY MAP



ICS	LRC Roofing	Chickadee	Catering For All Occasions
Justo Blanket	ThermoFisher SCIENTIFIC	PACE Supply	
Wrap Delivery	T-BOR MACHINING	AVT PRODUCTIONS	SJT Tech Industries
Public Storage	National Electronic Transport	Jumpers 4 Less	Amazon USF1
California Custom	dataendure	Fresh Dish	WestFab Manufacturing Inc

3270

keller street

SANTA CLARA, CA



CONTACT US

TYLER HUYGHUE

Associate

Lic. 02244055

+1 408 790 5419

tyler.huyghue@cbre.com

NICK WHITSTONE

Senior Vice President

Lic. 01196787

+1 408 453 7438

nick.whitstone@cbre.com

The CBRE logo, consisting of the letters 'CBRE' in a bold, white, sans-serif font.

© 2026 CBRE, Inc. All rights reserved. This information has been obtained from sources believed reliable, but has not been verified for accuracy or completeness. You should conduct a careful, independent investigation of the property and verify all information. Any reliance on this information is solely at your own risk. CBRE and the CBRE logo are service marks of CBRE, Inc. All other marks displayed on this document are the property of their respective owners. Photos herein are the property of their respective owners and use of these images without the express written consent of the owner is prohibited. PMStudio_January2026