



FOR LEASE

Available Space:

± 2,413 SF

Contact:

David Mein

Senior Vice President
+1 408 891 6504
david.mein@colliers.com
CA Lic. 00956322

23 Las Colinas Ln
San Jose, CA 95119

Suite 108

- 3.3/1,000 Parking
- 18" Clear Height
- ±2,413 SF
- 20% Office balance is warehouse
- One roll up door

225 W Santa Clara St
10th Floor, Suite 1000
San Jose, CA 95113
P: +1 408 282 3800
F: +1 408 282 3855
colliers.com/siliconvalley

Copyright © 2025 Colliers International. Information herein has been obtained from sources deemed reliable, however its accuracy cannot be guaranteed. The user is required to conduct their own due diligence and verification.

Floor Plan

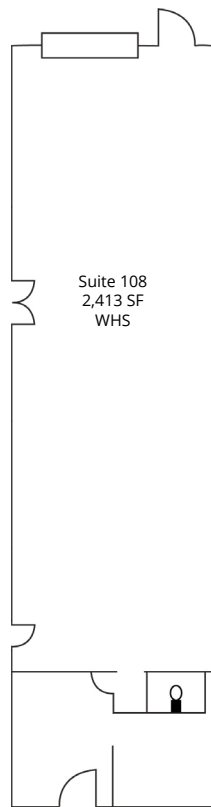
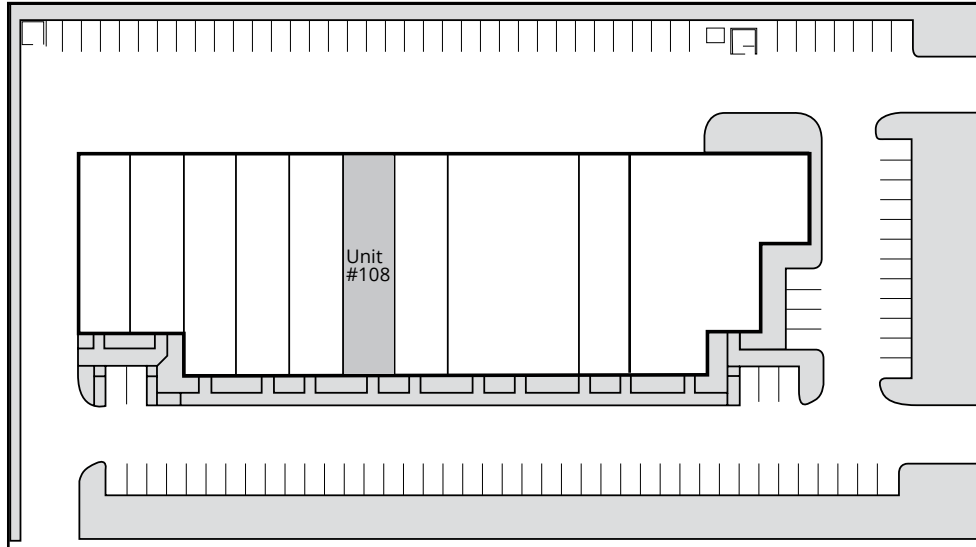

Map

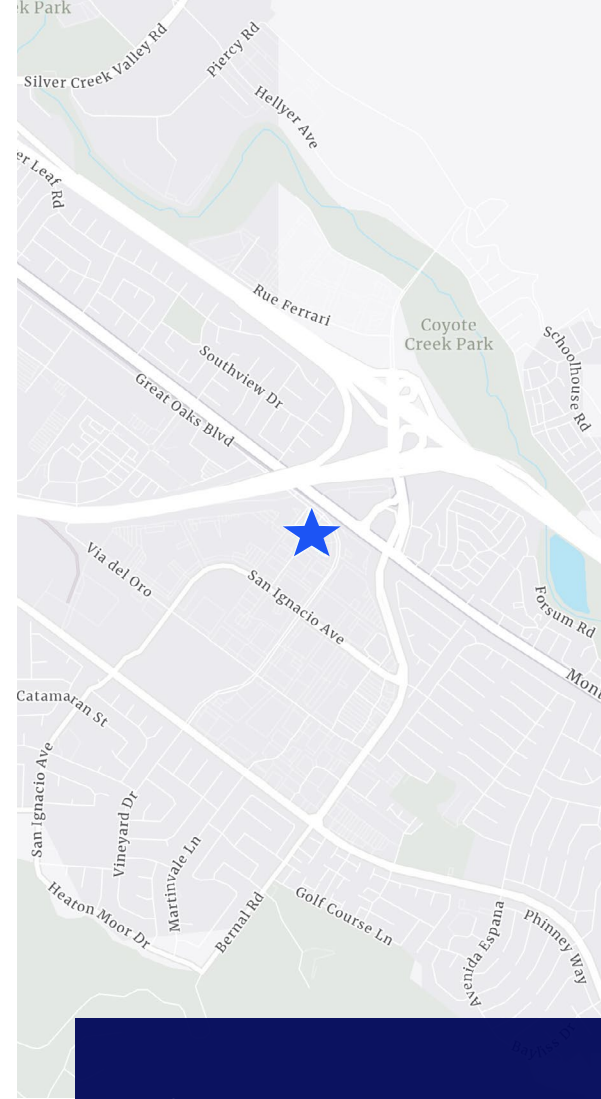
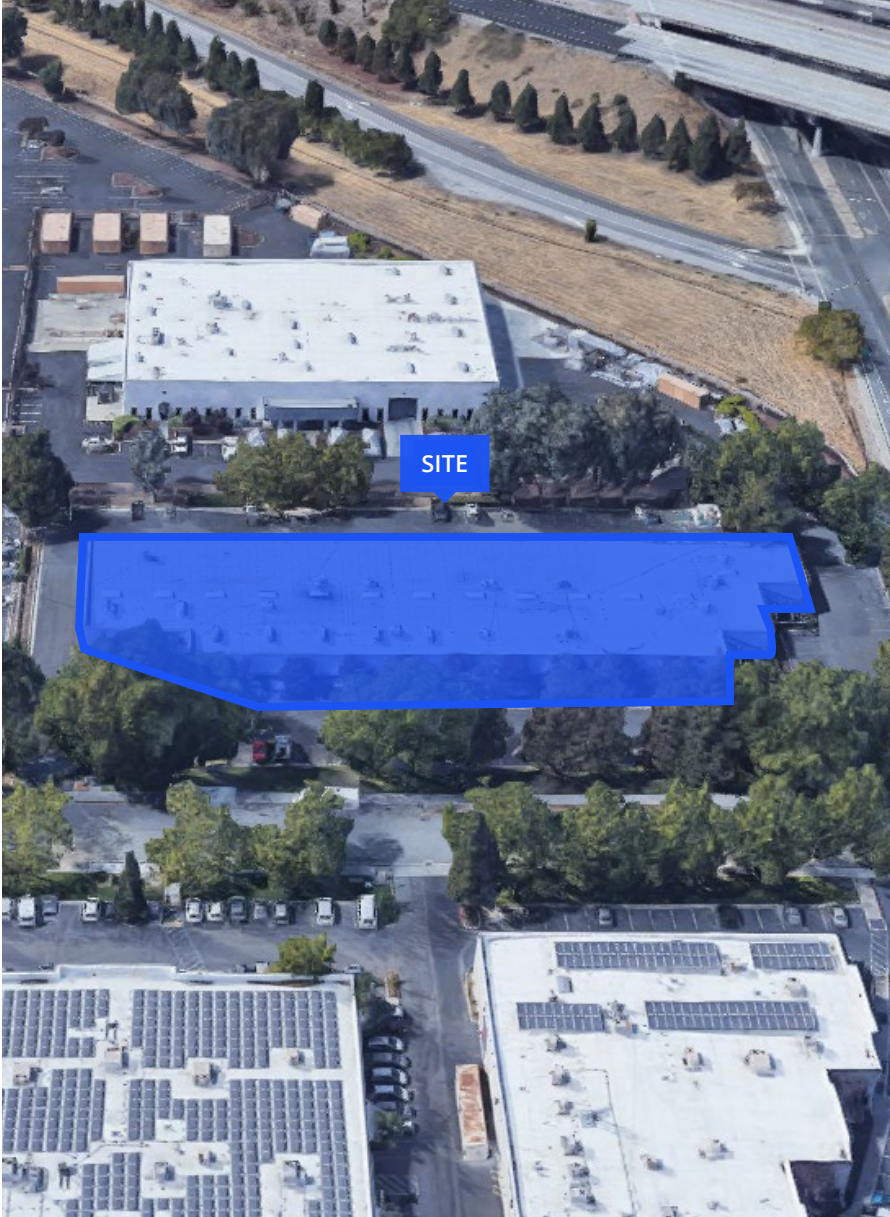

Contact:

David Mein

Senior Vice President

+1 408 891 6504

david.mein@colliers.com

CA Lic. 00956322

225 W Santa Clara St
10th Floor, Suite 1000
San Jose, CA 95113
P: +1 408 282 3800
F: +1 408 282 3855
colliers.com/siliconvalley