

Available SF 2,005 SF

Industrial For Lease

Building Size 19,101 SF



Property Name: Regal Business Park
Address: 1320 W El Segundo Blvd, Unit A, Gardena, CA 90247
Cross Streets: W El Segundo Blvd/Normandie Ave

Newly Refurbished
 Multi-Tenant Building
 1 Ground Level Loading, 14' Clearance
 Great 105 and 110 Freeway Access
 El Segundo Boulevard Frontage

Lease Rate/Mo:	\$2,005	Sprinklered:	No	Office SF / #:	250 SF
Lease Rate/SF:	\$1.00	Clear Height:	14'	Restrooms:	2
Lease Type:	Gross / Op. Ex: \$0.10	GL Doors/Dim:	1 / 10'x10'	Office HVAC:	Heat & AC
Available SF:	2,005 SF	DH Doors/Dim:	0	Finished Ofc Mezz:	0 SF
Minimum SF:	2,005 SF	A: 200 V: 220 O: 3 W:		Include In Available:	No
Prop Lot Size:	POL	Construction Type:	Masonry	Unfinished Mezz:	0 SF
Term:	Acceptable to Owner	Const Status/Year Blt:	Existing / 1978	Include In Available:	No
Sale Price:	NFS	Whse HVAC:	Yes	Possession:	Now
Sale Price/SF:	NFS	Parking Spaces: 3 / Ratio:	1.5:1	Vacant:	Yes
Taxes:		Rail Service:	No	To Show:	Call broker
Yard:	Paved	Specific Use:	Warehouse/Office	Market/Submarket:	Gardena/North Compton
Zoning:	M1			APN#:	6115-001-003

Listing Company: The Klabin Company

Agents: [Scott Andersen 310-329-9000](#), [Matt Stringfellow 310-329-9000](#)

Listing #: 44194828

Listing Date: 01/21/2026

FTCF: CB300N000S000/A0AA

Notes: Lessee to verify all information contained herein. \$1.00/SF teaser rate for the first 6 months of a 3-5 year lease. \$1.65/SF thereafter



This information supplied herein is from sources we deem reliable. It is provided without any representation, warranty or guarantee, expressed or implied as to its accuracy. Prospective Buyer or Tenant should conduct an independent investigation and verification of all matters deemed to be material, including, but not limited to, statements of income and expenses. Consult your attorney, accountant, or other prof. advisor.



KLABIN.COM

19700 S. VERMONT AVENUE, SUITE 100
TORRANCE, CA 90502

DRE 00824993

310.329.9000





SITE PLAN

INDUSTRIAL PROPERTY FOR LEASE

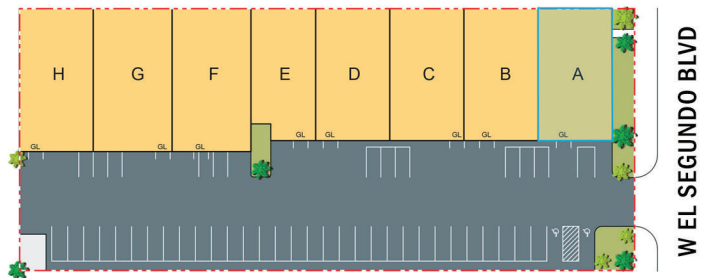
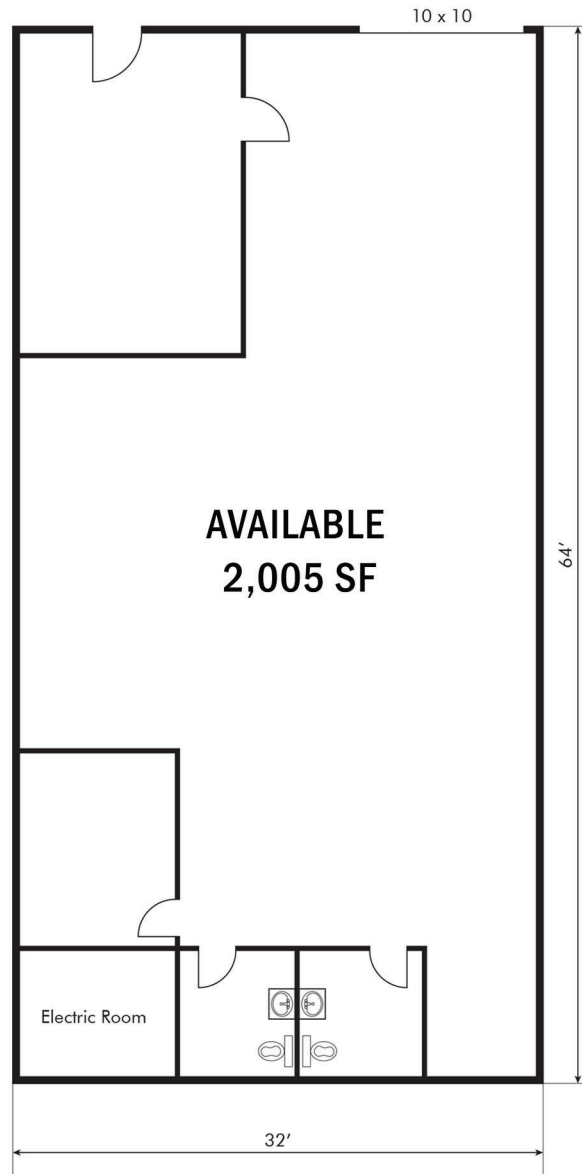

Available SF 2,600 SF

Industrial For Lease

Building Size 19,101 SF



Property Name: Regal Business Park
Address: 1320 W El Segundo Blvd, Unit B, Gardena, CA 90247
Cross Streets: W El Segundo Blvd/Normandie Ave

Newly Refurbished
 Multi-Tenant Building
 1 Ground Level Loading, 14' Clearance
 Great 105 and 110 Freeway Access
 El Segundo Boulevard Frontage

Lease Rate/Mo:	\$2,600	Sprinklered:	No	Office SF / #:	250 SF / 2
Lease Rate/SF:	\$1.00	Clear Height:	14'	Restrooms:	1
Lease Type:	Gross / Op. Ex: \$0.10	GL Doors/Dim:	1 / 10'x10'	Office HVAC:	Heat & AC
Available SF:	2,600 SF	DH Doors/Dim:	0	Finished Ofc Mezz:	0 SF
Minimum SF:	2,600 SF	A: 200 V: 220 O: 3 W:		Include In Available:	No
Prop Lot Size:	POL	Construction Type:	Masonry	Unfinished Mezz:	0 SF
Term:	Acceptable to Owner	Const Status/Year Blt:	Existing / 1978	Include In Available:	No
Sale Price:	NFS	Whse HVAC:	Yes	Possession:	Now
Sale Price/SF:	NFS	Parking Spaces: 3 / Ratio:	1.2:1	Vacant:	Yes
Taxes:		Rail Service:	No	To Show:	Call broker
Yard:	Paved	Specific Use:	Warehouse/Office	Market/Submarket:	Gardena/North Compton
Zoning:	M1			APN#:	6115-001-003

Listing Company: The Klabin Company

Agents: [Scott Andersen 310-329-9000](mailto:Scott.Andersen@klabin.com), [Matt Stringfellow 310-329-9000](mailto:Matt.Stringfellow@klabin.com)

Listing #: 44194871

Listing Date: 01/21/2026

FTCF: CB300N000S000/A0AA

Notes: Lessee to verify all information contained herein. \$1.00/SF teaser rate for the first 6 months of a 3-5 year lease. \$1.65/SF thereafter



This information supplied herein is from sources we deem reliable. It is provided without any representation, warranty or guarantee, expressed or implied as to its accuracy. Prospective Buyer or Tenant should conduct an independent investigation and verification of all matters deemed to be material, including, but not limited to, statements of income and expenses. Consult your attorney, accountant, or other prof. advisor.



KLABIN.COM

19700 S. VERMONT AVENUE, SUITE 100
TORRANCE, CA 90502

DRE 00824993

310.329.9000





SITE PLAN

INDUSTRIAL PROPERTY FOR LEASE

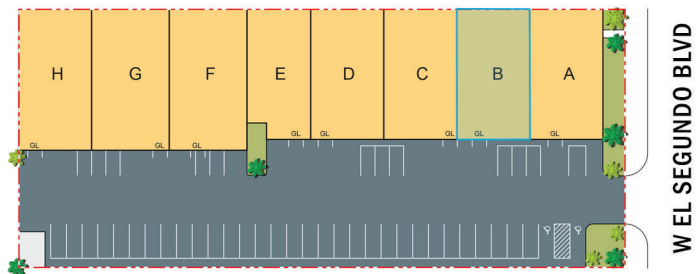
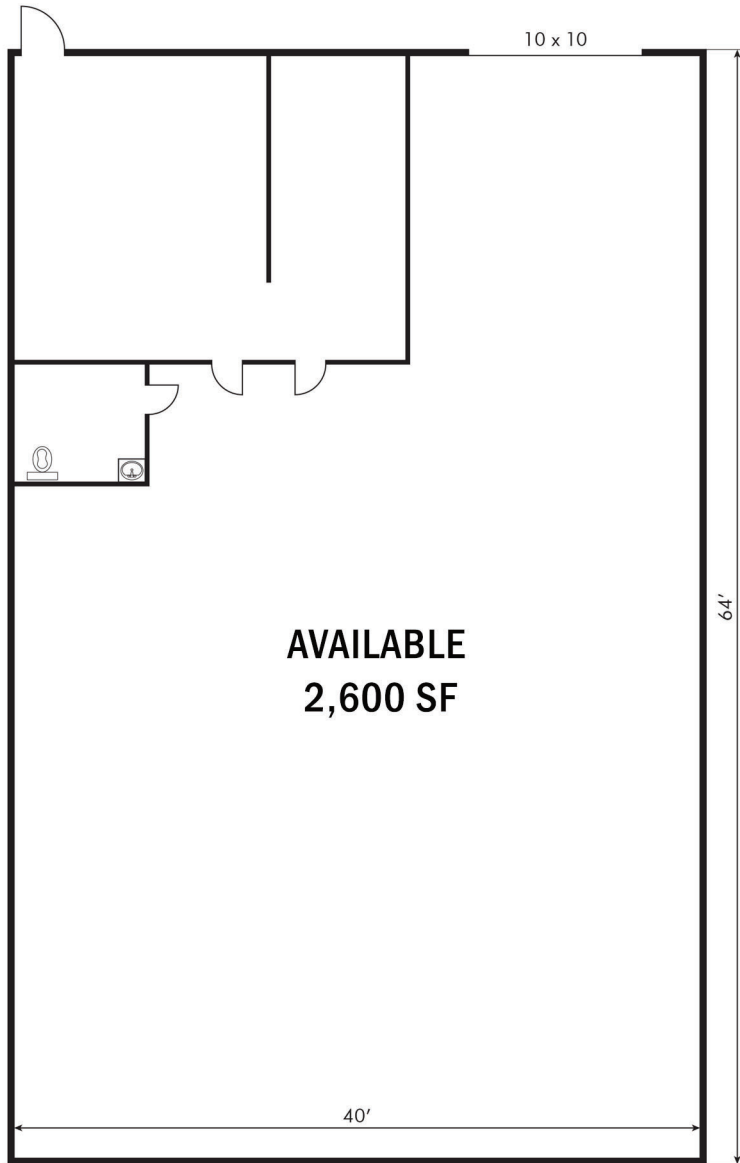

Available SF 2,080 SF

Industrial For Lease

Building Size 19,101 SF



Property Name: Regal Business Park
Address: 1320 W El Segundo Blvd, Unit C, Gardena, CA 90247
Cross Streets: W El Segundo Blvd/Normandie Ave

Newly Refurbished
 Multi-Tenant Building
 1 Ground Level Loading, 14' Clearance
 Great 105 and 110 Freeway Access
 El Segundo Boulevard Frontage

Lease Rate/Mo:	\$2,080	Sprinklered:	No	Office SF / #:	250 SF
Lease Rate/SF:	\$1.00	Clear Height:	14'	Restrooms:	1
Lease Type:	Gross / Op. Ex: \$0.10	GL Doors/Dim:	1 / 10'x10'	Office HVAC:	Heat & AC
Available SF:	2,080 SF	DH Doors/Dim:	0	Finished Ofc Mezz:	0 SF
Minimum SF:	2,080 SF	A: 200 V: 220 O: 3 W:		Include In Available:	No
Prop Lot Size:	POL	Construction Type:	Masonry	Unfinished Mezz:	0 SF
Term:	Acceptable to Owner	Const Status/Year Blt:	Existing / 1978	Include In Available:	No
Sale Price:	NFS	Whse HVAC:	Yes	Possession:	Now
Sale Price/SF:	NFS	Parking Spaces: 3 / Ratio:	1.4:1	Vacant:	Yes
Taxes:		Rail Service:	No	To Show:	Call broker
Yard:	Paved	Specific Use:	Warehouse/Office	Market/Submarket:	Gardena/North Compton
Zoning:	M1			APN#:	6115-001-003

Listing Company: The Klabin Company

Agents: [Scott Andersen 310-329-9000](#), [Matt Stringfellow 310-329-9000](#)

Listing #: 44194851

Listing Date: 01/21/2026

FTCF: CB300N000S000/A0AA

Notes: Lessee to verify all information contained herein. \$1.00/SF teaser rate for the first 6 months of a 3-5 year lease. \$1.65/SF thereafter.



This information supplied herein is from sources we deem reliable. It is provided without any representation, warranty or guarantee, expressed or implied as to its accuracy. Prospective Buyer or Tenant should conduct an independent investigation and verification of all matters deemed to be material, including, but not limited to, statements of income and expenses. Consult your attorney, accountant, or other prof. advisor.



KLABIN.COM

19700 S. VERMONT AVENUE, SUITE 100
TORRANCE, CA 90502

DRE 00824993

310.329.9000





SITE PLAN

INDUSTRIAL PROPERTY FOR LEASE

