

W:\2019 Land Projects\Laughner Patel W Manchester Site\CADD Phase II\LD Plans - Phase 2\RENDERING\Westgate-PH2-SITE-MARKETING-EXH-1(3-18-25).dwg, 3/19/2025 2:02:18 PM, briley

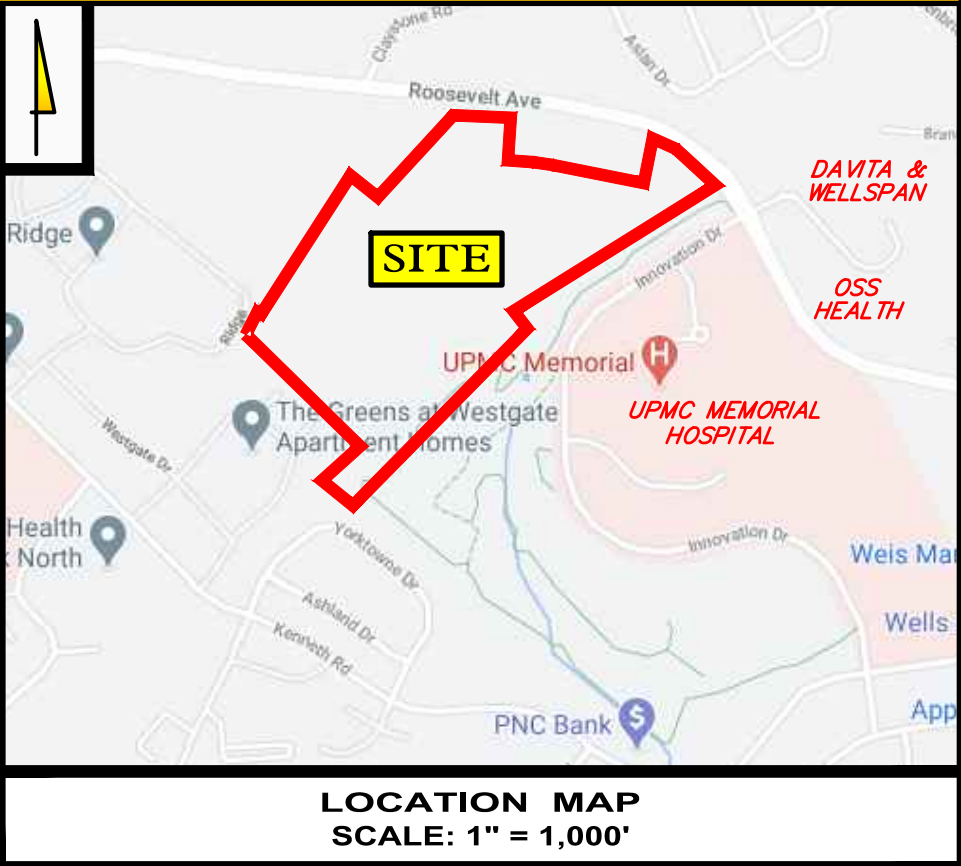

WILLIAMS
SITE CIVIL, LLC
WE ENGINEER SAVINGS
2325 PAXTON CHURCH ROAD
HARRISBURG, PA 17110
PH: 717-412-0142
FAX: 717-540-7958

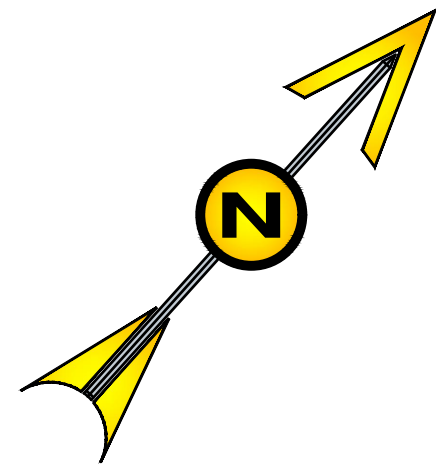

**WESTGATE CAMPUS
OVERALL SITE PLAN**
OWNER / APPLICANT
BAM WESTGATE DRIVE THREE, LLC
4045 THICKET LANE
HARRISBURG, PA 17110
TELEPHONE: (610) 334-7435
WEST MANCHESTER TOWNSHIP
YORK COUNTY, PA

ALL PLANS, DOCUMENTS AND
COMPUTER FILES RELATED TO THIS
PROJECT ARE THE PROPERTY OF
WILLIAMS SITE CIVIL, LLC. WILLIAMS
SITE CIVIL, LLC RETAINS ALL COMMON
LAW, STATUTE AND OTHER RESERVED
RIGHTS INCLUDING THE COPYRIGHT
THEREBY.

REPRODUCTION OF THE MATERIAL
HEREON OR SUBSTANTIAL USE
WITHOUT WRITTEN PERMISSION OF
WILLIAMS SITE CIVIL, LLC VIOLATES
THE COPYRIGHT LAWS OF THE
UNITED STATES AND WILL BE
SUBJECT TO LEGAL PROSECUTION.

© 2024 WILLIAMS SITE CIVIL, LLC

REVISIONS			

DESIGN BY: X.X.X. DRAWN BY: B.E.R. CHECKED BY: D.S.G.

WSC PROJECT NUMBER:
2023LPYORK

SCALE: 1" = 120'

DATE: MARCH 19, 2025

EXH-1

WESTGATE CAMPUS

WEST MANCHESTER TOWNSHIP YORK COUNTY, PA