

SCHOOL & CHURCH SPACE FOR LEASE

201 E BENNETT AVENUE, GLENDORA, CA



The Offering

The United Methodist Church of Glendora is offering the opportunity to lease church and second floor school space within its Church campus. The offering provides exclusive use of second floor classrooms, kitchenette, and patio for a school during traditional school days and hours. The Church space is shared use within specified days and hours. Sanctuary, Social Hall, several classrooms, office, kitchen, and on-site parking lot. This space would work great for private, public/charter school programs, and churches looking for space to lease. **No Preschools.**

RILEY ROHDE 213.808.4764 | riley.rohde@kidder.com | LIC N° 02207141

ROBERT FLETCHER 213.225.7246 | robert.fletcher@kidder.com | LIC N° 01706060

ERIC KNOWLES 213.225.7213 | eric.knowles@kidder.com | LIC N° 00944210

KIDDER.COM

This information supplied herein is from sources we deem reliable. It is provided without any representation, warranty, or guarantee, expressed or implied as to its accuracy. Prospective Buyer or Tenant should conduct an independent investigation and verification of all matters deemed to be material, including, but not limited to, statements of income and expenses. Consult your attorney, accountant, or other professional advisor.

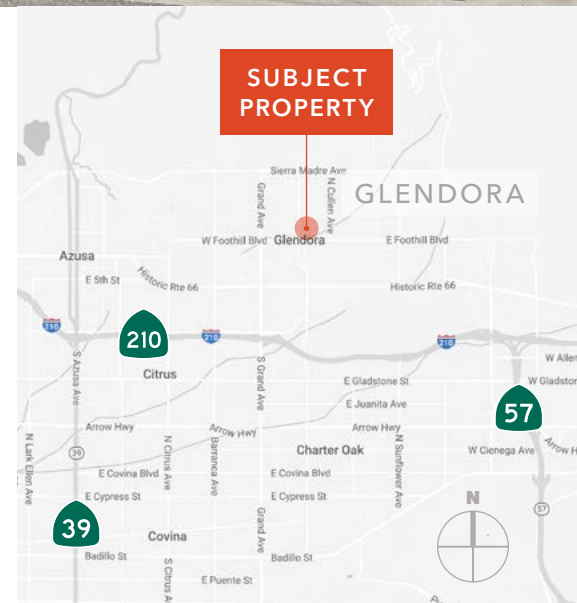

km Kidder
Mathews

SCHOOL & CHURCH SPACE FOR LEASE

PREMISES

SCHOOL SPACE:	School Space: ±4,444 SF, 5 second floor classrooms, kitchenette, and patio area Available: Traditional School Days and Hours
CHURCH SPACE:	Church Space: ±12,000 SF, Sanctuary (seats ±225), Foyer, classrooms, office, social hall (seats ±200), and kitchen. Available: Sundays from 3:00pm - 9:00pm, Saturdays, and Various Weeknights
UTILITIES:	Tenant to pay its share of sewer, water, gas, electric, and trash.
PARKING:	On-site parking
RESTROOMS:	2 restrooms in the Upper Education level (one single stall and one with two stalls); 2 restrooms on the Main Sanctuary level (one single stall and one ADA-compliant); and 2 restrooms on the Lower Sanctuary level (one ADA-compliant and one with two stalls).
APPROVALS:	A Conditional Use Permit is likely for school use. (verify with city)
SHARED VS. EXCLUSIVE:	Landlord requires shared use of some classrooms, sanctuary, assembly hall, and kitchen
NON-PROFIT VS. FOR-PROFIT:	Non-profit is preferred; Landlord will consider for-profit (Tenant to be responsible for any increase in property taxes)
LEASE RATE:	School space: \$2.00 psf mg Church space: \$3,000 - \$6,500/mo + share of utilities



FOR LEASING INFORMATION PLEASE CONTACT

RILEY ROHDE
213.808.4764
rileyrohde@kidder.com
LIC N°02207141

ROBERT FLETCHER
213.225.7246
robert.fletcher@kidder.com
LIC N° 01706060

ERIC KNOWLES
213.225.7213
eric.knowles@kidder.com
LIC N° 00944210

KIDDER.COM

This information supplied herein is from sources we deem reliable. It is provided without any representation, warranty, or guarantee, expressed or implied as to its accuracy. Prospective Buyer or Tenant should conduct an independent investigation and verification of all matters deemed to be material, including, but not limited to, statements of income and expenses. Consult your attorney, accountant, or other professional advisor.



SITE PLAN

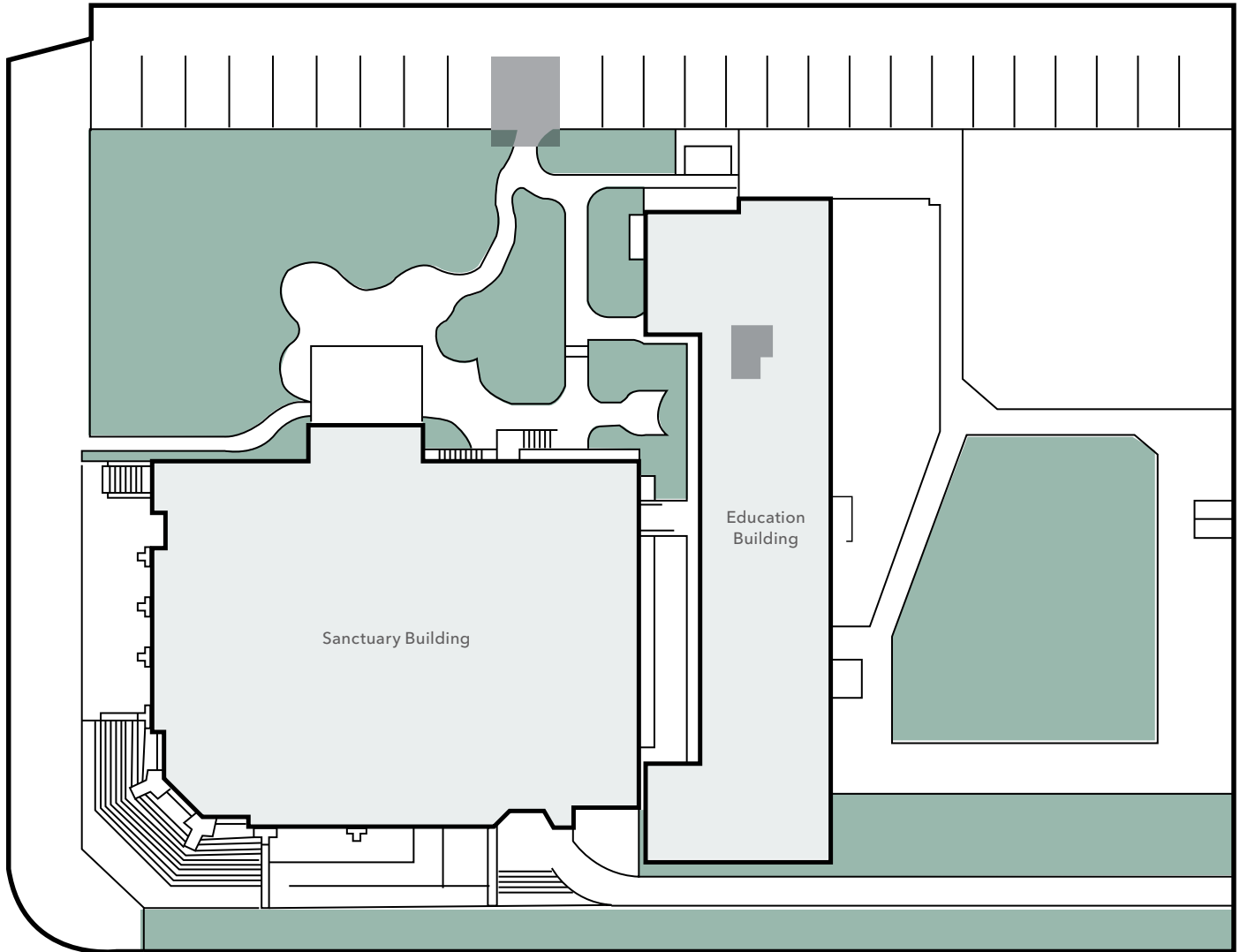

FOR LEASING INFORMATION PLEASE CONTACT

RILEY ROHDE
213.808.4764
rileyrohde@kidder.com
LIC N° 02207141

ROBERT FLETCHER
213.225.7246
robert.fletcher@kidder.com
LIC N° 01706060

ERIC KNOWLES
213.225.7213
eric.knowles@kidder.com
LIC N° 00944210

KIDDER.COM

This information supplied herein is from sources we deem reliable. It is provided without any representation, warranty, or guarantee, expressed or implied as to its accuracy. Prospective Buyer or Tenant should conduct an independent investigation and verification of all matters deemed to be material, including, but not limited to, statements of income and expenses. Consult your attorney, accountant, or other professional advisor.

SANCTUARY BUILDING

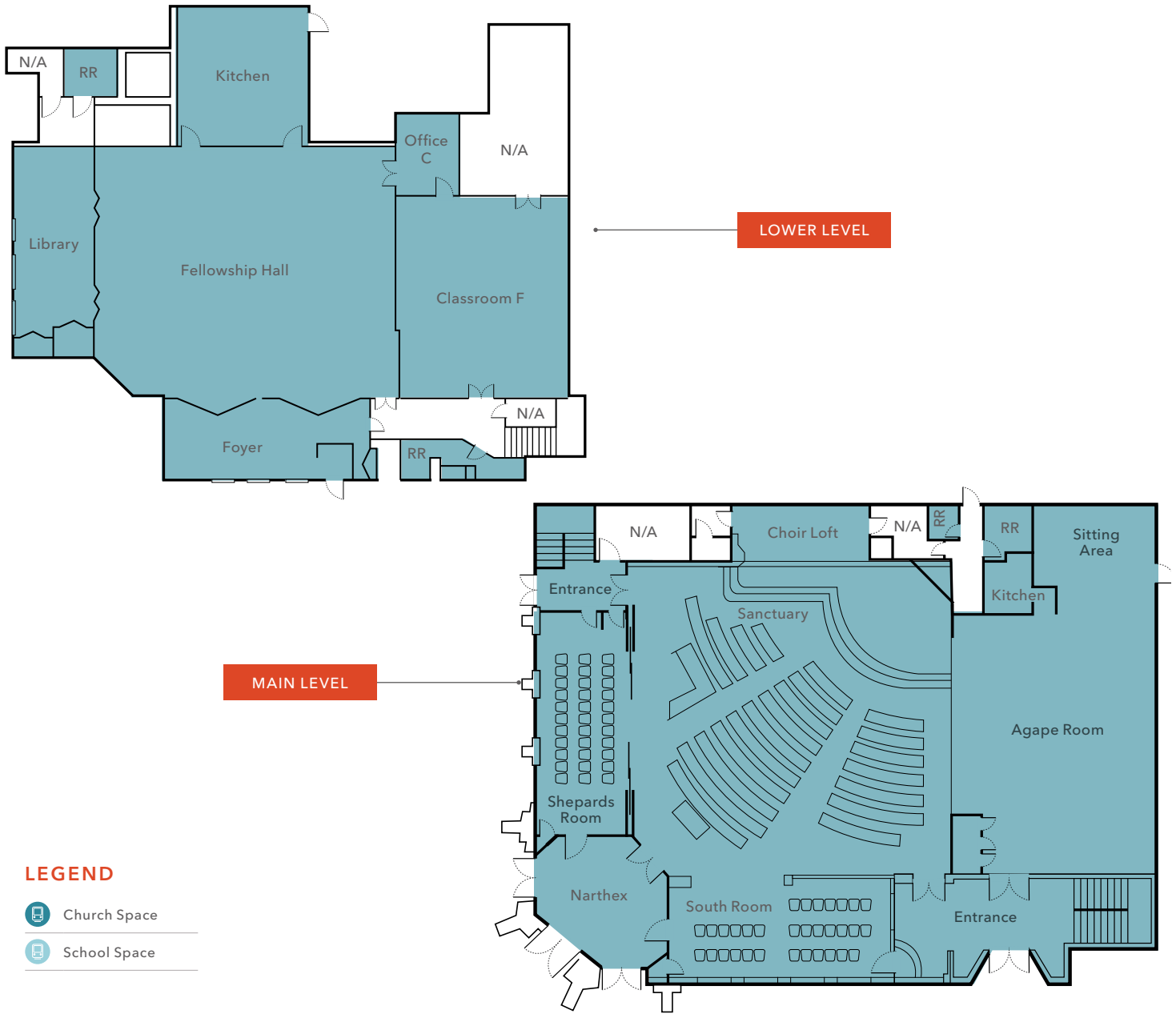

FOR LEASING INFORMATION PLEASE CONTACT

RILEY ROHDE
213.808.4764
rileyrohde@kidder.com
LIC N° 02207141

ROBERT FLETCHER
213.225.7246
robert.fletcher@kidder.com
LIC N° 01706060

ERIC KNOWLES
213.225.7213
eric.knowles@kidder.com
LIC N° 00944210

KIDDER.COM

This information supplied herein is from sources we deem reliable. It is provided without any representation, warranty, or guarantee, expressed or implied as to its accuracy. Prospective Buyer or Tenant should conduct an independent investigation and verification of all matters deemed to be material, including, but not limited to, statements of income and expenses. Consult your attorney, accountant, or other professional advisor.

UPPER LEVEL

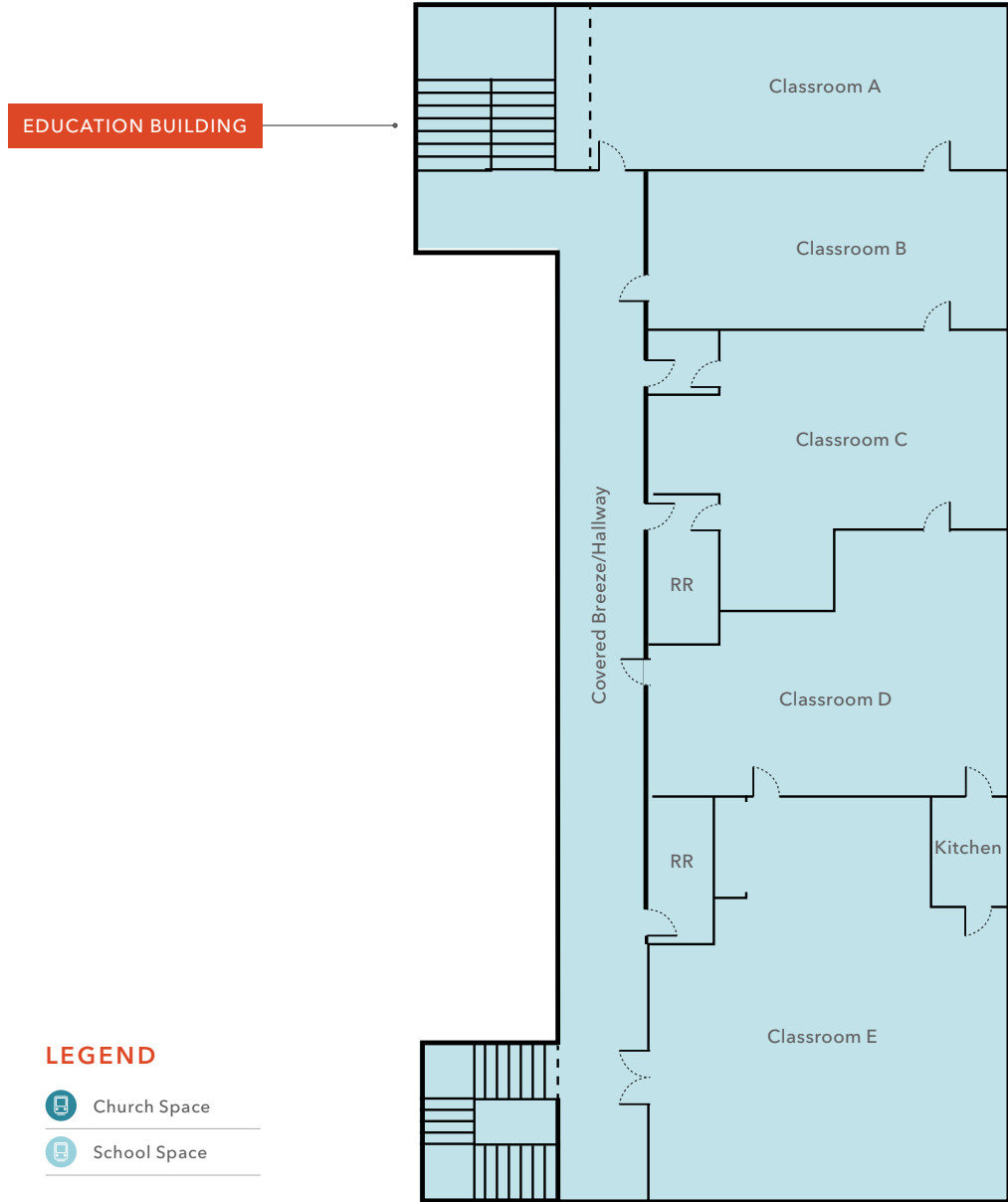

FOR LEASING INFORMATION PLEASE CONTACT

RILEY ROHDE
213.808.4764
rileyrohde@kidder.com
LIC N° 02207141

ROBERT FLETCHER
213.225.7246
robert.fletcher@kidder.com
LIC N° 01706060

ERIC KNOWLES
213.225.7213
eric.knowles@kidder.com
LIC N° 00944210

KIDDER.COM

This information supplied herein is from sources we deem reliable. It is provided without any representation, warranty, or guarantee, expressed or implied as to its accuracy. Prospective Buyer or Tenant should conduct an independent investigation and verification of all matters deemed to be material, including, but not limited to, statements of income and expenses. Consult your attorney, accountant, or other professional advisor.

SCHOOL & CHURCH SPACE FOR LEASE



FOR LEASING INFORMATION PLEASE CONTACT

RILEY ROHDE
213.808.4764
rileyrohde@kidder.com
LIC N° 02207141

ROBERT FLETCHER
213.225.7246
robert.fletcher@kidder.com
LIC N° 01706060

ERIC KNOWLES
213.225.7213
eric.knowles@kidder.com
LIC N° 00944210

KIDDER.COM

This information supplied herein is from sources we deem reliable. It is provided without any representation, warranty, or guarantee, expressed or implied as to its accuracy. Prospective Buyer or Tenant should conduct an independent investigation and verification of all matters deemed to be material, including, but not limited to, statements of income and expenses. Consult your attorney, accountant, or other professional advisor.

