



PREMIER EQUITIES

1220

BROADWAY





HISTORIC ELEGANCE, MODERN FUNCTION

Constructed in 1915, 1220 Broadway is a 90,000 boutique office building located in the heart of NoMad, one of Manhattan's most desirable live-work-play neighborhoods. Situated on the corner of Broadway and 30th Street, the building offers premium full-floor office suites averaging approximately 10,843 RSF square feet. Each unit features oversized windows, exceptional ceiling heights, and flexible open layouts — ideal for modern creative and professional tenants.

1220 Broadway also includes a newly upgraded lobby and high-speed elevators. With a prime NoMad location steps from Madison Square Park, top-tier restaurants, and major subway lines, the building provides an inspiring and convenient setting for dynamic businesses. The natural light and architectural charm make this a standout address for tenants seeking elevated workspace in a central Midtown South location.

THE NEIGHBORHOOD

Located at the heart of one of New York's fastest-evolving districts, 1220 Broadway offers access to the outdoor vibrancy of the NoMad Piazza, premier dining, and an ever-growing creative community — all just outside your door.

Barlume



Madison Square Park



La Pecora Bianca



Pura Vida



The Smith



The Med



SPACE DETAILS

SIZE

| | |
|---------|---------|
| Space A | 800 sf |
| Space B | 1250 sf |
| Space C | 550 sf |
| Space D | 500 sf |

CEILING HEIGHTS

13 sf

FRONTAGE

25 ft on Broadway
35 ft on 30th Street

AVAILABILITY

Immediate

SPACE FEATURES

- Located in Manhattan's hottest live-work-play neighborhood
- Within a newly designed pedestrian plaza with expanded sidewalks, seating, and lush landscaping — delivering constant foot traffic.
- Steps from multiple subway lines (N/R/W, 6, F, 1) and Penn Station. Heavy commuter, residential, and tourist traffic all converge in the neighborhood.
- Newly renovated spaces with new storefronts, floor, HVAC, etc.

NEIGHBORS

Quality Pizza, Bao Sugar, Teso Life, Nana's Green Tea, Irving Farm New York, NYMA, Ayza Wine & Chocolate Bar, Life Hotel New York, JKS Restaurants, Upside Pizza, Swingers, Electric Shuffle, Virgin Hotels, Copper Mug Coffee, MADE Hotel, Zaytinya, Ace Hotel New York, Koloman, Venchi, Scarpetta, Olddays, 7th Street Burger, CHAPS Deli, Aesop, NoMad Hotel, Cha Cha Matcha, Wedding Atelier, The Evelyn, SG Pura Vida, Anita, Malin + Goetz, The Smith, Starbucks, Hill Country, The Ivory Peacock, La Pecora Bianca, CVS Pharmacy, PetSmart, Escape the Room, MoMath (National Museum of Mathematics), Madison Square Park.

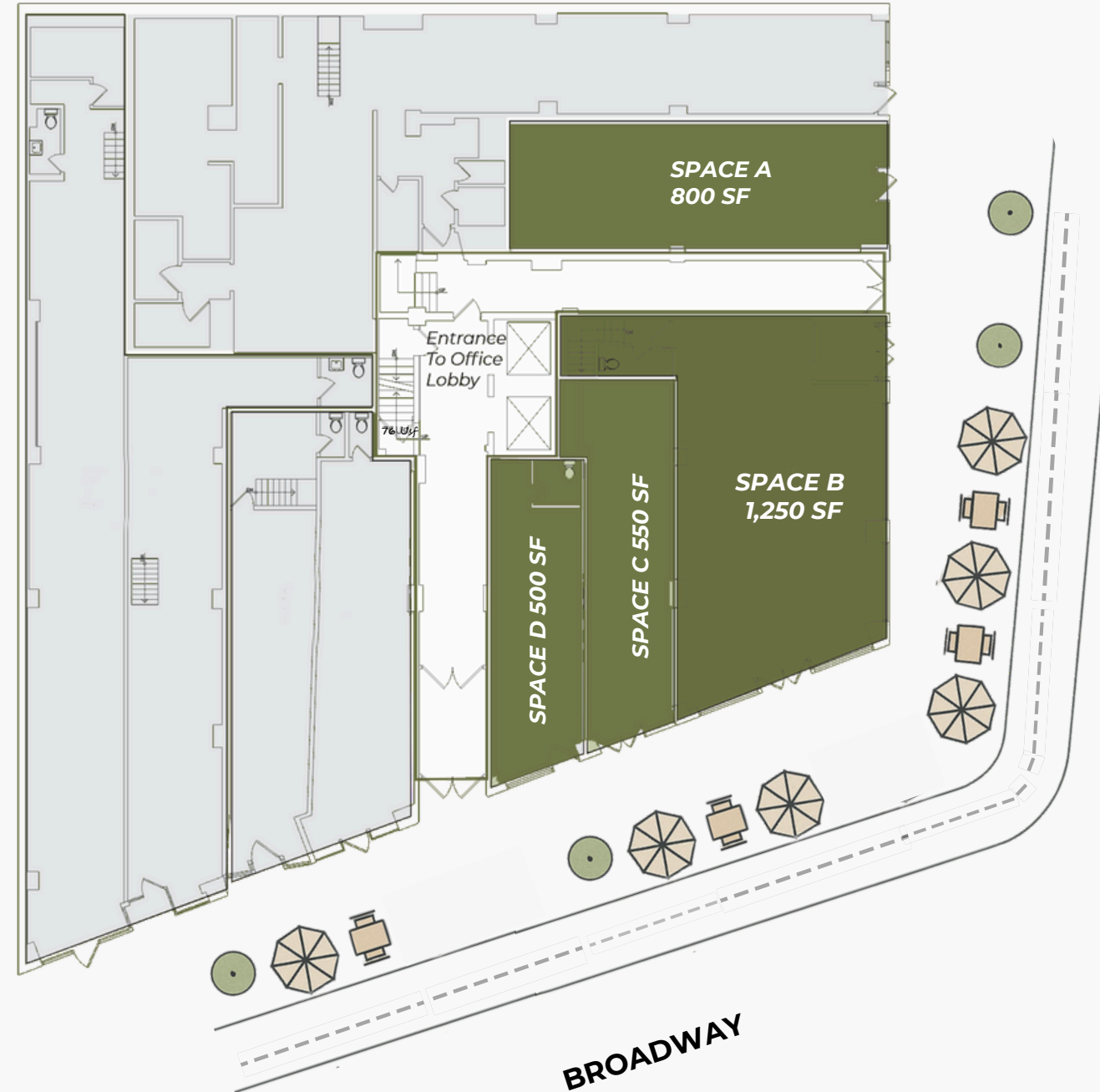

THE NEIGHBORHOOD MAP



SURROUNDED
BY ICONIC
BRANDS
&
EVERYDAY
ESSENTIALS



TRANSPORTATION STATISTICS

- 25,000,000 annual passengers
- **R** **W** stations (28th St and 23rd St) & **F** (23rd St)
- 4,544,976 annual passengers
- **1** station (28th St and 7th Ave)
- 7,214,293 annual passenger
- **6** station (Park Ave and 28th St)
- Penn Station - 650,000 daily passengers



NOMAD DEVELOPMENT MAP

| HOTEL | OFFICE | RESIDENTIAL |
|--|---|---|
| 1. 292-296 Fifth Avenue 20 Stories, 150 Keys | 1. 1241 Broadway 180,000 SF | 1. 9 30th St 21 Stories, 54 Units 41,992 SF |
| 2. 11-13 East 31st St 31 Stories, 248 Keys | 2. 3 West 29th St 600,000 SF | 2. 15 East 30th St 51 Stories, 756 FT 360,000 SF, 180 apartments |
| 3. 16-18 East 30th St 21 Stories, 240 FT | 3. 11 West 29th St | 3. 281 Fifth Ave 220,000 SF, 52 Stories, 141 Units |
| 4. Virgin Hotel - 1205 Broadway 460 Keys | 4. 1165 Broadway 50,000 SF Office | 4. Five Points Development 260-264 Fifth Ave 150,018 SF, 54 Stories 41 Units |
| 5. Moxy Hotel 350 Keys | 5. 1 Madison Ave 1.4M SF Office | 5. 277 Fifth Ave 130 Units |
| 6. The Ritz Carlton 1185 Broadway 250 Keys | 6. 1250 Broadway Nomad Tower 646,000 SF | 6. 145 Madison Ave 21 Stories, 210 SF 70 Units |
| 7. 250 5th Ave 141 Keys | | |

HOTEL ROOMS
2,497
KEYS

RESIDENCES
616
UNITS

OFFICE
1.3M
SQ FT

FOR MORE INFORMATION CONTACT:

DAVID JACOBI

P 212 421 3634

M 917 992 9215

david@premierequities.com



PREMIER EQUITIES