



Paramount Saw

PUBLIC MARKET

16493 PARAMOUNT BLVD, PARAMOUNT CA
90723

±8,364 SF AVAILABLE TO LEASE

Property Highlights



Up to \pm 8,364 SF single/multi-tenant retail space available



Newly renovated space in the heart of a bustling community



Very walkable location with walk score of 79



On-Site parking



Signage available



Approx. 24,162 VPD





Conceptual Site Plan*

- Tenant Space
- Seating Area
- Community/Museum Area
- Landscape

Area	SF
1 Outdoor Community Space	1,000
2 Community Room	1,567 S
3 Museum Area	1,069
4 Tenant 1	1,265
5 Outdoor Patio	790
6 Tenant 3	1,150
7 Indoor Eating Area	2,165
8 Tenant 4	389
9 Tenant 2	1,106
10 Landscape	

*Subject to change



PARAMOUNT AVE.

The Local Area



\$109,991

average household income
within 2 miles



141,843

people within 2 miles



20-39

is the majority age of
the local population



7,658

businesses within 3 miles
with 71,227 employees



42,305

households within 2 miles



Gather Around the Hay Tree

Creating a community a
hub for this generation,
and generations to come.

Paramount was once known as the “The Milk Shed of Los Angeles” and “Hay Capital” of the world. There were over 25,000 milk cows in the area and the price of hay on the commodity market was set for the region’s dairies each morning at the Hay Tree, a camphor tree planted in the late 19th century. The Hay Tree the only reminder of the area’s busy hay and dairy industry, is one of eleven trees designated as California Historical Landmarks.

We are now creating a community space around this historic sight to ensure that it is enjoyed by generations to come, just as it was generations ago.



Gather Around the Hay Tree

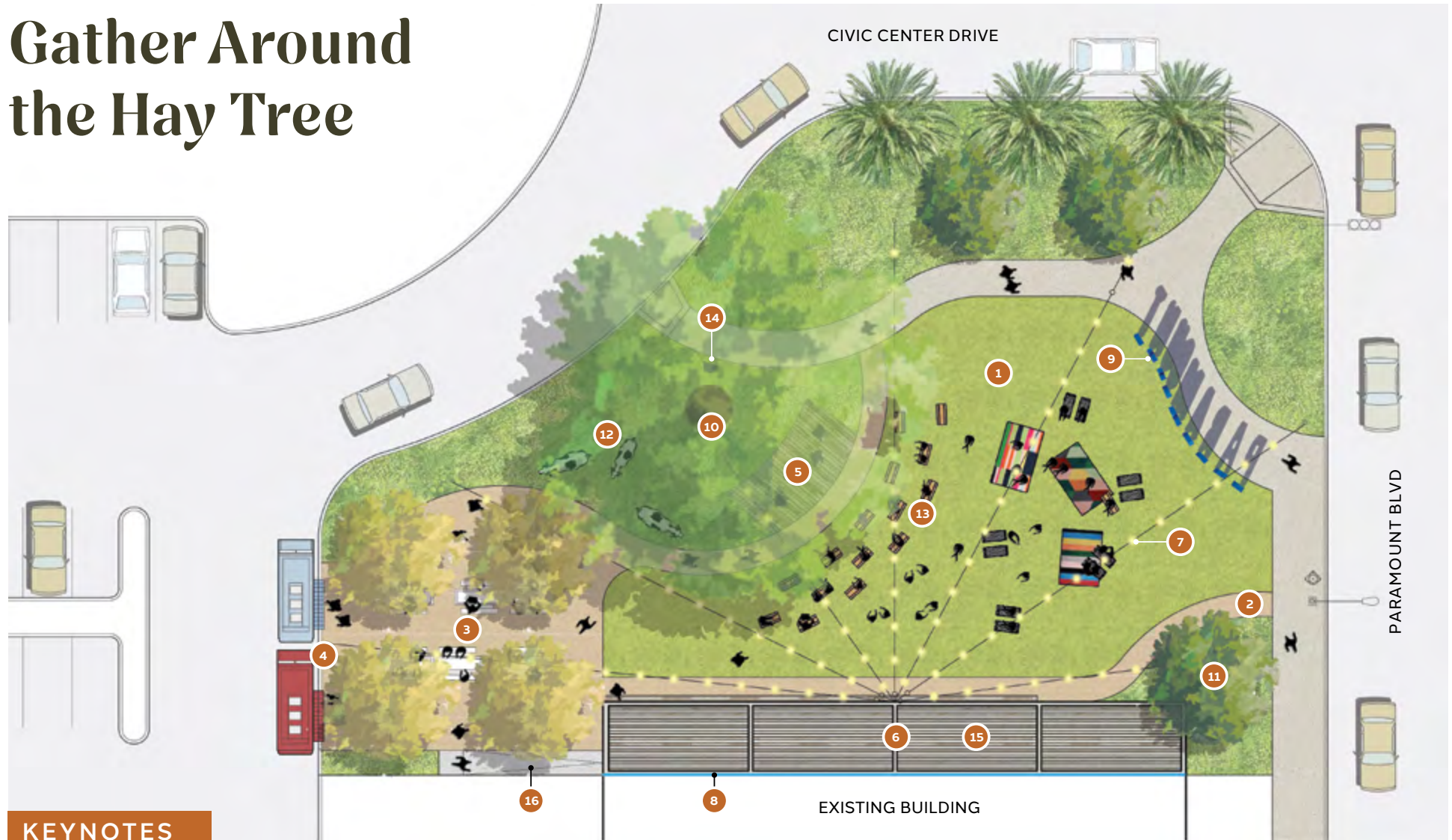

KEYNOTES

- | | | | |
|--|---|--|-------------------------------------|
| 1. Flexible lawn | 5. Permanent stage | 9. Oversized letters
"Paramount" City signage | 13. Hay bales and lawn furniture |
| 2. Decomposed granite paving | 6. Overhead structure with
integrated lighting | 10. Existing Hay Tree | 14. Hay Tree historic marker plaque |
| 3. Tree grove with picnic tables | 7. Overhead string lights | 11. Existing tree | 15. Dining platform |
| 4. Food truck curbside parking for
special events | 8. Colorful mural on building facade | 12. 3-dimensional Cow sculpture art | 16. ADA ramp |



Paramount Saw

PUBLIC MARKET

For more information, please contact:

JUSTIN MCMAHON

Lic. 01721162
+1 949 725 8589
justin.mcmahon@cbre.com

JAMIE BROOKS

Lic. 01434718
+1 310 363 4881
jamie.brooks@cbre.com

SAM AARON

Lic. 01828428
+1 818 730 1374
sam.aaron@cbre.com

© 2025 CBRE, Inc. All rights reserved. This information has been obtained from reliable sources but has not been verified for accuracy or completeness. CBRE, Inc. makes no guarantee, representation, or warranty and accepts no responsibility or liability for the accuracy, completeness, or reliability of the information contained herein. You should conduct a careful, independent investigation of the property and verify all information. Any reliance on this information is solely at your own risk. CBRE and the CBRE logo are service marks of CBRE, Inc. All other marks displayed on this document are the property of their respective owners, and the use of such marks does not imply any affiliation with or endorsement of CBRE. Photos herein are the property of their respective owners. Use of these images without the express written consent of the owner is prohibited.

