



**FOR LEASE**

# Freestanding Corner Building with Drive-Thru

1600 Hempstead Turnpike | East Meadow, NY



# Freestanding Corner Building with Drive-Thru

1600 Hempstead Turnpike | East Meadow, NY

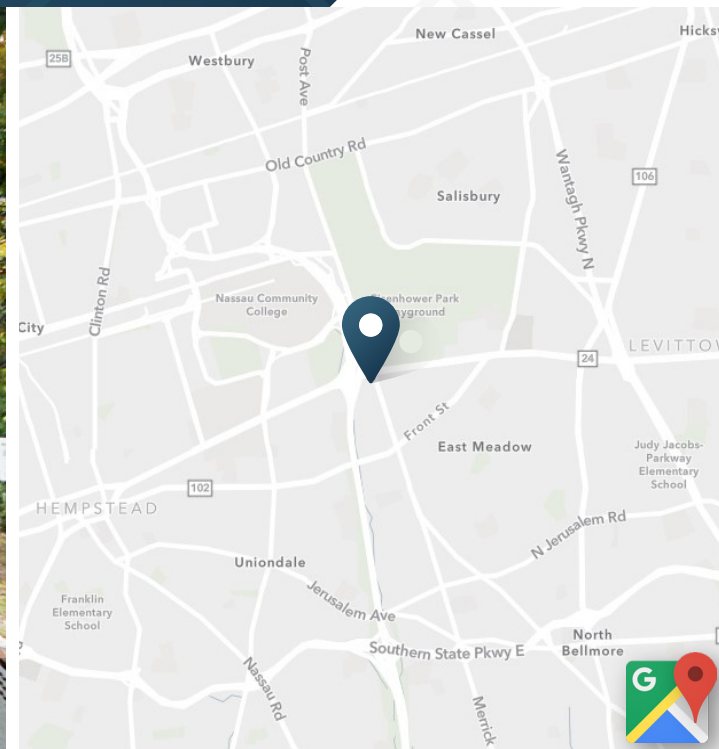

**FOR LEASE**

4,102 SF

Building Size

0.90 AC

Land Size

June 2026

Possession

Contact Broker

Asking Rent

## DESCRIPTION

- Signalized, hard corner intersection
- Former TD Bank with triple drive-thru
- 32 dedicated parking spaces
- Ingress/egress from Hempstead Turnpike and Merrick Avenue
- Close proximity to Meadowbrook State Parkway, Hofstra University, & Nassau Community College
- \$177,913 average household income within 5 mile radius
- Pylon signage available
- [Town of Hempstead BZO, NY X Business Districts \(X\) \(CLICK\)](#)

## NEARBY RETAILERS



## TRAFFIC COUNTS

Meadowbrook Parkway N	125,430 VPD
Hempstead Turnpike	44,264 VPD
Merrick Avenue	13,820 VPD

Year: 2024 | Source: Esri

# Freestanding Corner Building with Drive-Thru

1600 Hempstead Turnpike | East Meadow, NY



# Freestanding Corner Building with Drive-Thru

1600 Hempstead Turnpike | East Meadow, NY

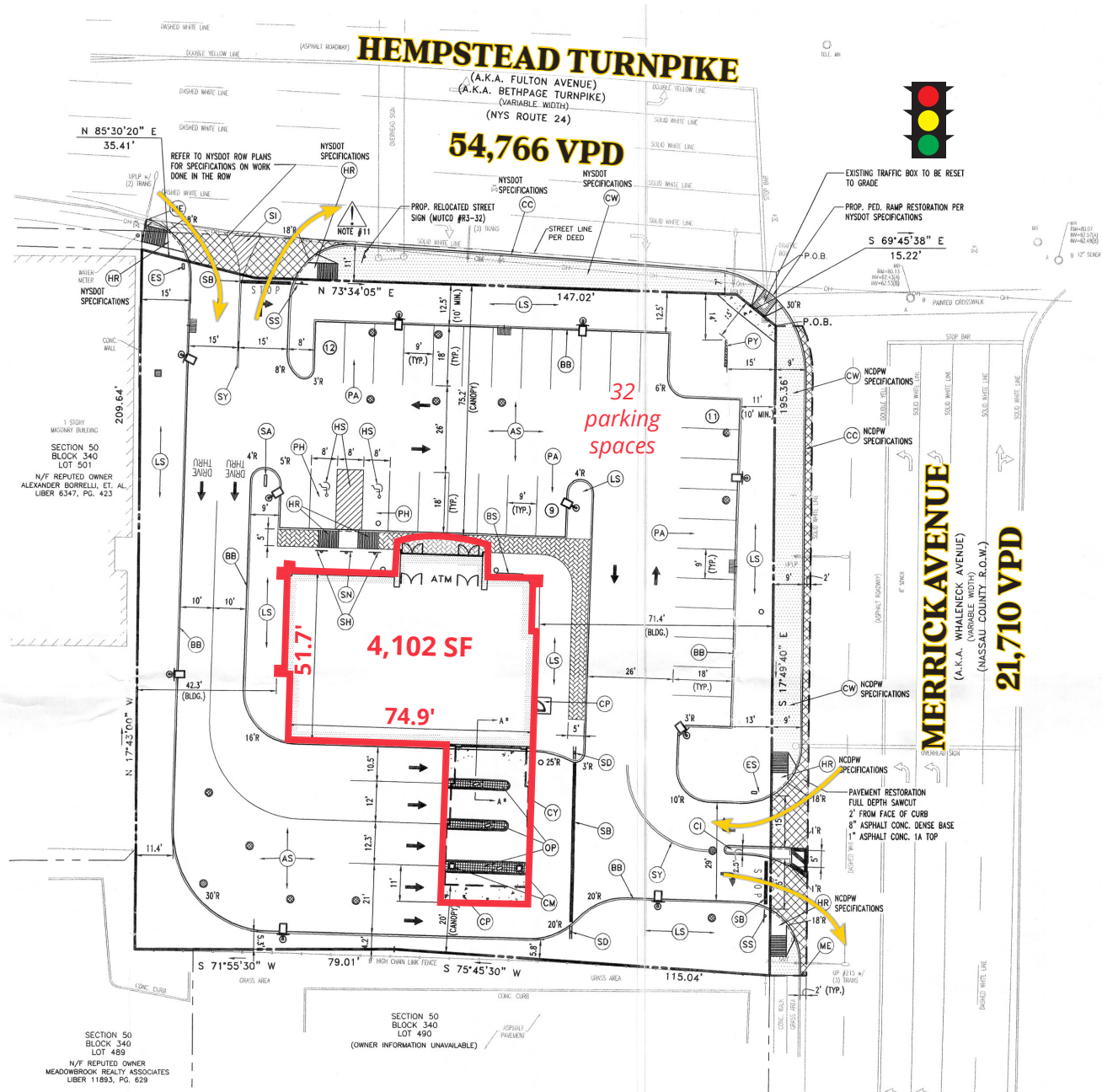

# Freestanding Corner Building with Drive-Thru

1600 Hempstead Turnpike | East Meadow, NY



# Freestanding Corner Building with Drive-Thru

1600 Hempstead Turnpike | East Meadow, NY



## DEMOGRAPHIC HIGHLIGHTS

### 1 MILE

13,356 Population	19,167 Total Daytime Population	\$142,856 Average Household Income	4,361 Total Households
----------------------	---------------------------------------	--	------------------------------

### 3 MILES

216,763 Population	203,928 Total Daytime Population	\$160,607 Average Household Income	63,184 Total Households
-----------------------	--	--	-------------------------------

### 5 MILES

526,164 Population	493,738 Total Daytime Population	\$177,913 Average Household Income	161,626 Total Households
-----------------------	--	--	--------------------------------

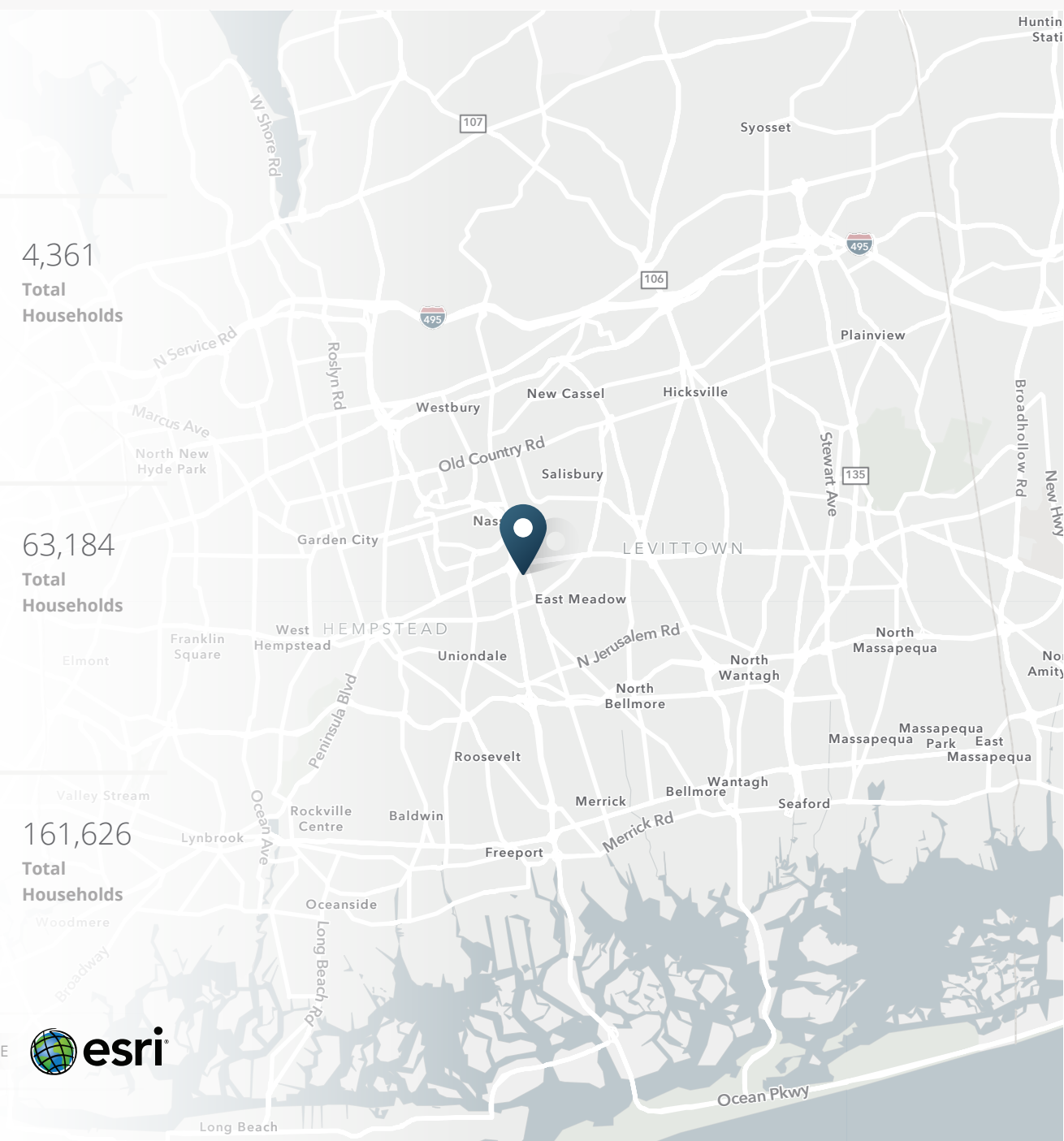

> **Want more?** Contact us for a complete demographic, foot-traffic, and mobile data insights report.





**SRS Real Estate Partners**  
340 Madison Avenue  
New York, NY 10173  
212.710.5250

**Jon Spadafino**  
212.710.5257  
[jon.spadafino@srsre.com](mailto:jon.spadafino@srsre.com)

**Hugh Kelly**  
212.710.5252  
[hugh.kelly@srsre.com](mailto:hugh.kelly@srsre.com)

**SRSRE.COM**

© SRS Real Estate Partners

The information presented was obtained from sources deemed reliable;  
however SRS Real Estate Partners does not guarantee its completeness or accuracy.