

Greenwich Street

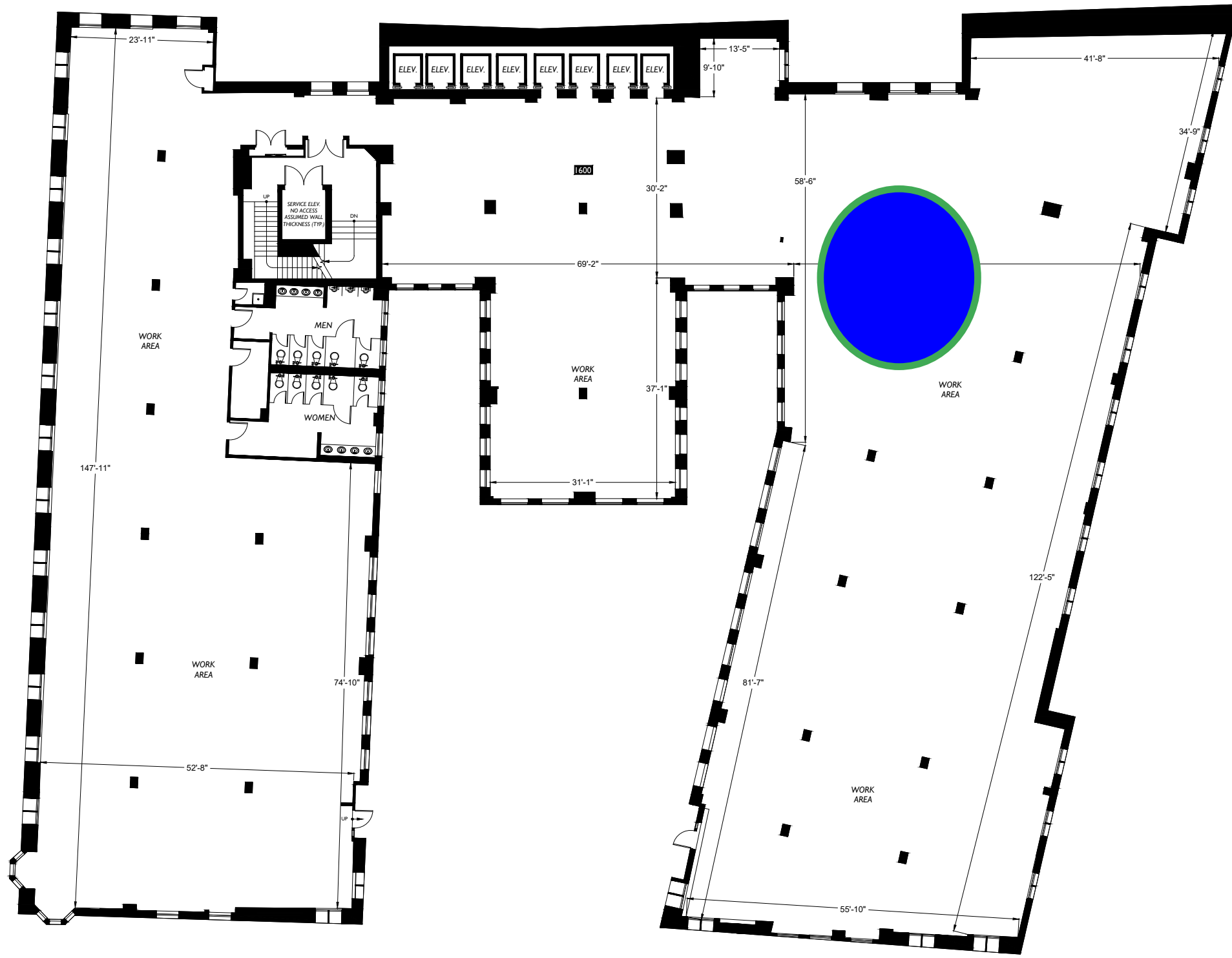

Adjacent Building

Adjacent Building
Battery Place

Broadway

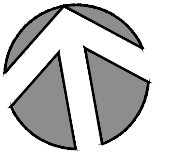

Office Building
11 Broadway
New York, NY 10004

Subject

Floor Plan

16

Floor

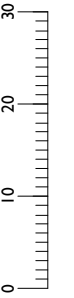

Scale

2DFLOORPLANS.COM
206-328-7410



600 NW Gilman Blvd. Suite E
Issaquah, WA 98027

Measured: August 2017

Project: C17-712

Braun Management, Inc.
160 Broadway, First Floor
New York, NY 10038

Client