

# 412 W 15TH

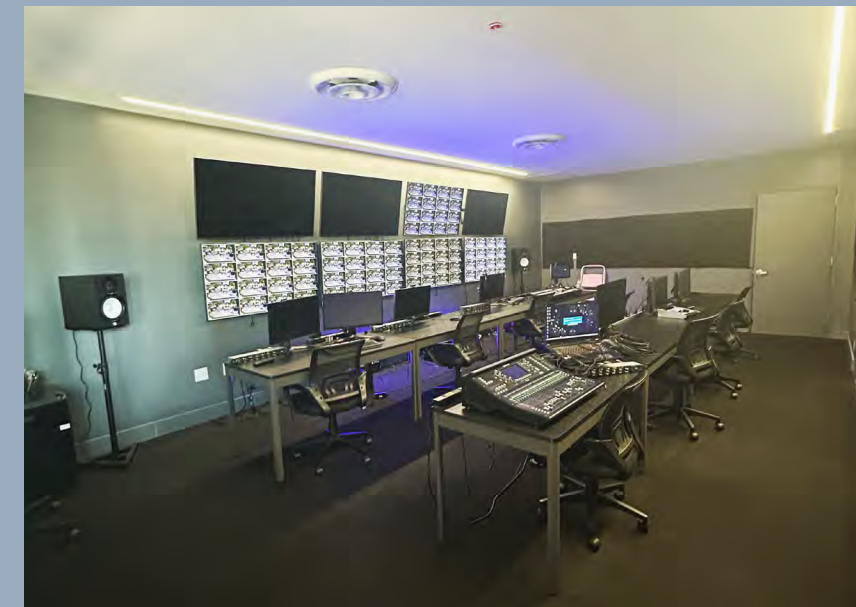

ENTIRE 5TH FLOOR | 10,435 RSF  
SUBLEASE | TERM THROUGH MAY 30, 2030

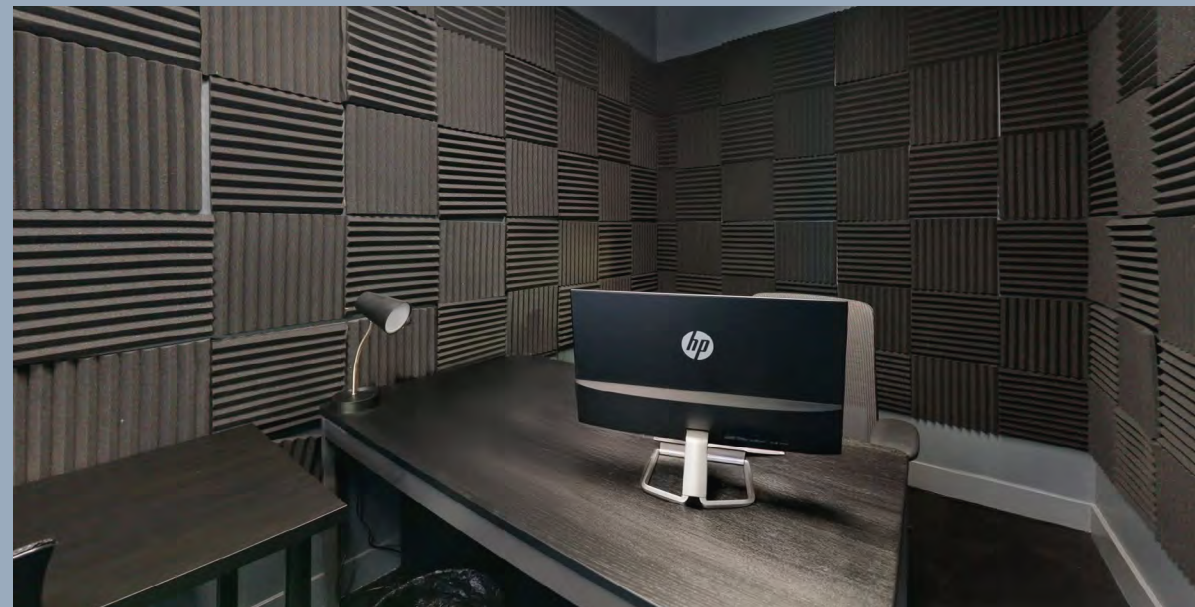

## SPACE HIGHLIGHTS



2 Offices



2 Large shared offices



2 Huddle/Breakout rooms



1 Boardroom



1 Conference room



Open area for workstations



Pantry and lounge

## SUGGESTED LAYOUT

5TH FLOOR

10,435 RSF

Sublease

Term through May 30, 2030

Virtual Tour



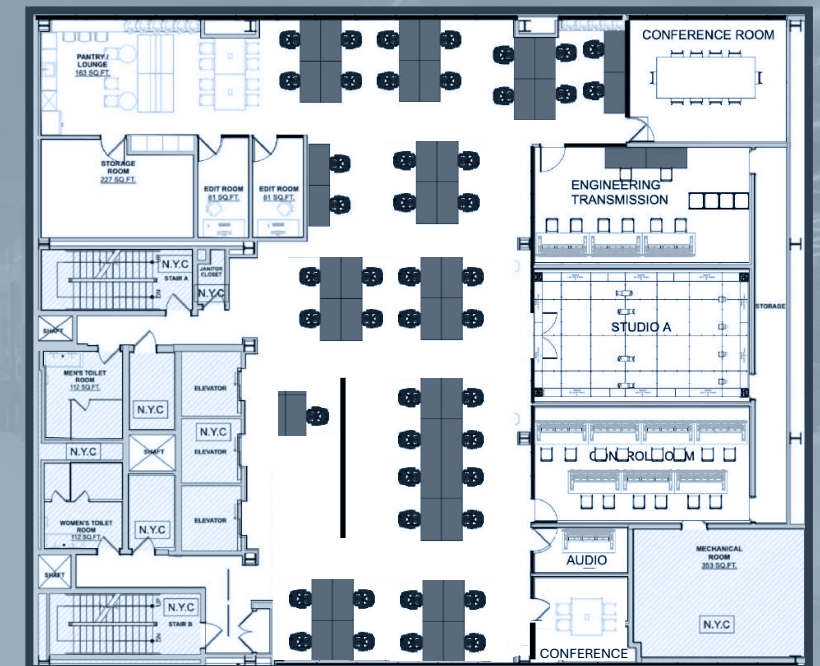

Scan or click to view



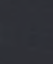

## BUILDING HIGHLIGHTS

-  Exceptional natural light, air, and views
-  Full glass storefronts
-  Soaring ceiling heights
-  Efficient floor plates
-  Over 350 feet of retail frontage along West 14th and West 15th Streets
-  Designed to appeal to a broad range of TAMI tenants
-  Situated between 9th and 10th Avenues
-  Located in the heart of Manhattan's Meatpacking District, one of the city's most sought-after submarkets

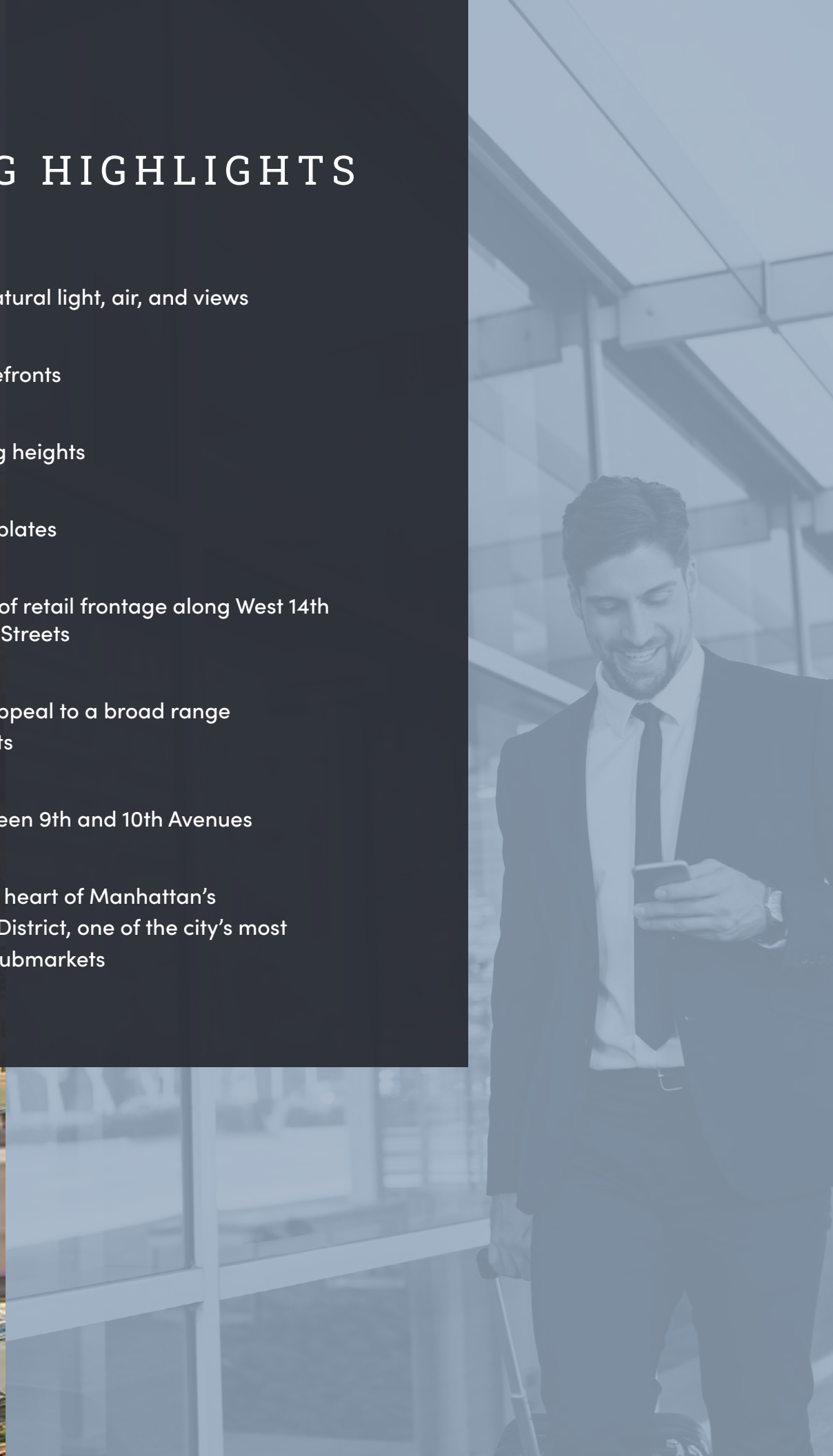

# ABUNDANT AMENITIES



Situated in the heart of the Meatpacking District, 412 W 15th Street is steps from the High Line, Hudson River Park, and the Whitney Museum. Surrounded by top-tier dining, boutique shopping, and vibrant nightlife—with easy access to the A/C/E and L trains—this prime address offers seamless connectivity in one of Manhattan’s most dynamic neighborhoods.

**6**  
MILLION  
Annual visitors to  
Chelsea Market

**5**  
MILLION  
Annual visitors to  
nearby High Line

**33.1**  
MILLION  
Annual ridership at  
nearby subway stations

**1**  
MILLION  
Annual visitors anticipated  
to Whitney Museum of  
American Art

**1,742**  
HOTEL ROOMS  
Within 10 block radius

**4.9**  
MILLION  
Square feet of office  
space in the MPD  
submarket

**11**  
Fitness

**9**  
Hotels

**47**  
Restaurants

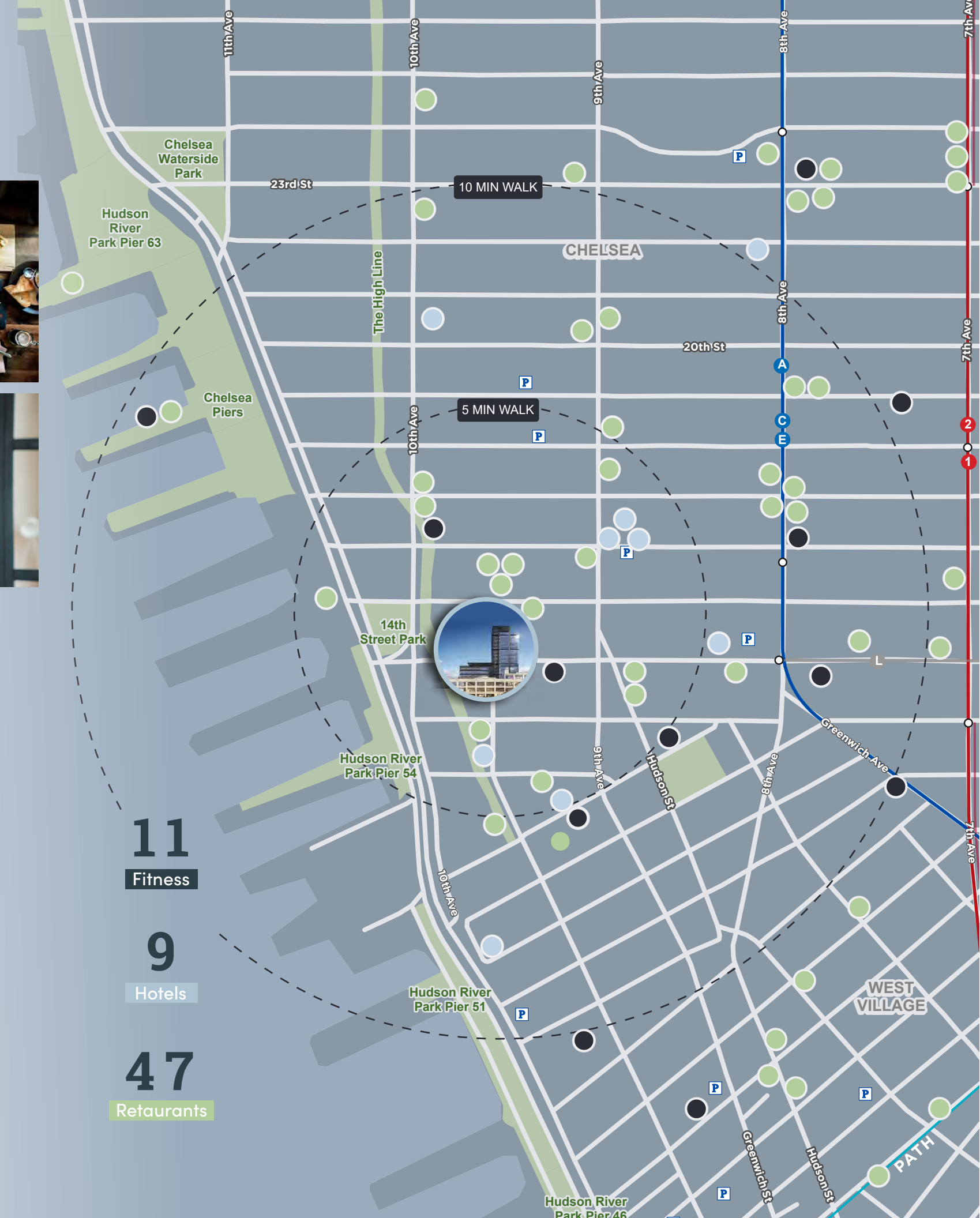

# 412 W 15TH

ENTIRE 5TH FLOOR | 10,435 RSF  
SUBLEASE | TERM THROUGH MAY 30, 2030

FOR MORE INFORMATION, PLEASE CONTACT:

ELIZABETH HOLMES

+1 6315465885

[elizabeth.d.holmes@cushwake.com](mailto:elizabeth.d.holmes@cushwake.com)

TAMAR WARTANIAN

+1 9177457812

[tamar.wartanian@cushwake.com](mailto:tamar.wartanian@cushwake.com)

DAMANI OSEI

+1 8043991044

[damani.osei@cushwake.com](mailto:damani.osei@cushwake.com)

YARDEN DRIMMER

+1 2123284220

[yarden.drimmer@cushwake.com](mailto:yarden.drimmer@cushwake.com)

DEBORAH VAN DER HEYDEN

+1 2125895189

[deb.vanderheyden@cushwake.com](mailto:deb.vanderheyden@cushwake.com)