

Bldg 925
South Federal Hwy

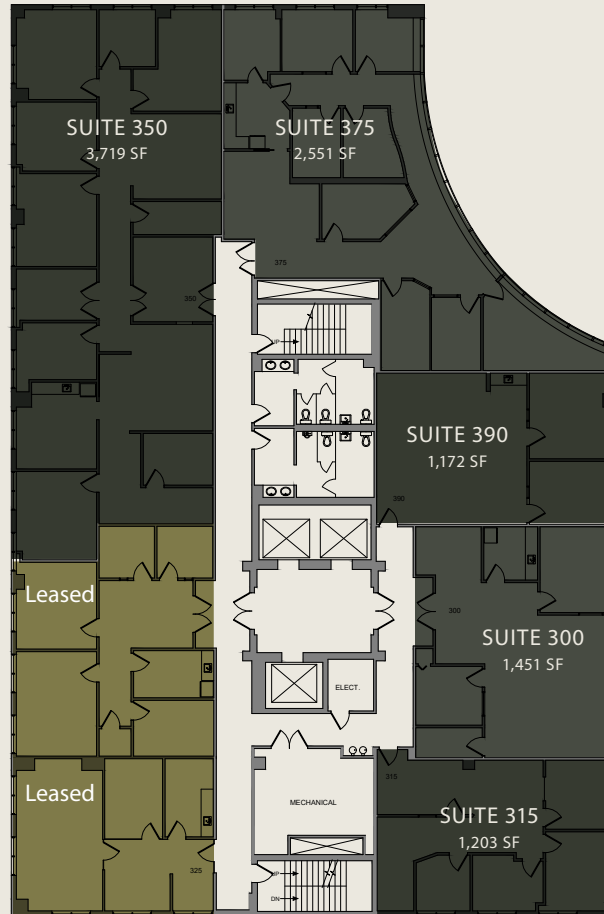

3RD FLOOR

Available:

SUITE 350: 3,719 SF

SUITE 375: 2,551 SF

SUITE 390: 1,172 SF

SUITE 315: 1,203 SF

SUITE 300: 1,451 SF

TOTAL: 10,096 SF

For more information contact:

John Criddle

Executive Vice President

+1 561 283 5176

john.criddle@cbre.com

Joe Freitas

Senior Vice President

+1 561 512 8844

joe.freitas@cbre.com

Maxwell Pawk

Vice President

+1 561 393 1670

max.pawk@cbre.com

Nicholas Mulligan

Associate

+1 561 393 1680

nicholas.mulligan@cbre.com

IPCapital
PARTNERS, LLC

CBRE