



FOR **LEASE**

RAIL SERVED WAREHOUSE - UP TO 93,700 SF ±

235-333 S. KRESSON STREET | BALTIMORE, MARYLAND 21224



MACKENZIE

COMMERCIAL REAL ESTATE SERVICES, LLC

PROPERTY OVERVIEW

HIGHLIGHTS:

- Two warehouse/industrial buildings totaling 93,700 SF ± (can be leased individually)
- Rail served
- Heavy power
- 16'-20' ± clear heights
- I-2 zoning allows for a wide variety of uses
- Easy access to I-95, I-895 and Johns Hopkins Bayview Medical Center
- Building to be newly painted soon

BUILDING 1:	50,000 SF ±
BUILDING 2:	43,700 SF ± (CAN BE DEMISED)
LOT SIZE:	2.78 ACRES ±
CLEAR HEIGHT:	16'-20' ±
DOCKS:	10
DRIVE-INS:	8
ZONING:	I-2 (GENERAL INDUSTRIAL DISTRICT)
RENTAL RATE:	NEGOTIABLE

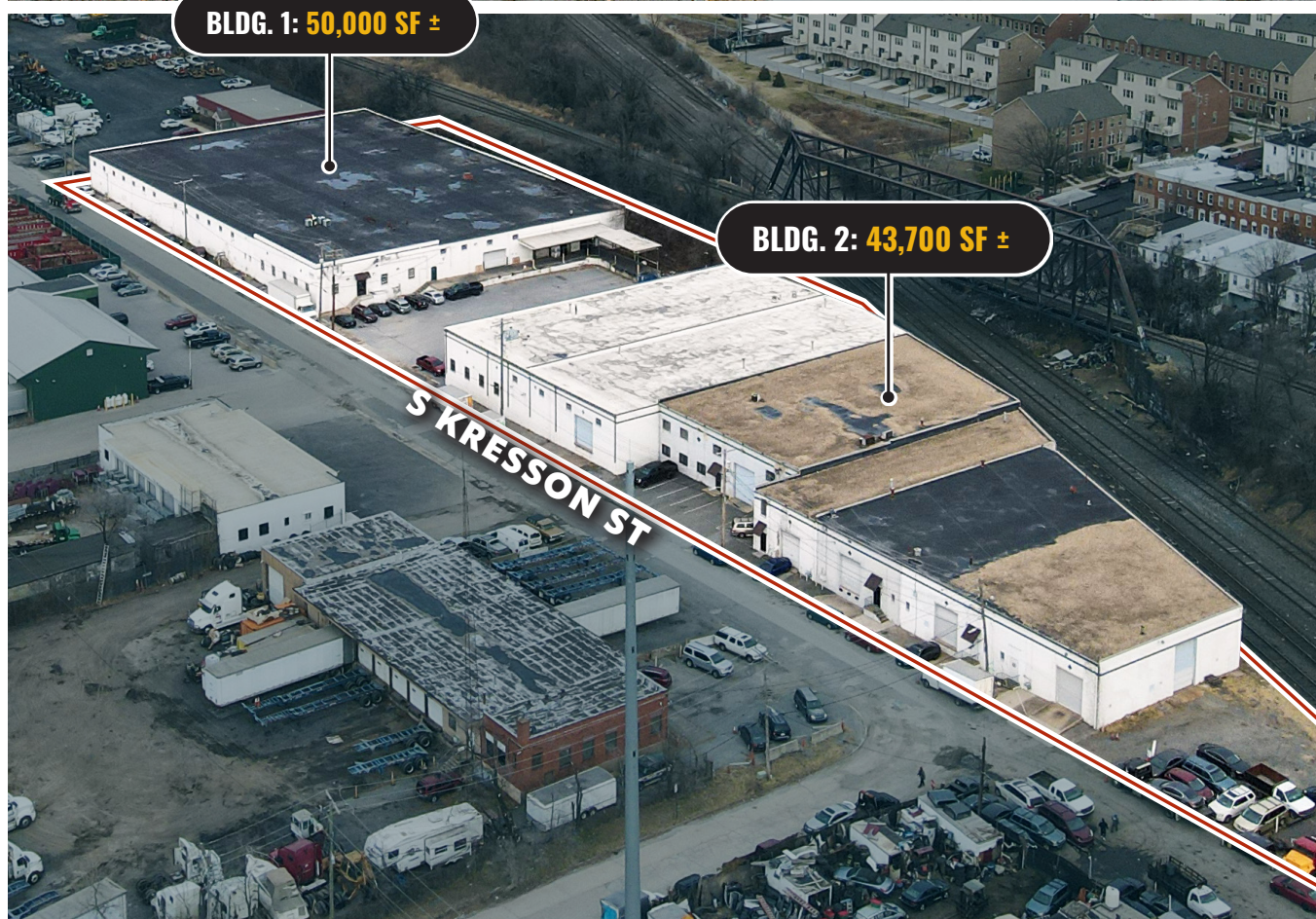

AERIAL

△ DRIVE-IN
|| DOCK



S KRESSON ST

EASTERN AVE



SITE PLAN

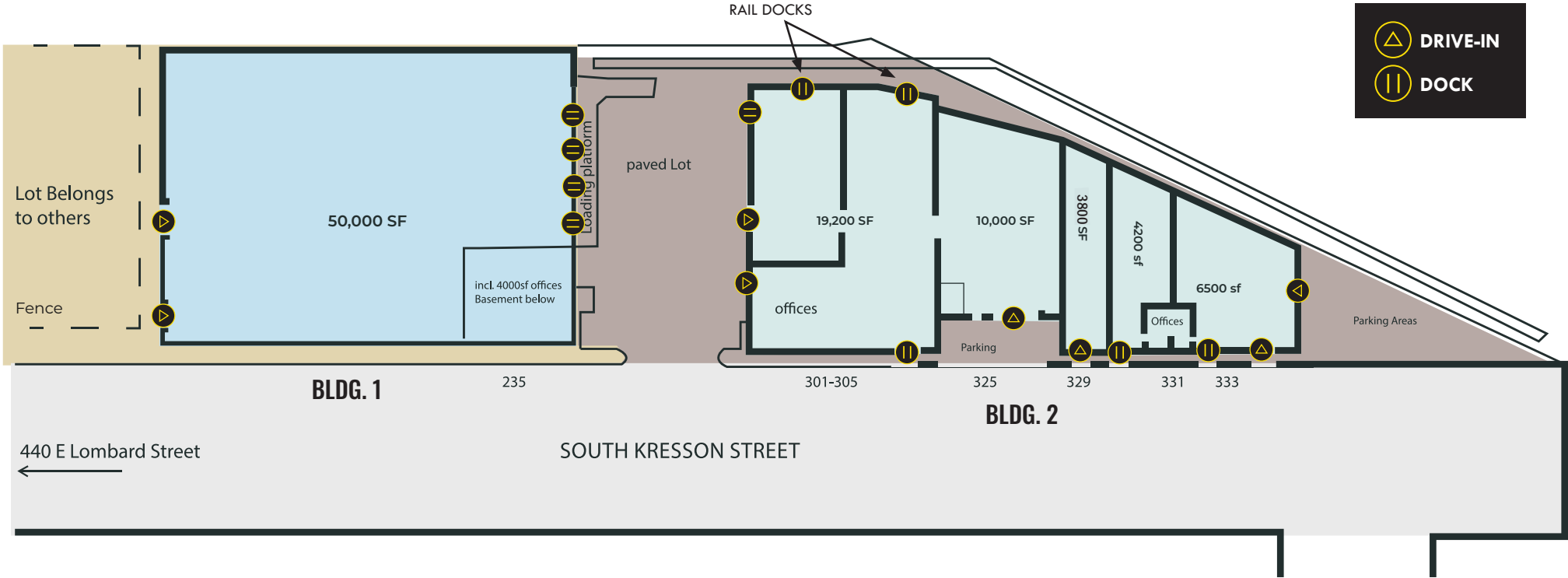

FLOOR PLAN: BUILDING 1

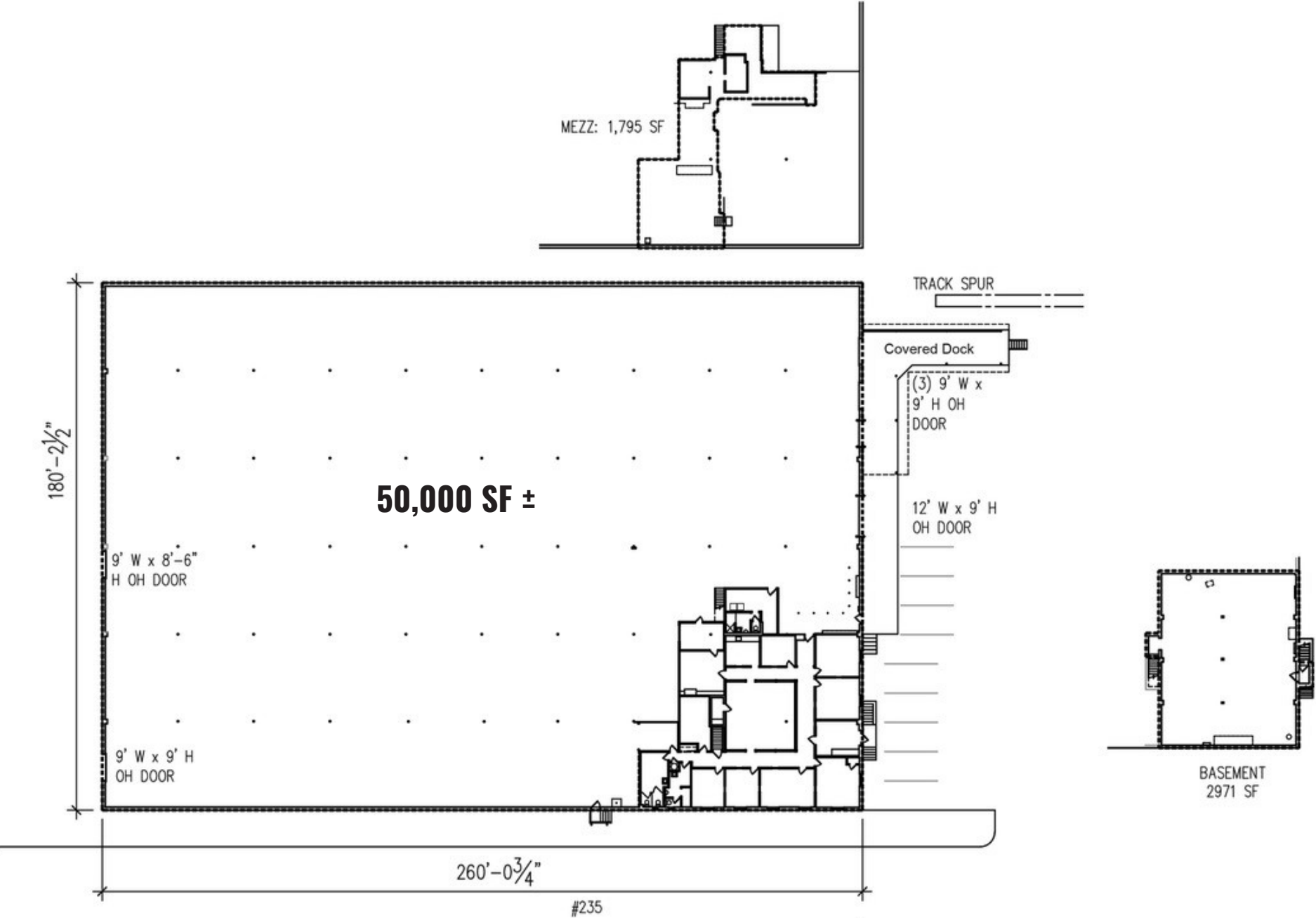

FLOOR PLAN: BUILDING 2

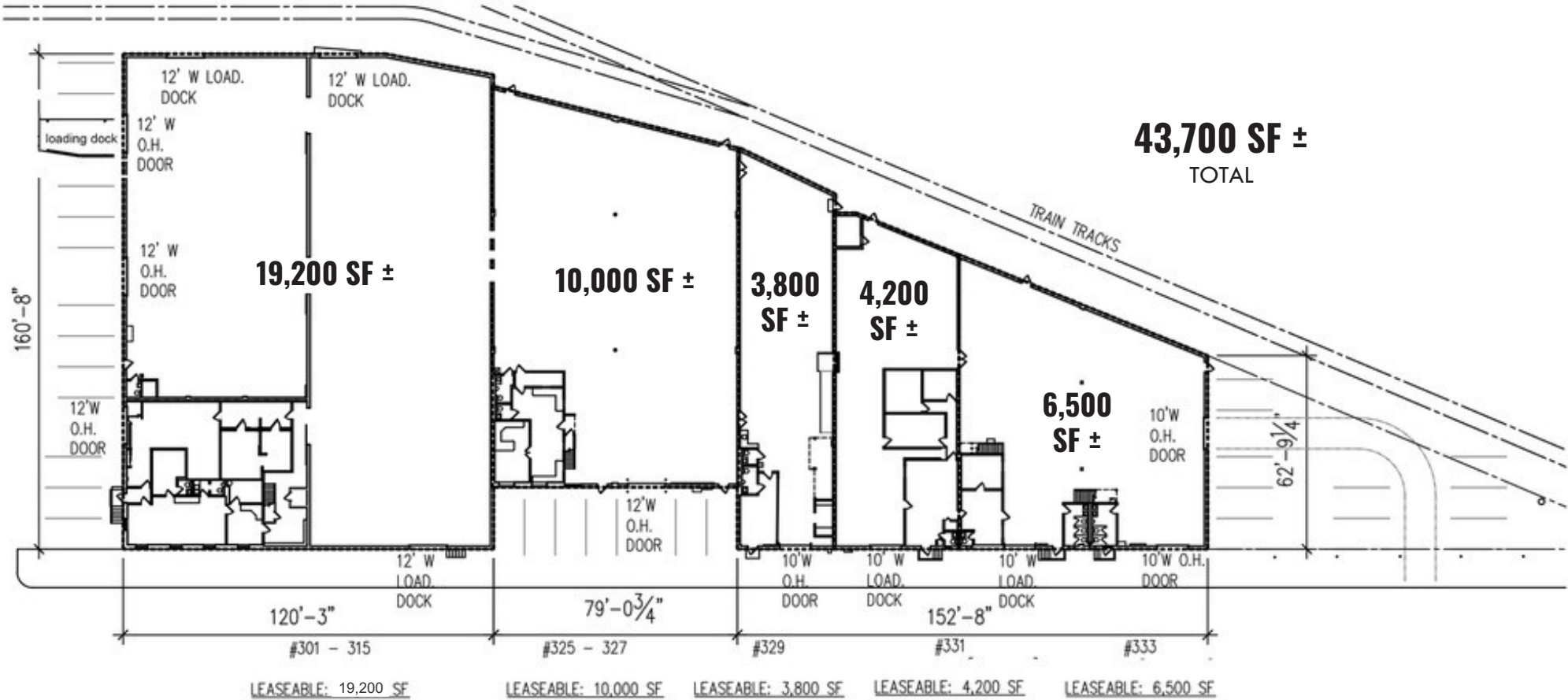

ADDITIONAL PHOTOS



LOCAL BIRDSEYE

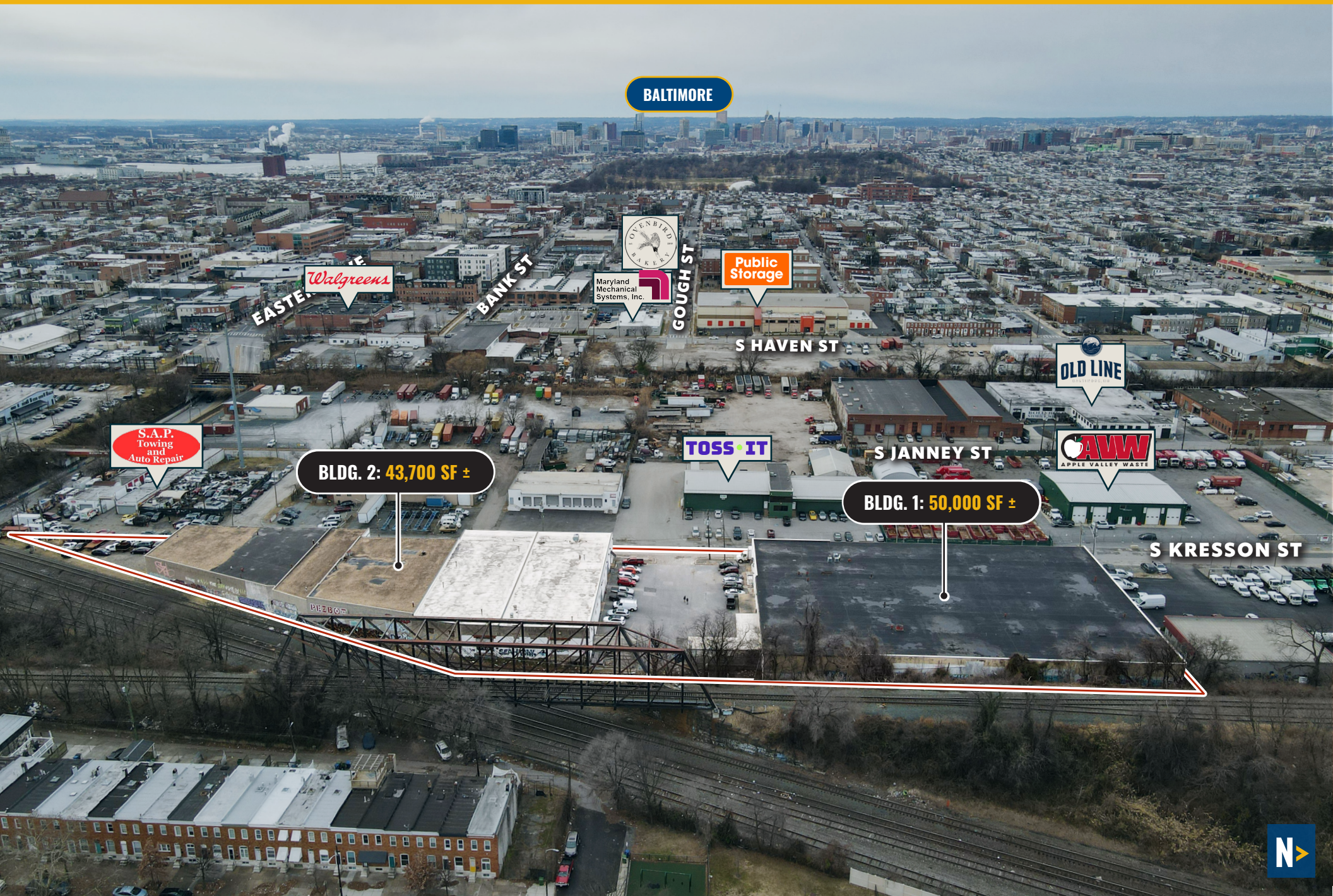

BALTIMORE



Walgreens

Maryland Mechanical Systems, Inc.

Public Storage

S.A.P. Towing and Auto Repair

TOSS-IT

AWW APPLE VALLEY WASTE

BLDG. 2: 43,700 SF ±

BLDG. 1: 50,000 SF ±

EAST...

BANK ST

GOUGH ST

S HAVEN ST

S JANNEY ST

OLD LINE

S KRESSON ST



TRADE AREA

DRIVING DISTANCE TO:

INTERSTATE 895
0.6 MILES
2 MIN. DRIVE

40
0.6 MILES
3 MIN. DRIVE

INTERSTATE 95
1.6 MILES
6 MIN. DRIVE

PORT OF BALTIMORE
1706
Helen Delich Bentley
2.9 MILES
9 MIN. DRIVE
(SEAGIRT MARINE TERMINAL)

BWI
BALTIMORE WASHINGTON INTERNATIONAL
THURGOOD MARSHALL
13.3 MILES
14 MIN. DRIVE

BALTIMORE, MD
3.1 MILES
10 MIN.

WASHINGTON, DC
42.2 MILES
45 MIN.

PHILADELPHIA, PA
98.4 MILES
1 HR. 30 MIN.

RICHMOND, VA
152.0 MILES
2 HRS. 20 MIN.



INDUSTRIAL/BUSINESS PARK
RETAIL CENTER

3 MILES

SITE



FOR MORE INFO CONTACT:



ANDREW MEEDER, SIOR

SENIOR VICE PRESIDENT & PRINCIPAL

410.494.4881

AMEEDER@mackenziecommercial.com



MATTHEW CURRAN, SIOR

SENIOR VICE PRESIDENT & PRINCIPAL

443.573.3203

MCURRAN@mackenziecommercial.com



DANIEL HUDAK, SIOR

SENIOR VICE PRESIDENT & PRINCIPAL

443.573.3205

DHUDAK@mackenziecommercial.com



ALTON CURRY

REAL ESTATE ADVISOR

443.841.9780

ACURRY@mackenziecommercial.com



VISIT **PROPERTY PAGE** FOR MORE INFORMATION

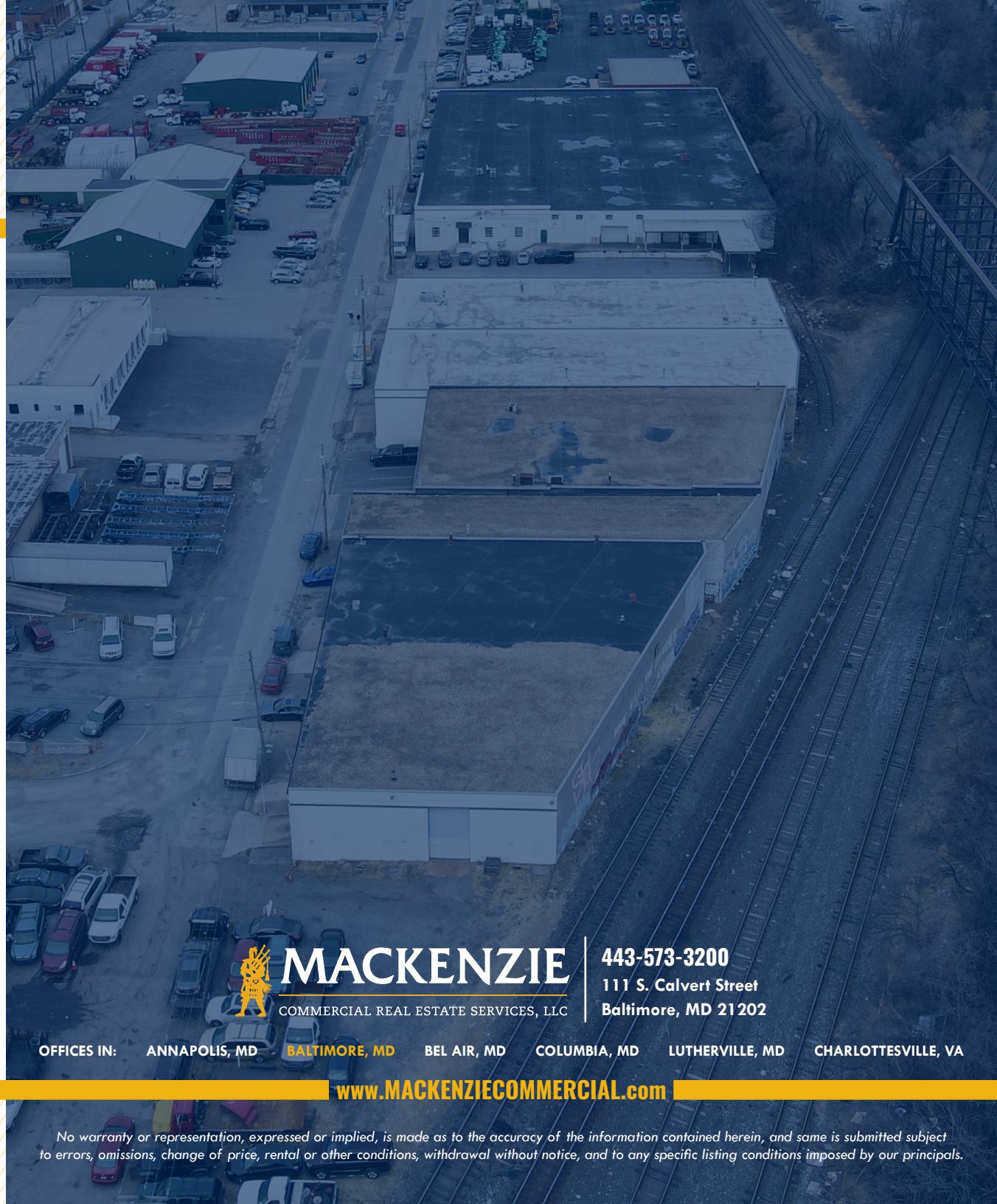

MACKENZIE

COMMERCIAL REAL ESTATE SERVICES, LLC

443-573-3200

111 S. Calvert Street
Baltimore, MD 21202

OFFICES IN: ANNAPOLIS, MD **BALTIMORE, MD** BEL AIR, MD COLUMBIA, MD LUTHERVILLE, MD CHARLOTTESVILLE, VA

www.MACKENZIECOMMERCIAL.com

No warranty or representation, expressed or implied, is made as to the accuracy of the information contained herein, and same is submitted subject to errors, omissions, change of price, rental or other conditions, withdrawal without notice, and to any specific listing conditions imposed by our principals.