



ETON BUSINESS PARK

21110 NORDHOFF ST, UNIT L/M
CHATSWORTH, CA

SPACE AVAILABLE | 4,099 SF

\$7,173 MG
PER MONTH (\$1.75 PSF)

6 MONTHS HALF RENT
(SUBJECT TO TENANT'S
CREDIT AND MINIMUM
3-YEAR LEASE TERM)



NEWMARK

Jeff Abraham, SIOR
Executive Managing Director
t 818-921-8528
jeff.abraham@nmrk.com
CA RE License #01830909

Javier Galvan
Associate Director
t 818-921-8532
javier.galvan@nmrk.com
CA RE License #02116539

Corporate License #01355491

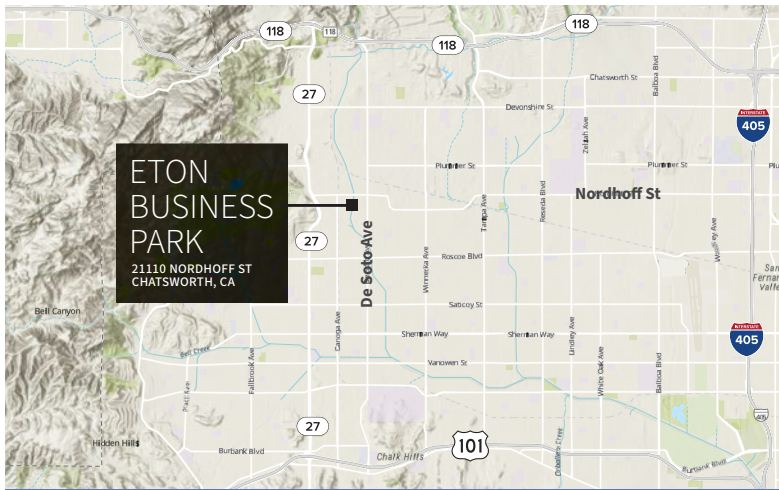

ETON BUSINESS PARK
21110 NORDHOFF ST
CHATSWORTH, CA

REGIONAL MAP

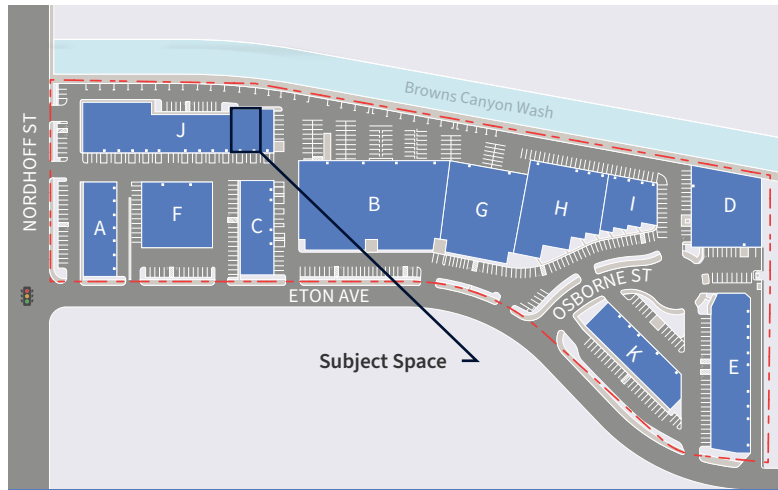

SITE PLAN

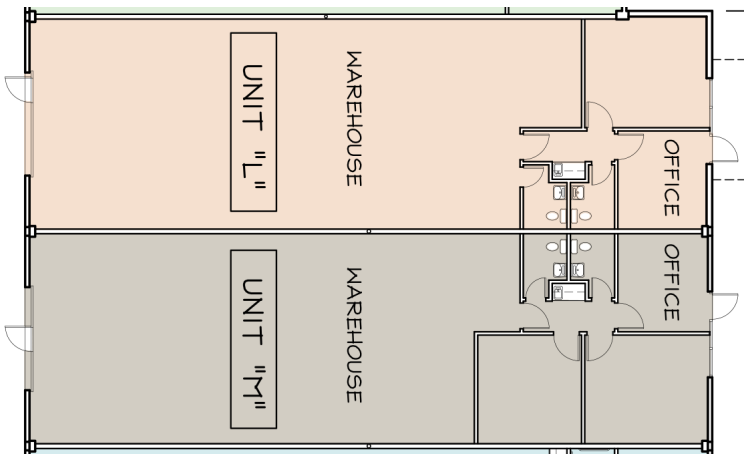

SUITE 21110, L/M **4,099 SF**

FLOOR PLAN

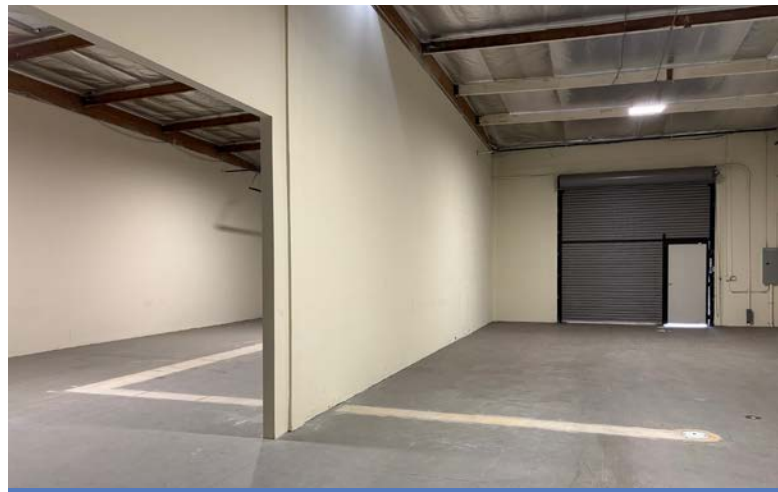

INTERIOR PHOTO

SUITE ATTRIBUTES



2 rear ground level loading doors



16-foot minimum warehouse clearance



Clear span warehouse



Functional office space



200 Amps, 120/208 Volts and 100 Amps, 120/208 Volts



3.5 miles from 118 Freeway and 5.2 miles from 101 Freeway



1.95:1,000 SF parking (8 spaces)



20 minutes from 405 Freeway, providing access to Greater Los Angeles



3 miles from Westfield Topanga



Jeff Abraham, SIOR
Executive Managing Director
t 818-921-8528
jeff.abraham@nrmk.com
CA RE License #01830909

Javier Galvan
Associate Director
t 818-921-8532
javier.galvan@nrmk.com
CA RE License #02116539

Corporate License #01355491