

METRO PARK NORTH

FLEX SPACE
FOR LEASE

7616 Standish Place

Rockville, MD



CONTACT INFORMATION

Kenneth Fellows
kfellows@klnb.com
301.222.0210

Robert Pugh
rpugh@klnb.com
301.222.0211

Keiry Martinez
kmartinez@klnb.com
703.334.5629





7610-7616 Standish Pl

Property Facts

Property Type:	Flex
Building Class:	B
RBA:	22,470 SF
Year Built:	1983

Floor Plan

Suite 7616
13,797 SF

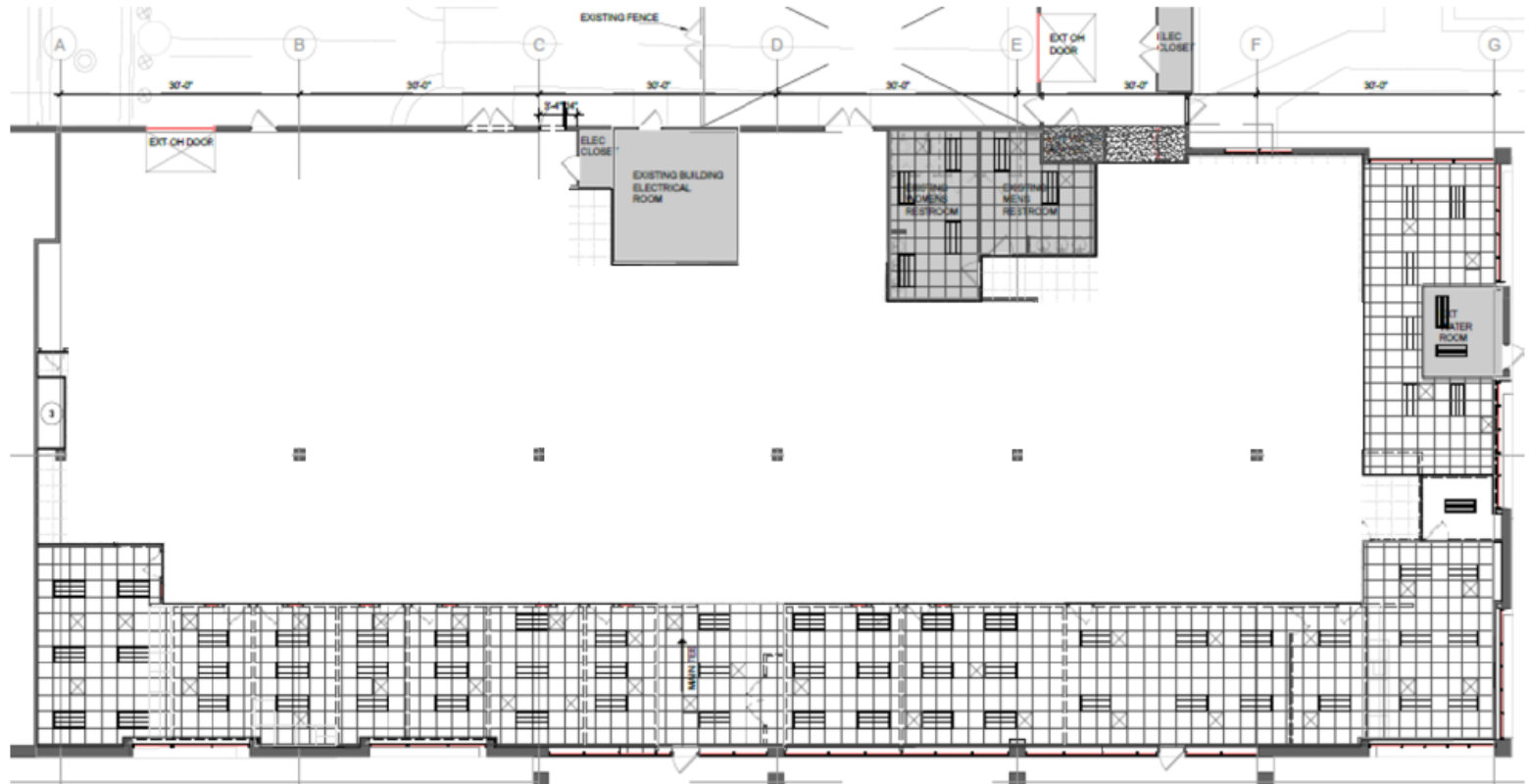



Accessibility

- Strategically located in Montgomery County with convenient access to major commuter routes (I-270, I-370, I-495, and ICC)
- Shady Grove Metro Station - 1.4 miles (4 minutes)
- Rockville Metrorail - 2.1 miles (5 minutes)
- On-site bus stop at Crabbs Branch Way and Standish Place

Local Amenities

Notable Amenities within 10 minute drive



RESTAURANTS & CAFE

- | | | |
|------------------------------|-----------------------------|-------------------------------|
| True Respite Brewing Company | Krispy Kreme | 520 Ice Cream & Tea Rockville |
| Panera Bread | Chick-fil-A | Lavande Patisserie |
| Dunkin' | Chipotle Mexican Grill | East Dumpling House |
| Papa John's Pizza | Five Guys | Word of Beer |
| Wendy's | Jumbo Jumbo Cafe Asia Taste | Nagoya Sushi |
| Starbucks | The Cuban Corner | Coffee Republic |
| McDonald's | Island Pride Jamaican | Botanero |
| Kung Fu Tea | Fresh Baguette | Fontina Grille |
| Gong Cha | Taipei Cafe | Nick's Chophouse |
| Peter's Grill | Pho 75 | Checkers |
| Burger King | Asian Bakery Cafe | Minerva Indian Cuisine |
| Red Lobster | China Bistro | The Melting Pot |
| CAVA | Popeyes Louisiana Kitchen | Love Sushi |

CONVENIENCE & GROCERY STORE

- | | |
|----------|----------------------|
| 7-Eleven | Giant Food |
| CVS | MOM's Organic Market |
| Safeway | Market Place |

HOSPITALITY

- | | |
|------------------------------|-----------------------|
| Red Roof PLUS+ | Radisson Hotel |
| Residence Inn
by Marriott | Sleep Inn |
| Sheraton | Courtyard by Marriott |
| Extended Stay America | Hilton Garden Inn |

Local Amenities



RIO Lakefront

- | | |
|-----------------------|-------------------|
| AMC DINE-IN Cinema | Yard House |
| Courtyard by Marriott | Potbelly |
| Target | Chipotle |
| Barnes & Noble | Nando's Peri-Peri |
| Starbucks | Tara Thai |
| The Bench | KungFu Tea |
| Copper Canyon Grill | BGR |
| California Pizza | Guapo's |
| Kitchen | Union Jack's |
| Uncle Julio's | |



Rockville Town Square

- | | |
|----------------------------|---------------|
| Rockville Memorial Library | La Tasca |
| Dawson's Market | Five Guys |
| Finnegan's Wake Irish Pub | Thai Pavilion |
| Vie de France Bakery Cafe | BonChon |
| Lebanese Taverna Cafe | Friendship |
| Marble Slab Creamery | Sushi Damo |
| Buffalo Wild Wings | Spice Xing |
| Starbucks | Berry Cup |
| Peter Chang | Kyoto Matcha |

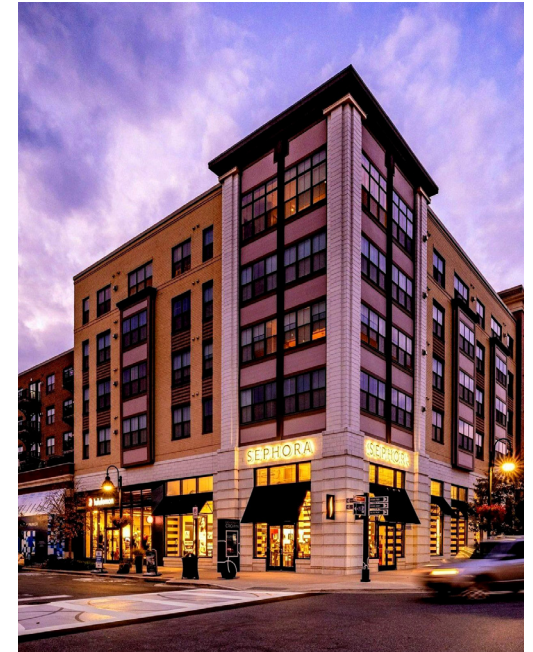

Downtown Crown

- | | |
|----------------|-----------------------------------|
| Harris Teeter | BurgerIM |
| LA Fitness | Chopt |
| &pizza | Mezeh Mediterranean |
| Coastal Flats | la Madeleine French Bakery & Cafe |
| Starbucks | Old Town Pour House |
| Ted's Bulletin | Ted's Montana Grill |
| Spicelife | Ruth's Chris Steak House |
| Cinnaholic | Paladar Latin Kitchen & Rum Bar |
| Asia Nine MD | |

METRO PARK NORTH

7616 Standish Place
Rockville, Maryland



12435 Park Potomac Ave,
Suite 250,
Rockville, MD, 20854

301-222-0200
klnb.com

 [in](#) [f](#) /klnbcre

FOR MORE INFORMATION, CONTACT:

Kenneth Fellows

kfellows@klnb.com
301.222.0210

Robert Pugh

rpugh@klnb.com
301.222.0211

Keiry Martinez

kmartinez@klnb.com
703.334.5629

While we have no reason to doubt the accuracy of any of the information supplied, we cannot, and do not, guarantee its accuracy. All information should be independently verified prior to a purchase or lease of the property. We are not responsible for errors, omissions, misuse, or misinterpretation of information contained herein and make no warranty of any kind, express or implied, with respect to the property or any other matters.