

110 GREENE STREET

NEW YORK, NY 10012

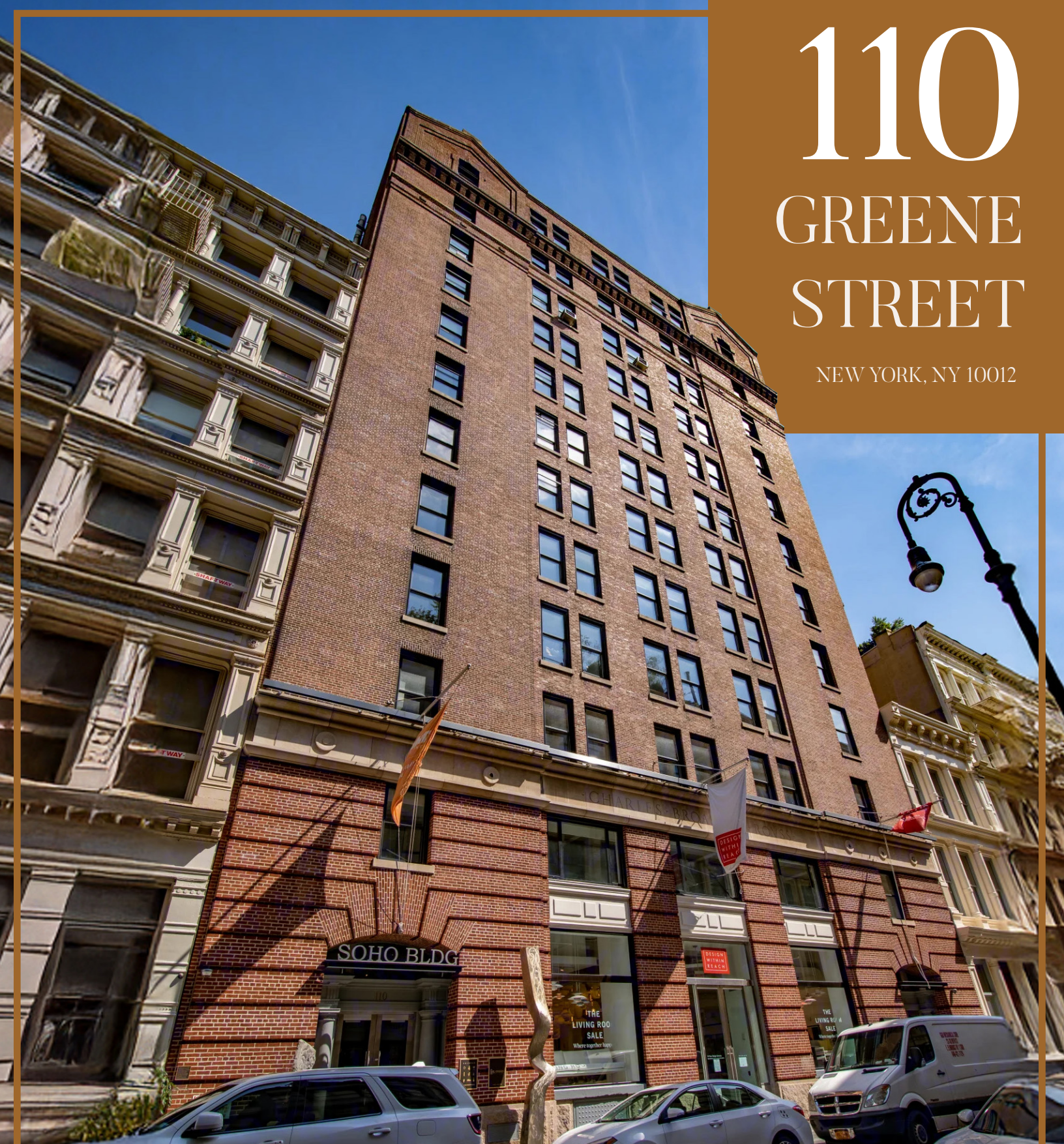

DISCOVER YOUR NEXT OFFICE SPACE

SUBLEASE OPPORTUNITY



THE BUILDING

Located in the heart of SoHo, 110 Greene Street is a classic cast-iron loft building that blends historic charm with modern living, featuring high ceilings, large windows, and signature details like exposed brick and hardwood floors. Set on a cobblestone street, it offers easy access to top shopping, dining, and transit, delivering a vibrant and convenient downtown lifestyle.

Leaseable Area	12,175 RSF	Term through	August 2029
Asking Rent	Upon Request	Occupancy	Immediate



FLOOR PLAN BREAKDOWN

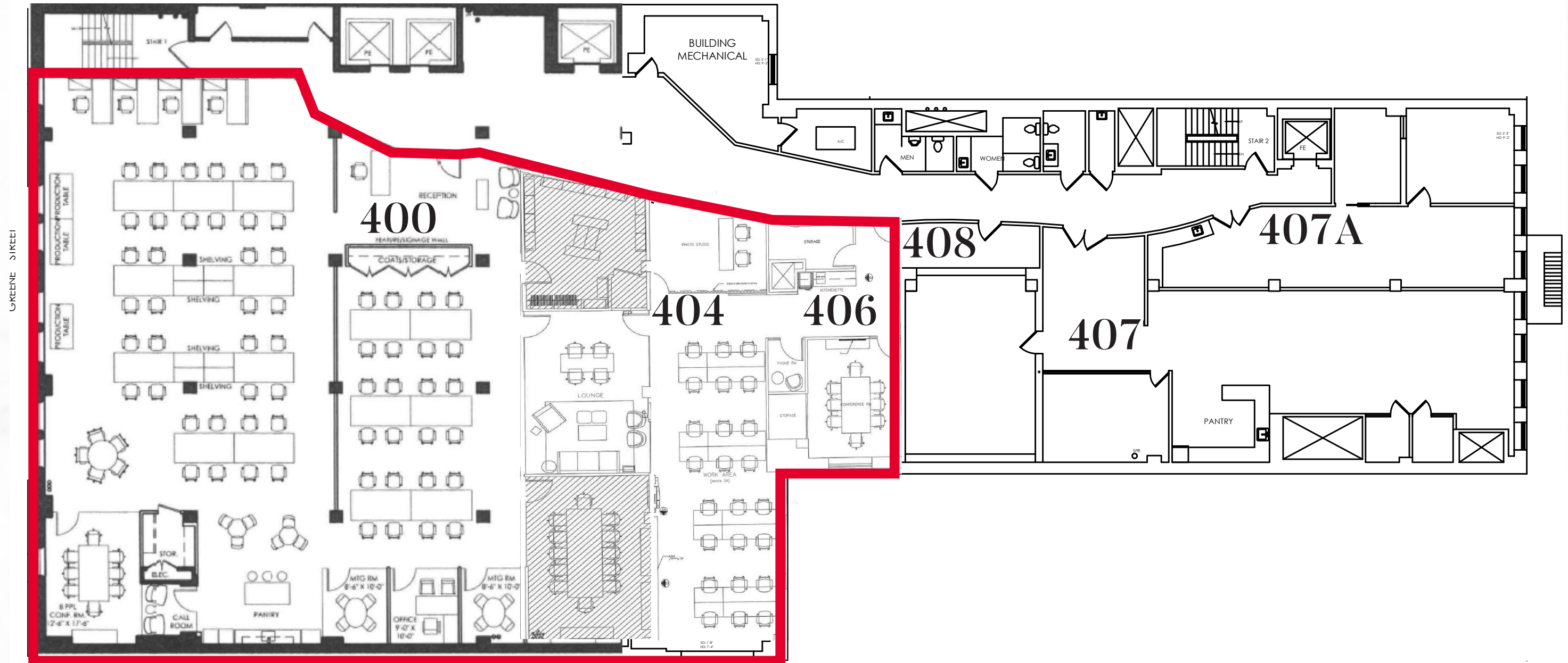

PROPERTY PHOTOS

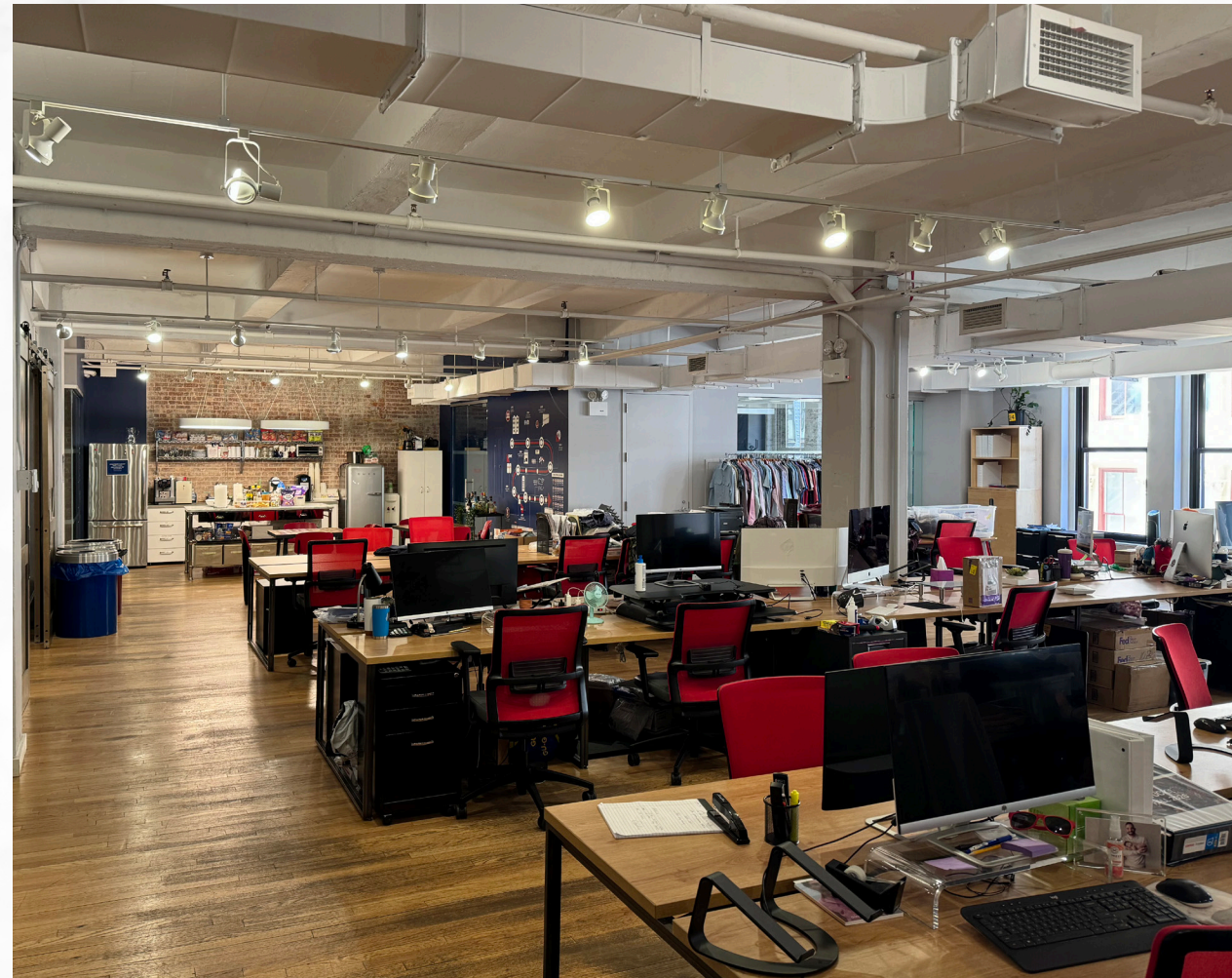
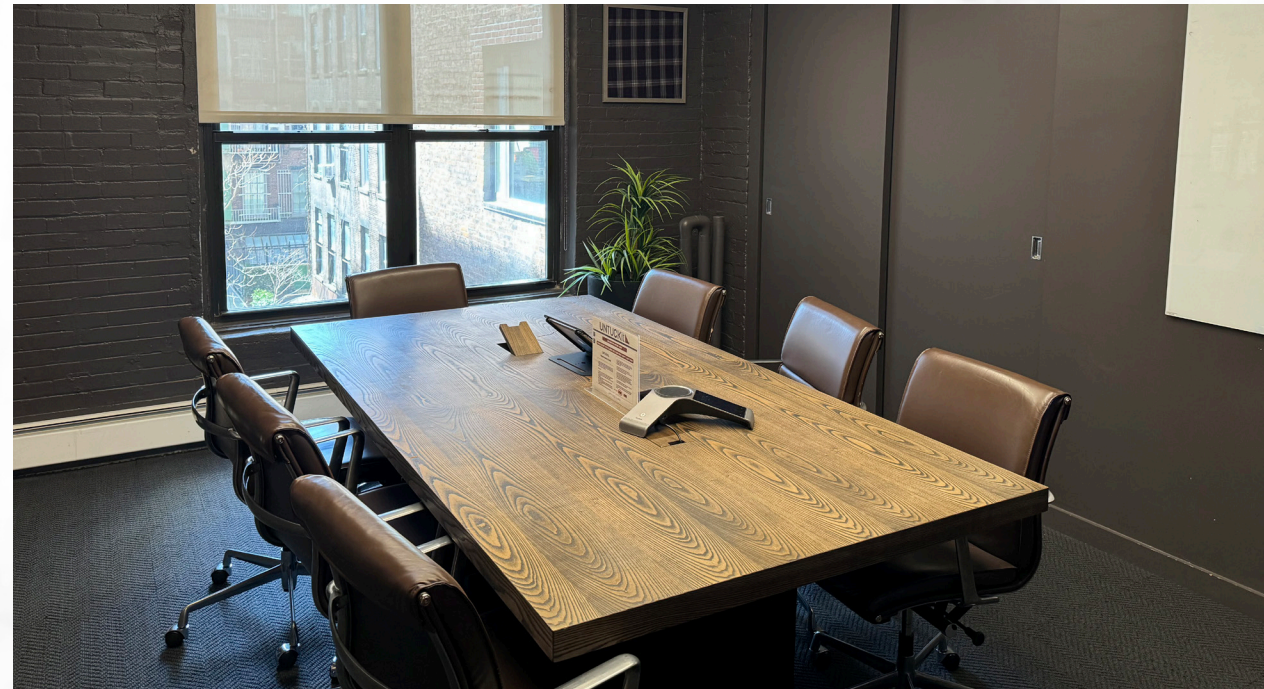



110 GREENE STREET

LEASEABLE AREA 12,175 RSF

TERM THROUGH AUGUST 2029

ASKING RENT UPON REQUEST

OCCUPANCY IMMEDIATE

Henry Molson

+1 212 841 9242

henry.molson@cushwake.com

Dan Organ

+1212 841 7720

dan.organ@cushwake.com