

LAUDERDALE LAKES INDUSTRIAL PARK

2696 NW 31ST AVENUE, LAUDERDALE LAKES, FL 33311

2760 NW 29TH TERRACE



BULLETS HEADLINE

- 1,635 SF
- 100% warehouse space
- Newly renovated
- Front 10' x 14' grade level overhead door
- 18' clear ceiling
- Private restroom
- 3 phase electric
- LED lights
- Hurricane Impact doors and windows
- Onsite Management
- Plenty of parking



ANGIE WEAVER

Lauderdale Lakes and Lauderdale Manager
Direct: 954.485.9200 | Cell: 917.645.2339
angie@levyrai.com

HALEY PRESSER

Property Manager / Sales Associate
Direct: 954.485.9200 | Cell: 954.254.5396
Haley@levyrai.com



LAUDERDALE LAKES INDUSTRIAL PARK

2696 NW 31ST AVENUE, LAUDERDALE LAKES, FL 33311

FLOOR PLAN

LAUDERDALE LAKES INDUSTRIAL PARK

Building #8, 2760 NW 29th Terrace | Lauderdale Lakes, FL 33311

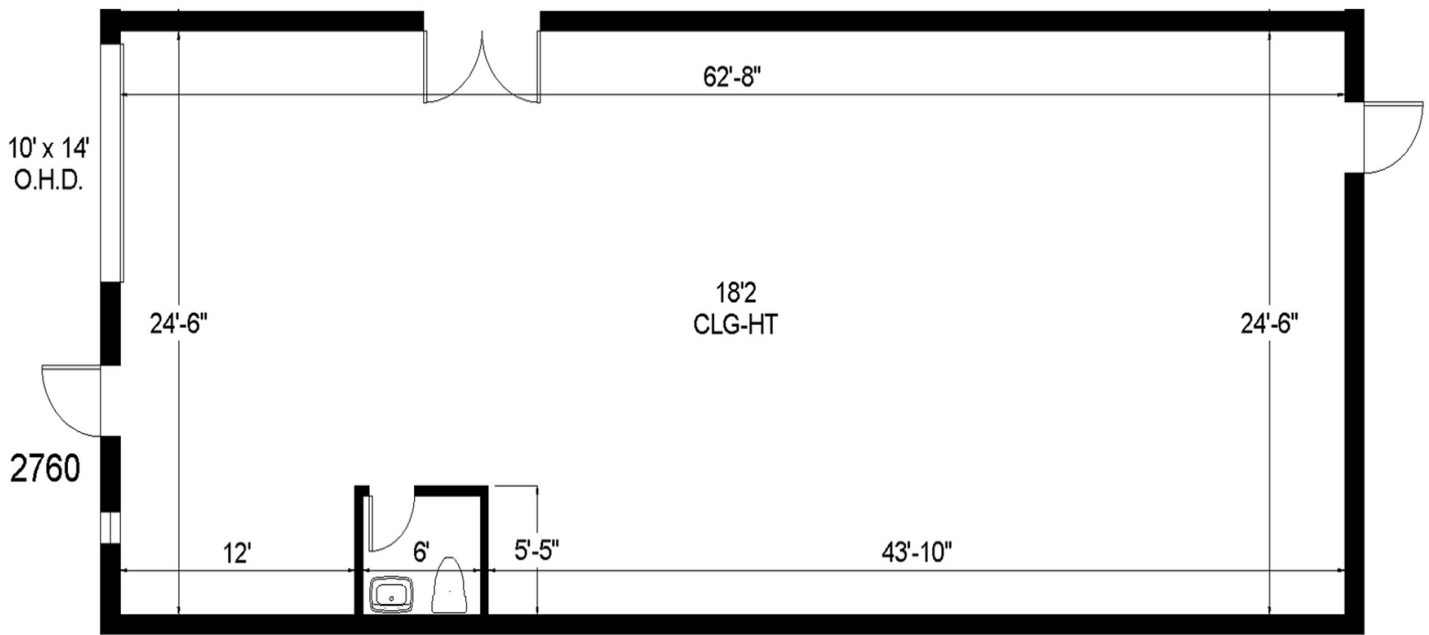

1,635 Rentable Sq. Ft.
www.LevyRealtyAdvisors.com

ANGIE WEAVER
 Lauderdale Lakes and Lauderhill Manager
 Direct: 954.485.9200 | Cell: 917.645.2339
angie@levyrai.com

HALEY PRESSER
 Property Manager / Sales Associate
 Direct: 954.485.9200 | Cell: 954.254.5396
Haley@levyrai.com

