

**RENTAL AREAS SUMMARY AS NOTED**

1,263.86 SQFT CATERED FIT MEZZANINE EXTERIOR WALL AREA  
 14,481.62 SQFT CATERED FIT EXTERIOR WALL AREA  
 15,745.48 SQFT TOTAL CATERED FIT AREA INCLUDING MEZZANINE. (Common areas not included)

**16,354.03 SQFT SELECTED FOOD EXTERIOR WALL AREA**

**LIFE SAFETY LEGEND:**

2-HOUR FIRE RATED SMOKE WALL

FIRE PROTECTION: PROVIDED

LEVEL OF ALTERATION: II

**FIRE RATINGS (CHAPTER 40):**

TYPE II CONSTRUCTION (1 STORY) PROTECTED PRIMARY STRUCTURAL FRAME EXISTING INTERIOR FRAME EXISTING FLOORS: EXISTING ROOF STRUCTURE: EXISTING VERTICAL SHAFTS: N/A EXIT ACCESS CORRIDORS: N/A

**BUILDING CODE ANALYSIS**

APPLICABLE CODE:  
 FLORIDA BUILDING CODE, 2010 EDITION  
 NEC 2008 EDITION  
 N.F.P.A. 101, LIFE SAFETY CODE 2009 EDITION

OCCUPANCY:  
 CATERED FIT:  
 GROUP F: FACTORY OCCUPANCY, FACTORY INDUSTRIAL F-1 MODERATE HAZARD: FOOD PROCESSING, INDUSTRIAL OCCUPANCY: LIGHT HAZARD  
 GROUP B: BUSINESS, NEW BUSINESS OCCUPANCY (ANCILLARY TO FOOD PROCESSING,)

SELECT FOODS:  
 STORAGE GROUP S: LOW HAZARD STORAGE, S-2  
 STORAGE OCCUPANCY

OCCUPANT LOAD (6,956.11 OFFICE/100): 69.56 PERSONS  
 OCCUPANT LOAD (9155.9 FOOD PROCESSING/100): 91.56 PERSONS  
 OCCUPANT LOAD (390.86 CONFERENCE ROOM/15): 13.00 PERSONS  
 OCCUPANT LOAD (15381.08 STORAGE/ N/A): 0.00 PERSONS  
 TOTAL 174.12 PERSONS

**MEANS OF EGRESS:** REQUIRED/ ALLOWED/PROVIDED

THE MIN. NO. OF MEANS OF EGRESS:	2	CATERED FIT, 3 SELECT FOODS
WIDTH OF EGRESS:	35"	252"
	175 PERSON X .2	
TRAVEL DISTANCE:	400'-0"	248"-10"
COMMON PATH OF TRAVEL:	100'-0"	100'-0"
DEAD ENDS:	50'-0"	25'-0" SELECT FOOD

- NOTES:**
- EXTERIOR GLASS DOORS SHALL BE CATEGORY II SAFETY GLAZING; GLASS PANELS ADJACENT TO DOORS SHALL BE CATEGORY II SAFETY GLAZING.
  - EGRESS DOOR SHALL BE READILY OPENABLE FROM EGRESS SIDE WITHOUT USE OF A KEY, SPECIAL KNOWLEDGE OR EFFORT.
  - DOOR RELEASING MECHANISM FOR ANY LATCH SHALL BE LOCATED AT LEAST 34" AND NOT MORE THAN 48" ABOVE FINISHED FLOOR.
  - DOOR SHALL BE OPENABLE WITH NOT MORE THAN ONE RELEASING OPERATION.
  - ALL LOCKSETS SHALL BE LEVER TYPE HANDLES PER FBC 11-4.13.9, PRIVACY LOCKS, BY OWNER
  - PROVIDE DOOR STOP BY STANLEY, MODEL CD 790, OR APPROVED EQUAL.
  - NO DOOR IN ANY MEANS OF EGRESS SHALL BE LOCKED AGAINST EGRESS WHEN THE BUILDING IS OCCUPIED. ALL LOCKING DEVICES WHICH IMPEDE EGRESS OR WHICH CANNOT BE EASILY DISENGAGED SHALL BE PROHIBITED.
  - PROVIDE ABC TYPE AND K TYPE FIRE EXTINGUISHER PER FBC SECTION 906.1 AND 2009 FLORIDA FIRE PREVENTION CODE
  - ALL FINISHES SHALL BE A MINIMUM CLASS "B".
  - FIRE SUPPRESSION SYSTEM SHALL MEET NFPA 17A.
  - THE BUILDING HAS AN EXISTING FIRE SPRINKLER SYSTEM AND FIRE ALARM SYSTEM.
  - THE SITE PLAN AND BUILDING ENTRANCES SHALL COMPLY W/ FBC 11-4.1.2(1), FBC 11-4.1.2(2), FBC 11-4.3.2(1) AND FBC 11-4.14.1. PROVIDE KNOX BOXES FOR FIRE DEPARTMENT ACCESS AT VEHICULAR GATE, ACCESS GATE TO FIRE HYDRANT AND TO FIRE STANDPIPE.

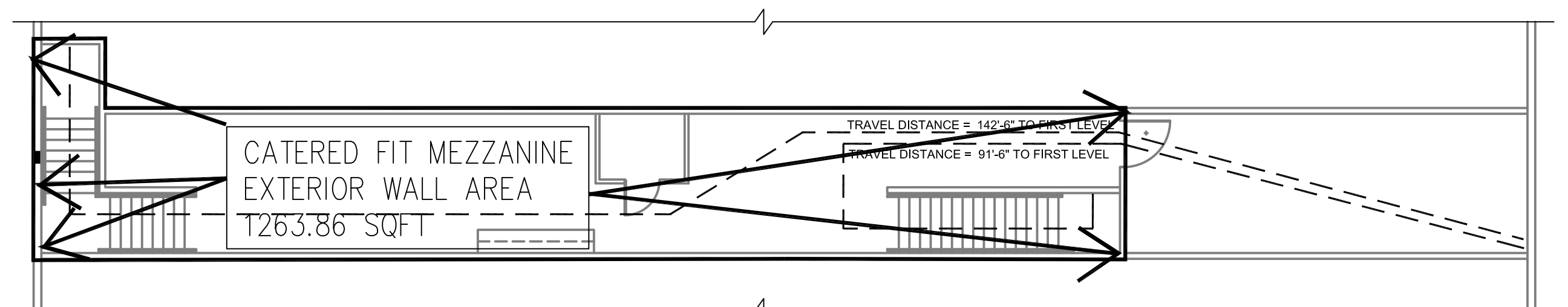

**LIFE SAFETY MEZZANINE FLOOR PLAN**  
 SCALE: 1" = 10'-0"

**LIFE SAFETY FIRST FLOOR PLAN**  
 SCALE: 1" = 10'-0"

**REVISIONS**

150601

LIFE SAFETY PLAN

SCALE:

GUSTAVO S. FRANCES  
 Florida Licence PE # 48996