

# NEWINGTON CENTER

INDUSTRIAL/FLEX SPACE

Approx. 1,500 SQFT

SPRINGFIELD, VIRGINIA

7706 Backlick Rd, Springfield, VA 22150

## ABOUT THE LOCATION:

- ✓ 1 traffic light from I-95, I-495, I-295, and Fairfax County Parkway.
- ✓ Located on one of the most traveled roads in Fairfax County.
- ✓ Ample parking.
- ✓ Lighted pylon signage.
- ✓ At-grade roll-up garage door.
- ✓ Built-out offices.
- ✓ Built-out lobby.
- ✓ Drop ceiling.
- ✓ Glass windows.
- ✓ Corner Unit.

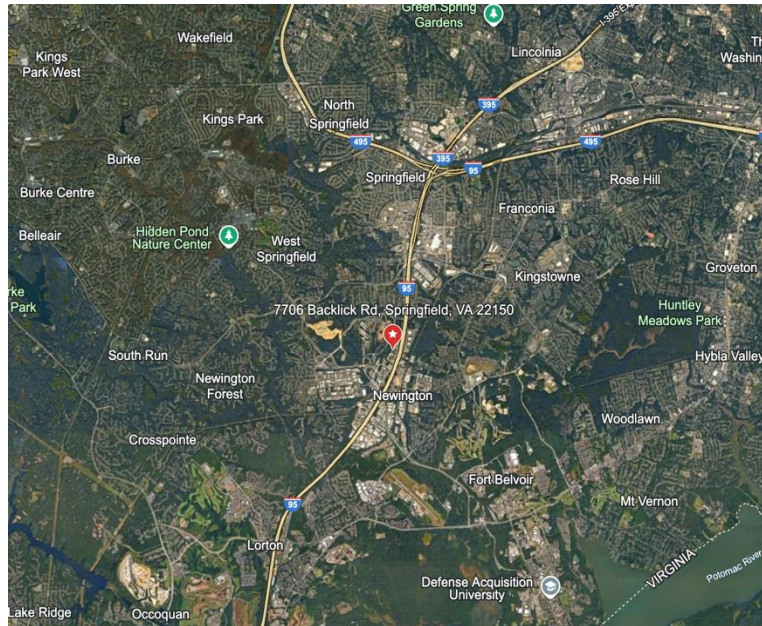

FOR FURTHER INQUIRIES:

(703) 922-7300

[Leasing@rjmcompanies.com](mailto:Leasing@rjmcompanies.com)



RJM MANAGEMENT

# NEWINGTON CENTER

## INDUSTRIAL/FLEX UNIT FOR LEASE



RJM MANAGEMENT

7706 Backlick Rd, Springfield, VA 22150

### FOR LEASE: INDUSTRIAL/FLEX SPACE

Approx. 1,500 square feet

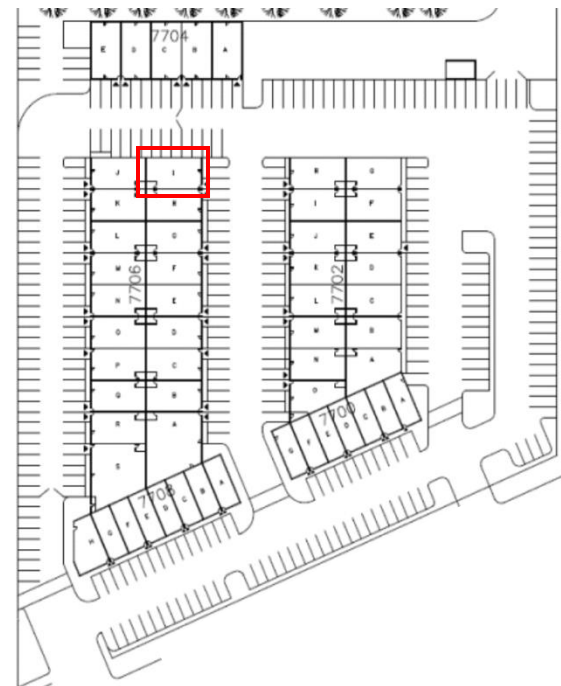
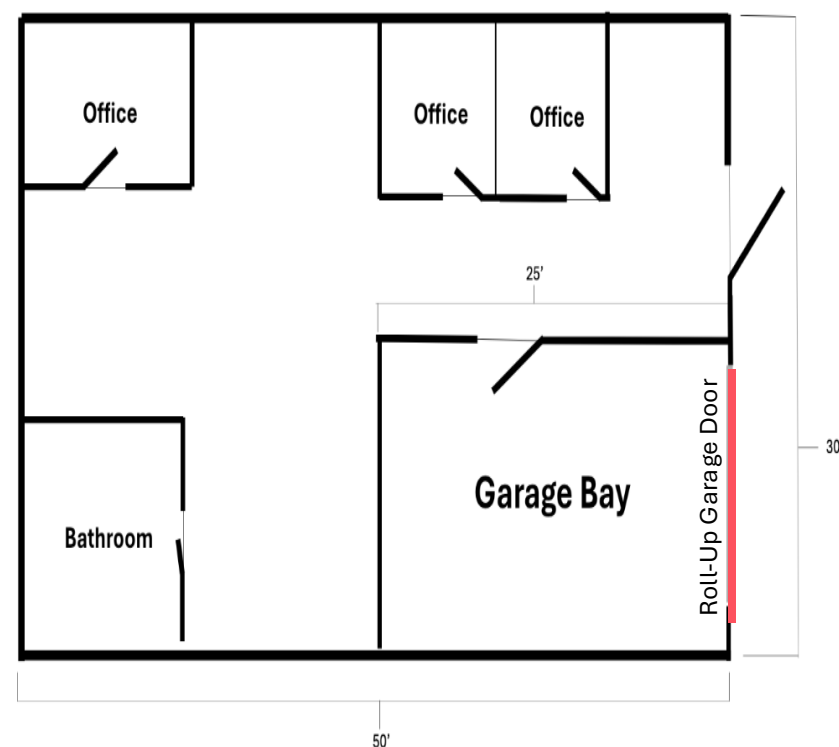

#### ABOUT THE UNIT:

- ✓ At-grade roll-up garage door.
- ✓ Front and back built-out offices.
- ✓ Built-out lobby.
- ✓ Drop ceiling.
- ✓ In unit bathroom.
- ✓ Central HVAC.
- ✓ Corner unit.
- ✓ Lighted pylon signage.

Contact Leasing Manager: (703) 992-7300 | [Leasing@rjmcompanies.com](mailto:Leasing@rjmcompanies.com)