

TORRANCE GATEWAY

PHASE III, BLDG. 10

128,508 SF

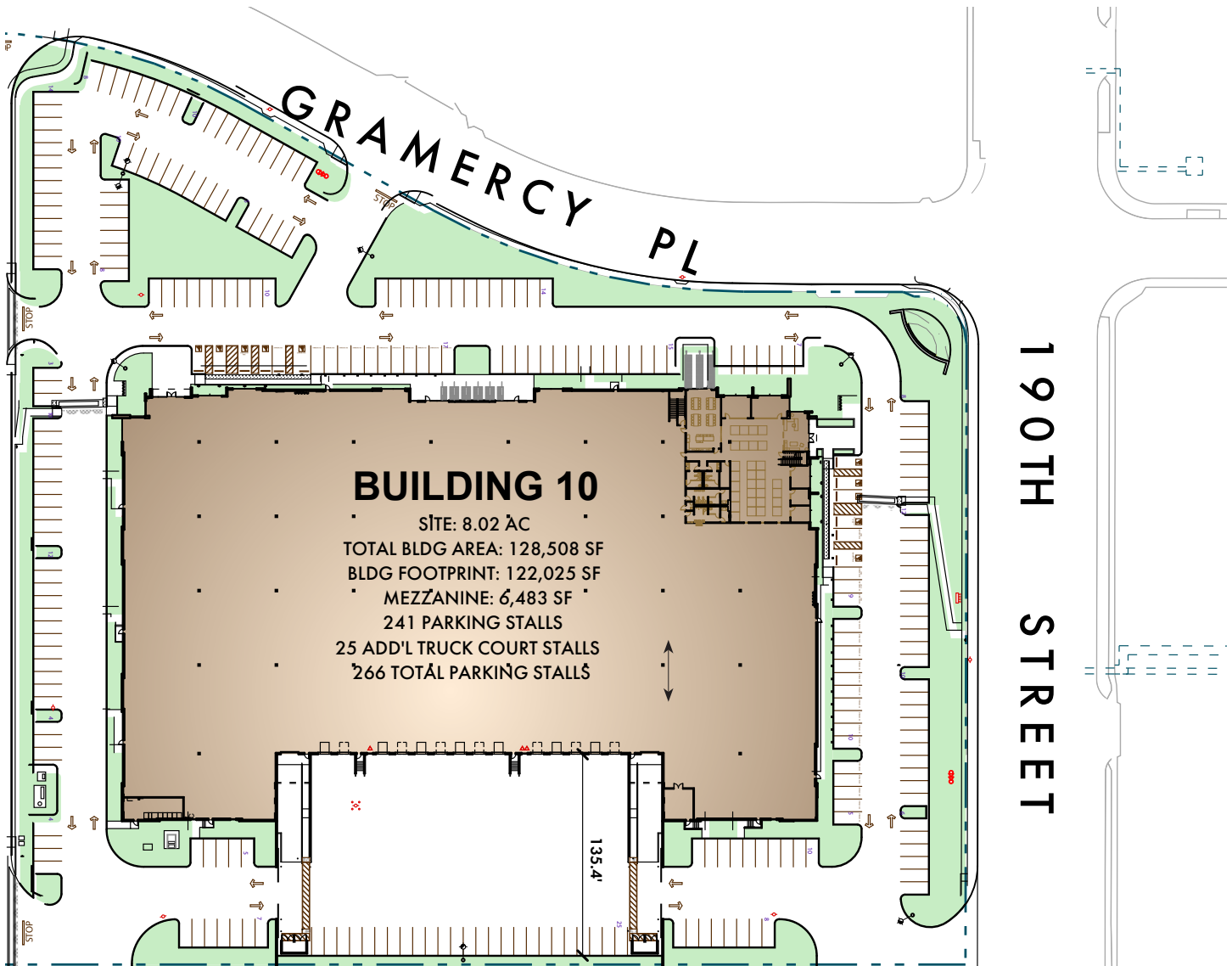

Zac Sakowski
 Executive Vice President
 Lic. 01510420
 T +1.424.294.3429
 zac.sakowski@am.jll.com



John Schumacher
 Vice Chairman
 Lic. 00987225
 T +1.310.363.4960
 john.schumacher@cbre.com

Caroline Reid
 Senior Associate
 Lic. 02188038
 +1 310 947 4219
 caroline.reid@cbre.com

Nicki Peetz
 Client Services Specialist
 Lic. 01720809
 +1 310 433 0602
 nicki.peetz@cbre.com



**SARES REGIS
GROUP**