

**AVAILABLE NOW - 700 SQFT RETAIL SPACE**



## **NOTTINGHAM SHOPPING PLAZA**

700 SQFT of newly constructed, boutique retail space available in the highly coveted Nottingham Plaza. The space is move-in ready, featuring hardwood floors throughout, marble countertops, and a brand new HVAC system with separate meters for gas and electric. The space includes one semi-private restroom shared with just one other tenant in the Plaza, with ample parking.



**Move-In Ready**  
**Neighborhood Center**  
**Abundant Parking**  
**New HVAC**

**New Grease Trap**  
**Semi-Private Bathroom**  
**Open Floorplan**  
**Marble Countertops**



**KARA KING**  
[Kara@goldbergrealtors.com](mailto:Kara@goldbergrealtors.com)  
(914) 946 - 4600

# 700 SQFT RETAIL SPACE AVAILABLE NOW



ing Plaza

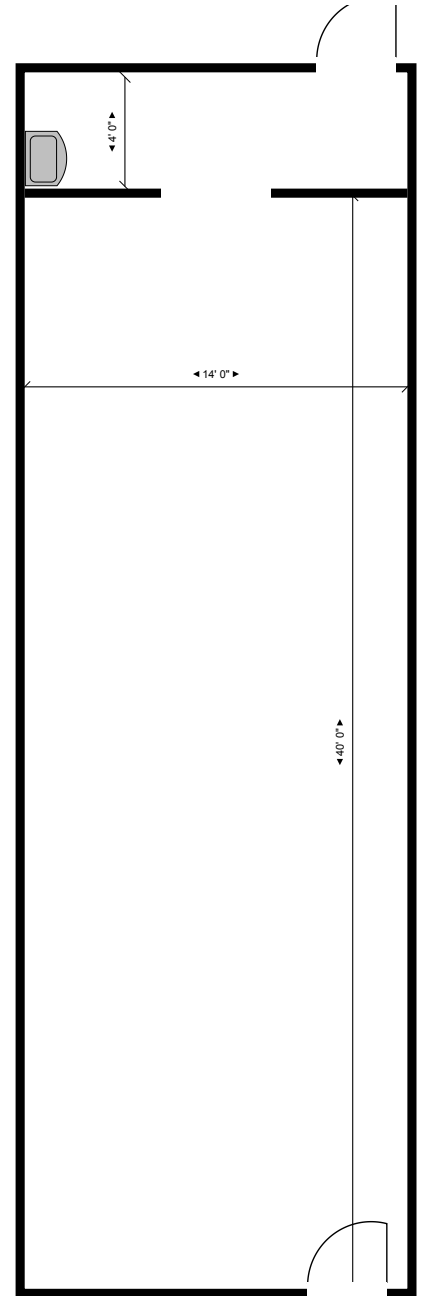

## TO ARRANGE A TOUR

**KARA KING**

Kara@GoldbergRealtors.com

(914) 946 - 4600

