



**Address:** 17600 S Santa Fe Ave, Rancho Dominguez, CA 90221  
**Cross Streets:** S Santa Fe Ave/91 Fwy

ROOF IS ON!!  
 34 Dock High Positions  
 Container/Trailer Storage (63)  
 32' Clear - ESRF - Full Concrete Yard  
 3Q 2026 Completion  
 Freeway Frontage

**Lease Rate/Mo:** TBD  
**Lease Rate/SF:** TBD  
**Lease Type:** NNN  
**Available SF:** 140,693 SF  
**Minimum SF:** 140,693 SF  
**Prop Lot Size:** 8.69 Ac / 378,598 SF  
**Term:** 5-10 Years  
**Sale Price:** NFS  
**Sale Price/SF:** NFS  
**Taxes:**  
**Yard:** Fenced / Paved  
**Zoning:** LCM1.5

**Sprinklered:** ESRF  
**Clear Height:** 32'  
**GL Doors/Dim:** 1 / Via Ramp  
**DH Doors/Dim:** 34  
**A:** 4000 **V:** 480 **O:** 3 **W:** 4  
**Construction Type:** Concrete  
**Const Status/Year Blt:** U/C  
**Whse HVAC:** No  
**Parking Spaces:** 158 / **Ratio:** 1.1:1  
**Rail Service:** No  
**Specific Use:** Warehouse/Distribution

**Office SF / #:** 9,803 SF / 6  
**Restrooms:** 4  
**Office HVAC:** Heat & AC  
**Finished Ofc Mezz:** 4,576 SF  
**Include In Available:** Yes  
**Unfinished Mezz:** 0 SF  
**Include In Available:** No  
**Possession:** 09/01/2026  
**Vacant:** N/A  
**To Show:** Call broker  
**Market/Submarket:** Carson/Compton  
**APN#:** 7306-002-034

**Listing Company:** The Klabin Company

**Agents:** [David Prior 310-329-9000](#), [Todd Taugner 310-329-9000](#), [Frank Schulz 310-329-9000](#), [Nicholas Buss 310-329-9000](#)

**Listing #:** 43448760

**Listing Date:** 09/26/2025

**FTCF:** CB300N000S000/A0AA

**Notes:** Lessee to verify all information contained herein.



This information supplied herein is from sources we deem reliable. It is provided without any representation, warranty or guarantee, expressed or implied as to its accuracy. Prospective Buyer or Tenant should conduct an independent investigation and verification of all matters deemed to be material, including, but not limited to, statements of income and expenses. Consult your attorney, accountant, or other prof. advisor.



**KLABIN**  
 A member of the CORFAC International network

**KLABIN.COM**

19700 S. VERMONT AVENUE, SUITE 100  
 TORRANCE, CA 90502  
 DRE 00824993

**310.329.9000**





SITE PLAN

INDUSTRIAL PROPERTY FOR LEASE

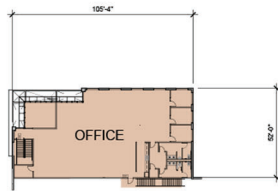

MEZZANINE

- 63 TRAILER STORAGE POSITIONS
- 158 AUTO PARKING SPACES