

CANYON RIDGE TECHNOLOGY PARK
9449 CARROLL PARK DRIVE
SORRENTO MESA

Upgraded Mid-Tech Opportunity

±41,782 SF



Building Highlights

9449 CARROLL PARK DRIVE / ±41,782 SF

- **Workspace**
 - First floor: 29,293 SF
 - Second floor: 12,488 SF
- **Upgraded Full-Building Workspace**
 - Entryway updates, including a modernized portal
 - Flexible office, lab and warehouse space
- **Enhanced Indoor-Outdoor Workspace**
 - New roll-up door connecting the break room to the open-air workspace
- **Workplace Features**
 - Connected outdoor workspaces and gathering areas with event-ready BBQ stations
- **Signage:** Building top and monument signage opportunities
- **Parking:** 3.7:1,000 SF, 155 surface stalls
- **Warehouse Clearance:** 12'
- **Loading Dock:** Four 9'x11' roll-up doors
- **Fire Sprinklers:** .21 GPM/1,500 SF
- **Electrical Expandable To:**
 - MSA 1,600 Amps, 480/277 Volts, 3-Phase, 4-Wire, with a 500KVA utility service transformer
 - Generator 480/277 Volts, 300KW-375 KVA, 451 Amps
- **HVAC:** 39-ton rooftop unit
- **Central Sorrento Mesa Location**
 - Easy access to the 805, 15, 52 and 56 freeways
 - San Diego's fastest-growing hub for tech and life sciences
 - Minutes to UC San Diego, Scripps Institute, La Jolla UTC, upscale dining and retail at Westfield UTC

FLOOR PLAN

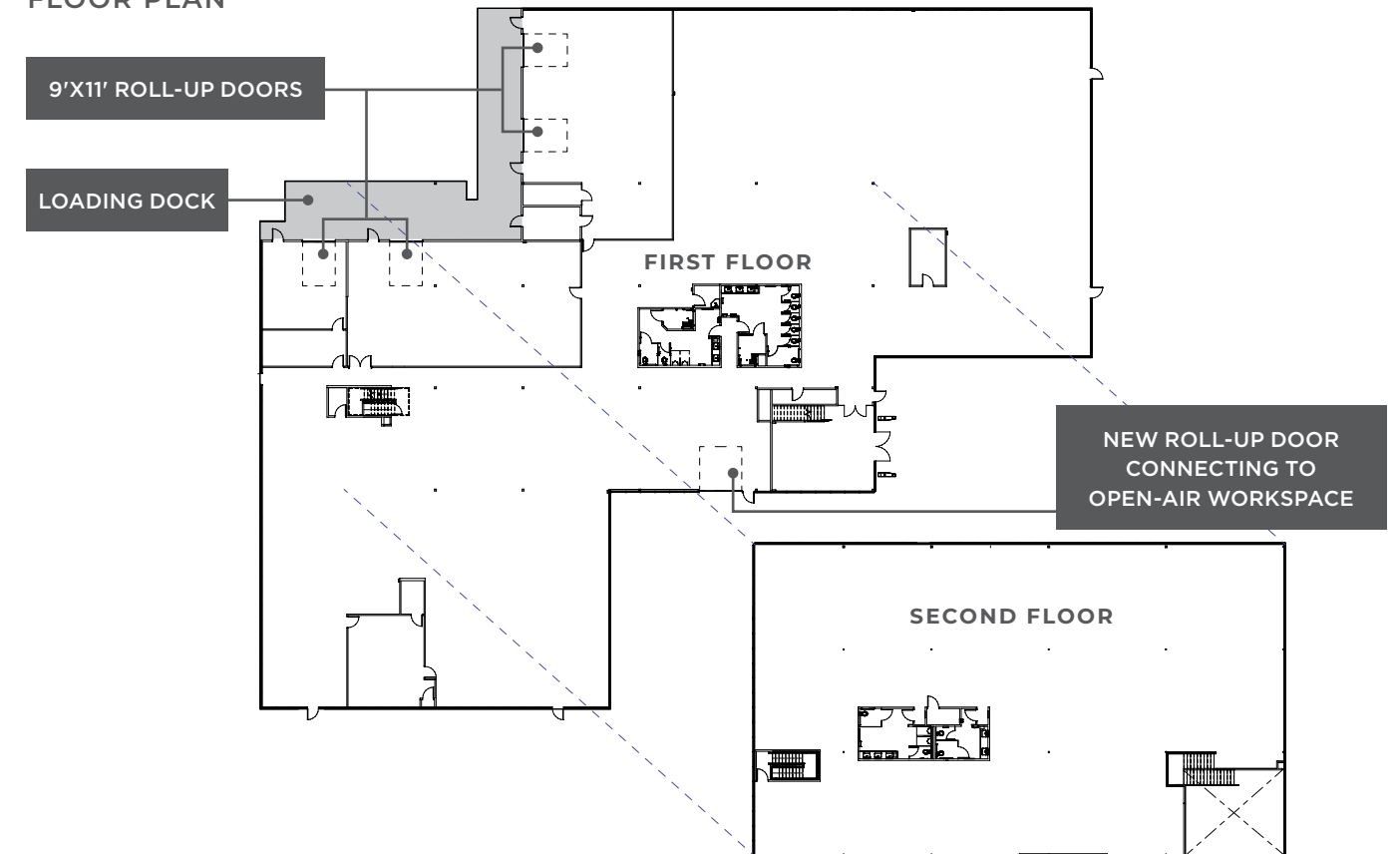

// 9449 CARROLL PARK DRIVE

All properties are offered for lease through Irvine Management Company, a licensed real estate broker DRE LIC. #02041810

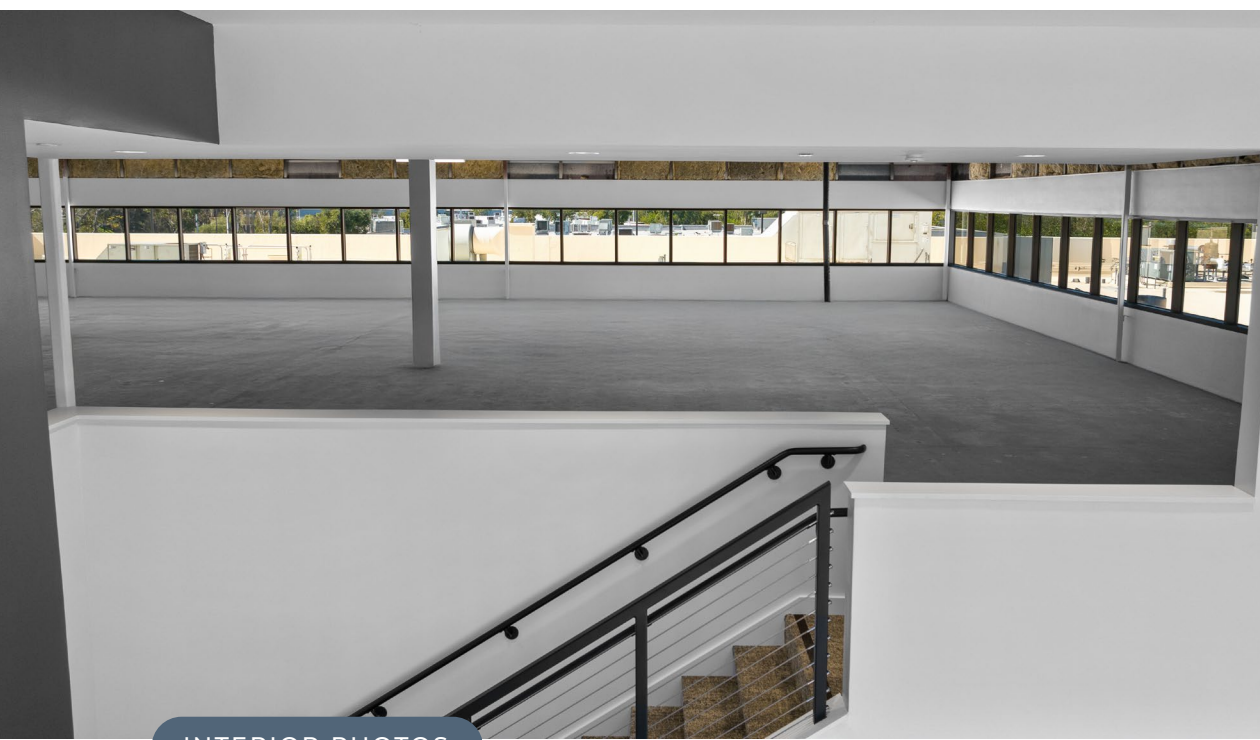

INTERIOR PHOTOS

Where High-Performing Teams Work

Step into a space designed for productivity and collaboration. The bright, modern interiors will feature stunning floor-to-ceiling windows, offering an abundance of natural light and inspiring views.

// 9449 CARROLL PARK DRIVE

All properties are offered for lease through Irvine Management Company, a licensed real estate broker DRE LIC. #02041810



INTERIOR PHOTOS

Refreshed lobby with wood slat feature wall and decorative light fixtures.

// 9449 CARROLL PARK DRIVE

All properties are offered for lease through Irvine Management Company, a licensed real estate broker DRE LIC. #02041810

N
MAP NOT TO SCALE



LOCATION

Canyon Ridge Technology Park

Property Map

Contemporary on-site conveniences and an unbeatable Sorrento Mesa location make Canyon Ridge Technology Park the ultimate place to work.

- EV CHARGING
- OUTDOOR WORKSPACE (WIFI-ENABLED)

// 9449 CARROLL PARK DRIVE

All properties are offered for lease through Irvine Management Company, a licensed real estate broker DRE LIC. #02041810

We Create Places that *Bring People Together to Succeed*

More than 18 million people choose to live, work, shop, stay and play in Irvine Company's 129 million SF real estate portfolio. Decades of thoughtful planning and stewardship ensure we deliver exceptional placemaking and customer experiences — all backed by our commitment to long-term ownership and industry-leading financial stability.

Industry-leading Financial Stability

Our unmatched capital resources ensure we uphold our standards of excellence, regardless of market conditions.

Future-Proof Flexibility

A range of lease options and our collaborative partnership support your growth.

Elevated Customer Care

Expert teams, fast response times and personalized service ensure worry-free workdays.

Ready for What's Next

From enabling hybrid solutions to supporting diverse work styles, we keep your business at the forefront of what's possible.

Activated to Attract & Engage Teams

Experience-driven amenities make your workplace an essential employee destination.

Sustainability By Design

We strive to lead and innovate for the preservation of environmental resources.



