

The Plaza at Woodbridge

675 Route 1, Woodbridge, NJ 07095



GLA: 414,002 SF

Acres: 28.66

Parking Spaces: 1,990/Ratio: 4.81:1,000 SF

County: Middlesex

For Leasing Contact:

James Cozine

Tel: 201-571-3515

jcozine@uedge.com

UEDGE.COM

Demographics: 3-Mile Radius



Population
142,029



Households
49,366



Daytime Pop.
145,336



AHHI
\$113,203



MHHI
\$87,588



College Ed.
63.4%

Demographics data Provided by: ESRI

The Plaza at Woodbridge

675 Route 1, Woodbridge, NJ 07095



Retail Spaces (SF)

F1	red lobster	7,865
F2	Bonefish_Grill	10,500
F3	Bank of America	4,000
F4	Tgi Friday's Inc.	8,500
1A	Best Buy	45,400
2A	Harmon	5,906
3A	Raymour & Flanigan	40,955
4A	Retro Fitness	18,022
5A	Available	2,002
6A	Buy Buy Baby	58,441
7A	Karate Usa	1,946
8A	Available	6,554
9A	U-Yee Sushi	4,040
10B	Meltzer Eye Care	1,360
11A	Jesus Book And Gift Store	5,400
12A	Harbor Freight Tools	16,265
13A	China Cafe	1,560
13B	Available	5,752
15A	Available	1,700
16A	Contempo Nail Spa li Inc.	1,240
16B	Supercuts	1,240
17A	Nunzio's Pizza	2,520



THIS EXHIBIT SHALL NOT BE DEEMED A WARRANTY, REPRESENTATION OR AGREEMENT BY LANDLORD THAT THE LAYOUT OR CONFIGURATION OF THE SHOPPING CENTER, OR ANY PART THEREOF, SHALL REMAIN AS SHOWN HEREON. LANDLORD RESERVES THE RIGHT TO MODIFY THE SHOPPING CENTER, OR ANY PART THEREOF, IN ACCORDANCE WITH THE PROVISIONS OF THE LEASE.

The Plaza at Woodbridge

675 Route 1, Woodbridge, NJ 07095



Retail Spaces (SF)

AA Available	19,317
BB Lincoln Tech	31,500

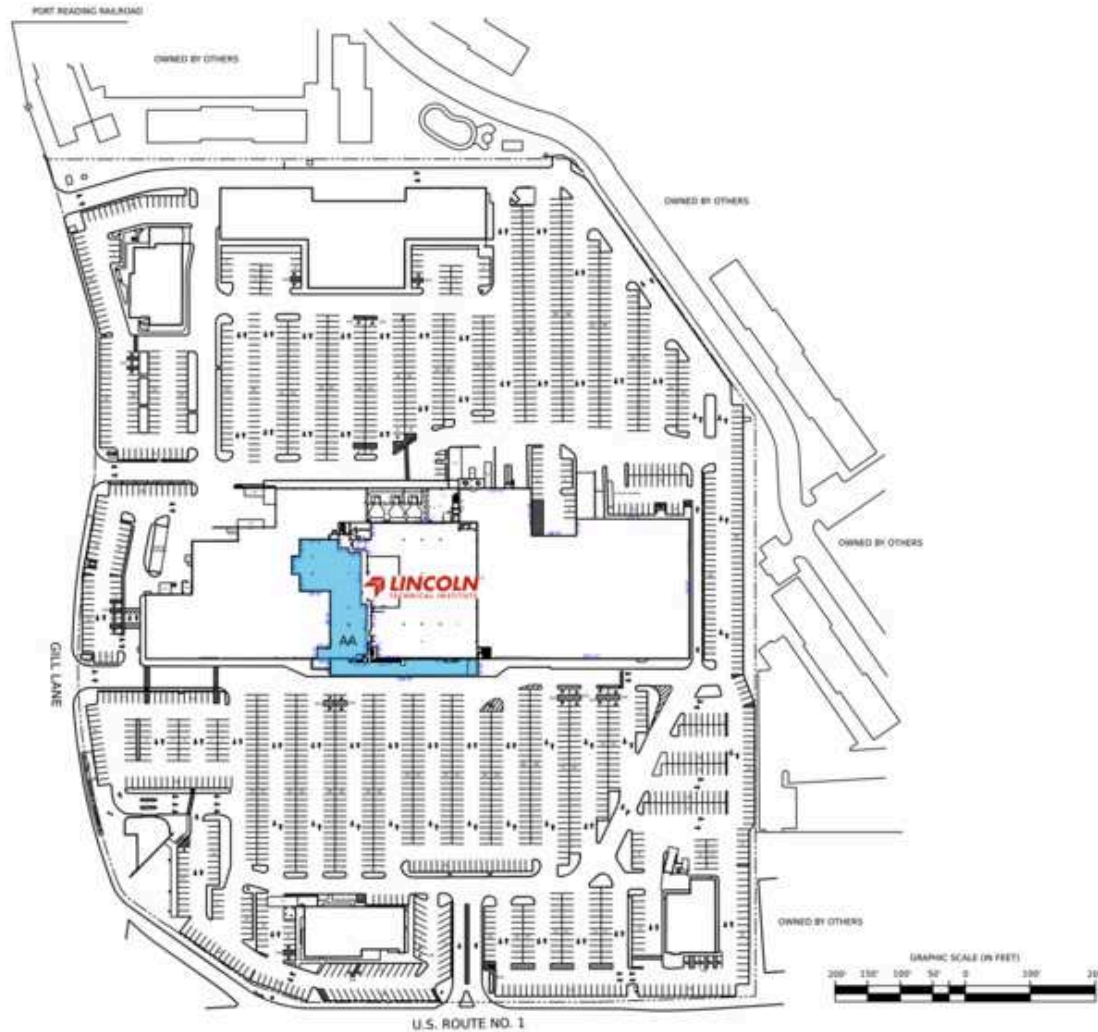

THIS EXHIBIT SHALL NOT BE DEEMED A WARRANTY, REPRESENTATION OR AGREEMENT BY LANDLORD THAT THE LAYOUT OR CONFIGURATION OF THE SHOPPING CENTER, OR ANY PART THEREOF, SHALL REMAIN AS SHOWN HEREON. LANDLORD RESERVES THE RIGHT TO MODIFY THE SHOPPING CENTER, OR ANY PART THEREOF, IN ACCORDANCE WITH THE PROVISIONS OF THE LEASE.

The Plaza at Woodbridge

675 Route 1, Woodbridge, NJ 07095



Retail Spaces (SF)

3B Raymour & Flanigan 35,084

5B Extra Space Storage 61,551

6B Extra Space Storage 15,382

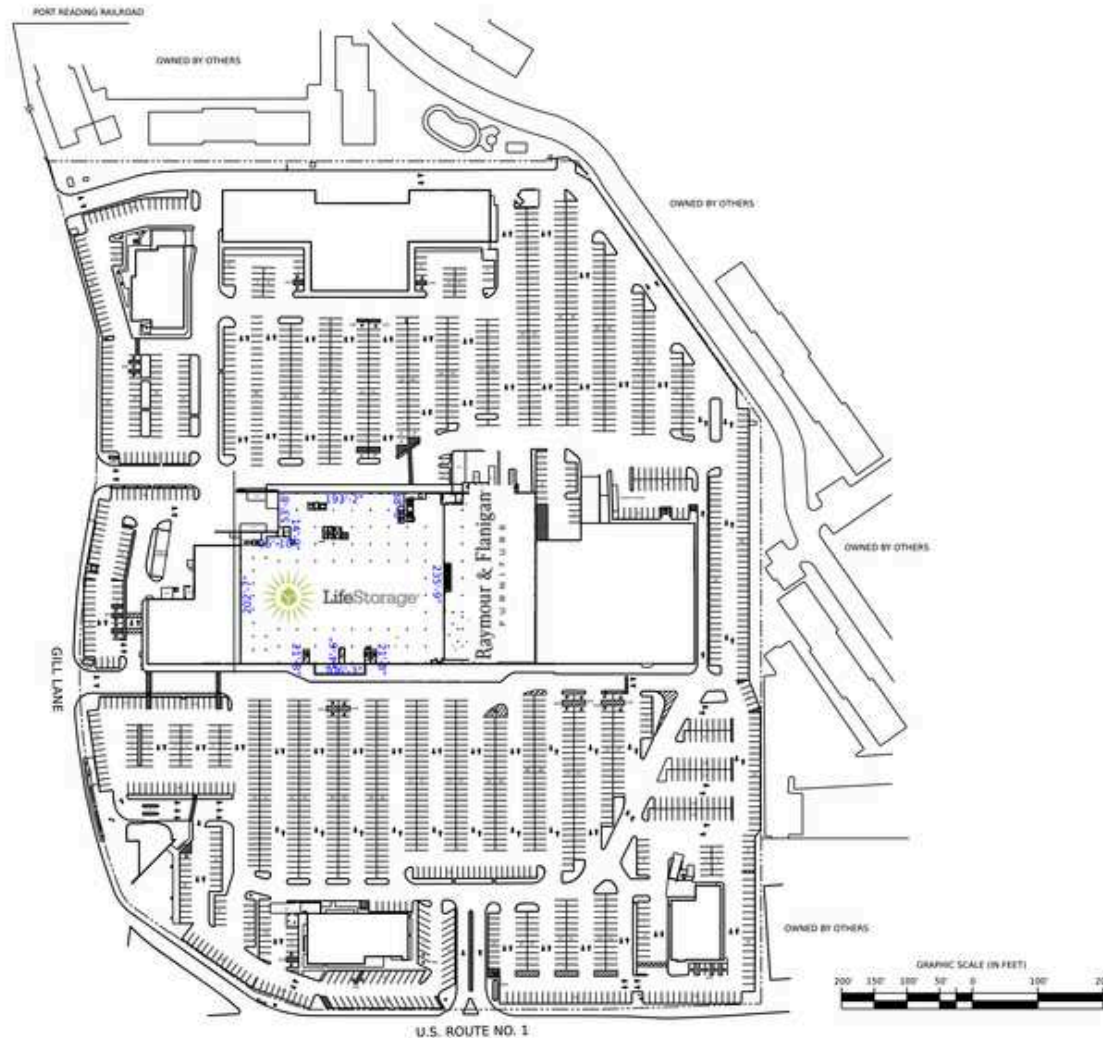

THIS EXHIBIT SHALL NOT BE DEEMED A WARRANTY, REPRESENTATION OR AGREEMENT BY LANDLORD THAT THE LAYOUT OR CONFIGURATION OF THE SHOPPING CENTER, OR ANY PART THEREOF, SHALL REMAIN AS SHOWN HEREON. LANDLORD RESERVES THE RIGHT TO MODIFY THE SHOPPING CENTER, OR ANY PART THEREOF, IN ACCORDANCE WITH THE PROVISIONS OF THE LEASE.