

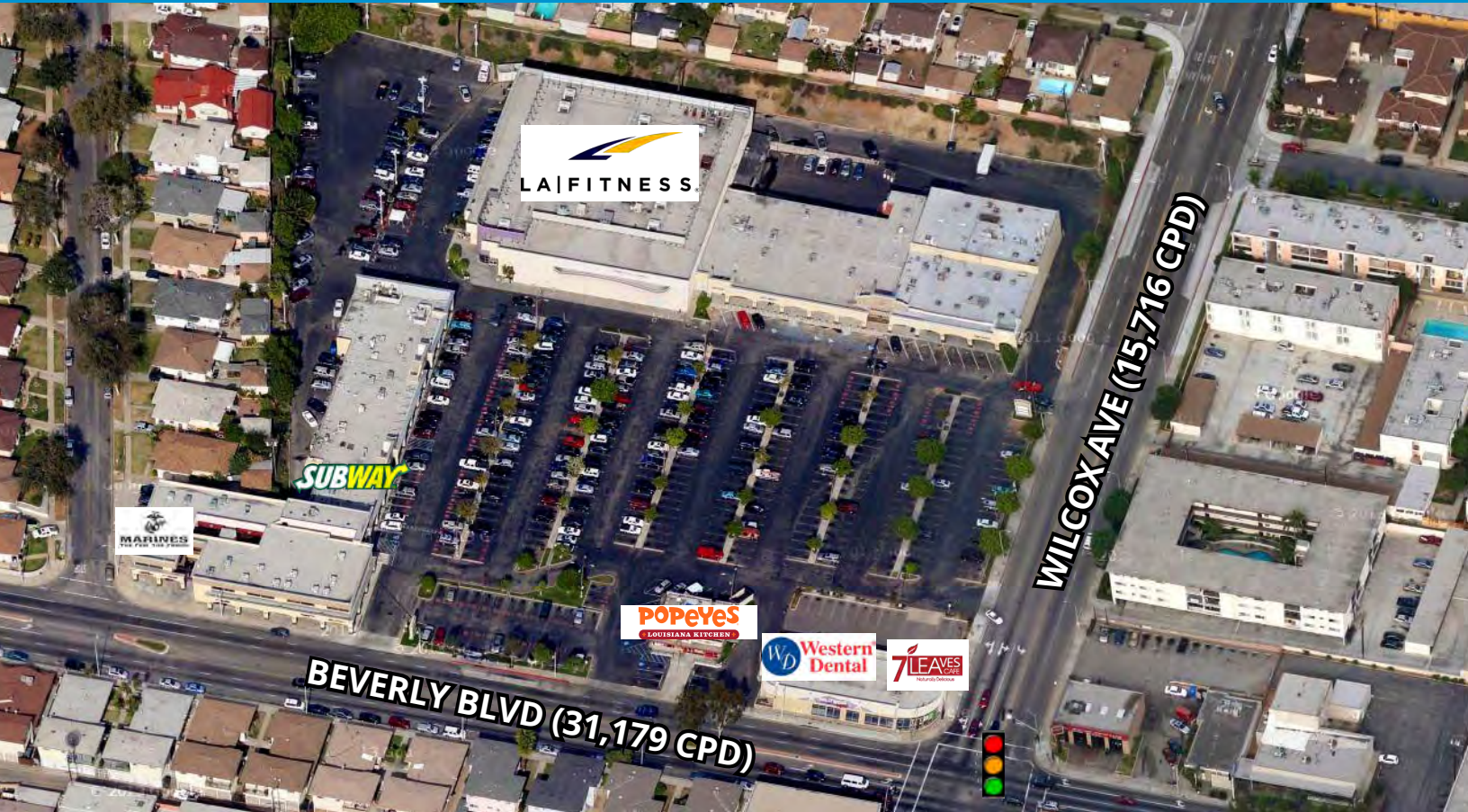

BEVERLY WILCOX VILLAGE

2200 W. BEVERLY BLVD (NWC BEVERLY BLVD & WILCOX AVE)
MONTEBELLO, CA 90640



SHOPPING CENTER CHARACTERISTICS

CENTER TYPE: Neighborhood Shopping Center

CO-TENANTS: LA Fitness, Western Dental, Popeye's, Subway & more

AVAILABILITY

AVAILABILITY: 1,250 SF
1,035 SF Office (2nd Floor)

LEASE RATE: Negotiable

TRAFFIC COUNTS

BEVERLY BLVD & WILCOX AVE: ±46,895 CPD (Inrix 2025)

HIGHLIGHTS

- > Neighborhood shopping center at the Northwest corner of Beverly Blvd & Wilcox Ave, a strong signalized intersection
- > Excellent mix of national and regional restaurants, retail and service tenants
- > Located in the heart of Montebello near Montebello's Civic Center, DMV, and two high schools
- > Strong 1-mile demographics with over 30,000 residents, over 10,000 in daytime population, and average household income of \$82,000

FOR FURTHER INFORMATION PLEASE CALL: +1 323 609 3172

JAMES RODRIGUEZ
SR. VICE PRES. | LIC. NO. 01164377
james.rodriguez@colliers.com

MICHAEL BOHORQUEZ
VICE PRES. | LIC. NO. 01870842
michael.bohorquez@colliers.com

COLLIERS INTERNATIONAL GREATER LOS ANGELES, INC | DTLA
865 S. Figueroa St., Suite 3500 | Los Angeles, CA 90017
<https://tinyurl.com/RodriguezBohorquezTeam>



BEVERLY WILCOX VILLAGE

2200 W. BEVERLY BLVD (NWC BEVERLY BLVD & WILCOX AVE)
MONTEBELLO, CA 90640



FOR FURTHER INFORMATION PLEASE CALL: +1 323 609 3172

JAMES RODRIGUEZ
SR. VICE PRES. | LIC. NO. 01164377
james.rodriquez@colliers.com

MICHAEL BOHORQUEZ
VICE PRES. | LIC. NO. 01870842
michael.bohorquez@colliers.com

COLLIERS INTERNATIONAL GREATER LOS ANGELES, INC | DTLA
865 S. Figueroa St., Suite 3500 | Los Angeles, CA 90017
<https://tinyurl.com/RodriguezBohorquezTeam>

BEVERLY WILCOX VILLAGE

2200 W. BEVERLY BLVD (NWC BEVERLY BLVD & WILCOX AVE)
MONTEBELLO, CA 90640

2ND FLOOR

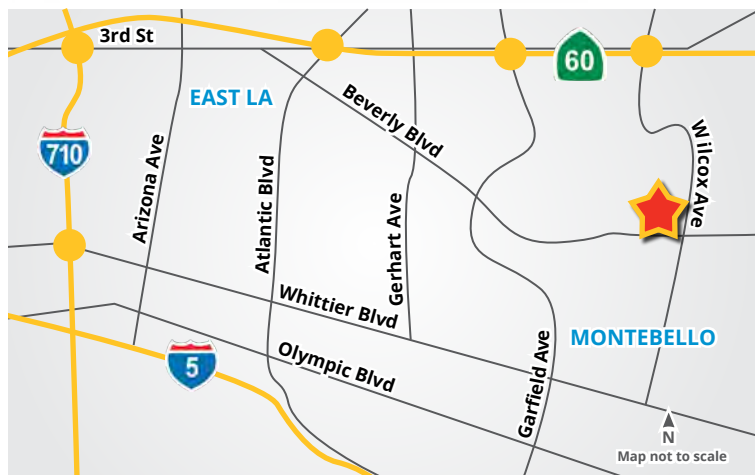
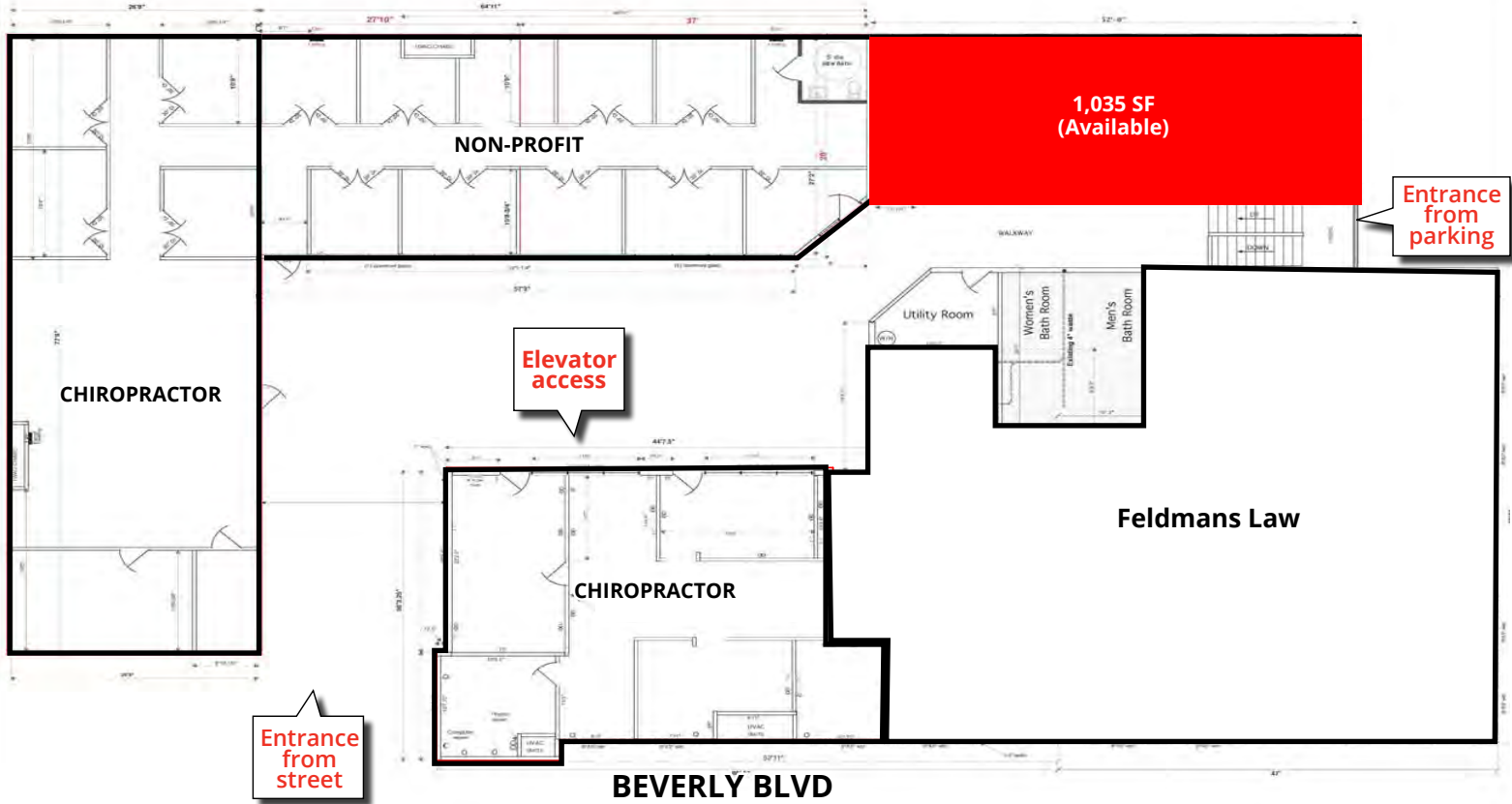

2025 DEMOGRAPHICS	1 Mile	3 Mile	5 Mile
Population:	30,195	209,095	643,366
Total Households:	9,912	64,549	193,070
Hispanic Population:	80.2%	73.2%	73.6%
Avg. HH Income:	\$98,658	\$101,744	\$98,760
Daytime Population:	9,814	94,280	261,089

Source: Esri

FOR FURTHER INFORMATION PLEASE CALL: +1 323 609 3172

JAMES RODRIGUEZ
SR. VICE PRES. | LIC. NO. 01164377
james.rodriquez@colliers.com

MICHAEL BOHORQUEZ
VICE PRES. | LIC. NO. 01870842
michael.bohorquez@colliers.com

COLLIERS INTERNATIONAL GREATER LOS ANGELES, INC | DTLA
865 S. Figueroa St., Suite 3500 | Los Angeles, CA 90017
<https://tinyurl.com/RodriguezBohorquezTeam>

LEASING > FITNESS ANCHORED RETAIL CENTER



BEVERLY WILCOX VILLAGE

2200 W. BEVERLY BLVD (NWC BEVERLY BLVD & WILCOX AVE)
MONTEBELLO, CA 90640

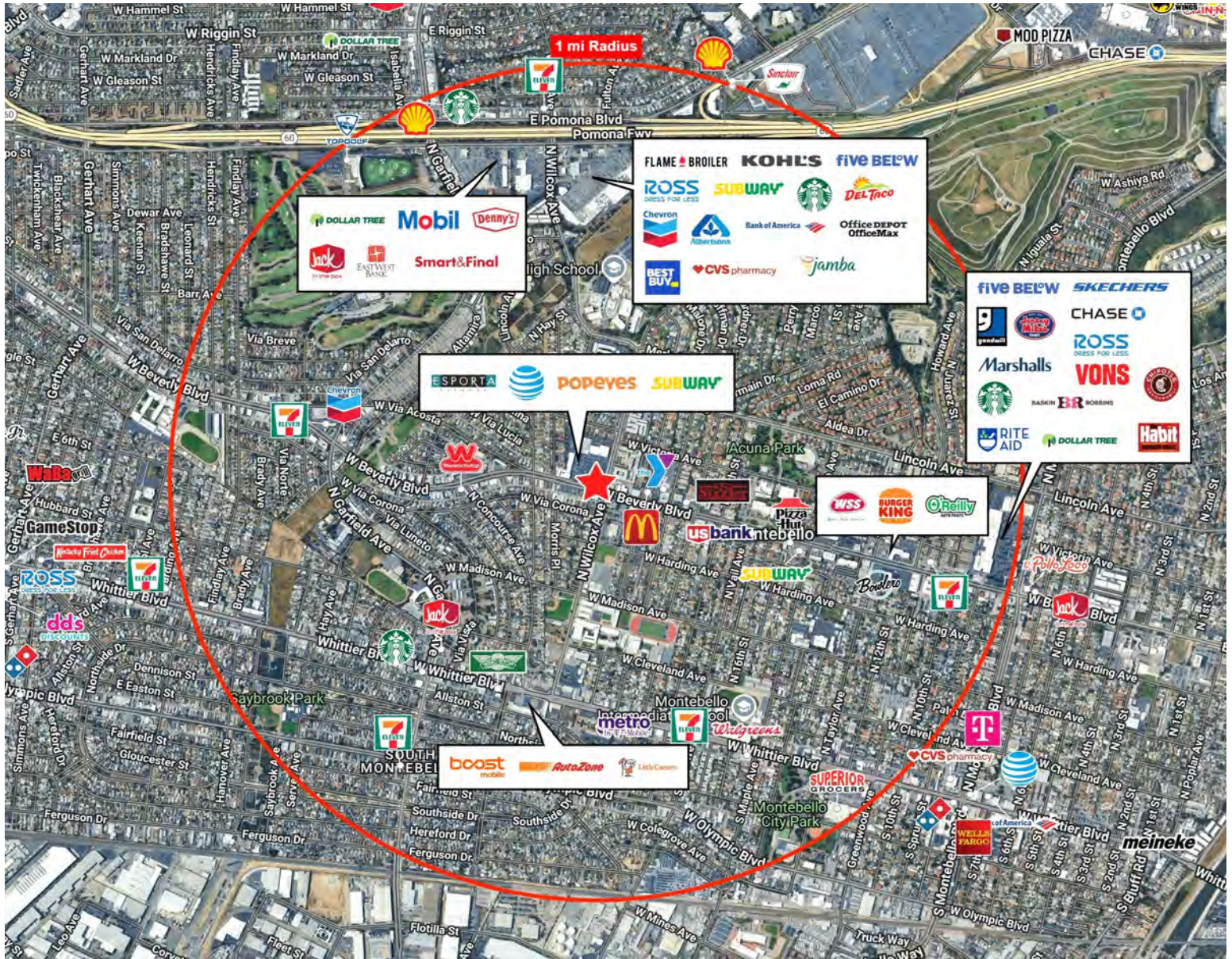

FOR FURTHER INFORMATION PLEASE CALL: +1 323 609 3172

JAMES RODRIGUEZ
 SR. VICE PRES. | LIC. NO. 01164377
 james.rodriquez@colliers.com

MICHAEL BOHORQUEZ
 VICE PRES. | LIC. NO. 01870842
 michael.bohorquez@colliers.com

COLLIERS INTERNATIONAL GREATER LOS ANGELES, INC | DTLA
 865 S. Figueroa St., Suite 3500 | Los Angeles, CA 90017
<https://tinyurl.com/RodriguezBohorquezTeam>

Colliers International Greater Los Angeles, Inc. makes no guarantees, representations or warranties of any kind, expressed or implied, regarding the information including, but not limited to, warranties of content, accuracy and reliability. This publication is the copyrighted property of Colliers International Greater Los Angeles, Inc. and /or its licensor(s). 2025. All rights reserved.