

7,170 SF CLASS A - INDUSTRIAL FOR LEASE

7705 SOMERSET BLVD.
PARAMOUNT, CA 90723

\$1.15 NET

- \$0.20 Net Charges
- 895 sf 1st Floor Office,
1,048 sf Mez
Storage (Included in total)
- 5 Year Minimum
- 3.00% Base Increases

LISTING FEATURES



- 6 Reserved Car Spaces, includes 1 shared handicap, & 51 Visitor
- 21' Clear
- Built in 1991 - Planned Restoration 1Q '26
- (1) Dock & (1) Grade Level Doors - 60' Concrete Truckwell
- .45/3000 Sprinklers w/ Smoke Vents; 200 Amp, 480/277 Volt, 3 Phase, 4 Wire w/ Add'l Conduit Capacity
- Natural Gas Stubbed; 2" Heavy Duty Water Service
- Zoned: M-2 Heavy Manufacturing
- Experienced Landlord w/ Additional Buildings for Expansion
- Excellent Freeway Access
- Master CUP Grants Immediate Occupancy & Expedites Business License Approval
- March 2026 Occupancy

LYONS & LYONS PROPERTIES
Chuckie Lyons - Broker Lic. 00625110
Colin O'Brien - Lic. 02145353



(310) 414-4500
colin@lyonsandlyons.net

WWW.LYONSANDLYONS.NET
880 Apollo Street, Suite 227
El Segundo, CA 90245

This information has been obtained from sources believed reliable. We have not verified it and make no guarantee, warranty or representation about it. Any projections, opinions, assumptions or estimates used are for example only and do not represent the current or future performance of the property. You and your advisors should conduct a careful, independent investigation of the property to determine to your satisfaction the suitability of the property for your needs. Photos herein are the property of their respective owners and use of these images without the express written consent of the owner is prohibited.

7705 Somerset Boulevard
City of Paramount
California 90723

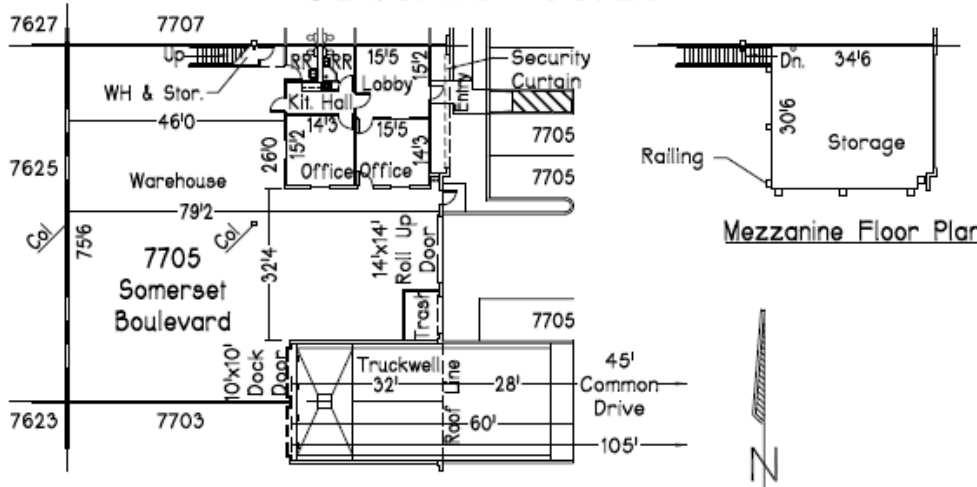

Mezzanine Floor Plan

Parking Summary

- 6 Standard Parking
- 0 Compact Parking
- 1 Handicap Parking (Shared)

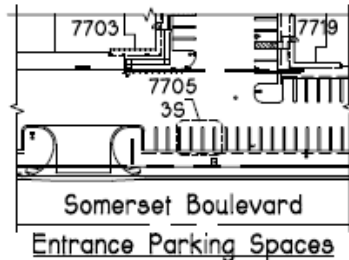

Entrance Parking Spaces

Scale: 1" = 100'

Total Sq. Ft.
w/ Mezzanine
7,170 Sq. Ft.

Footprint
6,122 Sq. Ft.

Ground Floor Office
(excl. Entry & Shop RR)
895 Sq. Ft.

Mezzanine Storage
1,048 Sq. Ft.

SOMERSET BUSINESS CENTRE

- *Quality Concrete Tilt-up Distribution/ Manufacturing Facility w/ Many Extra Features Developed by Lyons & Lyons Properties.
- *Loading: Overnight 60' Concrete Truckwell Dock & Roll-Up Dripline Door w/ Large 105' Turnaround Radius; (1) 10'x10' Dock High Door and (1) 12'x14' Ground Level Door.
- *Warehouse: High Piled Storage & Class 4 Commodity Rating (Class 5 Possible); .45/3000 Fire Sprinklers; White Scrim Ceilings; 3% Secured Vented Skylights including 2% Smoke Vent Skylights; 21' Clear Height; Pearl White Walls; LED Lights; Polished and Sealed 5" Thick Reinforced Concrete Slab.
- *Utility Services: 200 Amp 277/480 Volt 3 Phase; Natural Gas Stubbed; 2" Heavy Duty Water Service.
- *Ground Floor Office w/ Spacious 9' Ceilings; 2'x4' LED Light Fixtures; Central HVAC; Kitchen Unit with Microwave Outlet; Restroom Shower; Monitoring Windows; Polished and Sealed Concrete Floor & Vinyl Basecoat; Remote Controlled Exterior Metal Office Security Curtains.
- *Mezzanine Storage w/ 125 PSF Capacity with VCT Flooring and Vinyl Basecoat; Can be built-out as Additional Office Subject to City Staff Approval.
- *Exclusive Parking Stalls (Indicated by 7705); Heavy Duty Concrete Paving.
- *Secured Concrete Trash Enclosure Vault.
- *Experienced Landlord with Additional Buildings for Expansion.
- *Property Zone M-2: Heavy Manufacturing. *Low City Business Fees.

Scale: 1" = 30' 19040

David O. Roberts P.E., Inc.
17280 Newhope St., #17
Fountain Valley, CA 92708
(949) 633-1621
Email: dave@DORoberts.com

1-22-2026

Industrial Park Highlights

- Serene/colorful lush landscaping with seasonal changes, and drought tolerant plants (hybrid tropical/desert plants)
- White roofs – better for keeping warehouse cool
- Curb mounted smoke hatch vented skylights
- Electric and manual roll down gates for exterior of glass storefronts
- Security cameras & AI monitoring system
- EV Charging Station
- New HVAC units
- Front Entrance Security Gates

LYONS & LYONS PROPERTIES
Chuckie Lyons - Broker Lic. 00625110
Colin O'Brien - Lic. 02145353



(310) 414-4500
colin@lyonsandlyons.net

WWW.LYONSANDLYONS.NET
880 Apollo Street, Suite 227
El Segundo, CA 90245