

Light Industrial/Flex Space | For Lease

Woodlake Business Park

241 Lathrop Way, Suite B | Sacramento, CA 95815



Availability:
SUITE B
±9,748 SF

CBRE

Building Features

Lease Rate: \$0.80 PSF/Month, NNN

- Total Available: ±9,748 SF
- Light Industrial/Flex space
- Abundant, on-site parking adjacent to building entrances
- Office areas include: Multiple stall restrooms, break room, private offices.
- One (1) GL roll-up door
- Minutes to Sacramento's Central Business District and Midtown Submarket
- Proximity to over 30 restaurants and 2.8M SF of retail shopping
- Bike to work using the American River Parkway

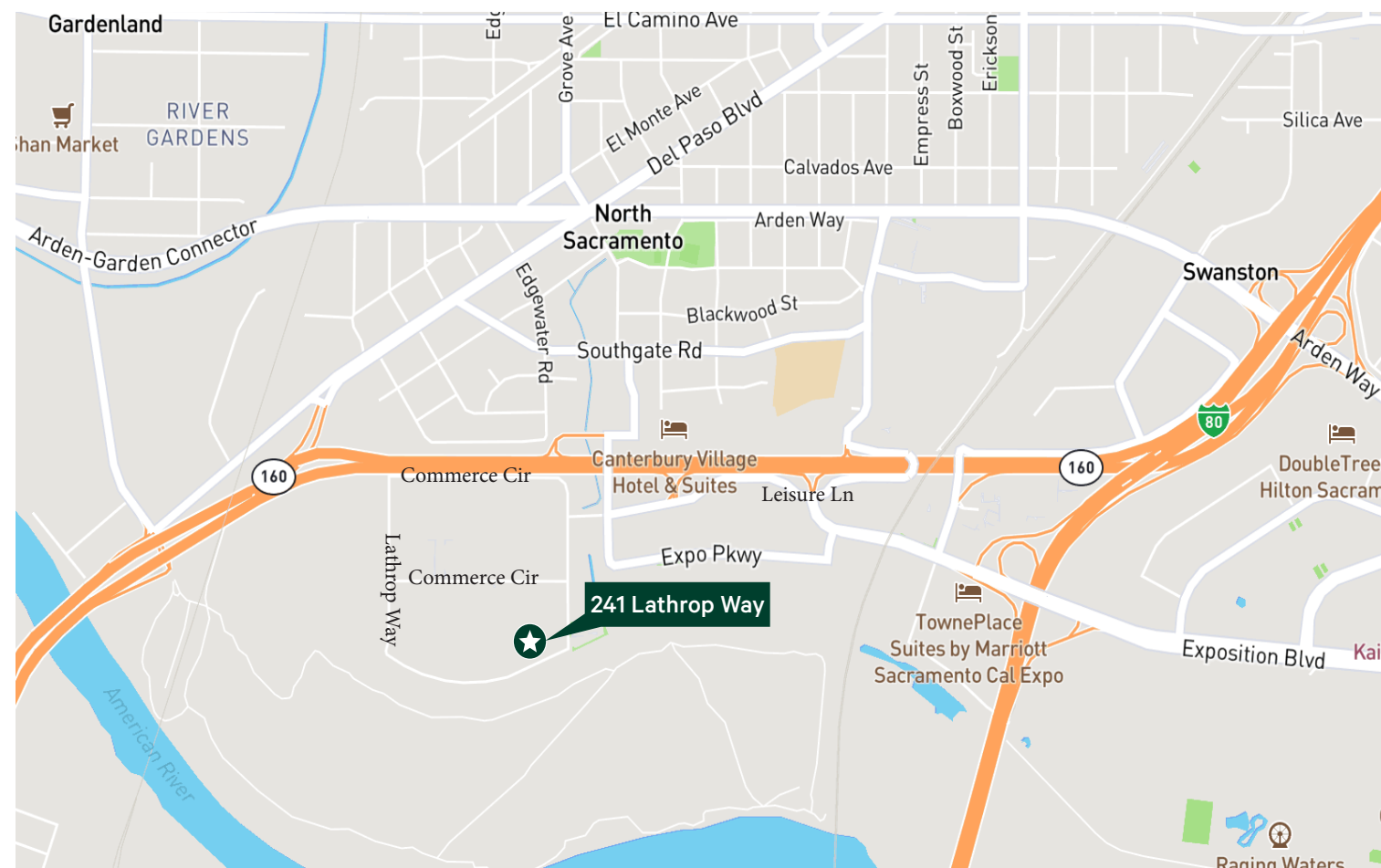

Floor Plan

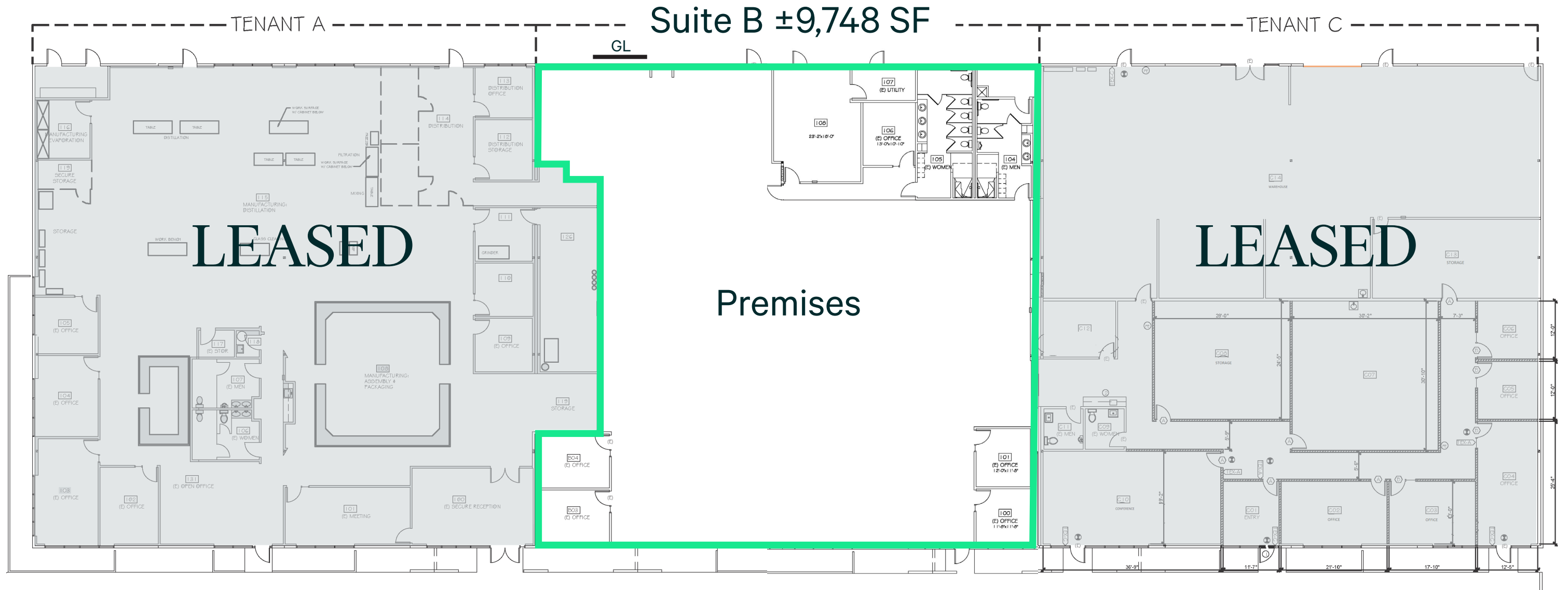

Woodlake Business Park

241 Lathrop Way, Suite B | Sacramento, CA 95815

Contact Us:

Tony Whittaker

Senior Vice President

+1 916 492 6914

tony.whittaker@cbre.com

Todd Sanfilippo, SIOR

Executive Vice President

+1 916 781 4859

todd.sanfilippo@cbre.com

Matt Susac

First Vice President

+1 916 781 4832

matt.susac@cbre.com