

For Lease

# Dawson Creek Mall

LOCATION

11000 8th Street  
Dawson Creek, BC  
V1G 4K6, Canada

LEASING CONTACTS

ALYCIA KAMER  
Director, Commercial Leasing  
604 558 8665  
akamer@bosaproperties.com

CALLY ZERING  
Leasing Manager, Commercial  
778 357 0175  
czering@bosaproperties.com

RACHEL SANGHA  
Leasing Coordinator, Commercial  
604 416 0286  
rsangha@bosaproperties.com



**bosa**  
properties

OVERVIEW

Dawson Creek Mall, reinvigorated with a complete exterior renovation, is the central shopping hub of the community as well as the neighbouring, and rapidly growing, Peace River Region.

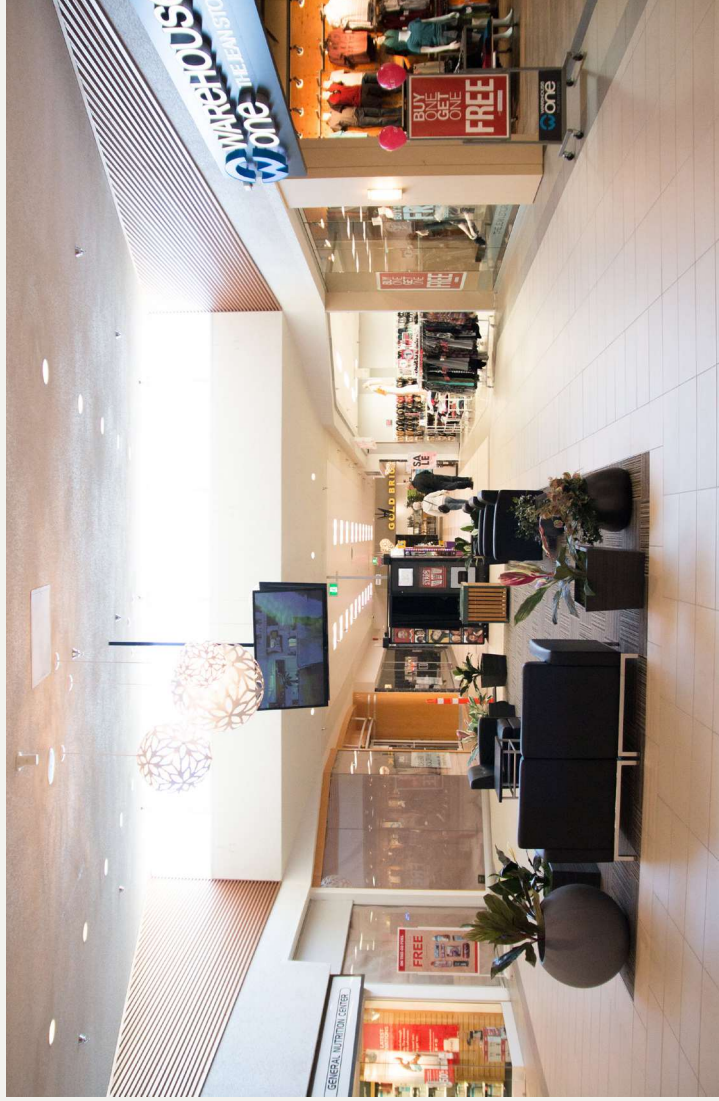

LOCATION

The City of Dawson Creek, whose name was derived from the creek by the same name that runs through the community, is situated at the southern end of the Alaska Highway and neighbours the B.C. and Alberta border. Dawson Creek is home to a population of over 11,000 and offers strong energy incentives that bring dozens of companies to this region yearly.



GROSS LEASABLE AREA  
150,828 sq. ft.

YEAR BUILT  
1977

NUMBER OF UNITS  
33

NUMBER OF STORES/  
RESTAURANTS  
27

ANCHOR TENANTS

- Save-on-Foods
- Dollarama
- Mark's
- Shoppers Drug Mart
- Pet Valu
- Anytime Fitness

FOOD OFFERINGS

- Original Joe's
- Buster's Pizza & Donair
- BarBurrito
- Mok Box
- Starbucks

# Dawson Creek Mall

● Leased ● Available

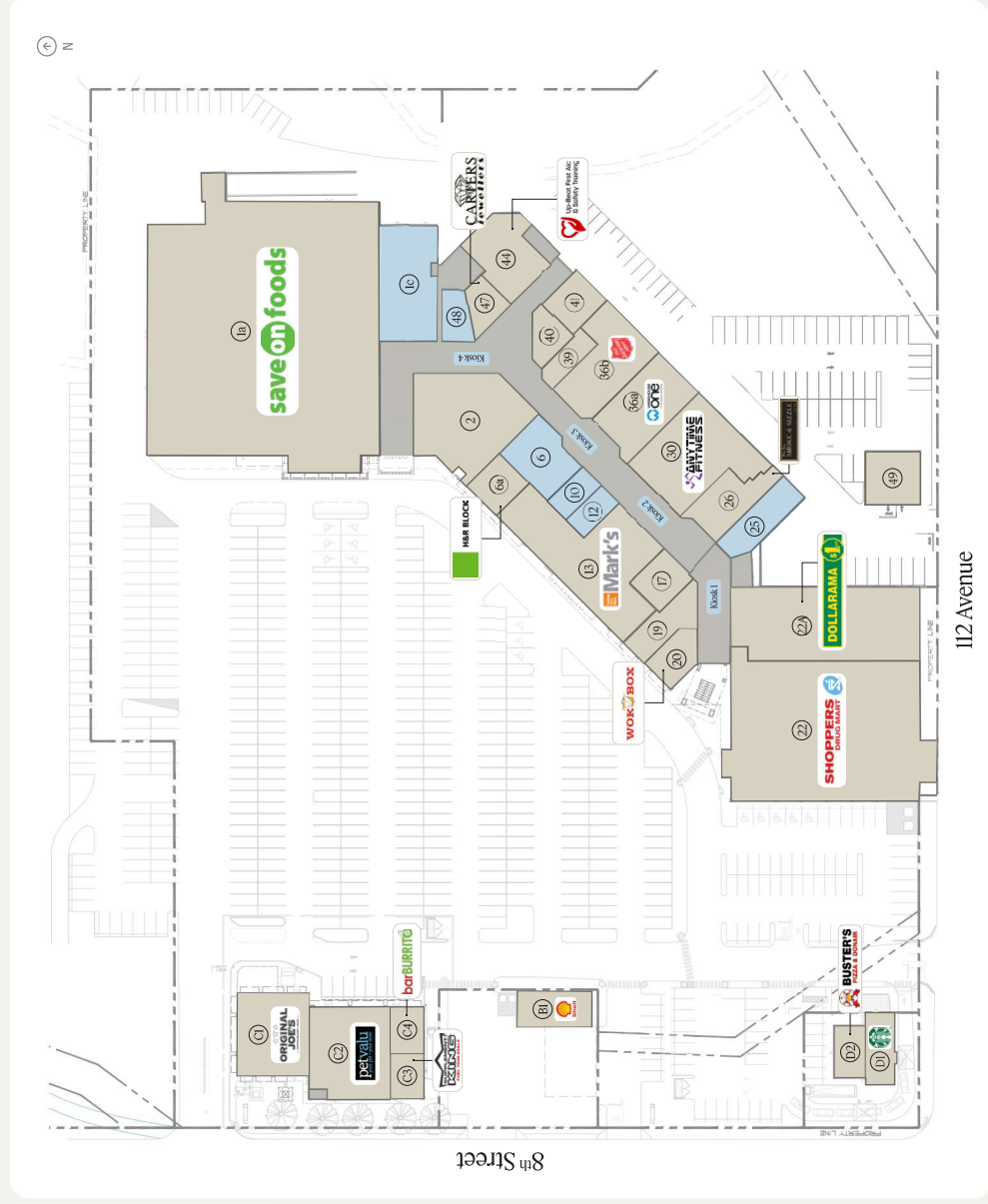

AVAILABLE UNITS

UNIT	SF	DESCRIPTION
1c	5,455	Cold shell. High ceilings.
6	2,672	Newly improved.
10	934	Newly improved.
12	848	Newly improved.
25	2,076	Newly improved.
48	1,054	Newly improved.
Kiosk	100	Multiple locations. \$60/day

NET RENTAL RATE

Negotiable

OPERATING EXPENSES

Approximately \$16.50/sf  
(2025 estimate)

AVAILABILITY

Immediately

ALLOWANCE

Negotiable

CONTACT

# Get in Touch

HEAD OFFICE

Bosa Properties  
1201-838 West Hastings St  
Vancouver, BC V6C 0A6

Office 604 416 0286

→ [bosaproperties.com](https://www.bosaproperties.com)

LEASING CONTACT

ALYCIA KAMER  
Director, Commercial Leasing  
604 558 8665  
[akamer@bosaproperties.com](mailto:akamer@bosaproperties.com)

CALLY ZERING  
Leasing Manager, Commercial  
778 357 0175  
[czering@bosaproperties.com](mailto:czering@bosaproperties.com)

RACHEL SANGHA  
Leasing Coordinator, Commercial  
604 416 0286  
[rsangha@bosaproperties.com](mailto:rsangha@bosaproperties.com)

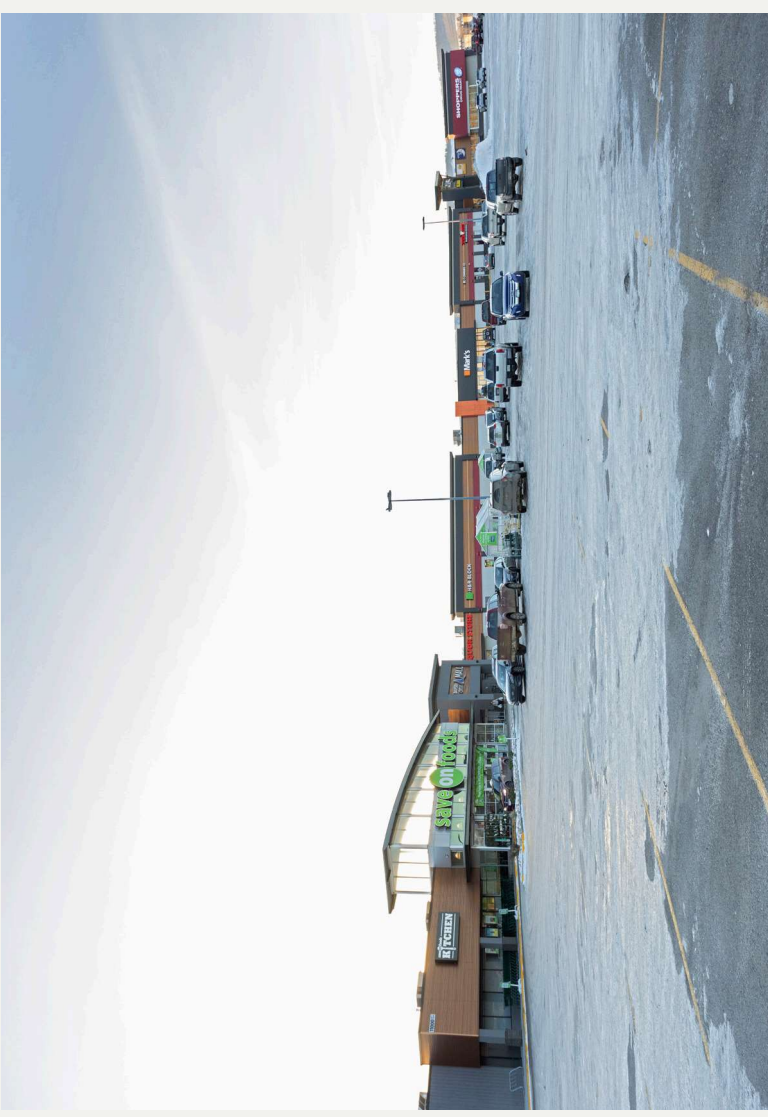

**bosa**  
**properties**