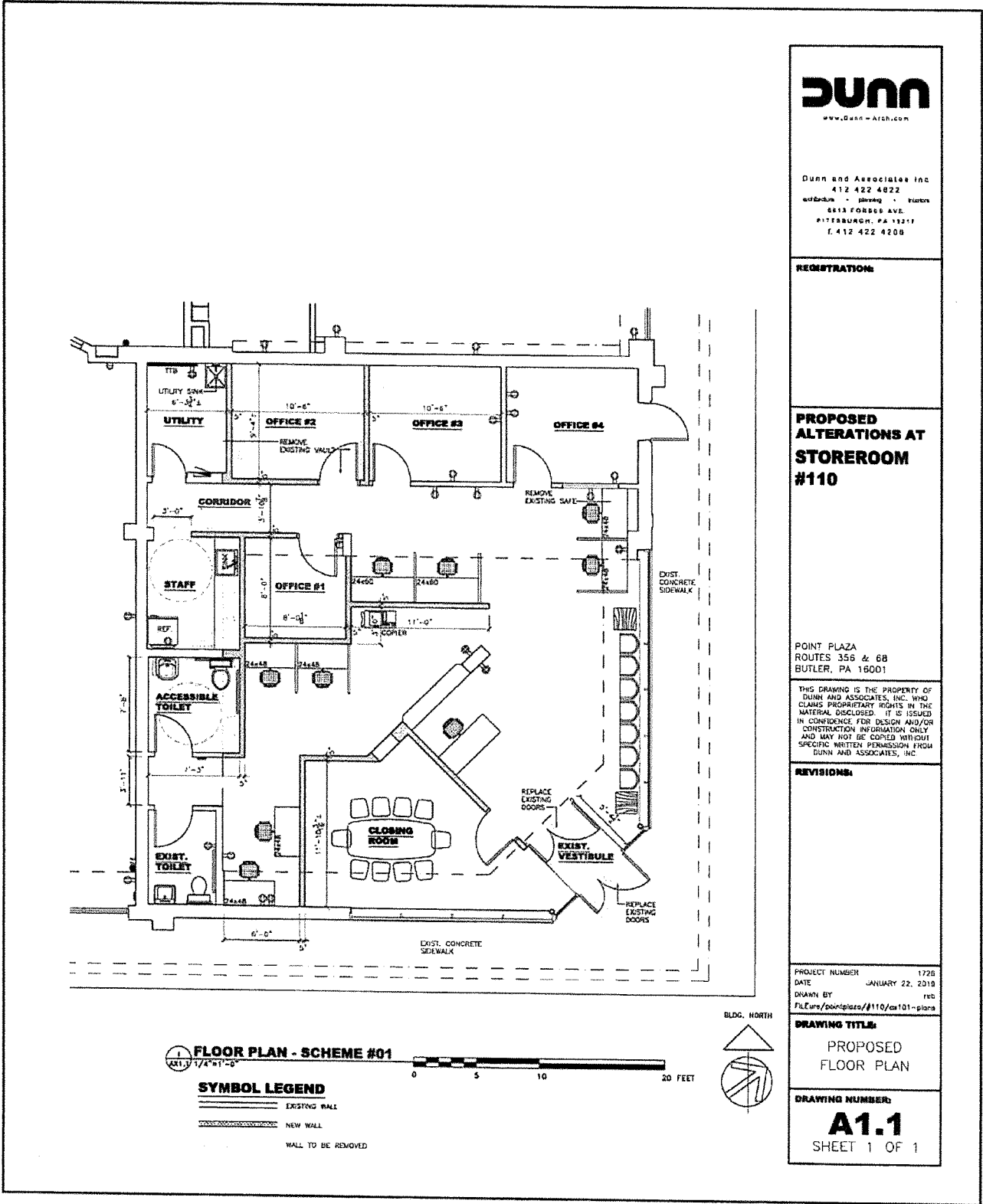

EXHIBIT "A-1"

Floor Plan



Dunn
www.dunn-atish.com

Dunn and Associates Inc
412 422 4822
architecture • planning • interiors
2813 Forbes Ave.
Pittsburgh, PA 15217
t. 412 422 4200

REGISTRATION:

PROPOSED ALTERATIONS AT STOREROOM #110

POINT PLAZA
ROUTES 356 & 68
BUTLER, PA 16001

THIS DRAWING IS THE PROPERTY OF DUNN AND ASSOCIATES, INC. WHO CLAIMS PROPRIETARY RIGHTS IN THE MATERIAL DISCLOSED. IT IS ISSUED IN CONFIDENCE FOR DESIGN AND/OR CONSTRUCTION INFORMATION ONLY AND MAY NOT BE COPIED WITHOUT SPECIFIC WRITTEN PERMISSION FROM DUNN AND ASSOCIATES, INC.

REVISIONS:

PROJECT NUMBER 1726
DATE JANUARY 22, 2019
DRAWN BY reb
File: dunn/point/plaza/#110/ca101-plans

DRAWING TITLE:
PROPOSED FLOOR PLAN

DRAWING NUMBER:
A1.1
SHEET 1 OF 1