

# MAJESTIC FREEWAY BUSINESS CENTER

147,249 SF | INDUSTRIAL WAREHOUSE SPACE | AVAILABLE FOR LEASE

18512 Harvill Avenue, Building #12, Riverside County, CA



- Spec Office: 1,670 SF
- ESFR Fire Sprinkler System
- LED Warehouse Lighting
- Ample Auto & Trailer Parking
- Immediate Access to I-215 via Cajalco Road & Harley Knox Boulevard

**For more information, contact:**

Taylor Talt  
D-(562) 654-2734 C-(626) 660-8829  
R.E. License #01901707 (CA)  
Ttalt@MajesticRealty.com

John Semcken  
D-(562) 948-4306 C-(562) 556-1887  
R.E. License #00979758 (CA)  
JSemcken@MajesticRealty.com

Jack Semcken  
D-(562) 576-1643 C-(626) 379-6138  
R.E. License #02290390 (CA)  
jacksemcken@MajesticRealty.com



# MAJESTIC FREEWAY BUSINESS CENTER RIVERSIDE COUNTY, CA

**BUILDING 12: 147,249 SF**  
18512 Harvill Avenue, Riverside County, CA

## BUILDING 12 SPECS

Total Size:	147,249 SF
Spec Office:	1,666 SF
Loading:	19 DH Doors - 9 w/ 40,000 lb. Mechanical Levelers 2 Grade Level Ramps
Power:	1 - 4,000 Amp, 277/480V, 3 Ph
Sprinklers:	ESFR
Column Spacing:	50' x 52' Typical Bay 60' x 52' Speed Bay
Building Depth:	320'
Warehouse Lighting:	LED @ 20' Candle

**32'**  
Clear Height

**19**  
Dock High Doors

**100**  
Auto Parking Stalls

**24**  
Trailer Parking Stalls

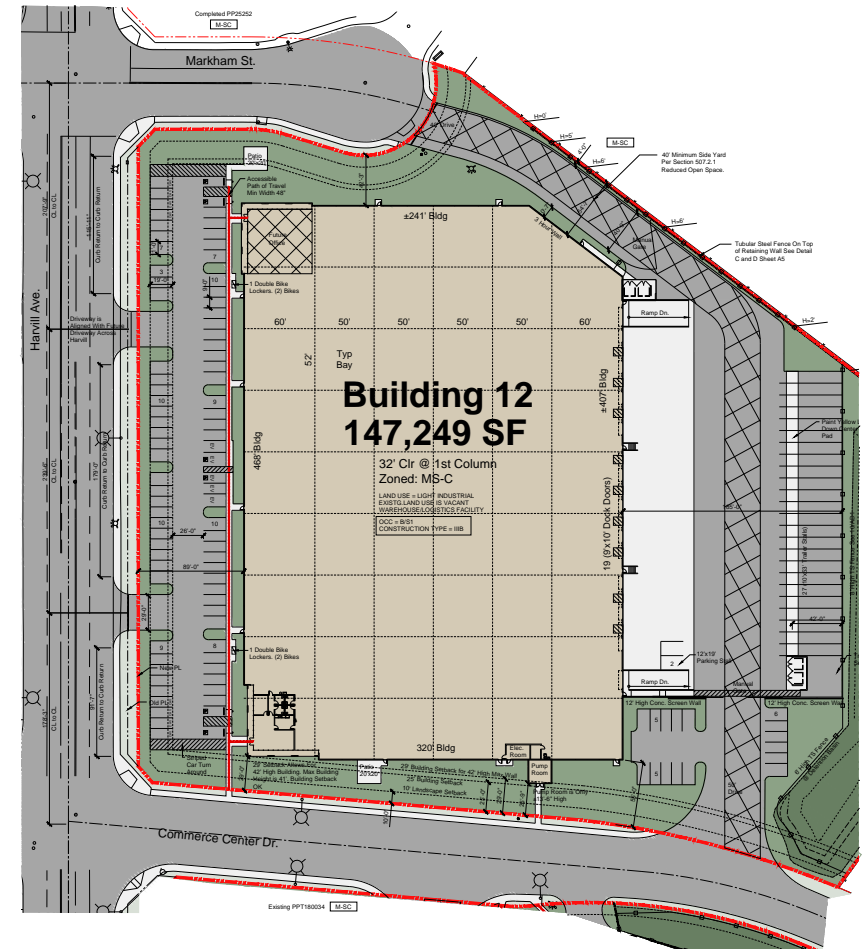

# MAJESTIC FREEWAY BUSINESS CENTER RIVERSIDE COUNTY, CA

## LOCATION

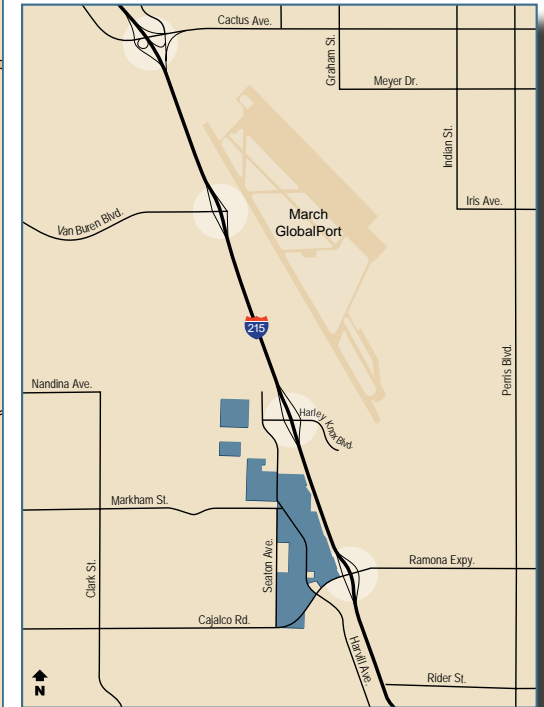

The Majestic Freeway Business Center is located between Harley Knox Boulevard and Cajalco Road on the I-215 Freeway in Riverside County, California.

# MAJESTIC FREEWAY BUSINESS CENTER RIVERSIDE COUNTY, CA

## CORPORATE NEIGHBORS



This statement is based upon information which we believe to be correct and is obtained from sources we regard as reliable but we assume no liability for errors or omissions therein.