



CENTERPARK
FLEX



STEVE BRUCE

Vice Chairman | Co-Lead
t 858-922-3056
steve.bruce@colliers.com
CA RE Lic. #01455744

CHRIS HIGH, SIOR

Vice Chairman | Co-Lead
t 619-772-2936
chris.high@colliers.com
CA RE Lic. #01734544

CONOR EVANS

Vice President
t 858-291-1415
conor.evans@colliers.com
CA RE Lic. #01963596

6865 Flanders Dr

FULL BUILDING

Office/Warehouse
22,379 SF

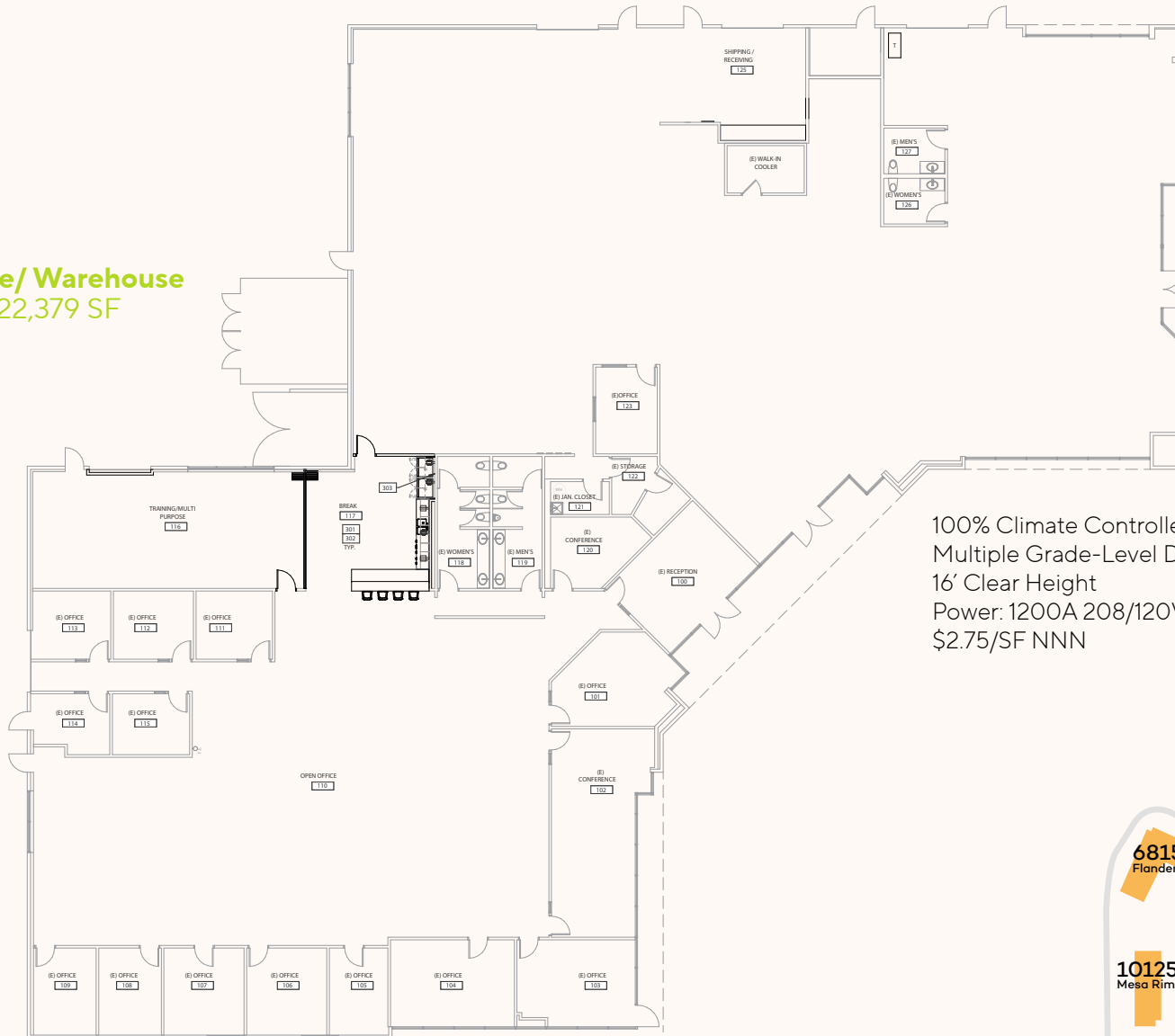

100% Climate Controlled Warehouse
Multiple Grade-Level Doors
16' Clear Height
Power: 1200A 208/120V
\$2.75/SF NNN

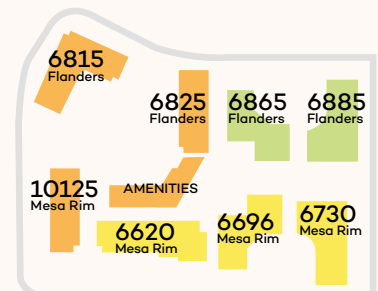

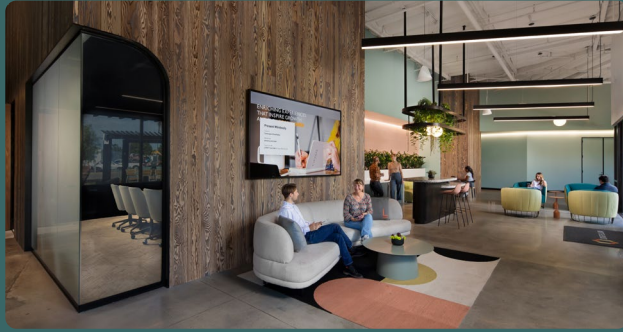

Room for life- at work

- Onsite Restaurant
- Beer On Tap
- Food Trucks
- Mindfulness Spaces
- Outdoor Seating
- Collaboration Areas
- Resort Style Fitness Center