



T TRANSWESTERN | RETAIL GROUP



**RETAIL
SPACE AVAILABLE.**

IN TYSONS

FOR LEASE - 7,728 RSF

1850 TOWERS CRESCENT PLAZA | VIENNA, VA

Just Steps From Tysons Corner Center

Unique retail located within **an urban office campus setting** brimming with modern amenities and readily walkable to the area's premier retail and restaurants. 1850 is just minutes to I-495 and its Express Lanes, Route 267, I-66, and a short walk to the Tysons Metro Station.



**7,278 SF
Available**



**Branding
Opportunity**



**Exceptional
Location**



**On-Site
Parking**



OUTDOOR PATIO BEHIND SPACE



CAMPUS PLAZA LOCATION



PEDESTRIAN BRIDGE TO TYSONS CORNER CENTER

Exclusive Retail Made Easy For You

Tyson's Corner stands out as a renowned national retail hub within the region, and a short **3 minute walk from you**. Some of the globe's most recognizable brands and dining establishments have chosen to establish their presence here.

1.2M SF
OF RETAIL SPACE

50+
RESTAURANTS

39+
SHOPS & STORES

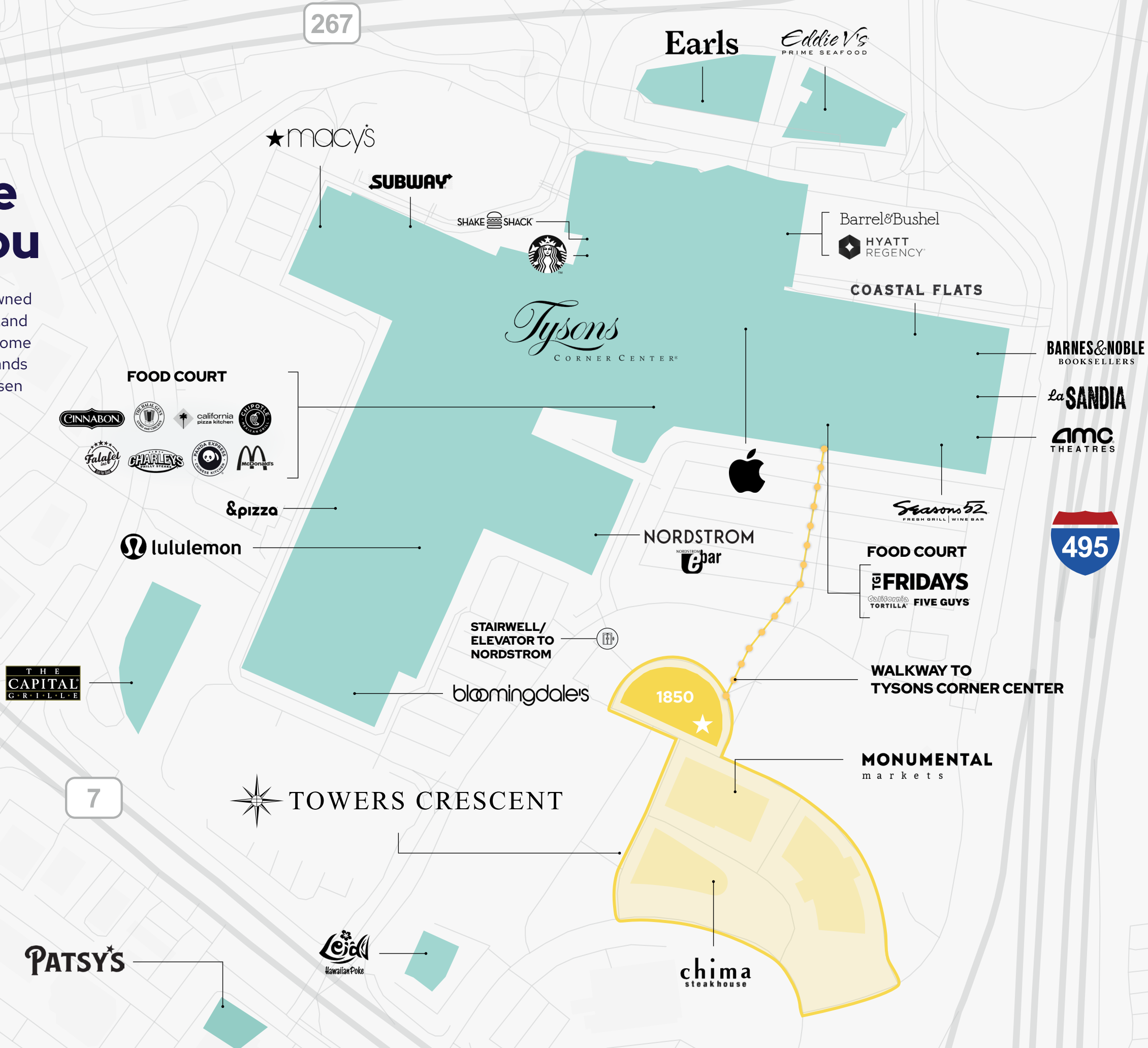

TOWERS CRESCENT

1850
★
chima
steakhouse
MONUMENTAL
markets

THE
CAPITAL
GRILLE

7

495

FOOD COURT
CINNABON
SHAKE SHACK
STARBUCKS
CALIFORNIA PIZZA KITCHEN
MCDONALDS
FALAFEL
CHARLEYS
PIZZA EXPRESS

& pizza

lululemon

STAIRWELL/
ELEVATOR TO
NORDSTROM

blōomingdales

NORDSTROM
bar

FOOD COURT
FRIDAYS
California TORTILLA
FIVE GUYS

WALKWAY TO
TYSONS CORNER CENTER

Seasons 52
FRESH GRILL | WINE BAR

Barrel & Bushel
HYATT REGENCY

COASTAL FLATS

Tyson's
CORNER CENTER

SUBWAY

★ macy's

Earls

Eddie V's
PRIME SEAFOOD

267

7,728 Total Rentable Square Feet

Street level opportunity with potential for a variety of uses. Private frontage entry along with connection to office building lobby.



Outdoor Seating

Patio Potential

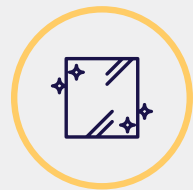

Unique Storefront

Expansive Windowline

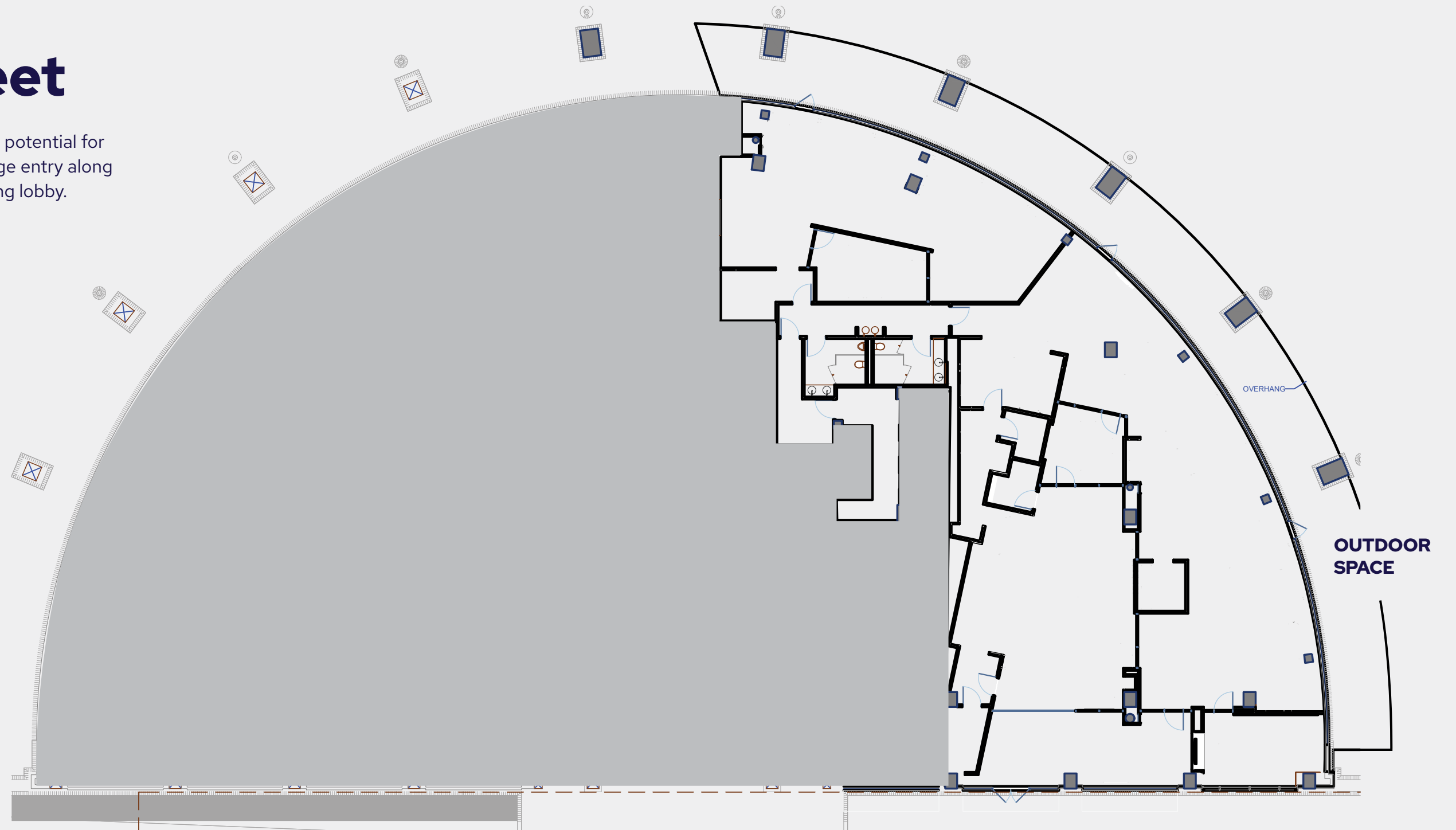

PREMIER RETAIL OPPORTUNITY

1850 TOWERS CRESCENT PLAZA | VIENNA, VA

T TRANSWESTERN | RETAIL GROUP



7,728 SF AVAILABLE

FOR LEASE

CONNOR MCCARTHY

202.775.7027

connor.mccarthy@transwestern.com

TONY WOMACK

703.328.1929

tony.womack@transwestern.com

BERNIE MCKEEVER, JR.

703.919.6750

bernard.mckeever@transwestern.com