



For Lease | 1,275 - 4,500 SF Warehouse Space

1504 Damon Ave, Kissimmee, FL 34744

Property Highlights:

- Grade level roll-up doors for seamless material handling and deliveries.
- Convenient access to major highways.
- Exterior security cameras for added safety.
- Clear span layouts for flexible use.



Asking Rate:
Contact Broker for Pricing

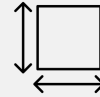

Square Footage:
1,275 - 4,500 SF



Clear Height / Door:
16' Clear / 12' x 14' Door



Parking Ratio:
2/1,000



Zoning:
IB, Kissimmee



**Scan to
Schedule
a Tour**

**FOR MORE INFORMATION
PLEASE CONTACT:**

Kevin Delarosa
407.761.6190
kdelarosa@kollektion.com

Shalini Hersowitz
954.254.0824
shersowitz@kollektion.com

**COLLEKTION
PROPERTIES**

The information contained herein has been obtained from sources deemed reliable, however, Kollektion Properties makes no guarantees, warranties or representation as to its completeness or accuracy thereof. The presentation of this property is submitted subject to errors, omissions, change of price or conditions, prior to sale or lease or withdrawal without notice.

1504 DAMON AVE

4,016 SF

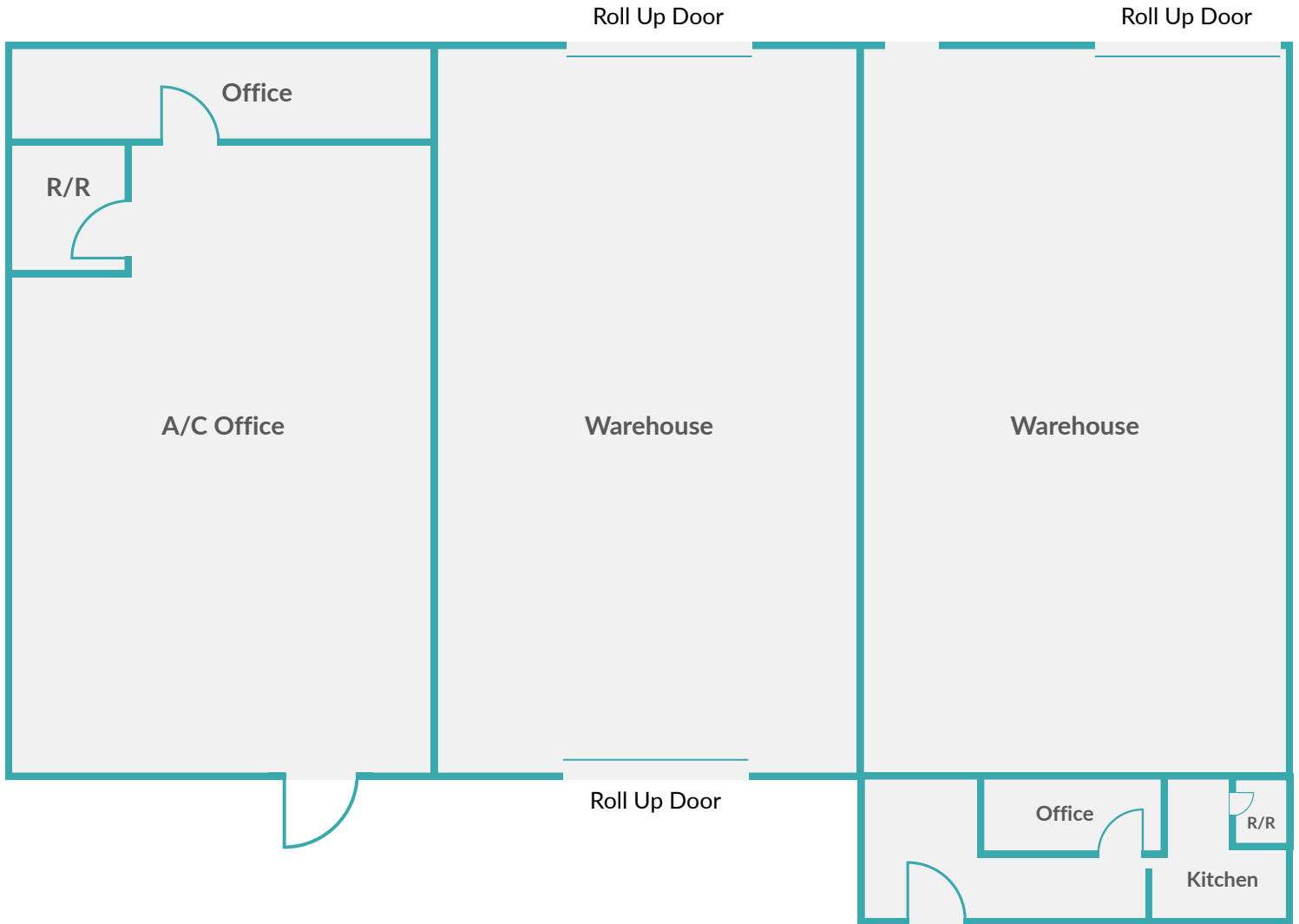

**Floor plan is for illustrative purposes only. All dimensions and layouts are approximate and subject to change.*

FOR MORE INFORMATION
PLEASE CONTACT:

Kevin Delarosa
407.761.6190
kdelarosa@collektion.com

Shalini Hersowitz
954.254.0824
shersowitz@collektion.com



1521-1525 DAMON AVE

4,500 SF

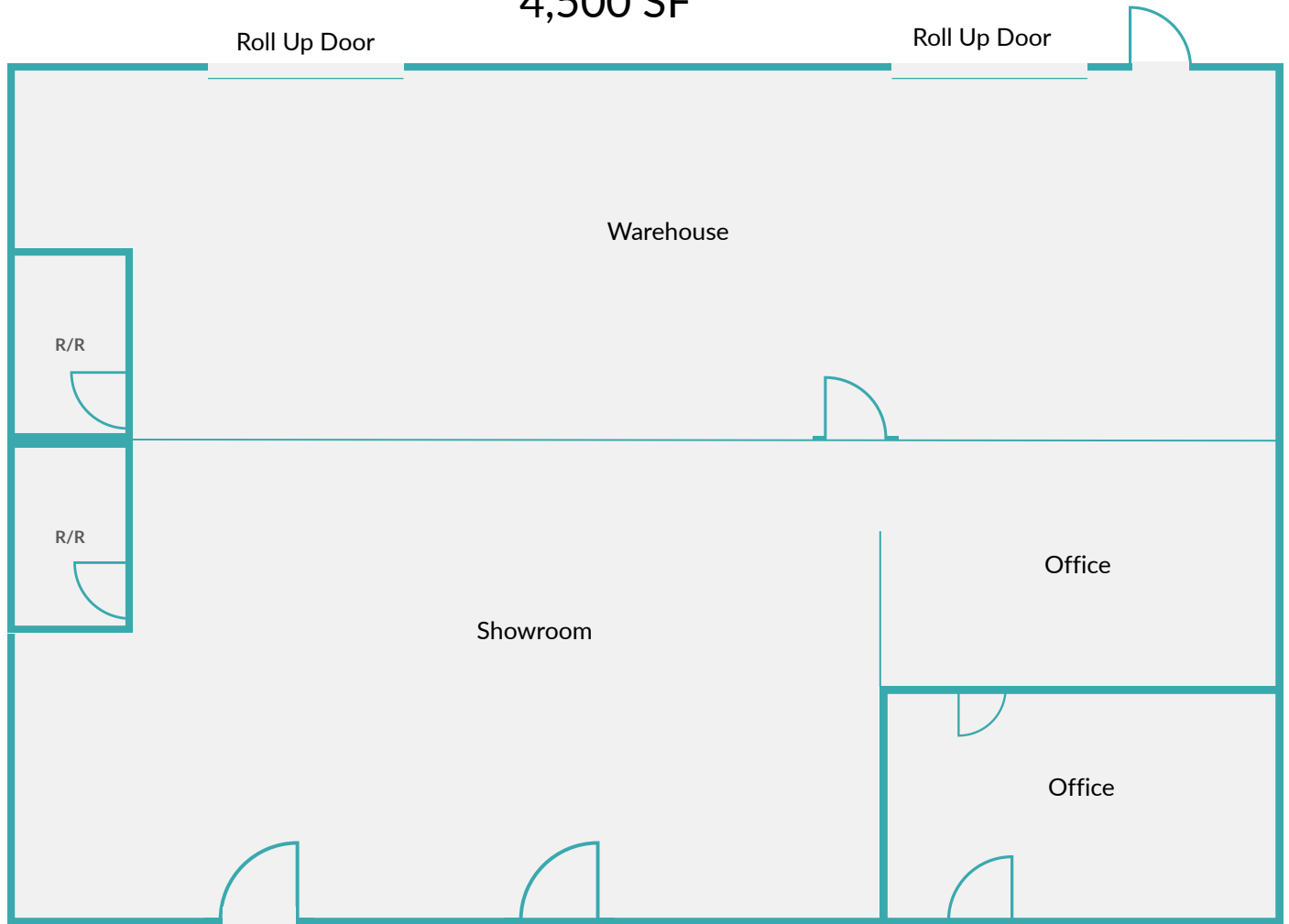

**Floor plan is for illustrative purposes only. All dimensions and layouts are approximate and subject to change.*

FOR MORE INFORMATION
PLEASE CONTACT:

Kevin Delarosa
407.761.6190
kdelarosa@kollektion.com

Shalini Hersowitz
954.254.0824
shersowitz@kollektion.com



1533 KELLEY AVE

1,275 SF

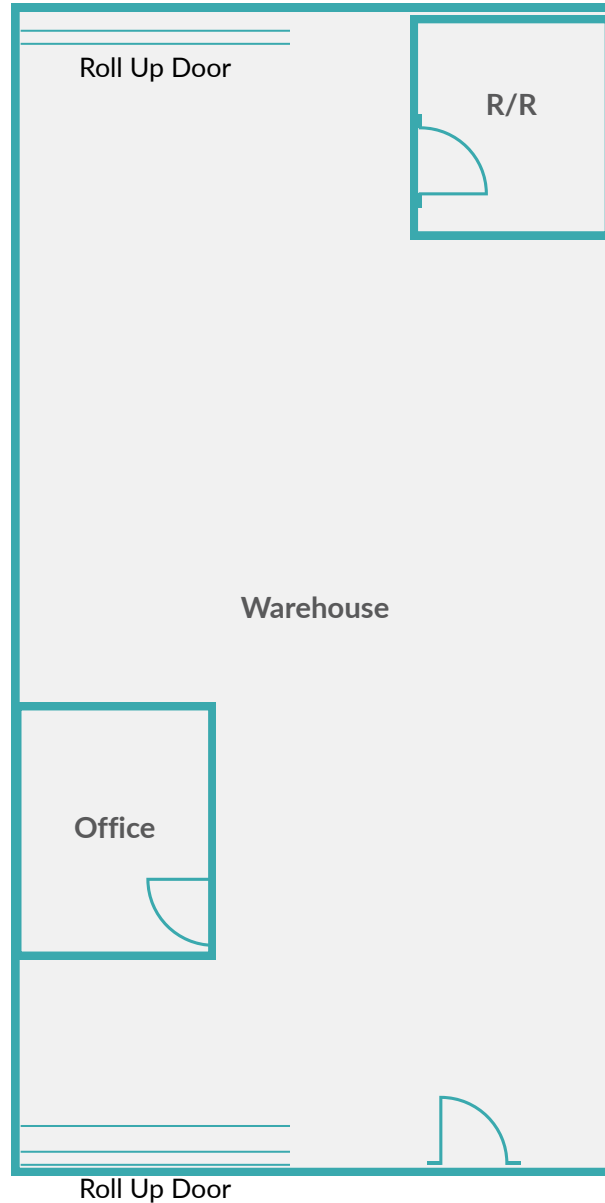

**Floor plan is for illustrative purposes only. All dimensions and layouts are approximate and subject to change.*

FOR MORE INFORMATION
PLEASE CONTACT:

Kevin Delarosa
407.761.6190
kdelarosa@collektion.com

Shalini Hersowitz
954.254.0824
shersowitz@collektion.com

The information contained herein has been obtained from sources deemed reliable, however, Collektion Properties makes no guarantees, warranties or representation as to its completeness or accuracy thereof. The presentation of this property is submitted subject to errors, omissions, change of price or conditions, prior to sale or lease or withdrawal without notice.



1521 KELLEY AVE

1,875 SF

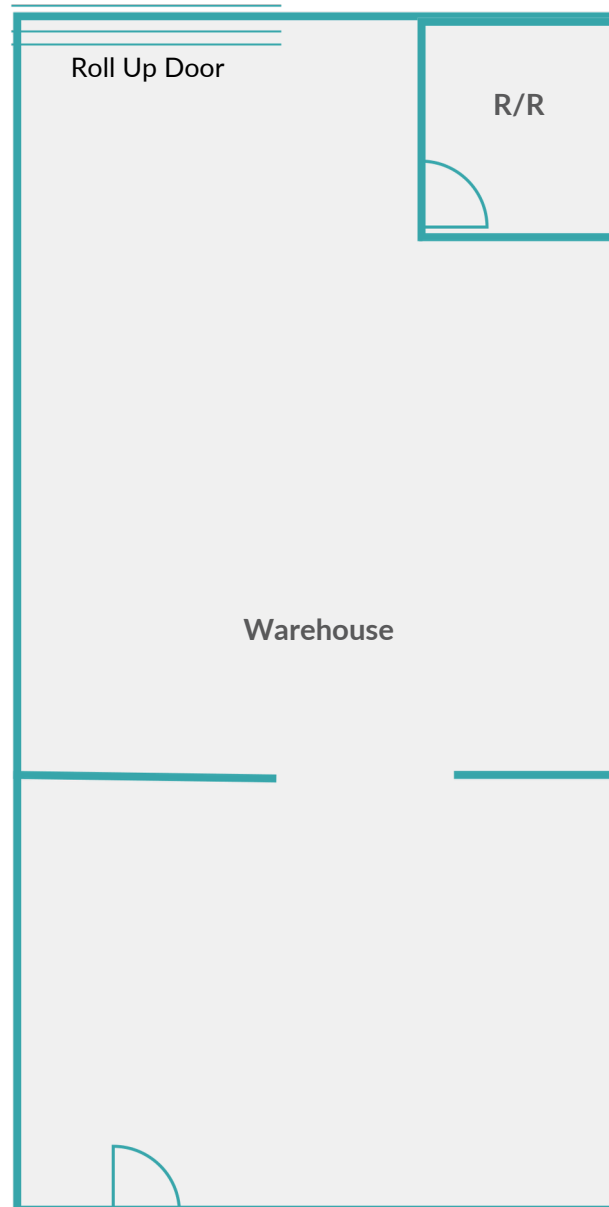

**Floor plan is for illustrative purposes only. All dimensions and layouts are approximate and subject to change.*

FOR MORE INFORMATION
PLEASE CONTACT:

Kevin Delarosa
407.761.6190
kdelarosa@collektion.com

Shalini Hersowitz
954.254.0824
shersowitz@collektion.com



For Lease | 1,275 - 4,500 SF Warehouse Space

1504 Damon Ave, Kissimmee, FL 34744

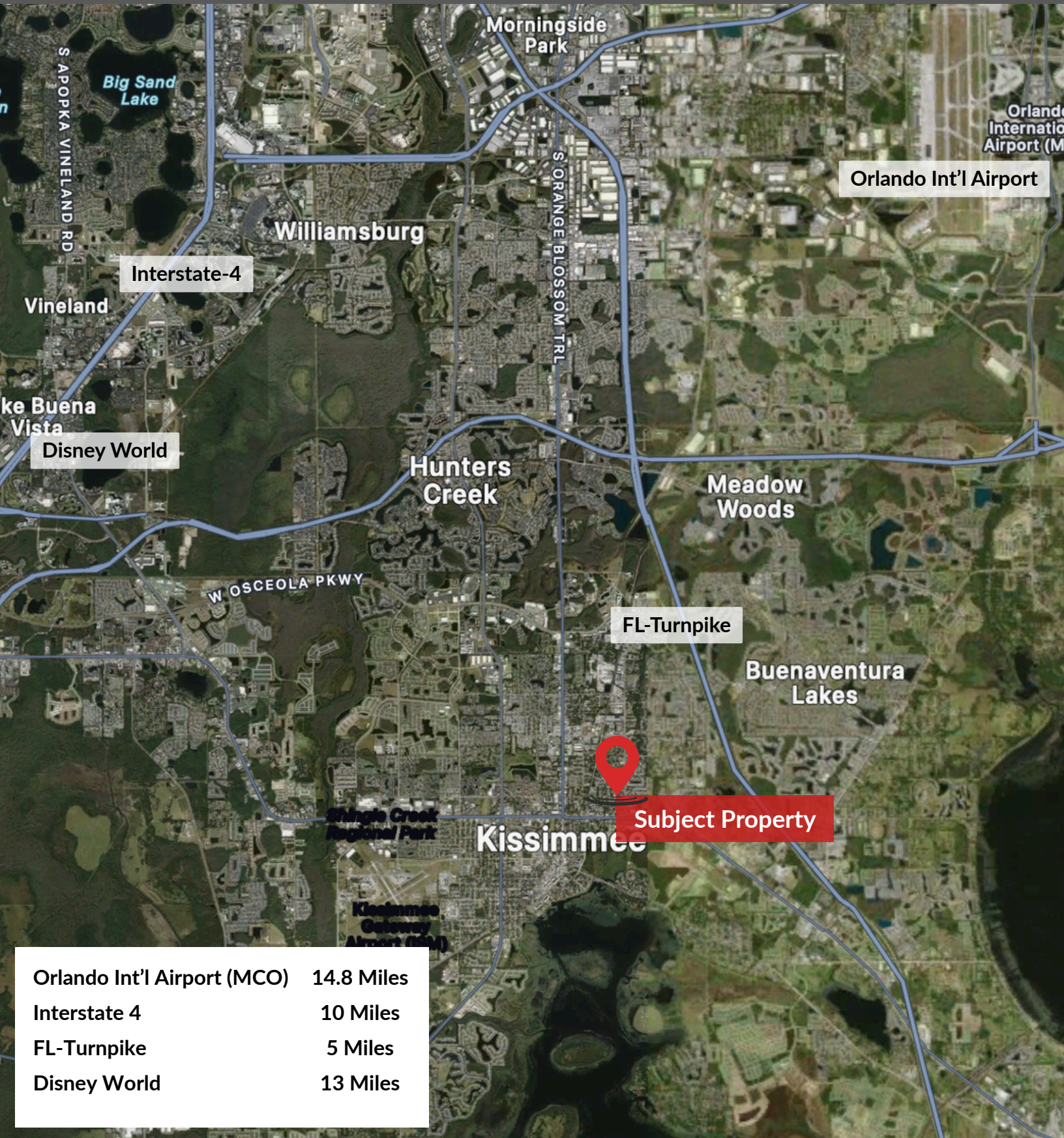

Orlando Int'l Airport (MCO)	14.8 Miles
Interstate 4	10 Miles
FL-Turnpike	5 Miles
Disney World	13 Miles

FOR MORE INFORMATION
PLEASE CONTACT:

Kevin Delarosa
407.761.6190
kdelarosa@kollektion.com

Shalini Hersowitz
954.254.0824
shersowitz@kollektion.com



The information contained herein has been obtained from sources deemed reliable, however, Kollektion Properties makes no guarantees, warranties or representation as to its completeness or accuracy thereof. The presentation of this property is submitted subject to errors, omissions, change of price or conditions, prior to sale or lease or withdrawal without notice.