

# 1130 N MELROSE DRIVE

*Unit 401 // Vista, CA*



**FOR LEASE**

**TURN KEY COMMERCIAL KITCHEN**

**±2,469 RSF**



# PROPERTY HIGHLIGHTS



## VISTA BUSINESS PARK



Commercial Bakery and  
Kitchen Improvements  
(see link on page 3)



100% HVAC Climate Control



Gas Served



Approximately 7 Unreserved  
Parking Spaces



One (1) Grade Level Door  
Position



Power: 3-Phase, 400 Amps



Easy Access to Highway-78



Lease Rate: Negotiable

# FLOOR PLAN

DOWNLOAD  
COMMERCIAL BAKERY  
& KITCHEN IMPROVEMENTS LIST

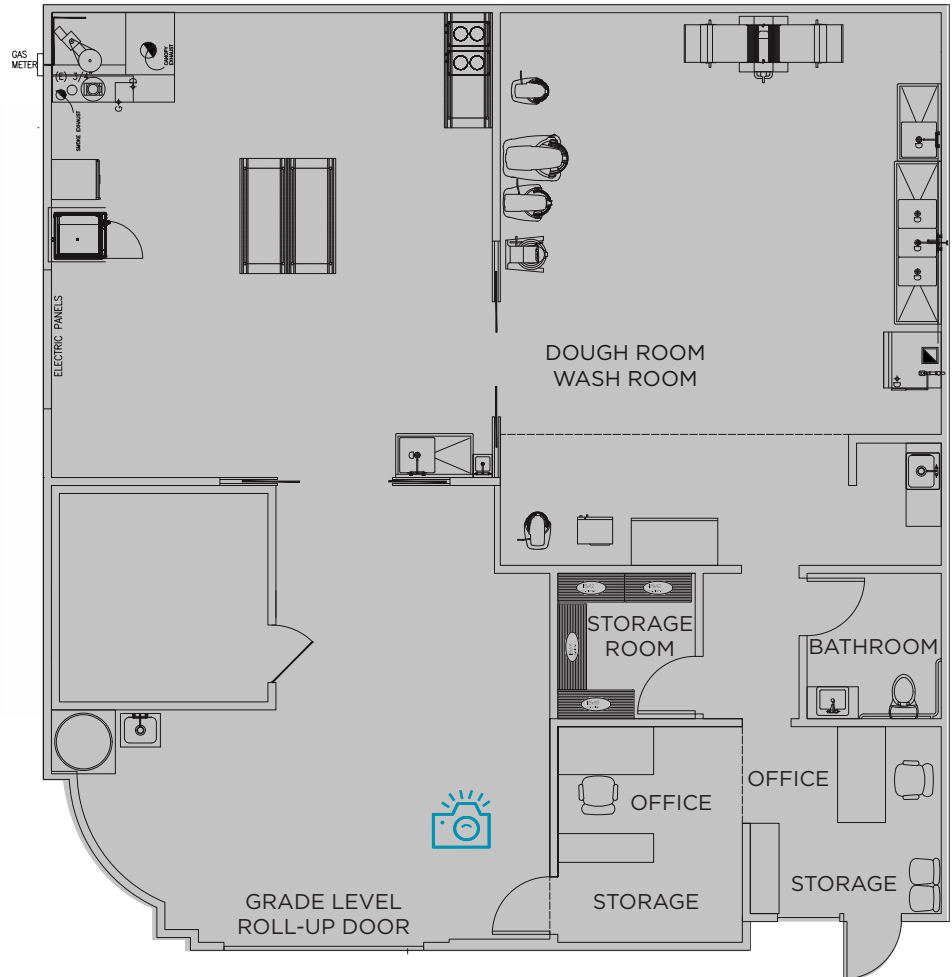

# PHOTOS



# LOCATION

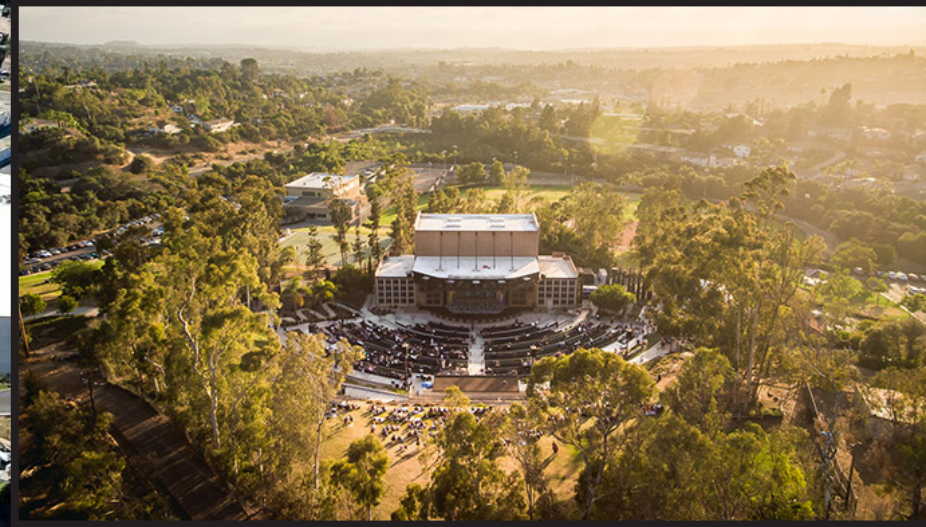
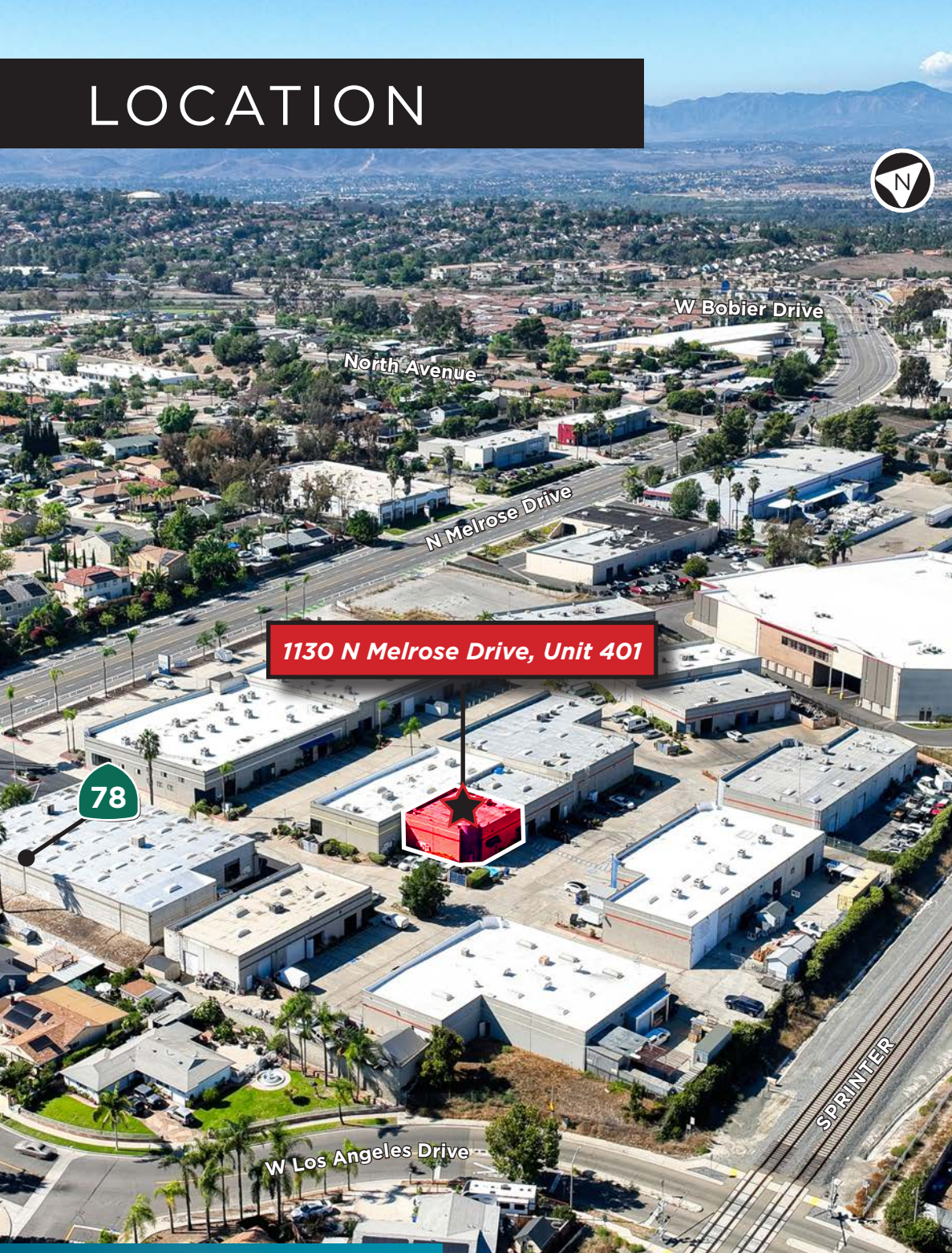

# DRIVE TIMES & CORPORATE NEIGHBORS

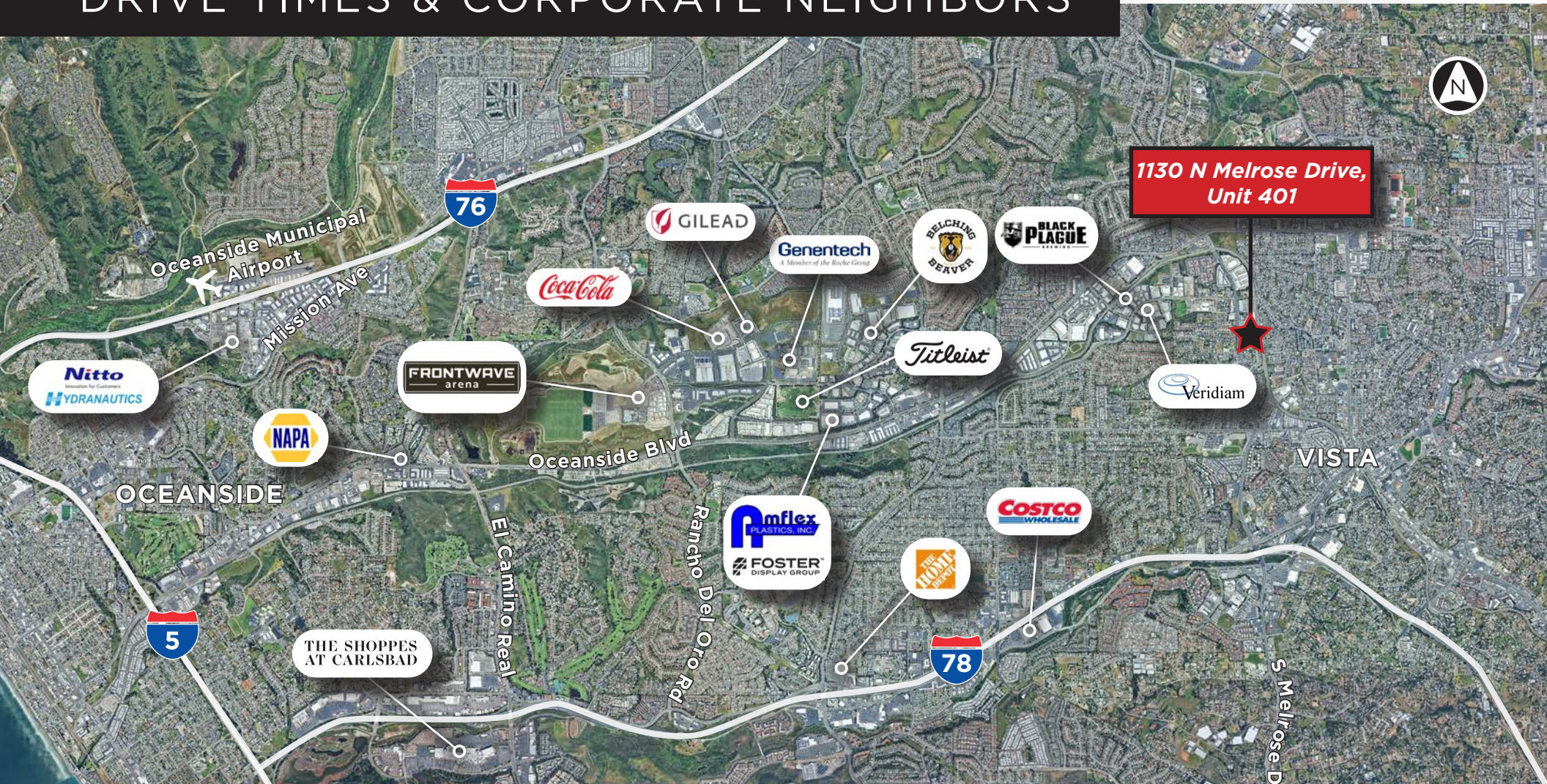

## DRIVE TIMES

- 5 Minutes** to Hwy-78
- 8 Minutes** to Hwy-76
- 12 Minutes** to I-5
- 35 Minutes** to Orange County

- 55 Minutes** to San Diego International Airport
- 1 Hr** to Downtown San Diego
- 1 Hr 25 Mins** to International Border

1130 N MELROSE DRIVE, UNIT 401 //// VISTA

FOR LEASE



FOR MORE INFORMATION CONTACT BROKER:

**TYLER STEMLEY**

760.431.3841

[tyler.stemley@cushwake.com](mailto:tyler.stemley@cushwake.com)

Lic. No.02003867

**MIKE CLARK**

858.625.5225

[mike.clark@cushwake.com](mailto:mike.clark@cushwake.com)

Lic. No.01192474

©2025 Cushman & Wakefield. All rights reserved. The information contained in this communication is strictly confidential. This information has been obtained from sources believed to be reliable but has not been verified. NO WARRANTY OR REPRESENTATION, EXPRESS OR IMPLIED, IS MADE AS TO THE CONDITION OF THE PROPERTY (OR PROPERTIES) REFERENCED HEREIN OR AS TO THE ACCURACY OR COMPLETENESS OF THE INFORMATION CONTAINED HEREIN, AND SAME IS SUBMITTED SUBJECT TO ERRORS, OMISSIONS, CHANGE OF PRICE, RENTAL OR OTHER CONDITIONS, WITHDRAWAL WITHOUT NOTICE, AND TO ANY SPECIAL LISTING CONDITIONS IMPOSED BY THE PROPERTY OWNER(S). ANY PROJECTIONS, OPINIONS OR ESTIMATES ARE SUBJECT TO UNCERTAINTY AND DO NOT SIGNIFY CURRENT OR FUTURE PROPERTY PERFORMANCE.

