

MEDICAL OFFICE SPACE FOR LEASE

1288 MORRO ST., SUITE 110
SAN LUIS OBISPO, CA



LISTING SUMMARY

PROPERTY OVERVIEW

Approximately 1,760 rentable square feet of medical office space available for lease. The suite was previously occupied by a dental practice and includes plumbed rooms, large reception area, restrooms, break room, ample storage and private office space.

Located at the Mission Medical Building one block from the Post Office, Granada Inn, and Starbucks.

Professionally managed building with an on-site building engineer.

Contact agent for a tour.

SIZE: +/- 1,633 SF (includes 127 SF of common area for a total rentable SF of +/- 1,760)

LEASE RATE: \$2.00/SF NNN (\$1.08 Estimated)

TERM: Negotiable

ZONING: Office

HVAC: Yes

RESTROOM: Yes

AVAILABLE: Negotiable

EXCLUSIVELY LISTED BY

No warranty or representation as to the accuracy of the foregoing information. Terms of sale, lease, and availability are subject to change or withdrawal without notice.



LEE & ASSOCIATES

COMMERCIAL REAL ESTATE SERVICES

MARTY INDVIK

mindvik@lee-associates.com

D 805.440.6861

CalDRE #0961882

JEFF ALLEN

jallen@lee-associates.com

D 805.801.7676

CalDRE #01313074



INTERIOR PHOTOS



INTERIOR PHOTOS



INTERIOR PHOTOS



FLOOR PLAN | SUITE 110

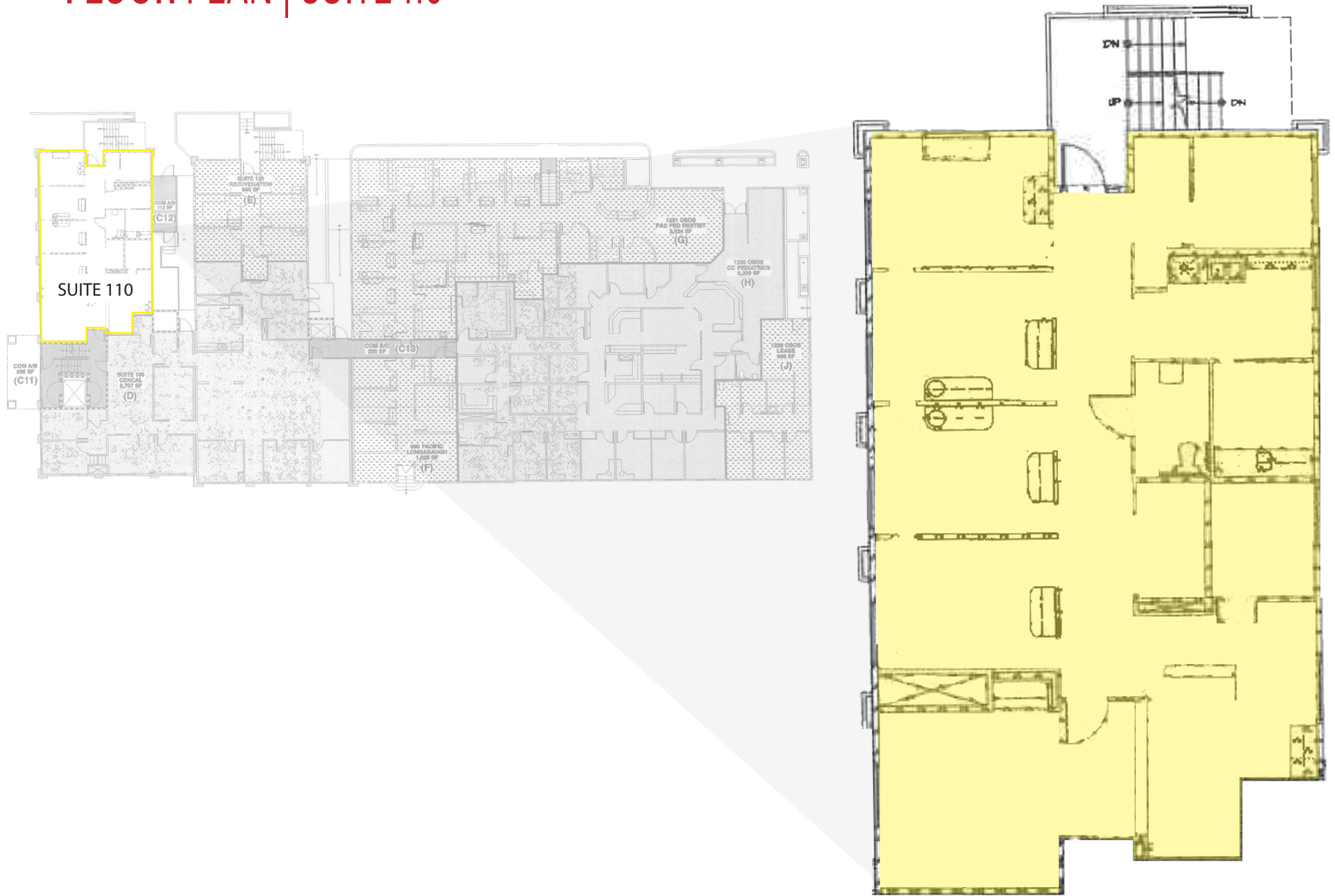

RETAIL MAP

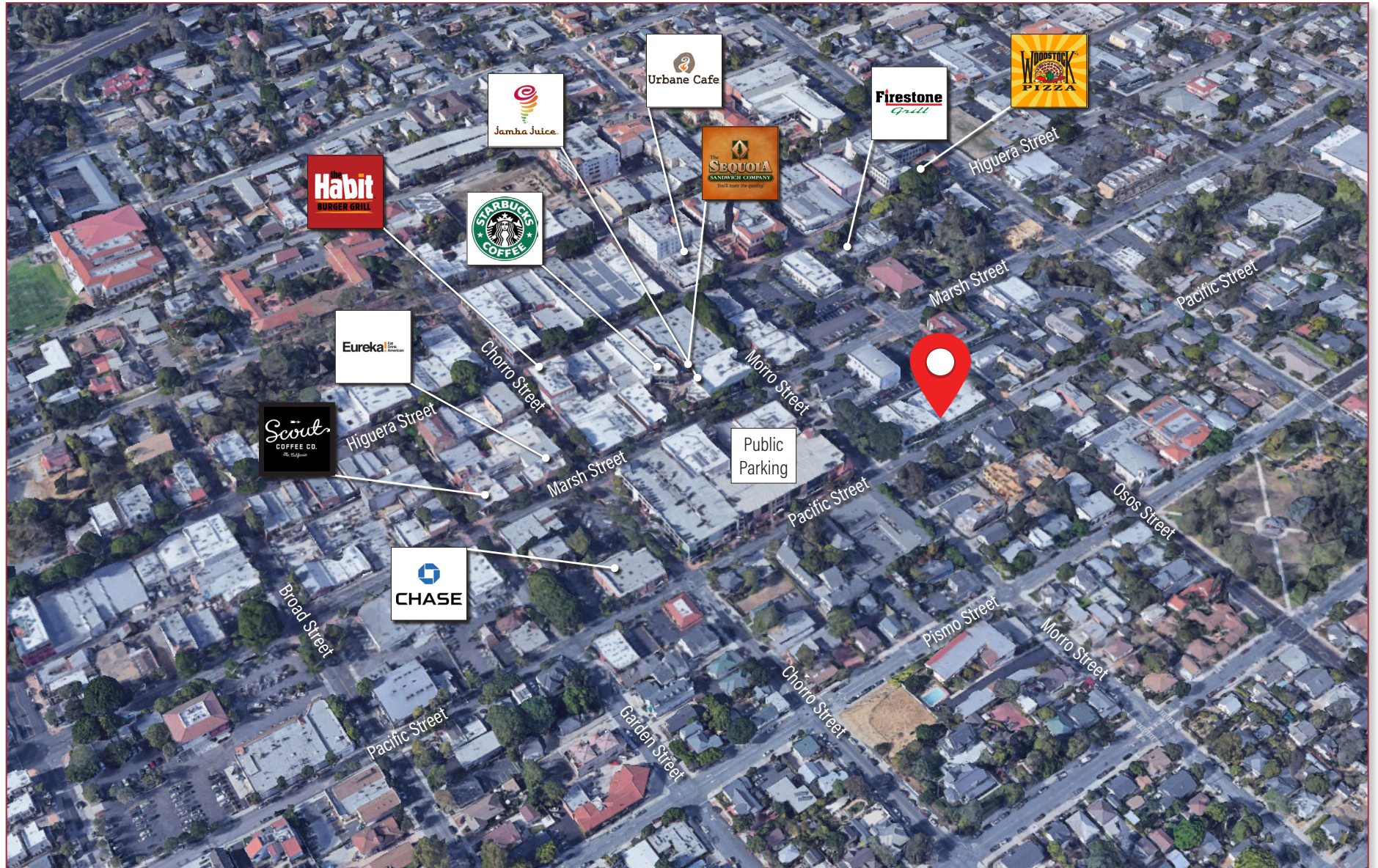

LOCATION CITY OF SAN LUIS OBISPO

