

City of Sacramento
 Dept. of Public Works
 Facilities / Real Property Mgt.
 5730 24th Street
 Bldg. #4
 Sacramento, CA.95822
 (916) 808-8300
 (916) 808-8337 (Fax)
 www.cityofsacramento.org

Approval:

Revisions / Issuances

No.	Description	Date.

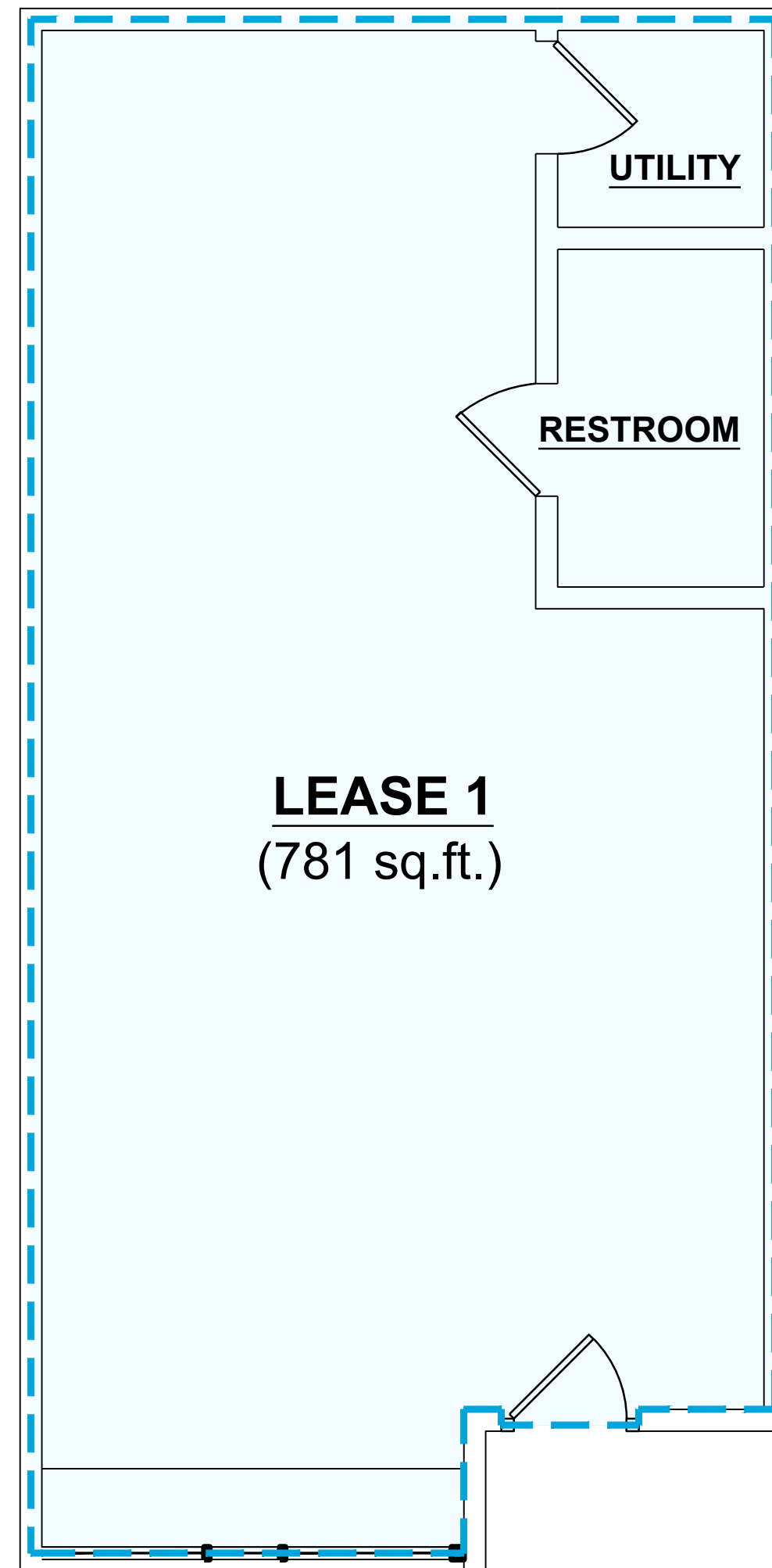

1 PLAN, FLOOR 1
 A101 SCALE: 1/4"=1'-0"



BOMA LEGEND

DEFINITIONS:

- VERTICAL PENETRATIONS STAIRS, ELEVATORS, SHAFTS, AND THE PERMANENT PARTITIONS WITH ADJACENT WALL.
- RENTABLE AREA THE REMAINDER IS THE MAXIMUM POSSIBLE AREA POTENTIALLY AVAILABLE TO A TENANT.
- FLOOR COMMON AREAS JANITOR, ELECTRICAL, AND TOILET ROOMS AND CORRIDORS @ CENTERLINE OF WALL
- FLOOR USABLE AREA THE REMAINDER IS THE AREA AVAILABLE FOR TENANTS' PRIVATE USE.
- R/U FACTOR RENTABLE AREA DIVIDED BY USABLE AREA PER FLOOR, USED TO DISTRIBUTE FLOOR COMMON AREAS AMONG MULTIPLE TENANTS ON THE SAME FLOOR.
- USABLE AREA THE BREAKDOWN OF FLOOR USABLE AREA BY TENANT, MEASURED TO SUITE INTERIOR FINISHES AND WINDOW GLASS.
- BASIC RENTABLE AREA A TENANT'S USABLE AREA PLUS THEIR SHARE OF THEIR FLOOR'S COMMON AREAS.
- BUILDING COMMON AREAS SPACES TO BE SHARED BY ALL BUILDING TENANTS,.

KEY PLAN

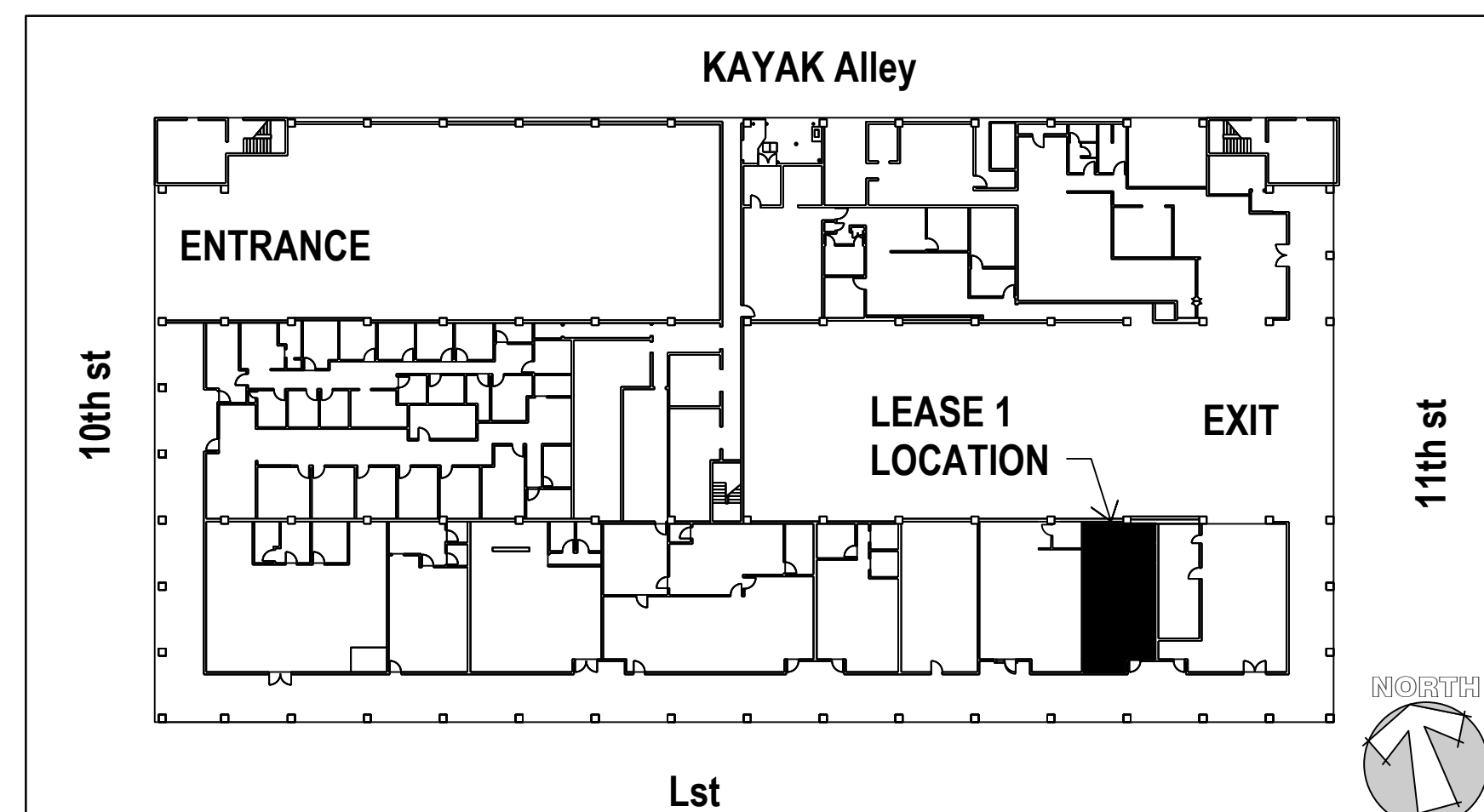

Project Name & Location:
City of Sacramento

Capitol Garage "LOT C"
 Total Body Nutrition - BOMA
 Public Works

Issue Date:

Sheet Title:

FLOOR PLAN

Designed By: Work Order No:

Drawn By: Sheet No:

Reviewed By: **A-101**

Sheet Scale: 1 OF 1

AS-BUILT