

BUCK OWENS BLVD.  
PLAZA

**ARMOR COATINGS**

**STAINMASTER**  
CARPET  
Always stylish. Always beautiful!  
SHAW ♦ ROYALTY ♦ MOHAWK ♦ BEAULIEU  
Lic. 888406

*Call No. 201-738-077*

**ARMOR COATINGS**

**UNDERCOVER INNOVATIONS**

**RB**  
TRUCK & SUPPLY, INC.

**STONE CRAFTERS**  
• Residential Remodeling  
• New Construction  
Granite Fabrication • Kitchen Specialist • FREE Estimates  
Call Any Time 661-201-7387

**THE FIT SPOT**



For Lease | +/- 1,500 SF - 3,000 SF  
**Office/Warehouse in  
Rosedale "Oilpatch"**

3624 Buck Owens Blvd | Bakersfield, CA

**Contact Us:**

**Cameron Mahoney**  
Senior Vice President | Principal  
License No. 01937802  
+1 661 631 3814  
cameron.mahoney@colliers.com

**Marco Petrini**  
Vice President  
License No. 02167974  
+1 661 631 3826  
marco.petrini@colliers.com

**Colliers International**  
10000 Stockdale Hwy, Suite 102  
Bakersfield, CA 93311  
+1 661 631 3800  
www.colliers.com/bakersfield



## Property Overview:

**3624 Buck Owens Blvd** is a multi-tenant, office/warehouse project that is centrally located within the highly desirable Rosedale “Oil Patch” submarket, just east of Highway 99 and north of Rosedale Hwy. The property is situated on approximately 2.30 acres of M-1 zoned land.

## Property Details:

<b>Address</b>	3624 Buck Owens Blvd Bakersfield, CA 93308
<b>APN</b>	332-120-03
<b>Building Size</b>	+/- 30,715 Square Feet
<b>Parcel Size</b>	+/- 2.30 Acres
<b>Zoning</b>	M-1; Light Industrial City of Bakersfield



**Water**  
California Water  
Servico Co.



**Electric**  
PG&E  
(4 wire, 200 amp, 3  
phase, 120/208 volt)



**Sewer**  
City of Bakersfield



**Gas**  
PG&E

## Available:

Suite 14	+/- 1,500 SF	\$1,875/mo. Industrial Gross
Yard 3	+/- 1,800 SF	\$400/mo.
Yard 4	+/- 3,600 SF	\$600/mo.

## Property Highlights:

- Large Monument sign on Buck Owens Blvd, with good Highway 99 visibility.
- Centrally located with freeway access to Highway 99 and Rosedale Highway.
- Recent renovations include new LED lights, interior and exterior paint, monument signage, and wrought iron fence securing the parking lot.
- Abundant amount of onsite fully secured parking.
- Flexible Term
- Suites Individually metered.

# Floor Plan

## Suite 14 Highlights:

Building Size	± 1,500 SF
Air Conditioned Office	± 384 SF
Warehouse	± 1,116 SF

- Swamp cooler
- Warehouse heater
- One (1) 12'x10' roll-up door

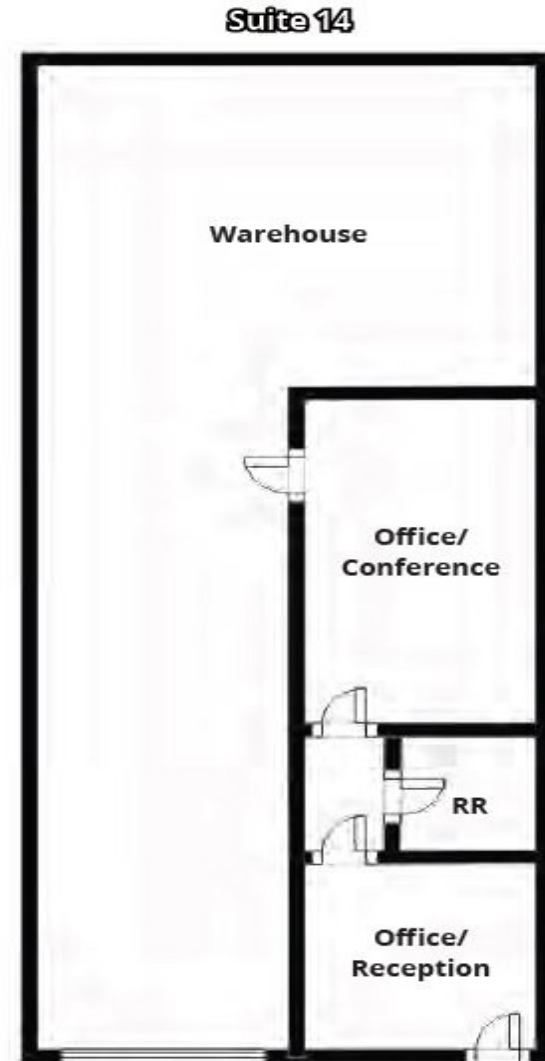

# Property Photos



This document/email has been prepared by Colliers for advertising and general information only. Colliers makes no guarantees, representations or warranties of any kind, expressed or implied, regarding the information including, but not limited to, warranties of content, accuracy and reliability. Any interested party should undertake their own inquiries as to the accuracy of the information. Colliers excludes unequivocally all inferred or implied terms, conditions and warranties arising out of this document and excludes all liability for loss and damages arising there from. This publication is the copyrighted property of Colliers and /or its licensor(s). © 2026. All rights reserved. This communication is not intended to cause or induce breach of an existing listing agreement

# Aerial



**Population**  
 1 Mile: 3,305  
 3 Mile: 89,376  
 5 Mile: 276,497



**Daytime Population**  
 1 Mile: 11,255  
 3 Mile: 154,326  
 5 Mile: 324,888



**Median Age**  
 1 Mile: 36.4  
 3 Mile: 34.3  
 5 Mile: 33.5



**Businesses**  
 1 Mile: 685  
 3 Mile: 7,883  
 5 Mile: 13,444



**Average HH Income**  
 1 Mile: \$90,778  
 3 Mile: \$67,829  
 5 Mile: \$76,431



**Households**  
 1 Mile: 1,270  
 3 Mile: 33,056  
 5 Mile: 94,203