

Grantville Station Business Park FOR LEASE



5841 MISSION GORGE RD #J

SUITE

5841 Mission Gorge Rd #J

APPROX. SQUARE FEET

1,946 SF

LEASE TYPE

Gross

FEATURES

- Commercial/flex space with tiled entry/lobby, one private office, one restroom, mezzanine storage, open warehouse with one large roll up door

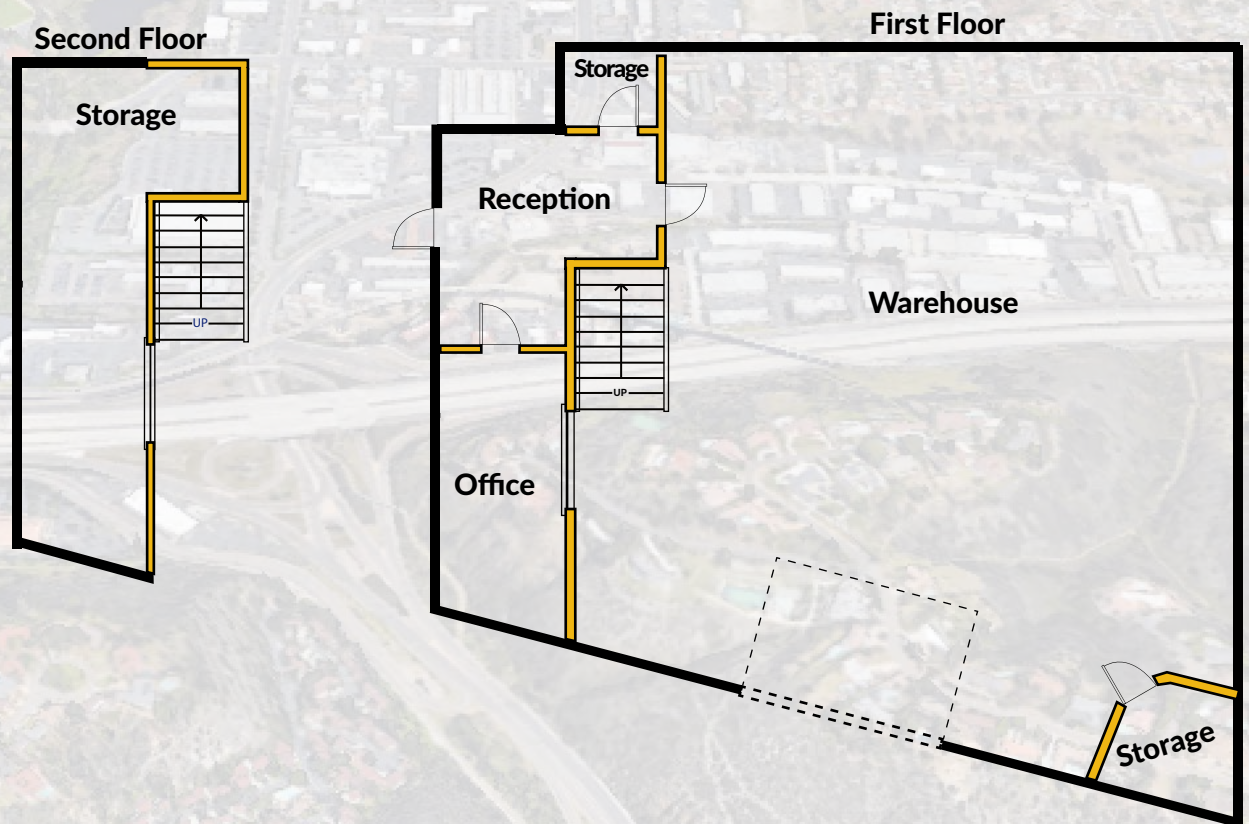

MISSION GORGE RD | SAN DIEGO, CA