

- POWER & COMMUNICATION NOTES:**
1. ALL WALL & FLOOR FURNITURE PANELS IN FEEDS & ALL FEEDS SHALL BE TO BE INSTALLED BY FURNITURE VENDOR.
 2. ALL VOICE & DATA CABLES TO BE PER TENANTS SPECIFICATION AND ARE TO BE TAGGED, TESTED & CERTIFIED. PROVIDE CABLES SLACK AT THE TERMINATION POINTS.
 3. ALL TELEPHONE & DATA CABLES TO BE BROUGHT BACK TO COMPUTER ROOM TELE DATA TERMINATION POINTS, U.O.D.
 4. SEE TENANTS FOR SPECIFIC CABLE LOCATIONS AT MILLWORK AND OTHER LOCATIONS. COORDINATE ALL AIRSPACE CABLE LOCATIONS WITH OFFICES.
 5. PROVIDE INSTALLATION INSTRUCTIONS.
 6. COORDINATE ALL WALL OUTLET LOCATIONS AT FURNITURE WITH THE FURNITURE VENDOR.
 7. SEE ENGINEER'S DRAWINGS AND WORKSHEET.
 8. CONDUIT LEAVE THE ROOMS, SEE AREA REQUIREMENTS IN THE SERVER & IDF ROOMS.
 9. PROVIDE SPACES FOR PANTRY & IDF ROOMS. MOUNTED TO WALL IN THE SERVER ROOM FOR TELEPHONE SYSTEM LOCATION AS DETERMINED BY TENANTS TELE DATA CONTRACTOR.
 10. COORDINATE WITH TELEPHONE CONTRACTOR.
 11. ALL SMALL POWER FUNCTION ROOMS AND CIRCUITRY FOR PHONE AND DATA MOUNTING CONDUIT SHALL BE 1/2" ABOVE FINISHED CEILING. WIRING SHALL BE IN TELE DATA CONTRACTOR.
 12. ALL OUTLETS SHALL BE AT 18" A.F.F. U.O.D.
 13. NEW ELECTRICAL CONNECTIONS TO FURNITURE SYSTEMS SHALL BE MADE BY ELECTRICAL CONTRACTOR.
 14. TYPE PROTECTIONS SCREENS AND ALL OTHER AV EQUIPMENT SHALL BE FURNISHED BY OTHERS. ALL REQUIRED POWER, CONDUIT AND BLOCKING SHALL BE BY E.C.

POWER & COMMUNICATION KEY NOTES:

1. PROVIDE (2) CONDUIT - ONE FOR ELECTRIC AND ONE FOR DATA, WITHIN EXTERIOR WALLS TO SYSTEM BY THE LENGTH BETWEEN WINDOWS.

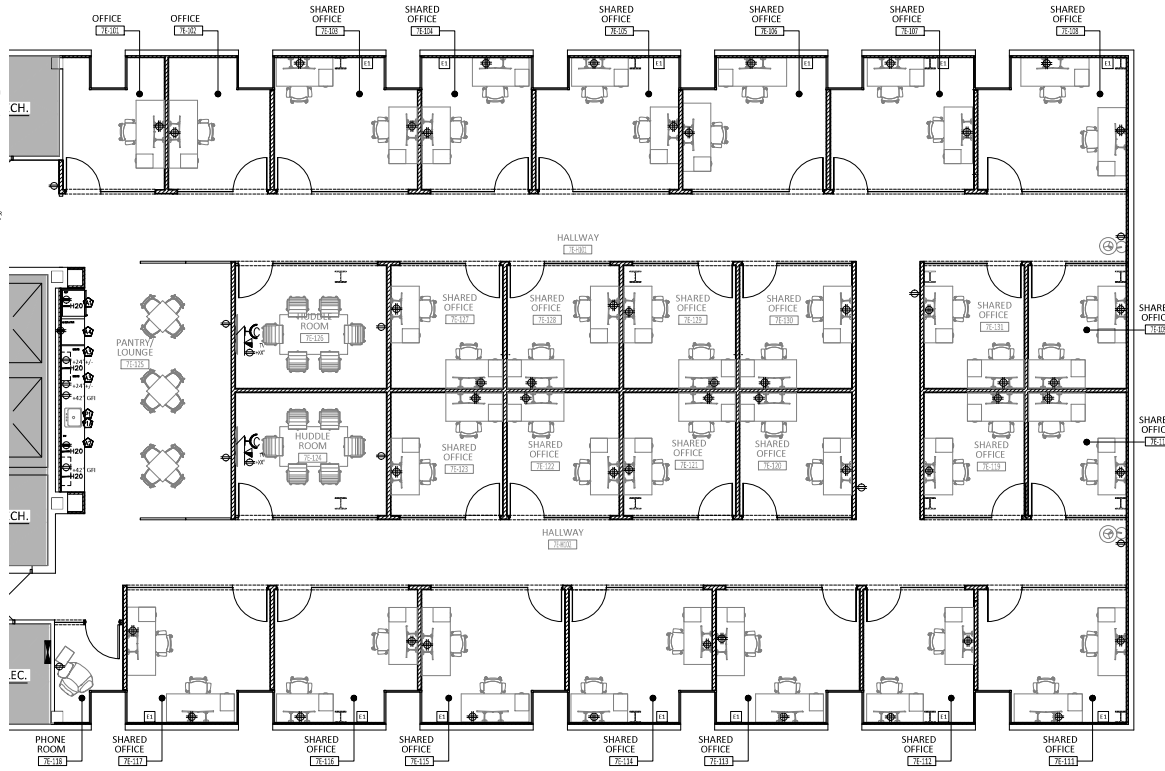

1 7TH FLOOR EAST POWER & COMMUNICATIONS PLAN
SCALE: 1/4" = 1'-0"

PLUMBING SCHEDULE								
EQUIP. TAG	ITEM	MANUFACTURER	MODEL #	DESCRIPTION	SIZE VWDxH	FINISH	HARDWARE/ELECTRICAL REQD.	NOTES
P1	UNDERMOUNT SINK (PANTRY)	ELKAY	ELUHAD211555	GOURMET LUSTERTONE UNDERMOUNT	21" x15"	STAINLESS STEEL		
P4	FAUCET (PANTRY)	GROHE	33645-DO	SINGLE-HANDLE PULLDOWN SPRAWER FAUCET		SUPERSTEEL FINISH		
P2	BOTTLE FILLING STATION	ELKAY	LEW5AB5	ES20T IN-WALL BOTTLE FILLING STATION	19.75" Wx40.13" Hx19.75" D	STAINLESS STEEL	115V/60Hz 300W	REFER TO MANUFACTURER CUT SHEET FOR INSTALLATION REQUIREMENTS

APPLIANCE SCHEDULE									
EQUIP. TAG	ITEM	MANUFACTURER	MODEL #	DESCRIPTION	SIZE VWDxH	FINISH	ELECTRICAL REQD.	WATERLINE REQD.	NOTES
A1	REFRIGERATOR	TED	TED			STAINLESS STEEL		X	
A2	DISHWASHER	TED	TED			STAINLESS STEEL		X	
A3	MICROWAVE	GE	PERMESTER PROFILE L1 CUPT.		24" W x 22 1/2" D x 12 1/2" H	STAINLESS STEEL			
A4	REFRIGERATOR								

- POWER & COMMUNICATION SYMBOL LEGEND**
- NEW 15AMP/20AMP ELECTRICAL RECEPTACLE AT 18" AFF. UNLESS OTHERWISE NOTED: 20 AMPERE, 125 VOLT, 2-POLE, 3-WIRE GROUNDING, FINISH: TRO
 - NEW 20 AMPERE ELECTRICAL RECEPTACLE AT 18" AFF. UNLESS OTHERWISE NOTED: 20 AMPERE, 125 VOLT, 2-POLE, 3-WIRE GROUNDING, FINISH: TRO
 - NEW DEDICATED GROUND POWER RECEPTACLE 18" A.F.F. (U.O.D.)
 - NEW YORK/FLORIDA/IL/C3 WORK/DATA BOX SHOWN FOR SCHEMATIC DESIGN ONLY. TENANT'S RESPONSIBILITY FOR COORDINATING NUMBER OF CABLES FOR EACH RECEPTACLE AND FRAGILE LOCATIONS WITH THEIR RESPONSIBILITY FOR MOUNTING TELEPHONE/FLOOR PHONE VENDOR.
 - NEW FLOOR FLOOR MTS. TELEDATA AND ELECTRIC RECEPTACLES. SEE ENGINEER'S DRAWINGS FOR FURTHER INFORMATION. COORDINATE LOCATION WITH FURNITURE VENDOR.
 - PROPOSED LOCATION OF OUTLET FOR TENANT'S TELEVISION. COORDINATE LOCAL LOCATION IN FIELD WITH TENANT'S & TENANT'S ANY CONSULTANT. CODED: OUTLET REQUIREMENTS WITH TENANT'S CONSULTANT.
 - INDICATES RECEPTACLE MOUNTING HEIGHT IN INCHES S.F.F.
 - INDICATES GROUND FAULT INTERRUPT. PROVIDE AS REQUIRED BY CODE.
 - ELECTRICAL PANEL



LOCUS DESIGN COLLABORATIVE
115 E. PUTNAM AVENUE
GREENWICH, CT 06030
203-742-8720
WWW.LOCUSDESIGNCOL.COM



CAPITAL EQUITIES
PROJECT DESCRIPTION
7TH FLOOR RENOVATION
PROJECT ADDRESS
50 WASHINGTON STREET,
SOUTH NORWALK
PROJECT NO.
19102

ISSUE LOG

NO.	DATE	DESCRIPTION	BY

Progress Set
07/22/2025

7TH FL. EAST: POWER & COMMUNICATIONS PLAN

A102.3