



# RETAIL/FLEX/WAREHOUSE SPACE FOR LEASE

1029 E. GUDE DRIVE, SUITE 108-109, ROCKVILLE, MD 20850

## HIGH EXPOSURE & SIGNAGE DIRECTLY ON EAST GUDE DRIVE!

CURRENTLY OCCUPIED BY HABITAT FOR HUMANITY RESTORE. HABITAT IS RELOCATING.

**SIZE:**

- Approx. 22,125 rentable SF.

**FEATURES:**

- 18' clear ceiling.
- 2 full-height loading docks + double doors with ramp.
- Available July 1, 2026.
- Heated and air conditioned throughout.
- Zoned IL, light industrial, Montgomery County, MD.

**PRICE:**

- \$19/SF NNN.
- NNN charges approx. \$5.25/SF.

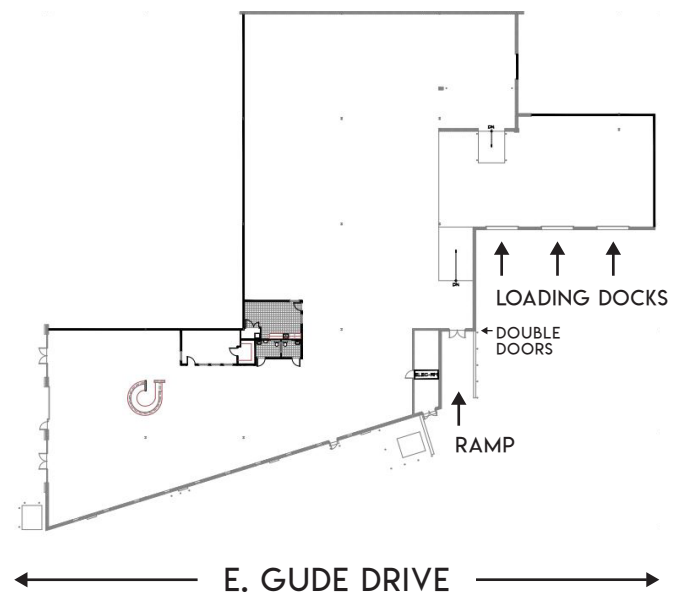

**CONTACT:**

JAY CLOGG  
301.340.9400  
JAY@JAYCLOGG.COM



JAY CLOGG REALTY GROUP, INC.  
301.340.9400 • JAYCLOGG.COM • @JAYCLOGG  
110 N. WASHINGTON STREET • ROCKVILLE, MD 20850