

LOT 6

2890 FAIVRE STREET, CHULA VISTA, CA 91911

OTAY RIVER BUSINESS PARK

±33.5 ACRE MASTER PLANNED BUSINESS PARK
UNITS FOR LEASE FROM 16,845 SF TO 19,456 SF
AVAILABLE APRIL 2026

MICHAEL MOSSMER, SIOR
SENIOR VICE PRESIDENT, PARTNER
LIC #00998326
858.405.4284
MMOSSMER@VOITCO.COM

Voit
REAL ESTATE SERVICES



CLICK IMAGE TO TAKE A VIRTUAL TOUR



2890 FAIVRE STREET, CHULA VISTA, CA 91911

OVERVIEW OF FEATURES

SUITE 100: 16,845 SF

| | |
|--------------|---|
| OFFICE | 1,541 SF |
| POWER | 200 Amps, 480 Volt, stepped down to 120/208 V |
| LOADING | 2 Docks Doors and 1 Ramp |
| CLEAR HEIGHT | 24' |
| PARKING | ± 34 Parking Spaces |

SUITE 120: 19,456 SF SF

| | |
|--------------|---|
| OFFICE | 2,220 SF |
| POWER | 200 Amps, 480 Volt, stepped down to 120/208 V |
| LOADING | 5 Docks Doors and 2 Ramps |
| CLEAR HEIGHT | 24' |
| PARKING | ± 43 Parking Spaces |

AVAILABILITY OVERVIEW

| SUITE | TOTAL SF | DOCK DOORS | RAMPS | AVAILABLE | LEASE RATE |
|-------|-----------|------------|-------|------------|------------|
| 100 | 16,845 SF | 2 | 1 | April 2026 | ASK BROKER |
| 120 | 19,456 SF | 5 | 2 | June 2026 | ASK BROKER |

2890 FAIVRE STREET

BUILDING FEATURES

- » 43,420 SF Freestanding Building
- » Divisible into two suites from 16,845 SF & 19,456 SF
- » Total 2,000 amps of 480 volt power available in the Building
- » 2.2/1,000 parking ratio (96 parking stalls)
- » 24' ceiling clear height
- » Skylights
- » ESFR ready sprinklers
- » Minimum of 2 docks and 1 ramp loading door per unit

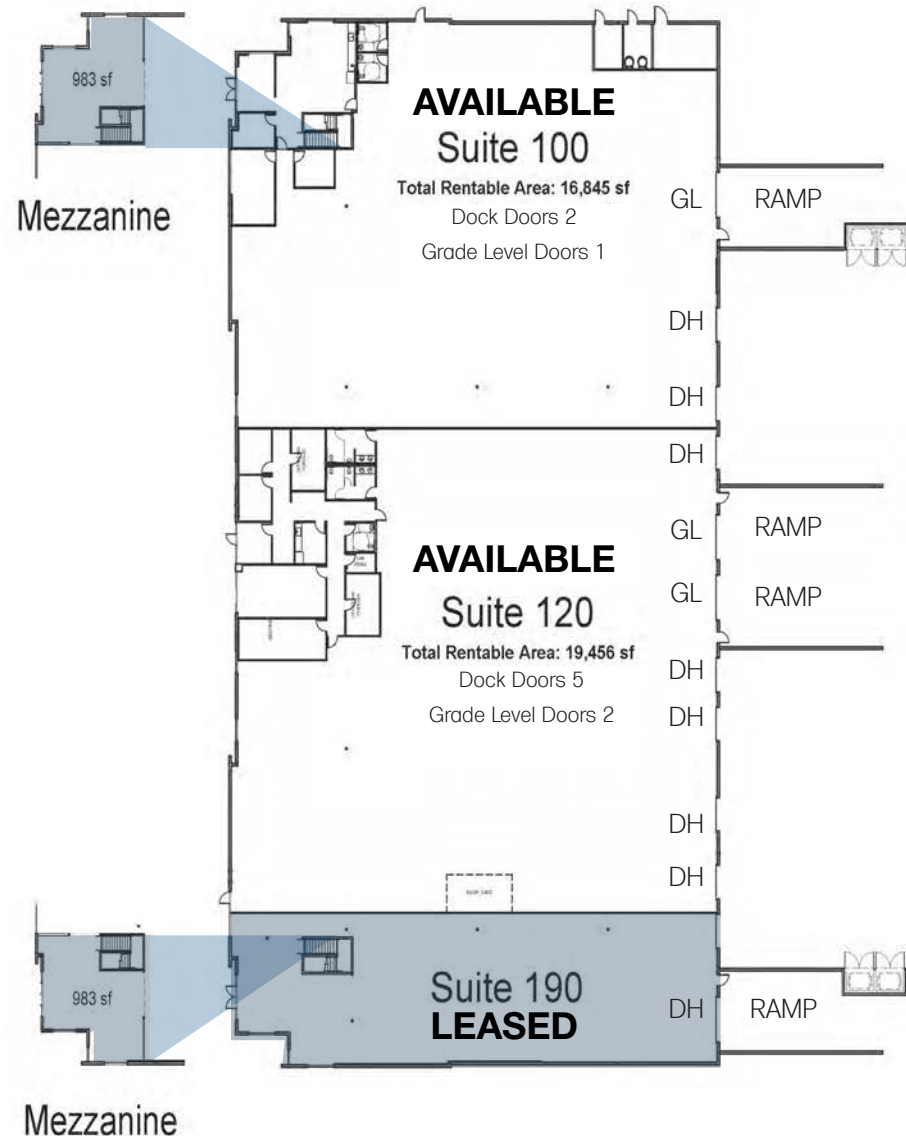

LOT 6

2890 FAIVRE STREET, CHULA VISTA, CA 91911

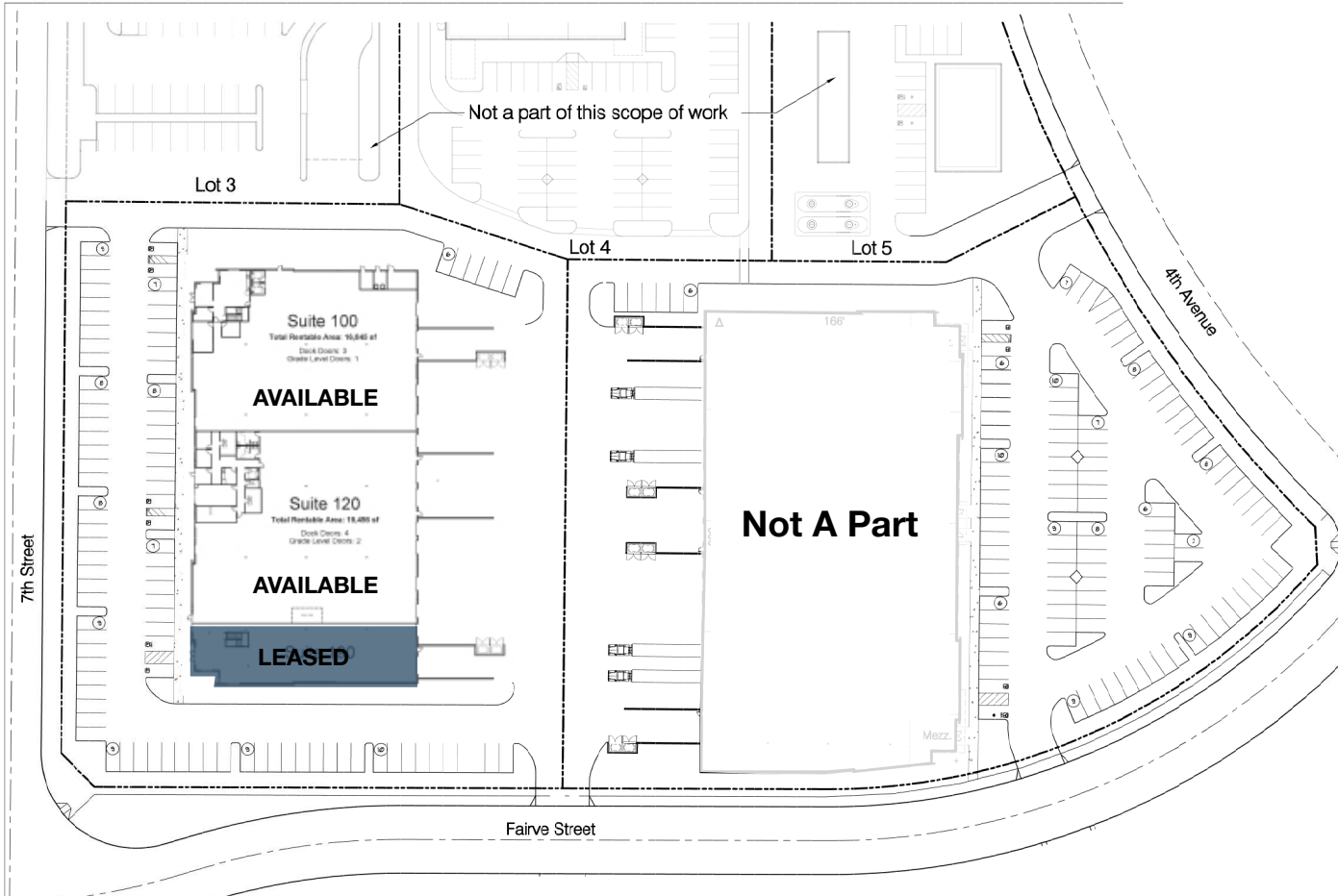

LOT 6

2890 FAIVRE STREET, CHULA VISTA, CA 91911

Otay River Business Park

Sudberry Properties, Inc.

ALLEY

MAINSTREET

4TH AVE

ORBP MASTER PLAN

LOT 6
2.79 AC

LOT 7
3.28 AC

FAIVRE STREET

LOT 8

LOT 10

LOT 11

LOT 12

BIO RETENTION
POND

BROADWAY

OTAY RIVER OPEN SPACE

Voit

REAL ESTATE SERVICES

LOT 6

2890 FAIVRE STREET, CHULA VISTA, CA 91911

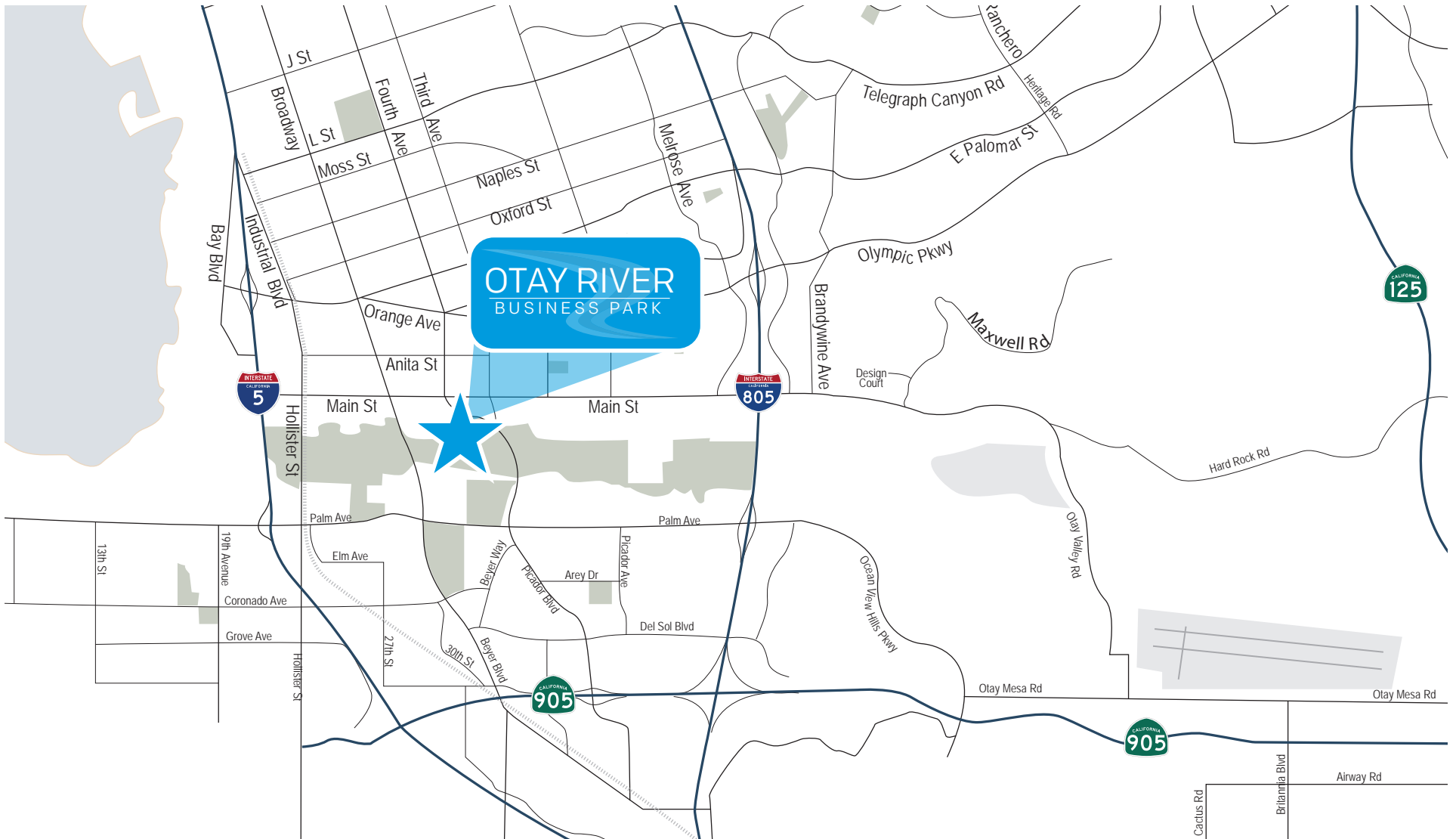

LOT 6

2890 FAIVRE STREET, CHULA VISTA, CA 91911



MICHAEL MOSSMER, SIOR | SENIOR VICE PRESIDENT, PARTNER | 858.405.4284 | mmossmer@voitco.com | Lic #00998326

4180 La Jolla Village Drive, Suite 100, La Jolla, CA 92037 • 858.405.4284 • 858.408.3976 Fax • Lic #01991785 • www.voitco.com

Licensed as Real Estate Salesperson by DRE. The information contained herein has been obtained from sources we deem reliable. While we have no reason to doubt its accuracy, we do not guarantee it. ©2025 Voit Real Estate Services, Inc. All Rights Reserved.

Voit
REAL ESTATE SERVICES