

MISSION VIEJO COMMERCE PARK

23382 Madero, Suite M
Mission Viejo, CA

1,476 Square Feet

\$1.65 SF/MO

Triple Net

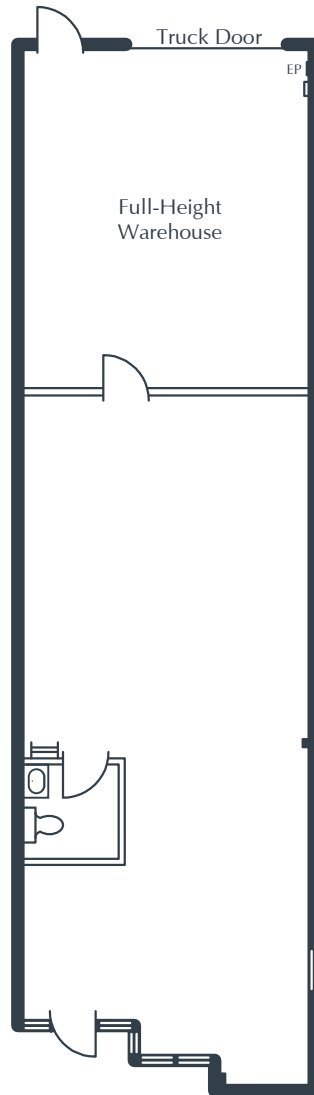

NOTES

Reception

Restroom

Large Open Work Area

Ground-Level Truck Door

Approximately 437 sq. ft. of Full-Height Warehouse

Part of a Professionally Managed Business Park

Created by Olen Commercial Realty Corp., 2022.
Information is not to be published or copied without
written approval. Square footage and floor plans are
estimates and should be separately verified. All rates,
terms, floor plans, and building facts are subject to
change without notice.

ea 05.14.2025

ELLYSSA DERRY

Senior Leasing Director

949.719.7204

ederry@olen.com



Seven Corporate Plaza

Newport Beach, CA

949.644.6536

www.olen.com