



**PINNACLE  
REALTY**  
OF NEW YORK, LLC

EXCLUSIVE LISTING

**FOR LEASE**



**250 GREENPOINT AVENUE**

**BROOKLYN, NY 11222**

# 7,800 Sq. Ft. Warehouse in Greenpoint

With Interior Loading Platform  
On-Site Parking Available

Type

**Warehouse / Loft / Industrial**



SQUARE FOOT

**7,800<sub>RSF</sub>**



ZONING

**M1-1**



CLEAR HEIGHT

**12'**



PARCEL ID

**2578**

BLOCK



LOADING

**1 INTERIOR DOCK**



**1**

LOT

PRICE

**Upon Request**

718-784-8282 / PINNACLERENY.COM

All information is from sources deemed reliable and is submitted subject to errors, omission, changes of price or other conditions, prior sale, rent and withdrawal without notice.

# Property Overview

## Features

- 7,800 Sq. Ft.
- 29' Interior Loading Dock
- Ample Natural Light/Windows
- New Concrete Floor
- New Bathrooms & Lighting
- Column Spacing 19' x 19'
- On-Site Parking Available
- Available Immediately
- Additional Loading Area that can Accommodate Large Trucks

## Ideal for

- Storage and Distribution
- Creative Uses
- Light Manufacturing

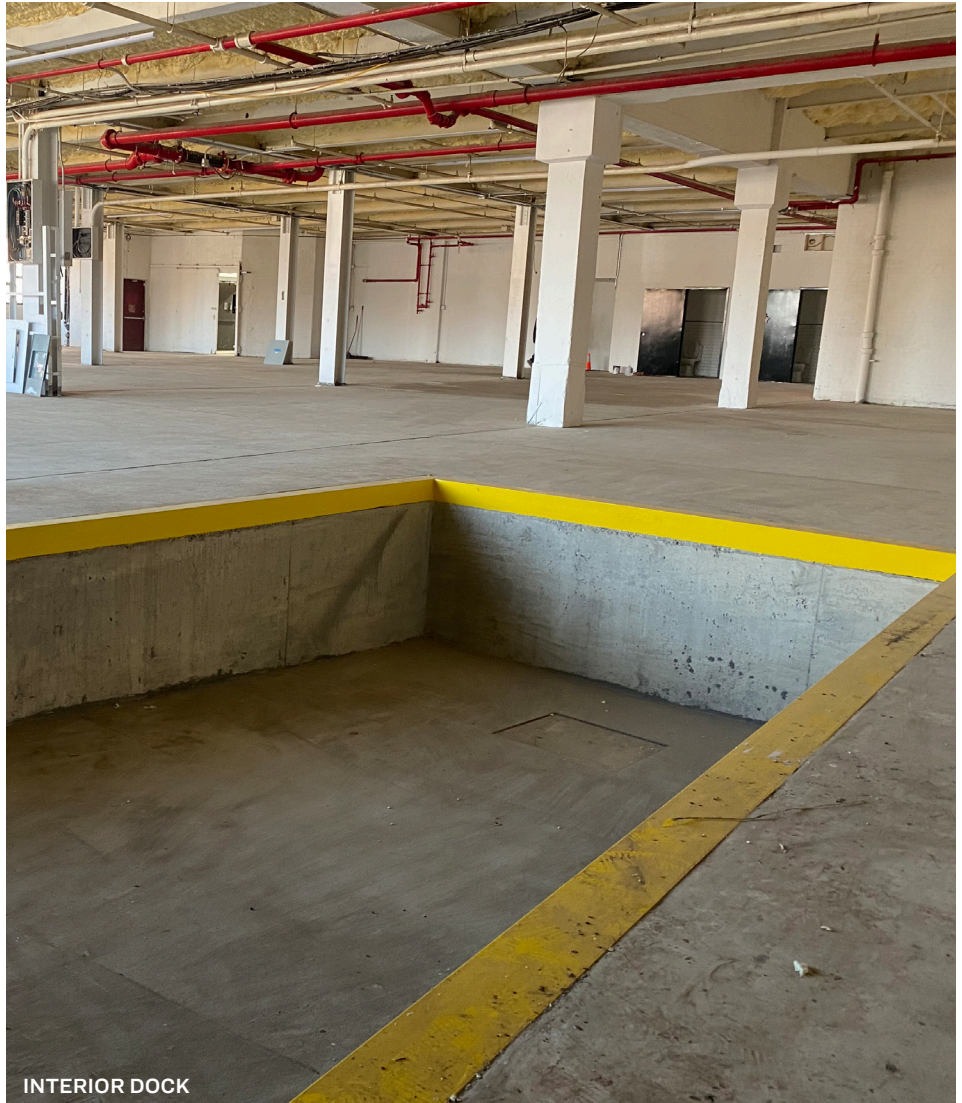

INTERIOR DOCK

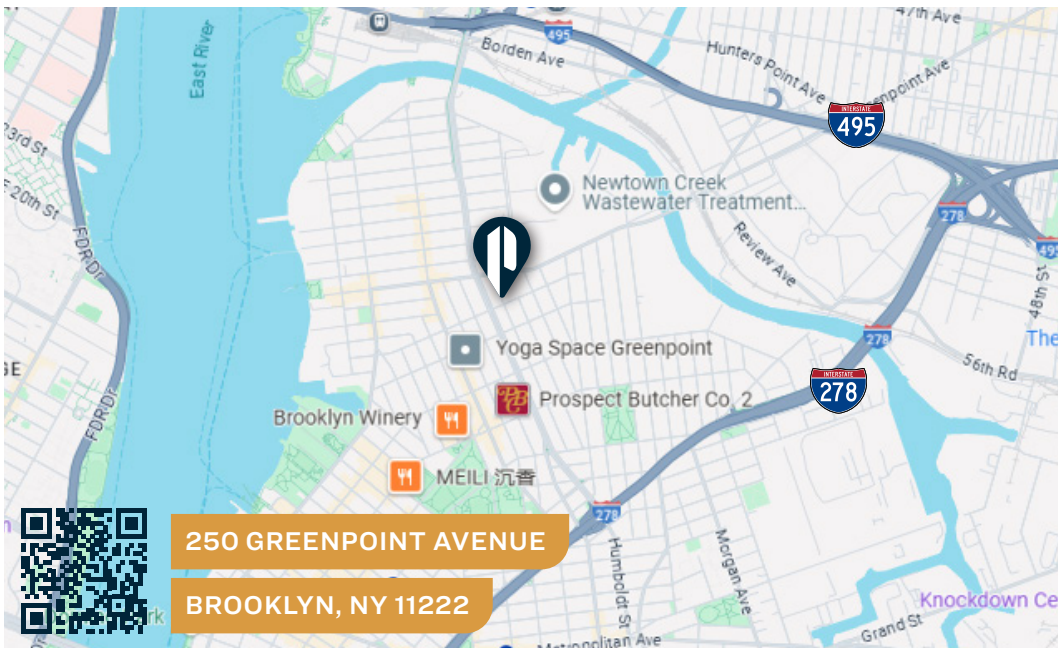

250 GREENPOINT AVENUE

BROOKLYN, NY 11222

## TRANSPORTATION



GREENPOINT  
AVE STATION



MIDTOWN  
TUNNEL  
LONG ISLAND  
EXPRESSWAY

WILLIAMSBURG  
BRIDGE



B24: GREENPOINT  
AVE/MCGUINNESS  
BLVD

B43, B62:  
MANHATTAN  
AVE/GREENPOINT  
AVE



718-784-8282 / PINNACLERENY.COM

All information is from sources deemed reliable and is submitted subject to errors, omission, changes of price or other conditions, prior sale, rent and withdrawal without notice.

## PICTURES



ADDITIONAL LOADING AREA THAT CAN ACCOMMODATE LARGE TRUCKS



34-07 Steinway Street, Suite 202  
Long Island City, NY 11101  
718-784-8282  
[pinnaclereny.com](http://pinnaclereny.com)

FOR MORE INFORMATION ABOUT THIS PROPERTY CONTACT EXCLUSIVE AGENTS:



**PAUL BRALOWER**  
Associate Broker  
[pbralower@pinnaclereny.com](mailto:pbralower@pinnaclereny.com)  
718-371-6402



**BRENDAN BURKE**  
Associate Broker  
[bburke@pinnaclereny.com](mailto:bburke@pinnaclereny.com)  
718-371-6403



**DAVID JUNIK**  
Partner  
[djunik@pinnaclereny.com](mailto:djunik@pinnaclereny.com)  
718-371-6406



**MARK CASO**  
Salesperson  
[mcaso@pinnaclereny.com](mailto:mcaso@pinnaclereny.com)  
718-371-6419