

401

WEST 207th STREET

OFF THE CORNER OF 207TH ST & 9TH AVE | INWOOD, NYC



 Ponce Bank

 Rising Scholars
LEARNING CENTER

 Golden Era
Social Activity Cafe

 DYCKMAN
BEER CO

 CROWN

401

WEST 207th STREET

OFF THE CORNER OF 207th ST & 9th | INWOOD

PROPERTY HIGHLIGHTS:

- New construction space
- Highly trafficked area connecting Inwood to The Bronx via the University Heights Bridge
- Situated at the base of 300 unit residential building
- Development sites on this intersection totaling over 1,500 units
- 15' x 35' two-story high opening for loading dock
- separate lobby + entryway to lower level
- Great for: Retail, Medical, School, Fitness, and more!

SIZE: Ground Floor: 2,500 SF (approx)
Lower Level: 18,500 SF (approx) **LEASED**

FRONTAGE: 40'

CEILING HEIGHT: 17.5' to 20.5' Ground Floor
17' Lower Level

DELIVERY: Immediate

ASKING RENT: Upon Request

TRANSPORTATION: A 1 Bx12 M100



FOR MORE INFORMATION, PLEASE CONTACT:

ELI YADID

EYadid@ksrny.com

917.770.9173

401

WEST 207th ST

CORNER OF 207TH STREET & 9TH AVE
INWOOD, NYC

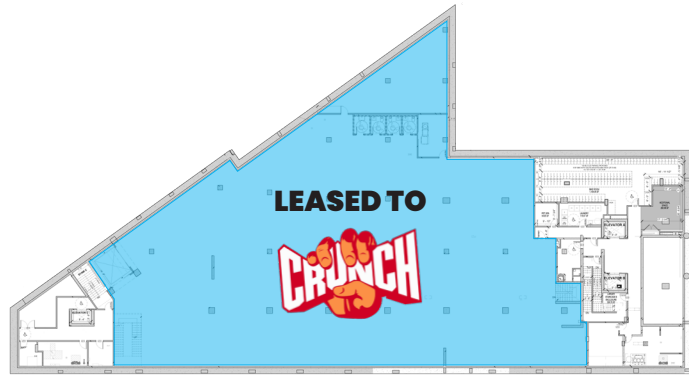

Lower Level

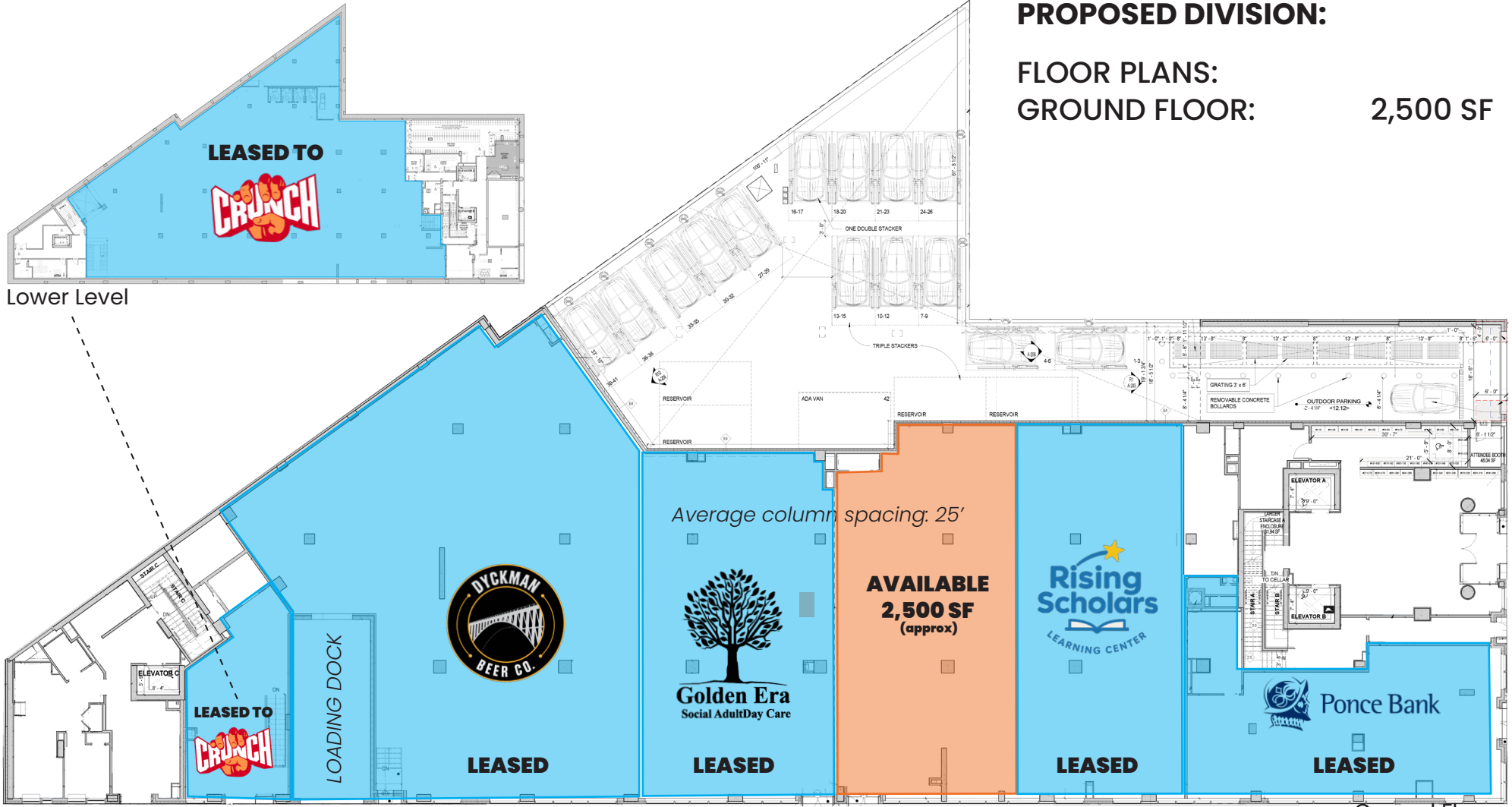

Ground Floor

401

WEST 207th ST

CORNER OF 207TH STREET & 9TH AVE
INWOOD, NYC

AREA DEMOGRAPHICS:



ANNUAL
RIDERSHIP:
1.352 MILLION
207TH ST **1** TRAIN STATION



POPULATION:
176,513



NUMBER OF
HOUSEHOLDS:
64,219



AVG. HOUSEHOLD
INCOME:
\$61,605



TOTAL CONSUMER
SPENDING:
\$1,300,000,000

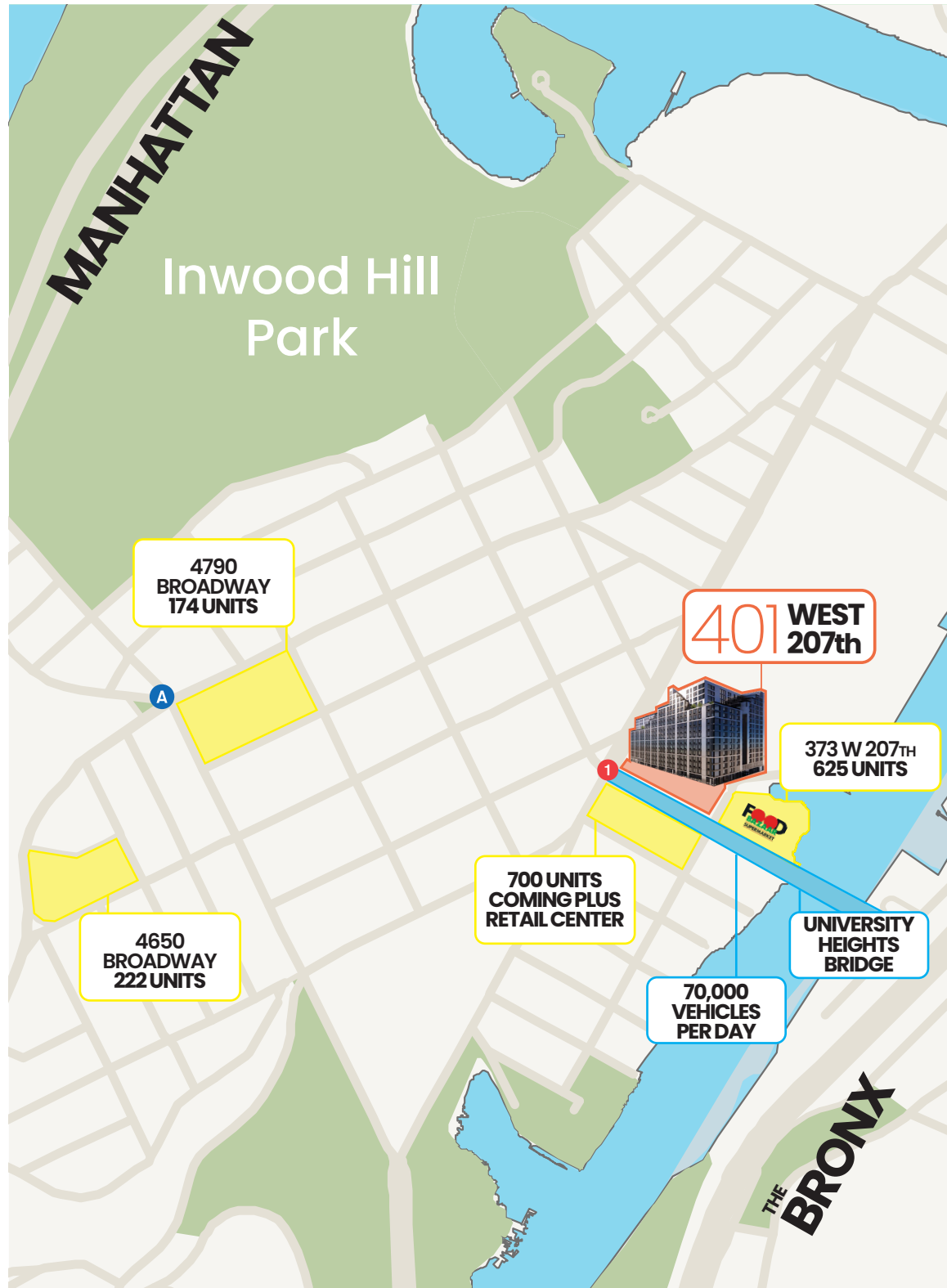

FOR MORE INFORMATION, PLEASE CONTACT:

ELI YADID

EYadid@ksrny.com

917.770.9173

ROYEE ZARUM

RZarum@ksrny.com

347.755.8137



1385 Broadway, 22nd Floor | New York, NY 10018

212.417.9217

ksrny.com

All information supplied in this marketing presentation and/or flyer is from sources deemed reliable and is furnished subject to errors, omissions, modifications, removal of listings from sale/lease and to any listing condition. Any square footage, dimensions, floor plans and/or technical data set forth are approximations and are subject to further elaboration/confirmation.