

280 N. MIDLAND
AVENUE
SADDLE BROOK, NJ

Zuckerberg's
Industrial Park

30,314 SF | BUILDING O-1

Warehouse /
Flex Space

Excellent
highway
access

Major
upgrades
throughout
park

Professionally
owned &
managed by

SITEX
GROUP

Fully
Air-Conditioned
& Humidity
Controlled



NAI James E. Hanson
COMMERCIAL REAL ESTATE SERVICES, WORLDWIDE

For more information

Kenneth D. Lundberg, SIOR
Senior Vice President
201 488 5800 x138
klundberg@naihanson.com

Patrick Lennon
Senior Vice President
201 488 5800 x109
plennon@naihanson.com

Lorenzo Lambiase, MBA, CCIM
Vice President
201 488 5800 x176
llambiase@naihanson.com

FOLLOW US! | NJ Offices: Teterboro | Parsippany | naihanson.com | Member of NAI Global with 325+ Offices Worldwide

The information contained herein has been obtained from sources considered to be reliable, but no guarantee of its accuracy is made by NAI James E. Hanson

Total Space
±30,314 SF

Warehouse
±25,778 SF

Office
±4,536 SF

Two (2) Tailgates
One (1) Drive-In

Ceiling Height
14'4"

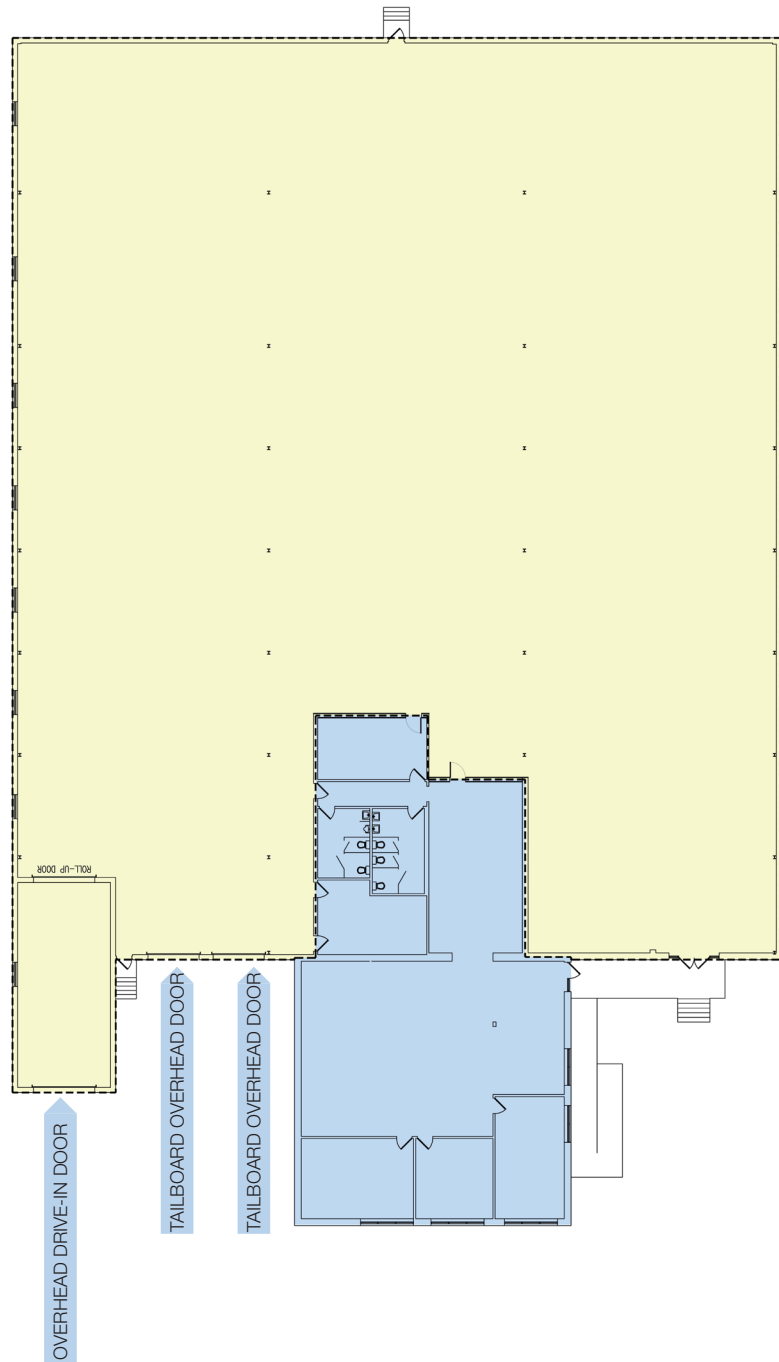
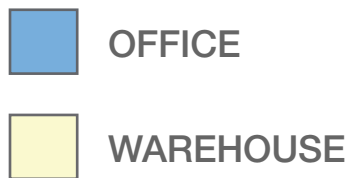

REGIONAL MAP

Zuckerberg's Industrial Park

At the Crossroads of Bergen County

Access building via N. Midland Ave
Click [HERE](#) for directions



GW Bridge
10.5 miles



Lincoln Tunnel
14.7 miles



Pulaski Skyway
18.0 miles



Holland Tunnel
18.8 miles



Mario Cuomo Bridge
22.4 miles



Newark Airport
23.7 miles



Port Newark
24.5 miles

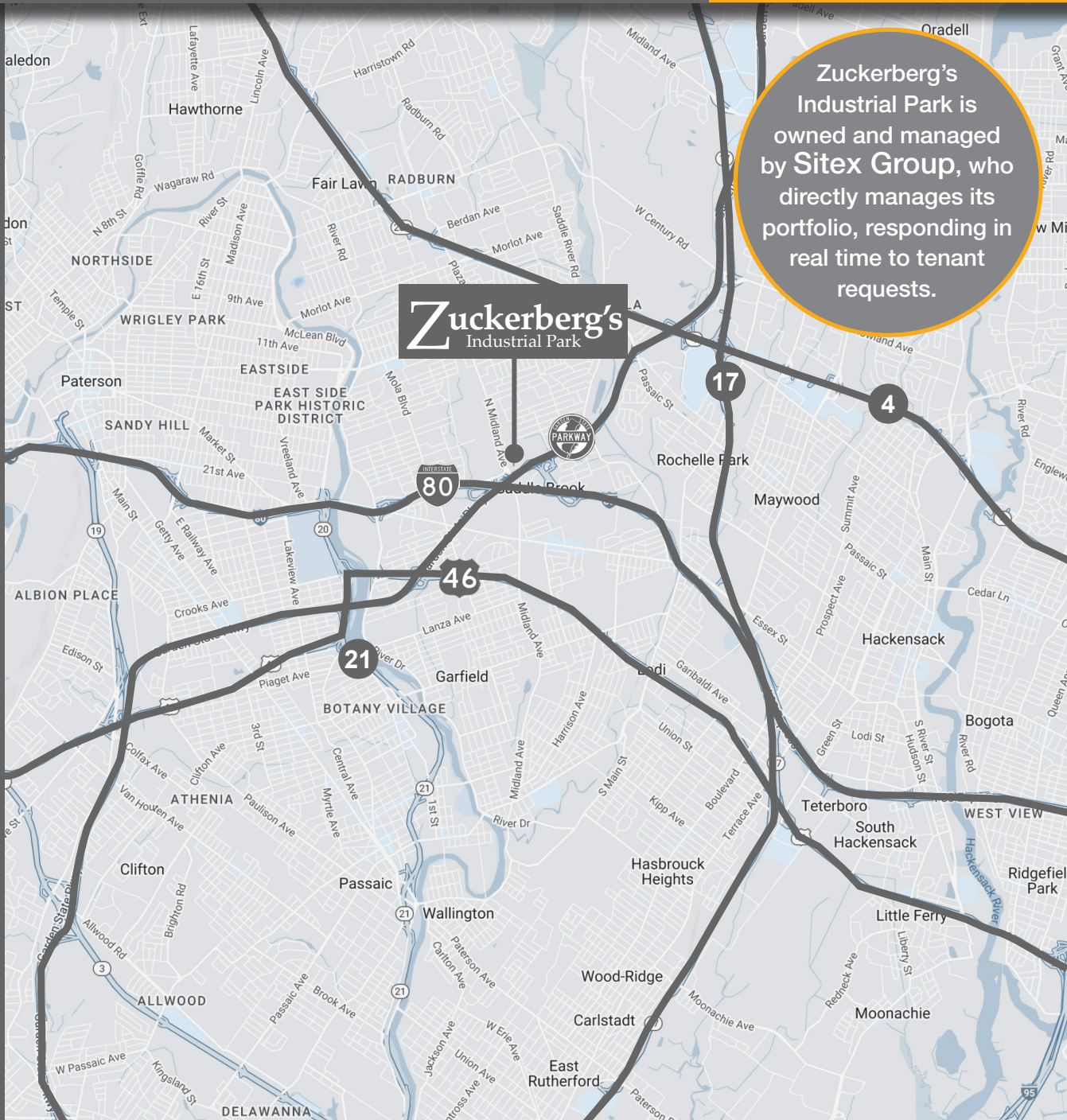

Zuckerberg's Industrial Park is owned and managed by Sitex Group, who directly manages its portfolio, responding in real time to tenant requests.

Zuckerberg's
Industrial Park

For leasing information, call 201 488 5800
Ken Lundberg x138 / Pat Lennon x109 / Lorenzo Lambiase x176

NAI James E. Hanson
COMMERCIAL REAL ESTATE SERVICES, WORLDWIDE

FOLLOW US! | NJ Offices: Teterboro | Parsippany | naihanson.com | Member of NAI Global with 325+ Offices Worldwide

The information contained herein has been obtained from sources considered to be reliable, but no guarantee of its accuracy is made by NAI James E. Hanson