

AVAILABLE FOR LEASE

**22391 GILBERTO**  
Rancho Santa Margarita, CA

**SPACES AVAILABLE FROM 2,350 SF - 3,900 SF**



**PROPERTY FEATURES:**

- High Image 2-story building
- 2 Units Available
- Shared gated yard
- 3:1 parking ratio
- 22' clear height
- Street parking available
- Excellent glass line
- CAM Fee \$0.25 PSF
- Easy access to the 241 Foothill Transportation Corridor and numerous retail amenities



Exclusively Listed By:

**BJ FELL**  
Senior Vice President  
License ID# 01929179  
949.790.3114  
bfell@leeirvine.com

**MARK JERUE**  
Senior Vice President  
License ID# 01073399  
949.790.3121  
mjerue@leeirvine.com

**CRAIG FITTERER**  
Senior Vice President  
License ID# 01246929  
949.790.3123  
cfitterer@leeirvine.com

**LEE & ASSOCIATES**  
COMMERCIAL REAL ESTATE SERVICES

No warranty or representation is made to the accuracy of the foregoing information. Terms of sale or lease and availability are subject to change or withdrawal without notice.

AVAILABLE FOR LEASE

**22391 GILBERTO**  
Rancho Santa Margarita, CA

**SPACES AVAILABLE FROM 2,350 SF - 3,900 SF**

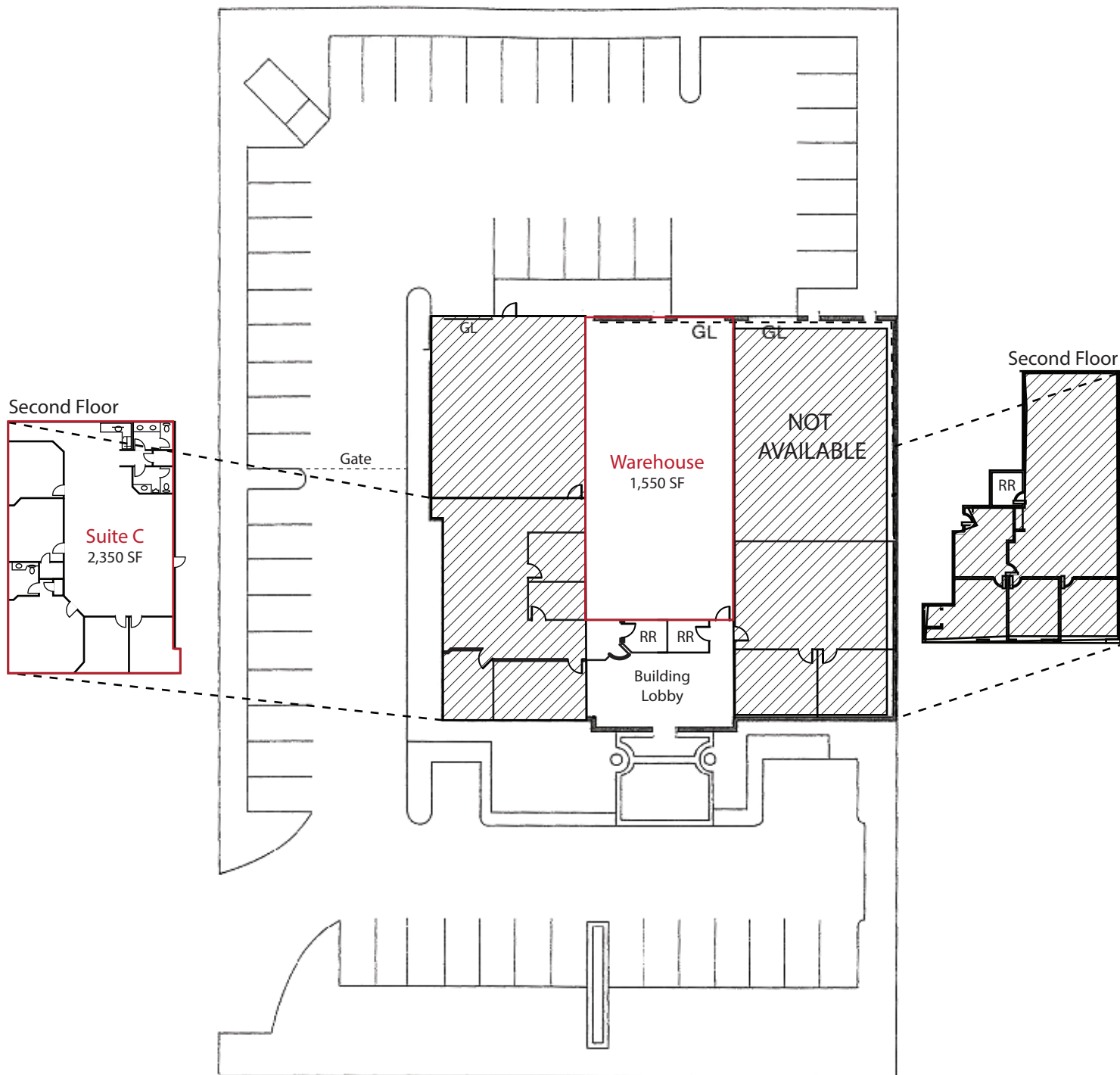

Exclusively Listed By:

**BJ FELL**  
Senior Vice President  
License ID# 01929179  
949.790.3114  
bfell@leeirvine.com

**MARK JERUE**  
Senior Vice President  
License ID# 01073399  
949.790.3121  
mjerue@leeirvine.com

**CRAIG FITTERER**  
Senior Vice President  
License ID# 01246929  
949.790.3123  
cfitterer@leeirvine.com

 **LEE &  
ASSOCIATES**  
COMMERCIAL REAL ESTATE SERVICES

No warranty or representation is made to the accuracy of the foregoing information. Terms of sale or lease and availability are subject to change or withdrawal without notice.