

3730 RIVERSIDE AVENUE

Colton, CA

Short Term Deals Available

±11,659 SF TRUCK SERVICE FACILITY
FOR LEASE
±134,318 (3.08 ACRES)



Voit
REAL ESTATE SERVICES



SHY ASSAR, MBA/MRED
Senior Vice President, Partner
Lic # 01964667
909.545.8091
sassar@voitco.com

IAN OZIMEC, CCIM
Senior Associate
Lic # 02040261
909.545.8001
iozimec@voitco.com

BRADEN SPRENGER
Associate
Lic # 02190434
714.833.9623
bsprenger@voitco.com

3280 East Guasti Rd., Suite 100, Ontario, CA 91761 • 909.545.8000 • 909.354.3253 Fax www.voitco.com

Licensed as Real Estate Salespersons by the DRE. The information contained herein has been obtained from sources we deem reliable. While we have no reason to doubt its accuracy, we do not guarantee it. ©2025 Voit Real Estate Services, Inc. All Rights Reserved. Lic. #01991785

3730 RIVERSIDE AVENUE

Colton, CA

±11,659 SF TRUCK SERVICE FACILITY
FOR LEASE
±134,318 (3.08 ACRES)

PROPERTY FEATURES

- ±11,659 SF Metal Building
 - Total Office: 4,696 SF
 - 2,412 SF First Floor Office
 - 2,824 SF Second Floor Office
 - Three (3) Service Bays
 - Five (5) Ground Level Doors
 - 17' Clear (verify)
 - 10,000-gallon double-walled fiberglass diesel UST
- ± 3.08 Usable Acres
 - Secured by wrought iron fence and electric gate with keypad
 - Yard is partially paved and partial gravel/dirt
 - Access to the I-10, I-215 & 60 Freeways

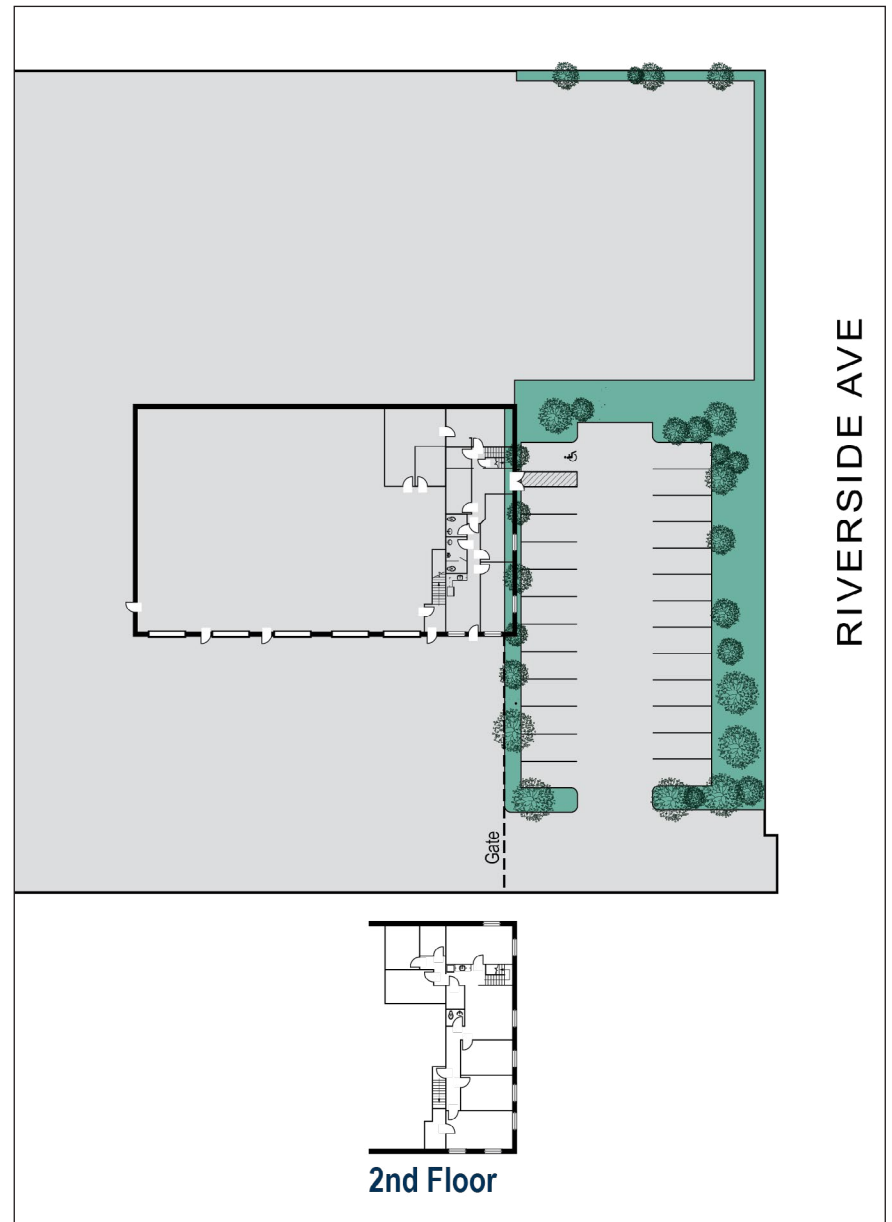

PROPERTY FEATURES : 2

Voit
REAL ESTATE SERVICES



SHY ASSAR, MBA/MRED
Senior Vice President, Partner
Lic # 01964667
909.545.8091
sassar@voitco.com

IAN OZIMEC, CCIM
Senior Associate
Lic # 02040261
909.545.8001
iozimec@voitco.com

BRADEN SPRENGER
Associate
Lic # 02190434
714.833.9623
bsprenger@voitco.com

3280 East Guasti Rd., Suite 100, Ontario, CA 91761 • 909.545.8000 • 909.354.3253 Fax www.voitco.com

Licensed as Real Estate Salespersons by the DRE. The information contained herein has been obtained from sources we deem reliable. While we have no reason to doubt its accuracy, we do not guarantee it. ©2025 Voit Real Estate Services, Inc. All Rights Reserved. Lic. #01991785

3730 RIVERSIDE AVENUE

Colton, CA

±11,659 SF TRUCK SERVICE FACILITY
FOR LEASE
±134,318 (3.08 ACRES)

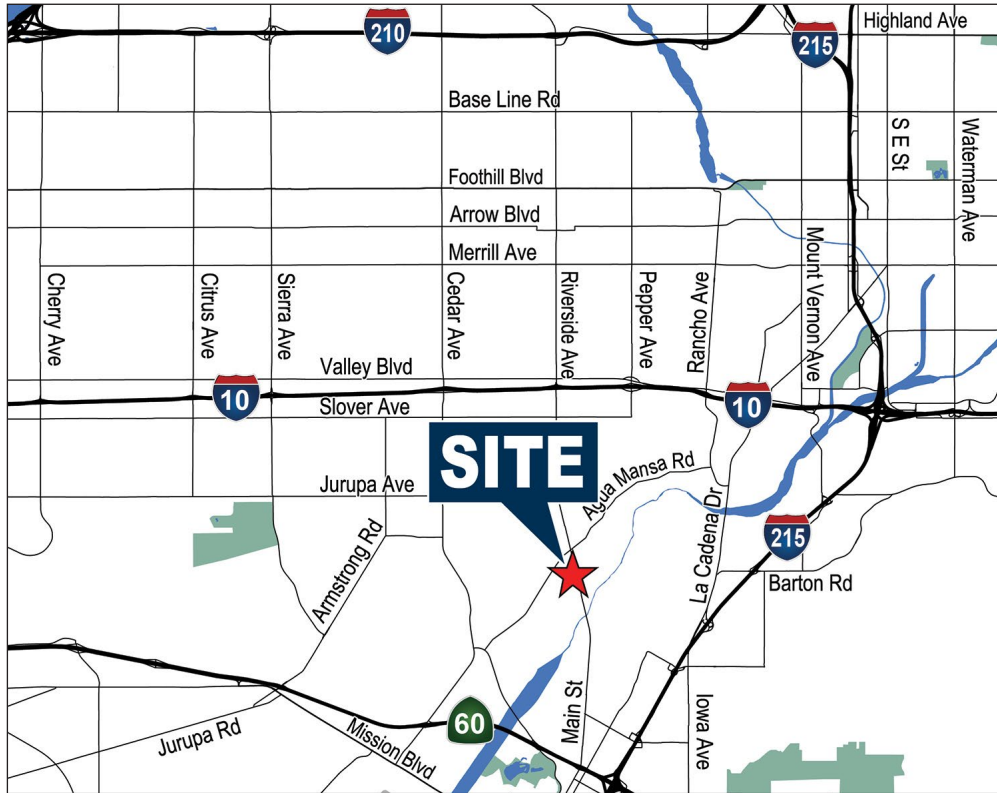

LOCATION

- 12.3 miles from SBD Int'l Airport (25 min) and 17.8 miles from Ontario Int'l Airport (23 min)
- Located in the center of supply-constrained Inland Empire, along the Agua Mansa Industrial Corridor
- 2.3 miles (5 min) from the I-215 Freeway Center Ave On/Off Ramps and 2.5 miles (5 min) from the I-10 Freeway Riverside Avenue On/Off Ramps

MAPS : 3

Voit
REAL ESTATE SERVICES



SHY ASSAR, MBA/MRED
Senior Vice President, Partner
Lic # 01964667
909.545.8091
sassar@voitco.com

IAN OZIMEC, CCIM
Senior Associate
Lic # 02040261
909.545.8001
iozimec@voitco.com

BRADEN SPRENGER
Associate
Lic # 02190434
714.833.9623
bsprenger@voitco.com

3280 East Guasti Rd., Suite 100, Ontario, CA 91761 • 909.545.8000 • 909.354.3253 Fax www.voitco.com

Licensed as Real Estate Salespersons by the DRE. The information contained herein has been obtained from sources we deem reliable. While we have no reason to doubt its accuracy, we do not guarantee it. ©2025 Voit Real Estate Services, Inc. All Rights Reserved. Lic. #01991785

3730 RIVERSIDE AVENUE

Colton, CA

±11,659 SF TRUCK SERVICE FACILITY
FOR LEASE
±134,318 (3.08 ACRES)



AERIAL : 4

Voit
REAL ESTATE SERVICES



SHY ASSAR, MBA/MRED
Senior Vice President, Partner
Lic # 01964667
909.545.8091
sassar@voitco.com

IAN OZIMEC, CCIM
Senior Associate
Lic # 02040261
909.545.8001
iozimec@voitco.com

BRADEN SPRENGER
Associate
Lic # 02190434
714.833.9623
bsprenger@voitco.com

3280 East Guasti Rd., Suite 100, Ontario, CA 91761 • 909.545.8000 • 909.354.3253 Fax www.voitco.com

Licensed as Real Estate Salespersons by the DRE. The information contained herein has been obtained from sources we deem reliable. While we have no reason to doubt its accuracy, we do not guarantee it. ©2025 Voit Real Estate Services, Inc. All Rights Reserved. Lic. #01991785