



# WESTWARD SHOPPING CENTER

West Palm Beach, Florida

Westward Shopping Center is conveniently located just west of I-95 on West Palm Beach's main thoroughfare, Okeechobee Blvd. It is a 233,176 square foot regional shopping center whose tenants benefit from their close proximity to Downtown West Palm Beach and the new Palm Beach Fashion Outlets.



### CENTER PROFILE

Total Square Feet	233,176
Number of Stores/Services	28
Number of Levels	1
Number of Parking Spaces	1,011

### MAJOR TENANTS

Burlington	55,000 SF
Havertys Furniture	44,000 SF
Harbor Freight Tools	21,600 SF
Office Depot	19,960 SF
Aldi	18,364 SF

### MARKET DEMOGRAPHICS

**1 Mile**

Population	16,092
Number of Households	5,746
Average Household Income	\$57,421

**3 Mile**

Population	119,104
Number of Households	52,012
Average Household Income	\$69,997

**5 Mile**

Population	261,049
Number of Households	104,943
Average Household Income	\$74,572

**Daily Vehicle Count**

Okeechobee Blvd	46,502
-----------------	--------



**WESTWARD SHOPPING CENTER**  
2501 Okeechobee Boulevard  
West Palm Beach, FL 33409

## WESTWARD SHOPPING CENTER TENANT LIST

### FOOTWEAR

Red Wing Shoe Store	17
Shoe Carnival	7

### HEALTH AND BEAUTY

GNC	20
-----	----

### ELECTRONICS

GameStop	22
----------	----

### WIRELESS AND CELLULAR SERVICES

Verizon Wireless	OP5
------------------	-----

### APPAREL

Discovery Clothing	8
--------------------	---

### GENERAL MERCHANDISE & VARIETY

Dollar Tree	LS
-------------	----

### ENTERTAINMENT

Chuck E. Cheese	CC
-----------------	----

### RESTAURANT/FOOD

Checkers	OP3
McDonalds	
Pizza Hut	OP4
Pollo Tropical Restaurant	OP2
Tacos Wey	25

### SERVICES

America's Best Contacts and Eyeglasses	5
Apple Lashes	18
Brazilian Waxing By Sisters	19
Zoom Tan	6
H&R Block	23/24
Hair Cuttery	4
Peter Glenn Ski & Sports, Run Appeal	SM
Venus Nails	21

### MAJOR TENANTS

Aldi	AF
Burlington	SA
Harbor Freight Tools	ON
Havertys Furniture	PM
Office Depot	OD



### LEASING INQUIRIES

Morguard Management Company Inc.  
551 S. Powerline Road, Pompano Beach, FL 33069  
Phone 561-404-7036  
Joshua Nolan JNolan@morguard.com  
[morguard.com](http://morguard.com)



# WESTWARD SHOPPING CENTER

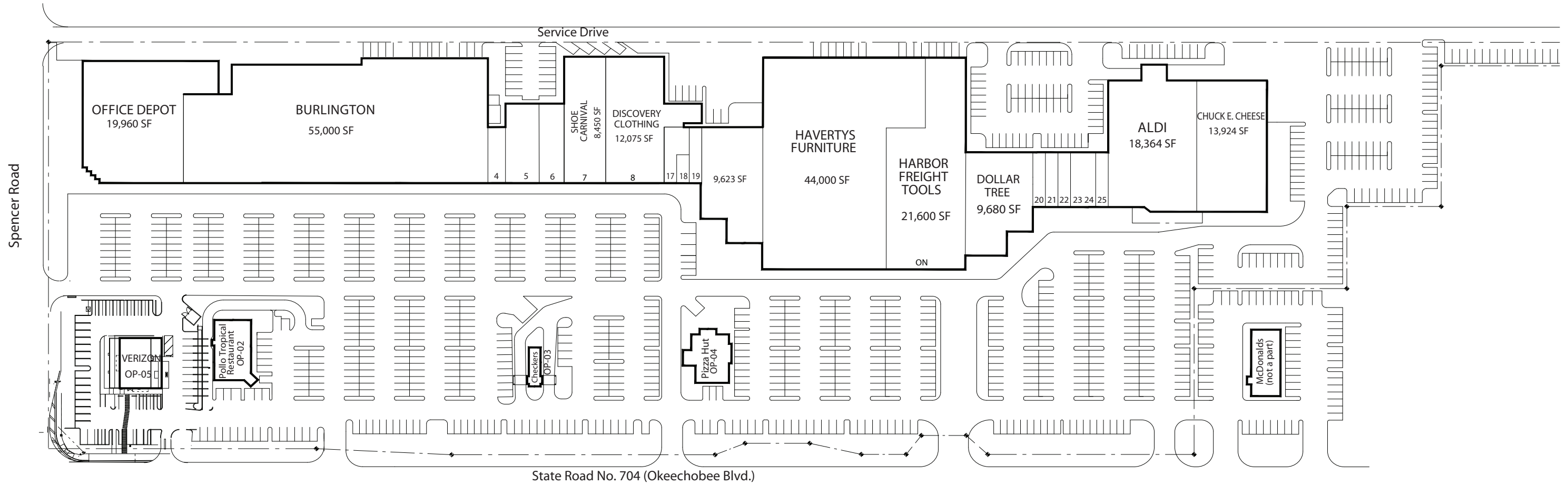

## Lease Plan

SCALE: N.T.S.  
 All dimensions subject to field verification  
 0' 30' 60' 120'



This exhibit shall not be deemed a warranty, representation or agreement on the part of the Landlord that the shopping center will or continue to be as indicated hereon without change, and Landlord may, from time to time and in any manner whatsoever, increase, reduce or change the parking areas or common areas as Landlord shall deem proper, and Landlord reserves the right to change the general layout and to make alterations or additions to, and to build additional stories on the buildings in which the leased premises are contained, and to add buildings adjoining same or elsewhere in the shopping center, and any other changes as may be required by governing authorities. The plan is subject to change, and is neither a warranty, representation nor agreement that prospective tenants and department stores shown here will be tenants or department stores at the location shown or at any other location at this shopping center. All measurements must be field verified.