

## PROPERTY HIGHLIGHTS

39,207 SF

- RBA: 39,207 SF
- Stories: 1
- Year Built: 1989
- Parking: 130 spaces
  - Including 6 handicap spaces
- Zoning: CR
- Land: 4.24 acres
- 3 truck height doors with roll up doors
- Roof Deck 14' 10"
- Clear Height 13'1"
- Finished Height 9.5'

The entire building can be made vacant for a single tenant or owner user.



**OFFICE/ MEDICAL BUILDING  
FOR SALE OR LEASE**

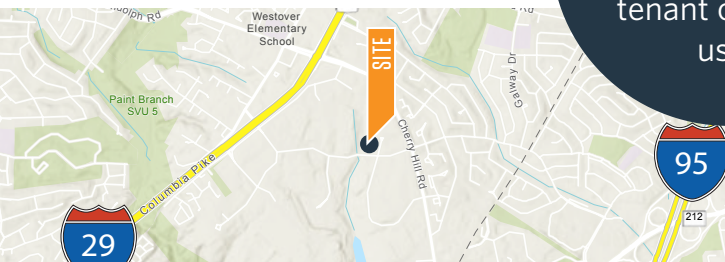



**WESTECH VILLAGE CORNER**





Logic at WhiteOak  
Townhomes and Apartments  
*Recently developed*

**SITE**

**WHITE OAK TOWN CENTER DEVELOPMENT**



Oak Barrel & Vine Liquor Store





**INSPIRE NAIL BAR & SPA**

**MONTGOMERY COLLEGE EAST EDUCATION CENTER**

**ORCHARD CENTER**





**KOHL'S**

**PET SMART**

Adventist HealthCare White Oak Medical Center

## PROXIMITY

- ICC MD-200 . . . . . 2.6 mi.
- I-95 . . . . . 2.2 mi.
- I-495 . . . . . 4.3 mi.
- Univ. of Maryland. . . . . 5.2 mi.
- Downtown D.C . . . . . 12.9 mi.
- BWI Airport . . . . . 25.7 mi.

## ABOUT OWNERSHIP

Founded in 2008, ESJ Capital Partners is a vertically-integrated owner, operator and developer of institutional quality office properties and education-focused real estate. ESJ's principals possess a combined 100+ years of experience and have completed over 11.3 million square feet of office transactions primarily located in the Southeastern United States.

# WESTECH BUSINESS PARK - DORCHESTER

KENNETH FELLOWS  
kfellows@klnb.com  
301-222-0210

ROBERT PUGH  
rpugh@klnb.com  
301-222-0211

KEIRY MARTINEZ  
kmartinez@klnb.com  
703-334-5629



Route 29: 1.4 mi. | 3 minutes

I-95: 2.2 mi. | 5 minutes

ICC MD-200: 2.6 mi. | 6 minutes

I-495: 4.3 mi. | 10 minutes

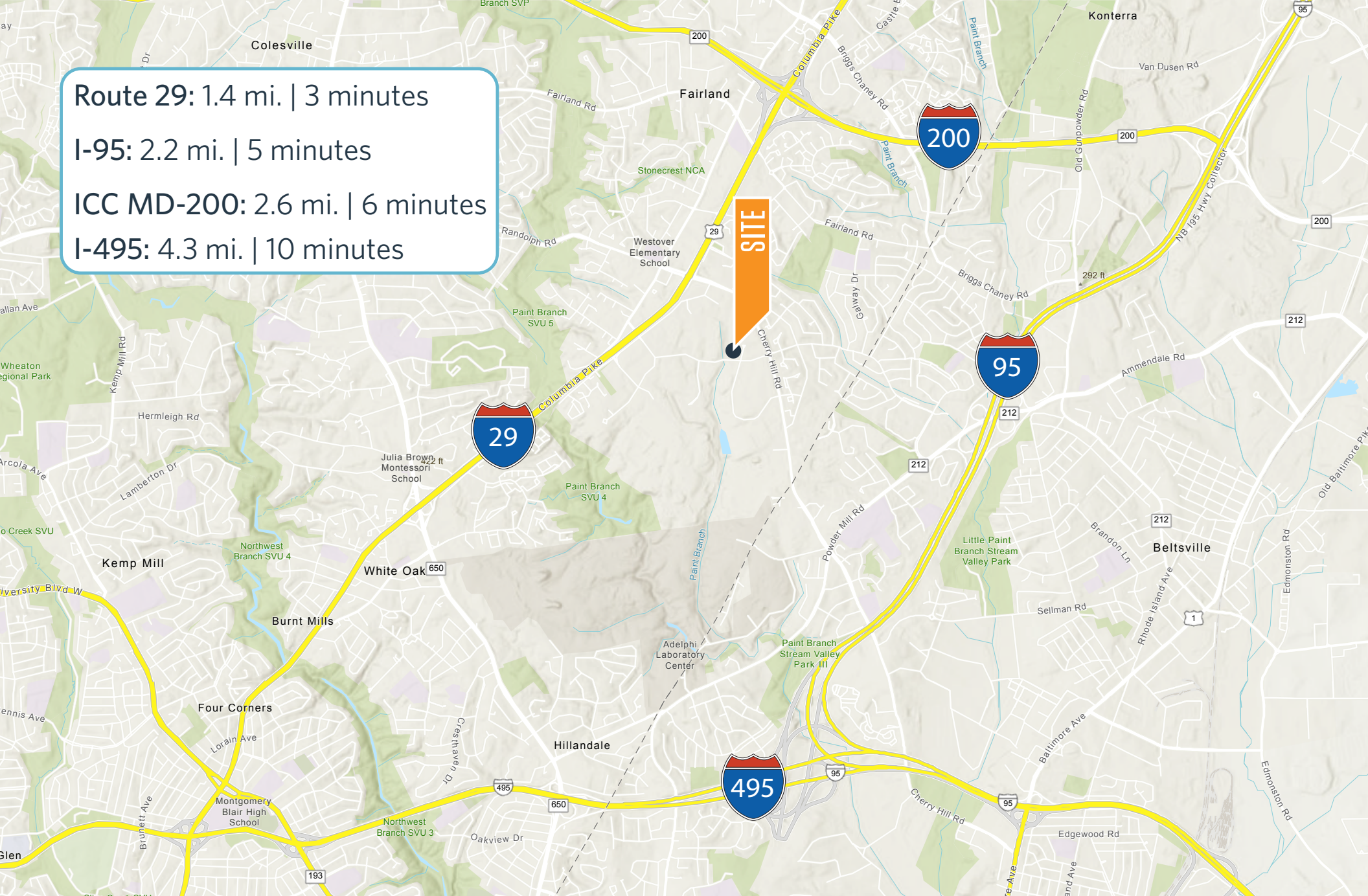

## WESTECH BUSINESS PARK - DORCHESTER

KENNETH FELLOWS  
kfellows@klnb.com  
301-222-0210

ROBERT PUGH  
rpugh@klnb.com  
301-222-0211

KEIRY MARTINEZ  
kmartinez@klnb.com  
703-334-5629



Total SF: 39,207

SUITE 100  
23,137 SF

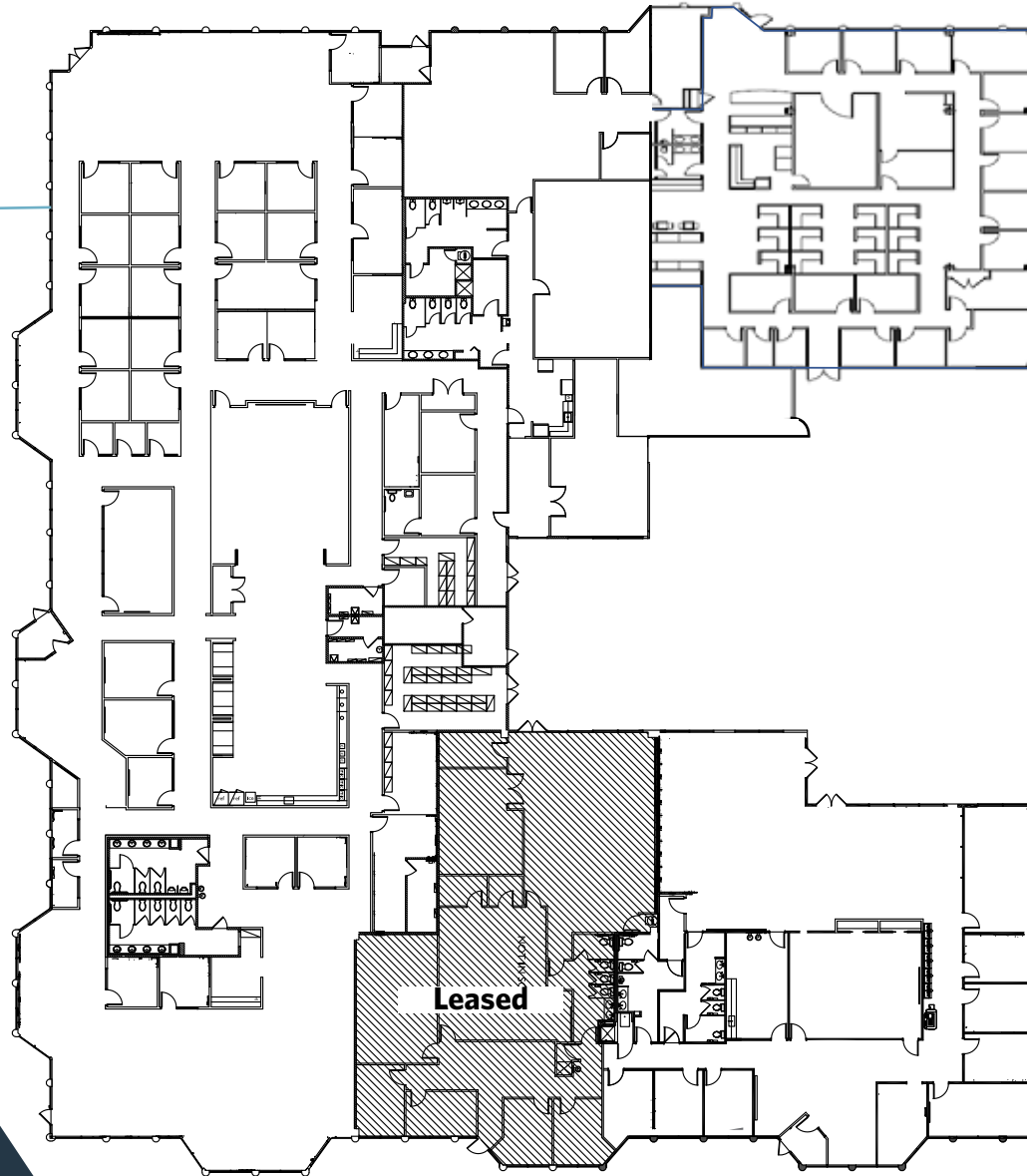

SUITE 110  
6,071 SF  
Available 05/2026

The entire building  
can be made  
vacant for a single  
tenant or owner  
user.

SUITE 115  
5,979 SF

## FLOOR PLAN

### WESTECH BUSINESS PARK - DORCHESTER

KENNETH FELLOWS  
kfellows@klnb.com  
301-222-0210

ROBERT PUGH  
rpugh@klnb.com  
301-222-0211

KEIRY MARTINEZ  
kmartinez@klnb.com  
703-334-5629





# WESTECH BUSINESS PARK - DORCHESTER

12120 Plum Orchard Dr, Silver Spring, MD 20904

## CONTACT

KENNETH FELLOWS  
kfellows@klnb.com  
301-222-0210

ROBERT PUGH  
rpugh@klnb.com  
301-222-0211

KEIRY MARTINEZ  
kmartinez@klnb.com  
703-334-5629

12435 Park Potomac Ave, Suite 250,  
Rockville, MD, 20854

**klnb.com**

VISIT PROPERTY WEBSITE



While we have no reason to doubt the accuracy of any of the information supplied, we cannot, and do not, guarantee its accuracy. All information should be independently verified prior to a purchase or lease of the property. We are not responsible for errors, omissions, misuse, or misinterpretation of information contained herein and make no warranty of any kind, express or implied, with respect to the property or any other matters.