

# FOR LEASE

## OFFICE | WAREHOUSE

### Chelsea District of Norfolk, VA



**1317 REDGATE AVENUE, NORFOLK, VA**

- Available: 900 SF
- Warehouse: 607 SF
- Office: 293 SF
- Site: Multi-tenant complex
- Zoning: I-1
- Electrical: 1 Phase, 100 Amp 240 Volt
- Eave Height: 14'
- Building Dimensions: 30' x 30'
- Floor: 5" reinforced concrete
- 2 paved parking spaces
- Heated and air conditioned throughout

- Office Lighting: LED
- Warehouse Lighting: LED
- (1) 10' x 12' Overhead door
- Exterior Walls: Concrete block with vinyl siding
- Building constructed in 1986
- One office restroom with shower
- One office area
- One kitchen with cabinets, sink, microwave and refrigerator
- Available: Immediately
- LEASE RATE: \$1,600.00 per month

**CONTACT:**

**CHIP WORLEY**  
**(757) 640-8218**

[chipworley@harveylindsay.com](mailto:chipworley@harveylindsay.com)

**HARVEY LINDSAY**

COMMERCIAL REAL ESTATE

*A Tradition of Forward Thinking*

The information contained herein has been obtained from sources believed to be reliable but is not warranted. We cannot be responsible for errors, omissions, withdrawal, or prior lease or sale.

**LAYOUT**

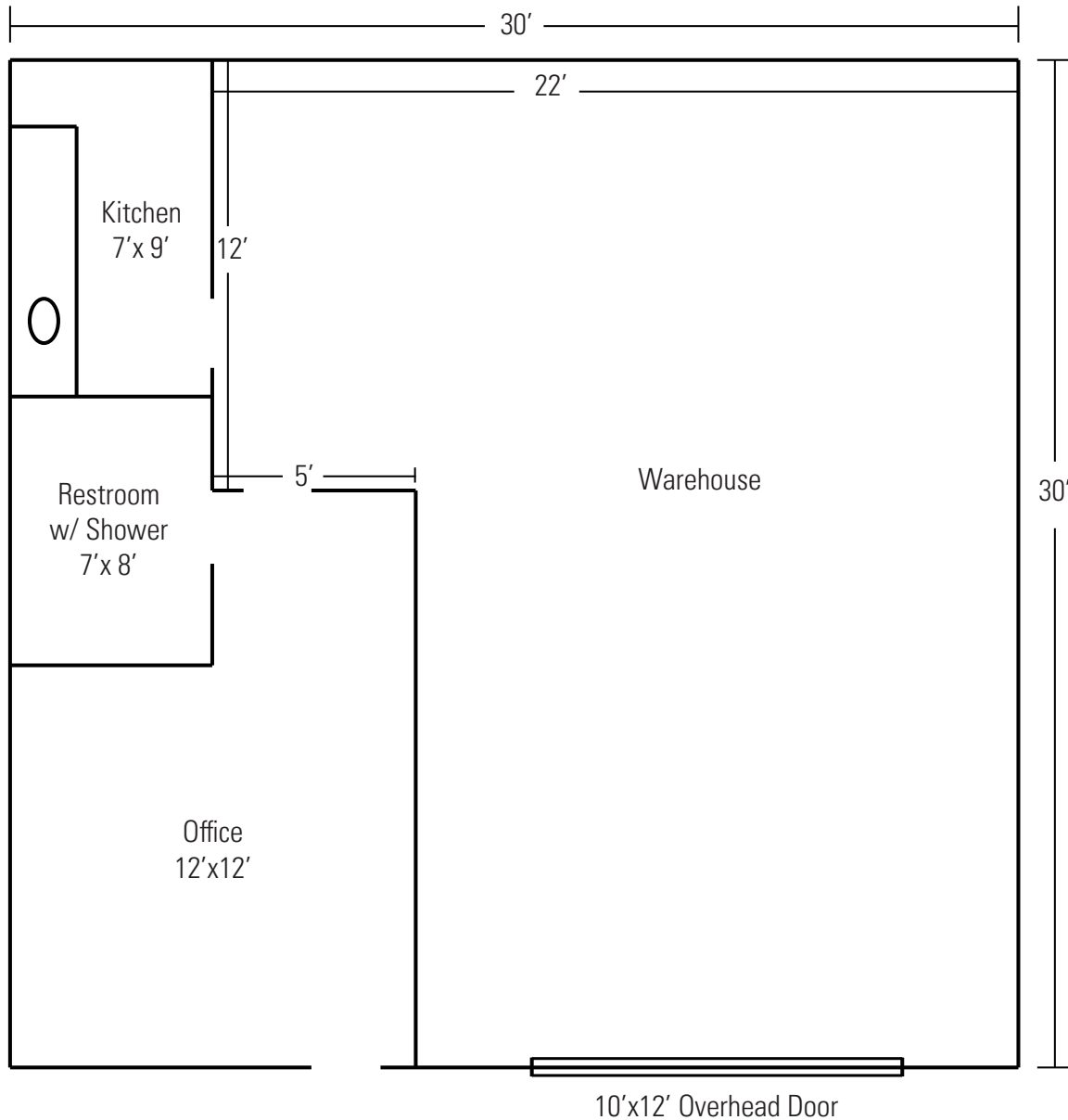

\*NOT TO SCALE

**CONTACT:** \_\_\_\_\_

**CHIP WORLEY**

**(757) 640-8218**

[chipworley@harveylindsay.com](mailto:chipworley@harveylindsay.com)

**HARVEY LINDSAY**

COMMERCIAL REAL ESTATE

*A Tradition of Forward Thinking*

**FOR LEASE | OFFICE/WAREHOUSE | 1319 Redgate Avenue, Norfolk, VA**

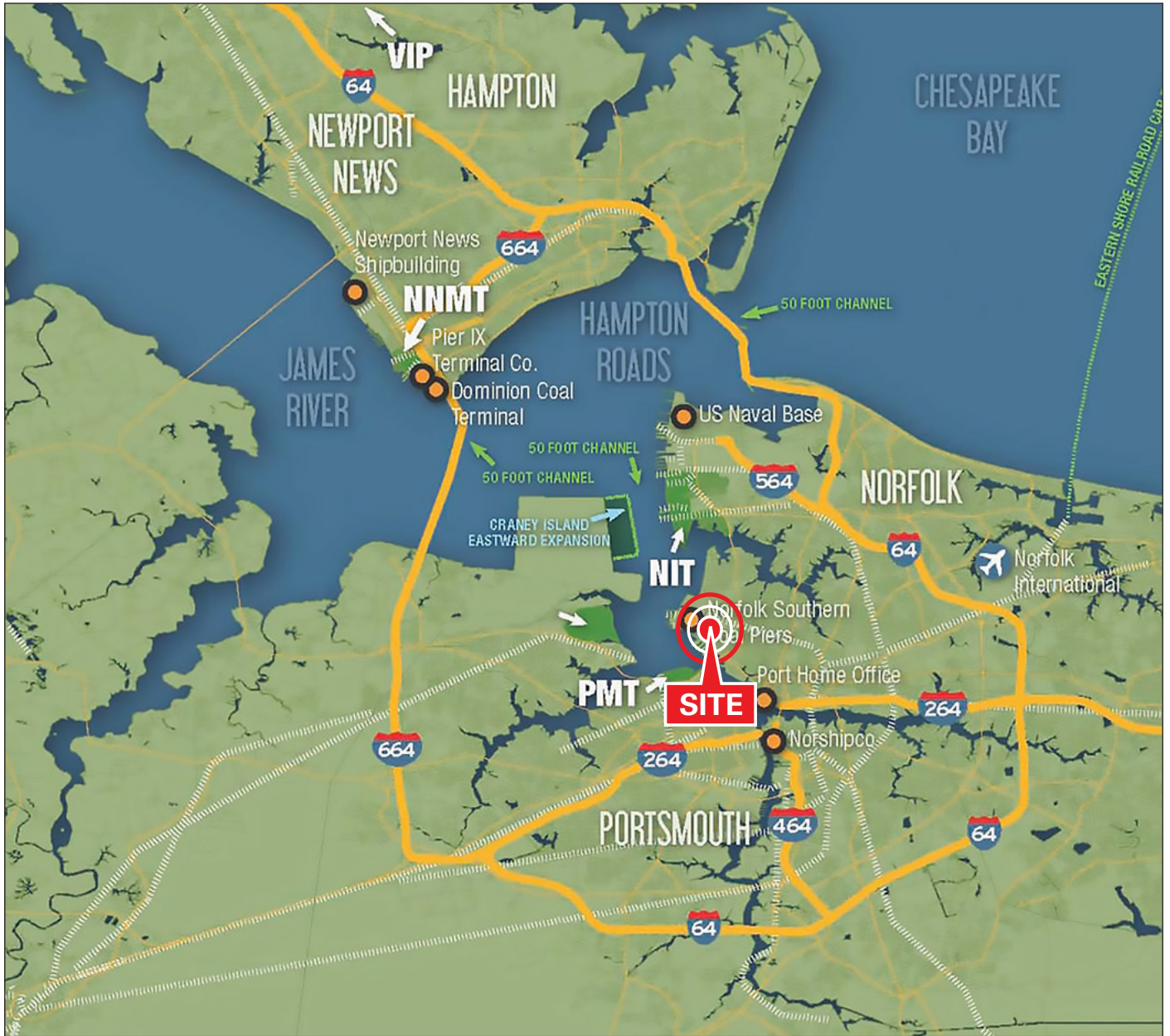

**DISTANCE TO PORTS (APPROXIMATE)**

Portsmouth Marine Terminal	± 3.7 Miles
Virginia International Gateway (former APM)	± 5.1 Miles
Norfolk International Terminal	± 4.4 Miles
Newport News Marine Terminal	± 17.9 Miles

**CONTACT:**

**CHIP WORLEY**  
**(757) 640-8218**

[chipworley@harveylindsay.com](mailto:chipworley@harveylindsay.com)

**HARVEY LINDSAY**

COMMERCIAL REAL ESTATE

*A Tradition of Forward Thinking*

The information contained herein has been obtained from sources believed to be reliable but is not warranted. We cannot be responsible for errors, omissions, withdrawal, or prior lease or sale.