

**FOR
LEASE**



ADT: ±157,500



ADT: ±197,500

Murray Dr ADT: ±13,200

**Grossmont Center Dr
ADT: ±34,100**

Grossmont Plaza II

5475 Grossmont Center Drive La Mesa, California 91942





Property Highlights

- Anchored by Trader Joes, Kahoots and Men's Warehouse.
- Positioned within the high-traffic Grossmont Center Shopping Area, which attracts over 10.7 million visits annually.
- Benefits from strong visibility at the intersection of Grossmont Center Drive (34,100 ADT) and Murray Drive (13,200 ADT).
- Anchored by the iconic Trader Joe's and other strong tenants
- Highly desired La Mesa trade area
- Directly across from the busiest entrance to Grossmont Shopping Center
- Easy access and visibility to the I-8 and SR 125
- Strong daytime demographics
- Impressive household incomes

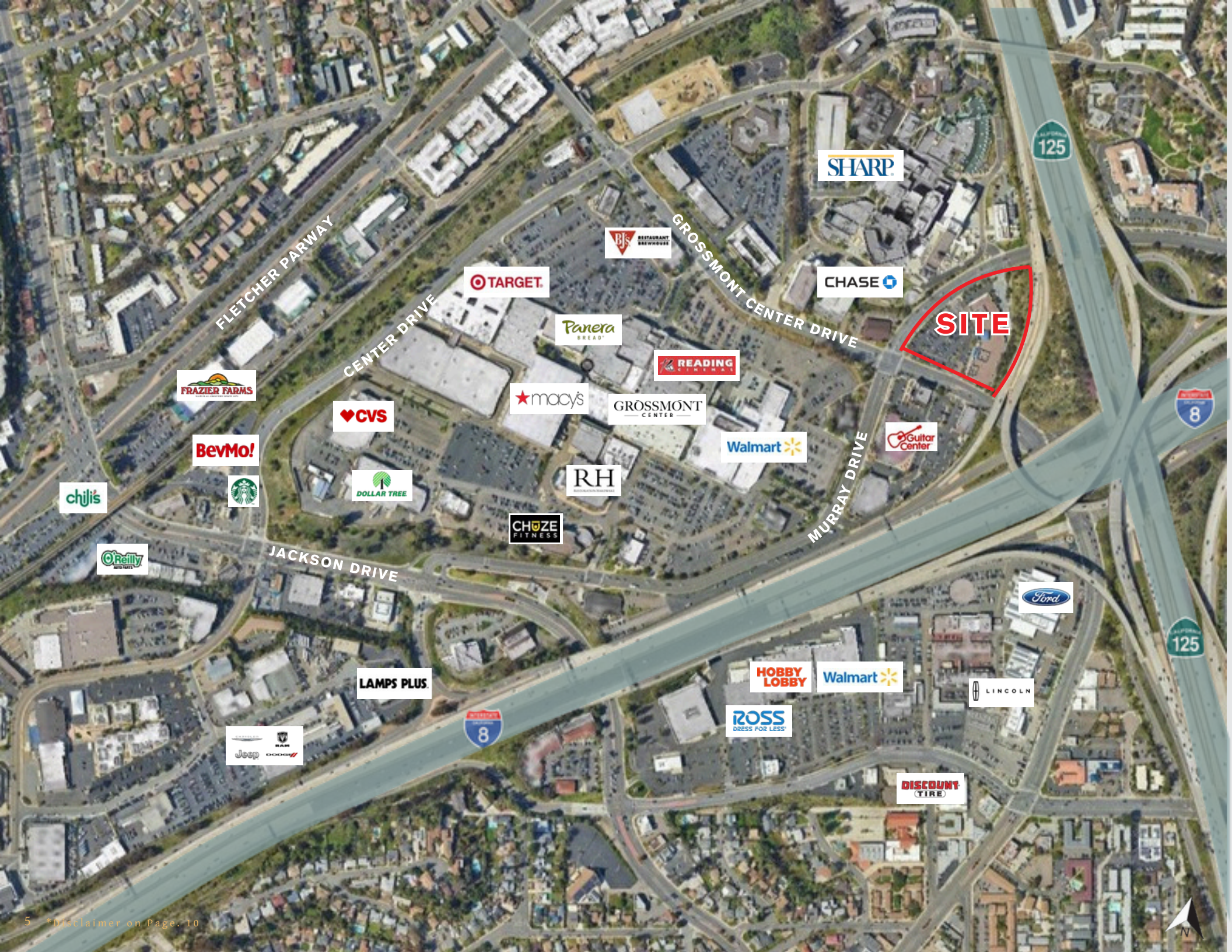

FLETCHER PARWAY

CENTER DRIVE

GROSSMONT CENTER DRIVE

JACKSON DRIVE

MURRAY DRIVE

125

8

125

SITE

SHARP

BFS RESTAURANT BREVARD

TARGET

CHASE

Panera BREAD

READING CINEMAS

FRAZIER FARMS

CVS

macy's

GROSSMONT CENTER

Walmart

Guitar Center

chjji's

Starbucks

DOLLAR TREE

RH

CHUZE FITNESS

O'Reilly

Ford

LAMPS PLUS

HOBBY LOBBY

Walmart

LINCOLN

Jeep RAM

8

ROSS DRESS FOR LESS

DISCOUNT TIRE





Site Plan

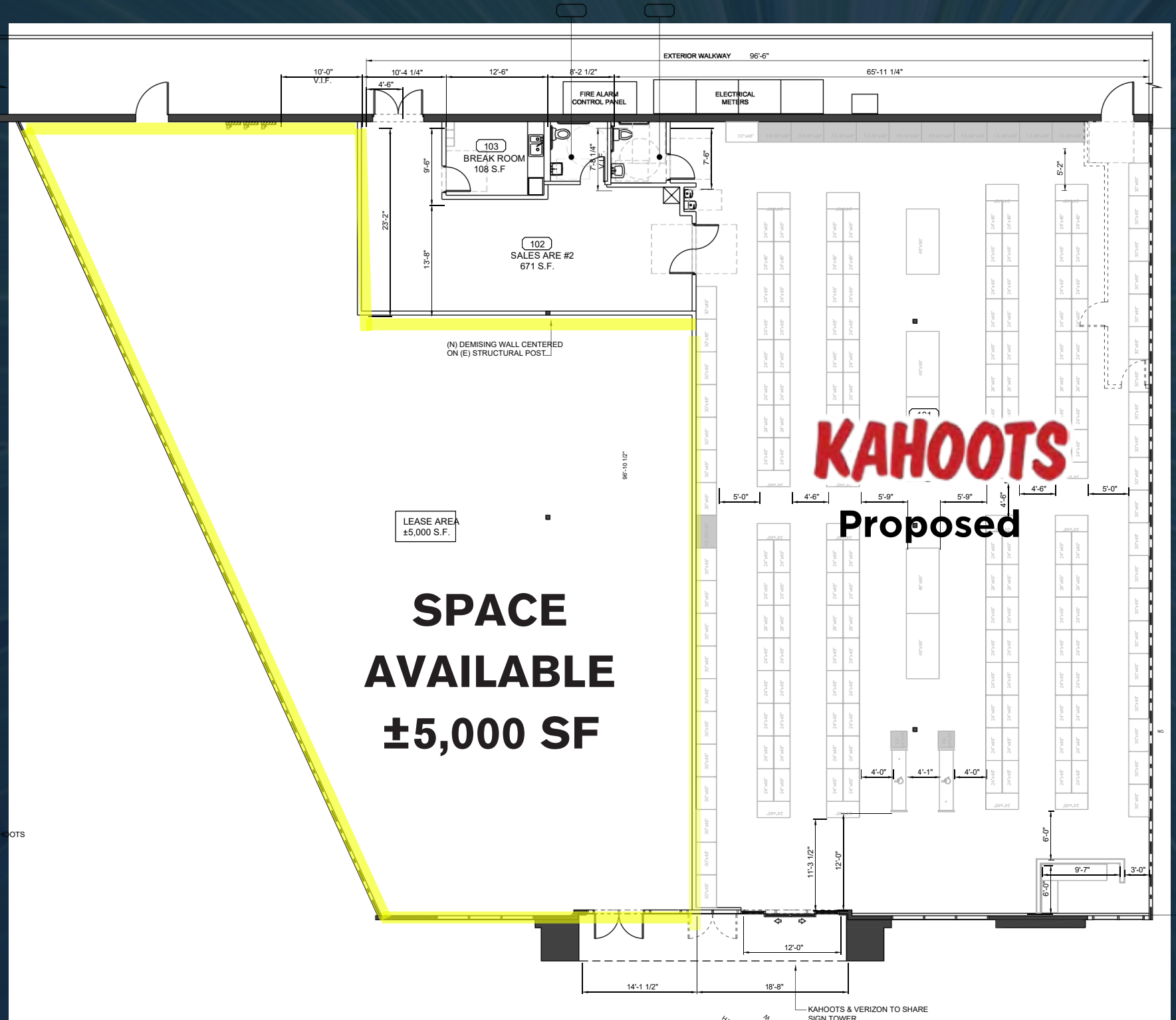

PROPOSED KAHOOT'S ENTRANCE

CONCEPTUAL SIGN AREAS

**YOUR NAME
HERE**

KAHOOTS
Proposed

Demographics



Population

| | |
|----------------|---------|
| 1 Mile | 16,674 |
| 3 Miles | 161,716 |
| 5 Miles | 449,291 |



Average Daily Traffic

| | |
|-----------------------------|---------|
| Murray Dr. | 13,200 |
| Grossmont Center Dr. | 34,100 |
| Interstate 8 | 228,000 |



Daytime Population

| | |
|----------------|---------|
| 1 Mile | 17,560 |
| 3 Miles | 92,806 |
| 5 Miles | 248,682 |



Average HH Income

| | |
|----------------|-----------|
| 1 Mile | \$111,728 |
| 3 Miles | \$122,136 |
| 5 Miles | \$160,421 |

Disclaimer

*All information regarding this property is deemed to be reliable, however, no representation, guarantee or warranty is made to the accuracy thereof and is submitted subject to errors, omissions, change of price or withdrawal without notice.

*Figures and statements appearing on this form represent our best knowledge and belief based on information gathered regarding the above property. This analysis is to be taken, therefore, as an estimate and not as a guarantee or warranty. Information contained herein is subject to independent verification and no liability for errors or omissions is assumed. You should rely on your own independent analysis and investigation regarding the above property and on the advice of your legal counsel and tax consultant.

*Any site plans and maps contained herein is not a representation, warranty or guarantee as to size, location, or identity of any tenant, and the improvements are subject to such changes, additions, and deletions as the architect, landlord, or any governmental agency may direct.

*Demographics contained herein are produced using private and government sources deemed to be reliable. The information herein is provided without representation or warranty. Additional information available upon request.

*Any geofencing data herein is provided by Placer Labs, Inc. (www.placer.ai) and is provided without representation or warranty.

*Photos contained herein are property of their respective owners. Use of these photos without the express written consent of the owner is prohibited. Photos do not guarantee the current condition of the property.

LEASING TEAM

JON HORNING

Senior Vice President
858.875.4667

jhorning@flockeavoyer.com
CA DRE No.: 01027916

STEVE AVOYER

President/Founder
619.280.2600

savoyer@flockeavoyer.com
CA DRE No.: 00407899

GAEL COURTNEY

Executive Vice President
858.875.4666

gcourtney@flockeavoyer.com
CA DRE No.: 00952439

PAIGE ROCHELLE

Sales Associate
858.875.4684

prochelle@flockeavoyer.com
CA DRE No.: 02369938